

Town of Woodfin
Board of Planning & Zoning Meeting
October 14, 2019
6:30 P.M.

Meeting

Meeting Call to Order
Invocation
Approval of the Agenda
Approval of the Minutes

Public Forum-Citizens may address the Board concerning various topics after being recognized by the Mayor.

New Business

1. Public Hearing on a Proposed Conditional Use for Property Known to Buncombe County by PIN 9730-61-8333 and known commonly as 4 New Walnut Street..
2. Consideration of a Conditional Use Request for the Property Identified Above.

Adjournment



Town of Woodfin

90 Elk Mountain Road
Woodfin, NC 28804
PH:(828) 253-4887
FX:(828) 253-4700

To: Neighbors of Property Located at 4 New Walnut Street
From: Town Administrator, Jason Young
Re: Conditional Use Permit Hearing
Date: October 1, 2019

Dear Property Owner:

This notice is being sent to you because you own property within 150 feet of 4 New Walnut Street. On Monday, October 14, 2019 at 6:30 PM the Board of Planning and Zoning will hold a public hearing on a proposed multi-family apartment complex located at 4 New Walnut Street. This hearing is open to the public and the proposed development can only go forward as a Conditional Use. If you are interested in finding out more about the requested use, you may contact the Town Hall during normal business hours and or you may attend the above described meeting.

Yours truly,

Jason Young
Town Administrator
Town of Woodfin
www.woodfin-nc.gov

Public Notice

In accordance with the provisions outlined in the Town of Woodfin's Code of Ordinance let it hereby be known to all interested parties that an application has been made to the Board of Planning and Zoning for a conditional use permit for a multi-family apartment located at 4 New Walnut Street known alternately to Buncombe County at PIN 9730-61-8333 . The property in question is zoned Residential-7000 (R-7) a high-density residential district deemed suitable for multifamily use and the Land Use Ordinance of the Town of Woodfin allows for such facilities as a conditional use in this district. The proposed apartment complex would consist of nine units and 18 parking spaces. Any interested person may address the Planning and Zoning Board on this issue at a public hearing to be held on Monday, October 14, 2019 at 6:30 PM at the Woodfin Town Hall. Inquiries into this matter should be directed to the Woodfin Town Planner Michael Saunders at 828.253.4887 ext. 1006 or at msaunders@woodfin-nc.gov.

Zoning Petition

DATE: 6/27/2019

TO THE PLANNING AND ZONING ADJUSTMENT BOARD OF THE TOWN OF
WOODFIN, NORTH CAROLINA:

We, the undersigned, being the owners of the property described herein, request
that said property be considered for:

Interpretation _____

Conditional Use High Density residential

Variance _____

Re-zone for the reasons stated below:

Residential development commercial zone

Ward	Sheet	Lot	Address of Property	Owner's Name and Signature
		Pin# 9730 -61- 8333	4 New Walnut St Asheville NC 28804	Brandy L. Honeycutt <i>Brandy Honeycutt</i>

Received by: _____
Zoning Administrator

Search input field

Search By Deed or Plat

Sales Report Buffer Export Map Export to Google Map

Search Results

Export to Excel Print Results

Property Card: PROPERTY CARD (<https://registerofdeeds.buncombecounty.org/propertycard/5225/1782>)

DEEDBOOK/DEEDPAGE: (<http://registerofdeeds.buncombecounty.org/deedbook/520001/0009>)

PLATBOOK/PLATPAGE: (<http://registerofdeeds.buncombecounty.org/platbook/18973061833300000>)

Sales Report: Sales Report

PINNUM: 973061833300000

OWNER: HONEYCUTT BRANDY

CONDOUNIT:

CONDOBUILDING:

SUBNAME: WOODFIN LAND CO

SUBLOT: 20-23

SUBBLOCK: 9

SUBSECT:

HOUSENUMBER: 4

NUMBERSUFFIX:

DIRECTION:

STREETNAME: NEW WALNUT

STREETTYPE: ST

TOWNSHIP: 11

ACREAGE: 0.56999999

DEEDDATE: 20140717

COUNTY: BUN

CITY: CWO

FIREDISTRICT: FWO

SCHOOLDISTRICT:

AREAOF:

ADDRESS: 1016 RIDDLER BRANCH RD

CITYNAME: BURNSVILLE

STATE: NC

ZIPCODE: 28714

CLASS: 100 (<https://gis.buncombecounty.org/class/100>)

TOTALMARKETVALUE: 124500

APPRAISEDVALUE: 124500

TAXVALUE: 124500

LANDUSE:

NEIGHBORHOODCODE: R4KH

LANDVALUE: 41100

BUILDINGVALUE: 82200

Empty search input box

Search By Deed or Plat

Sales Report Buffer Export Map Export to Google Map

Search Results

Export to Excel Print Results

Property Card [PROPERTY CARD \(https://gis.buncombecounty.org/propertycard\)](https://gis.buncombecounty.org/propertycard)

DEEDBOOK/DEEDPAGE: <http://registerofdeeds.buncombecounty.org/deedbook>
 bAutoSearch=true&bk=520001/0009

PLATBOOK/PLATPAGE: <http://registerofdeeds.buncombecounty.org/platbook>
 bAutoSearch=true&bk=180001/0009

Sales Report: Sales Report
 PINNUM: 973061833300000
 OWNER: HONEYCUTT BRANDY
 CONDOUNIT:
 CONDOBUILDING:
 SUBNAME: WOODFIN LAND CO
 SUBLLOT: 20-23
 SUBBLOCK: 9
 SUBJECT:
 HOUSENUMBER: 4
 NUMBERSUFFIX:
 DIRECTION:
 STREETNAME: NEW WALNUT
 STREETTYPE: ST
 TOWNSHIP: 11
 ACREAGE: 0.56999999
 DEEDDATE: 20140717
 COUNTY: BUN
 CITY: CWO
 FIREDISTRICT: FWO
 SCHOOLDISTRICT:
 ZEOFF:
 ADDRESS: 1016 RIDDLE BRANCH RD
 CITYNAME: BURNSVILLE
 STATE: NC
 ZIPCODE: 28714
 CLASS: 100 (<https://gis.buncombecounty.org/class>)
 TOTALMARKETVALUE: 124500
 APPRAISEDVALUE: 124500
 TAXVALUE: 124500
 LANDUSE:
 NEIGHBORHOODCODE: R4KH
 LANDVALUE: 41100
 BUILDINGVALUE: 82200

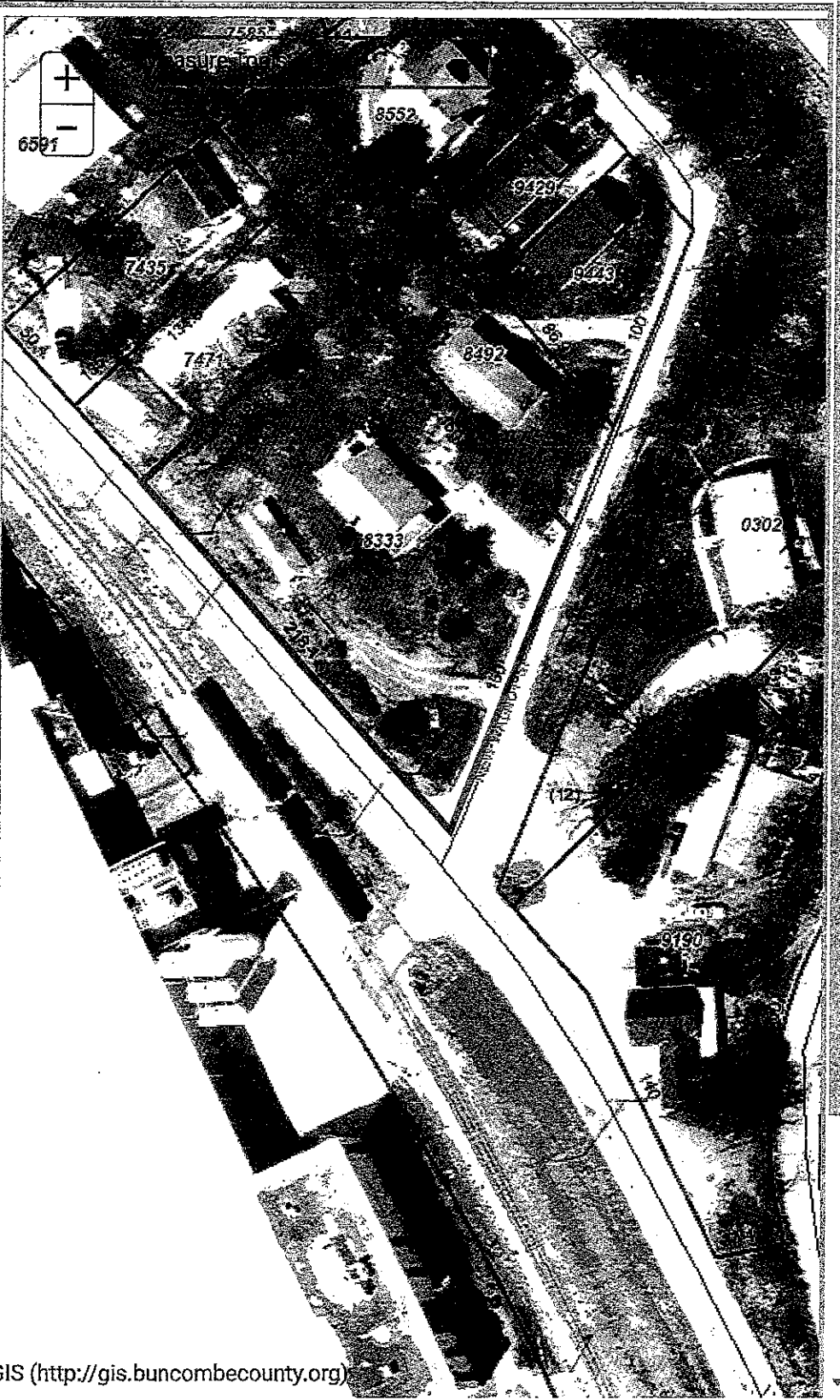

5/3/2011

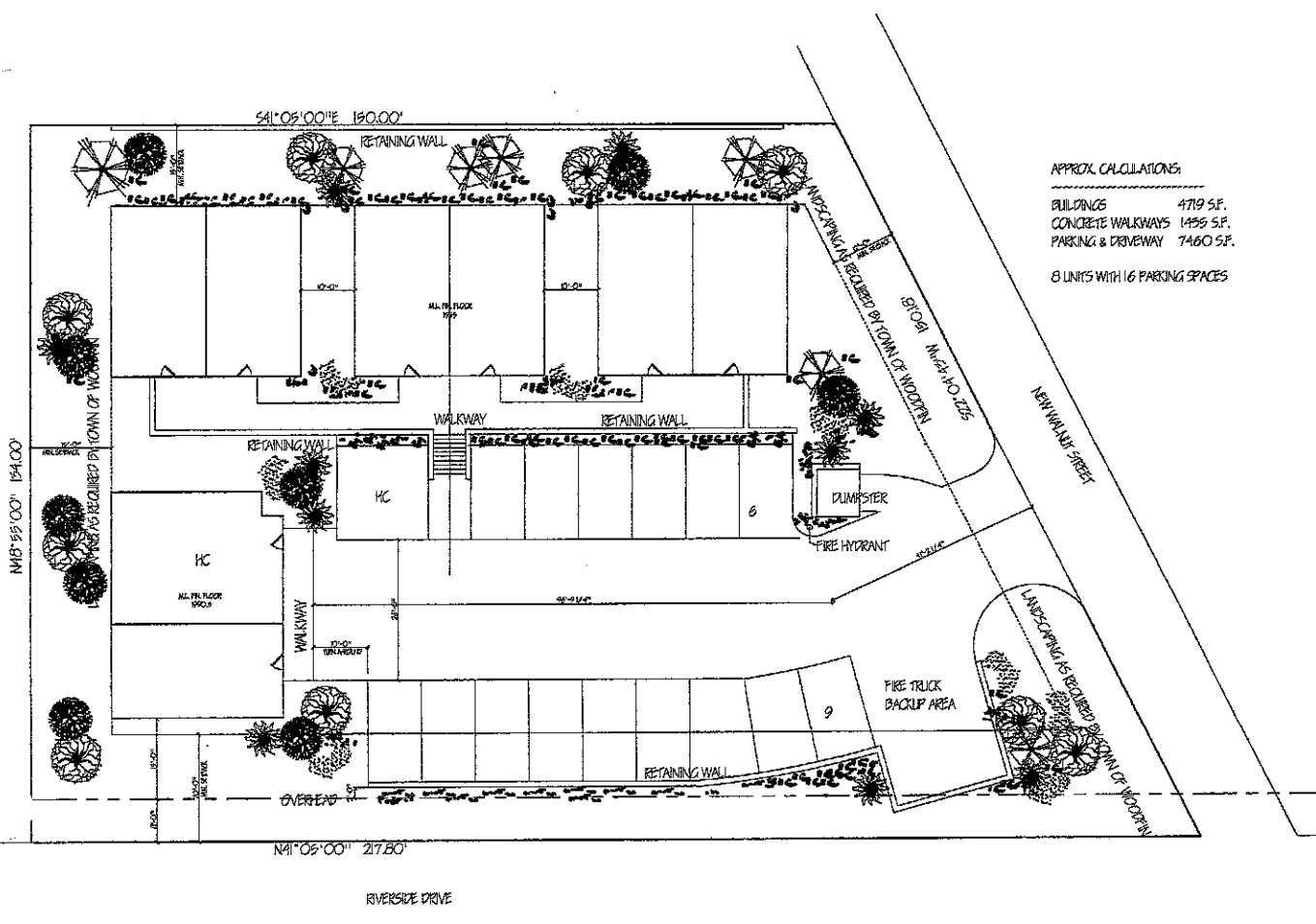

APPROX. CALCULATIONS:
 BUILDINGS 4719 SF.
 CONCRETE WALKWAYS 1455 SF.
 PARKING & DRIVEWAY 7460 SF.
 8 UNITS WITH 16 PARKING SPACES

Ⓜ Preliminary Site Plan
 SCALE: 1/8" = 1'-0"

DESIGNER	Randy Homecutt
CHECKER	
SCALE	AS SHOWN
DATE	05/03/11
PROJECT TITLE	Woodfin Homecutt
CLIENT	Town of Woodfin
LOCATION	Lincolnton, NC
PROJECT NO.	
DATE	
SP-11	