

LEGEND:

865.50SW	PROPOSED TOP OF SIDEWALK ELEVATION
865.50TC	PROPOSED TOP OF CURB ELEVATION
865.50FL	PROPOSED FLOWLINE ELEVATION
865.50TP	PROPOSED TOP OF PAVEMENT ELEVATION
865.50FG	PROPOSED FINISH GRADE ELEVATION
865.50DC=865.50FL	PROPOSED DROP CURB ELEVATION
865.50TW	PROPOSED TOP OF WALL ELEVATION
865.50BW	PROPOSED BOTTOM OF WALL ELEVATION
865.50TS	PROPOSED TOP OF STEP ELEVATION
865.50BS	PROPOSED BOTTOM OF STEP ELEVATION
(ME)	MATCH EXISTING ELEVATION
1%→	PROPOSED FINISH GRADE SLOPE AND DIRECTION OF FLOW
(H.P.)	PROPOSED HIGH POINT
882	PROPOSED CONTOUR ELEVATION
⊘	TEMPORARY SEDIMENT FILTER- HIGH FLOW
⊖⊖⊖⊖⊖	PROPOSED TEMPORARY SEDIMENT LOGS
▨	TEMPORARY ROCK CONSTRUCTION ENTRANCE

GRADING GENERAL NOTES:

1. THE CONTRACTOR SHALL NOTE ANY DISCREPANCIES BETWEEN EXISTING CONDITIONS AS EXIST IN THE FIELD AND AS REPRESENTED WITHIN THE PLANS AS SHOWN AND ALERT THE ENGINEER BEFORE BIDDING THE PROJECT AND BEGINNING CONSTRUCTION.
2. CONTRACTOR SHALL LOCATE AND VERIFY ALL UTILITIES WHICH MAY AFFECT THIS WORK AND NOTIFY OWNER OF ANY CHANGES. CONTACT LOCAL UTILITY COMPANIES FOR EXACT LOCATIONS PRIOR TO BIDDING THE PROJECT AND COMMENCING WORK.
3. CONTRACTOR SHALL TAKE NECESSARY PRECAUTIONS TO PREVENT SILT AND DEBRIS RUN-OFF DURING GRADING OPERATIONS (I.E. SILT FENCE, STRAW BALES, ETC.).
4. CONTRACTOR SHALL VERIFY CRITICAL ELEVATIONS TO ENSURE CONFORMANCE WITH GRADING PLAN, PARTICULARLY WITH EXISTING STRUCTURES AND/OR PAVEMENTS TO REMAIN. MEET EXISTING GRADES ALONG STREETS, PROPERTY LINES AND DRIVEWAY ENTRANCES. RESTORE ALL PAVEMENTS THAT REMAIN TO THEIR ORIGINAL IF NOT BETTER CONDITION. NOTIFY OWNER OF ANY CONFLICTS PRIOR TO BIDDING THE PROJECT.
5. TURF ESTABLISHMENT AREAS SHALL RECEIVE MINIMUM OF 4" DEPTH AS MEASURED IN PLACE OF TOPSOIL. TOPSOIL FURNISHED AND INSTALLED BY CONTRACTOR. ALL GRADED SLOPES GREATER THEN OR EQUAL TO 5:1 SHALL BE HYDROSEEDDED, EROSION CONTROL BLANKETED, OR MULCHED TO HELP STABILIZE THE SLOPES BY GENERAL CONTRACTOR.

EROSION CONTROL NOTES:

1. CONTRACTOR SHALL CONFINE CONSTRUCTION OPERATIONS TO THE CONSTRUCTION/GRADING LIMITS SHOWN.
2. ALL WORK SHALL CONFORM TO THE MINNESOTA POLLUTION CONTROL AGENCY'S STORM WATER PERMIT REQUIREMENTS. CONTRACTOR SHALL OBTAIN ALL PERMITS AND COMPLY WITH ALL PERMIT REQUIREMENTS.
3. THE SITE SOIL EROSION AND SEDIMENT CONTROL FACILITIES SHALL BE INSTALLED PRIOR TO ANY DEMOLITION OR GRADING OPERATIONS AND MAINTAINED TO CONFORM WITH THE STANDARDS SPECIFIED BY THE PERMIT.
4. CONTRACTOR SHALL INSPECT TEMPORARY EROSION CONTROL MEASURES ON THE ENTIRE SITE AT LEAST EVERY 7 DAYS AND WITHIN 24 HOURS OF ANY MEASURABLE RAINSTORM. DAMAGED SILT FENCE OR OTHER EROSION CONTROL DEVICE OR PRACTICES SHALL BE REPAIRED IMMEDIATELY. INSPECTION AND MAINTENANCE OF DEVICES SHALL CONTINUE UNTIL THE SITE HAS UNDERGONE FINAL STABILIZATION AND A NOTICE OF TERMINATION IS SUBMITTED TO THE MPCA.
5. ALL GRADING OPERATIONS SHALL BE CONDUCTED IN A MANNER TO MINIMIZE THE POTENTIAL FOR SITE EROSION.
6. THE SITE SOIL EROSION AND SEDIMENT CONTROL FACILITIES SHALL BE INSTALLED AND MAINTAINED TO CONFORM WITH THE STANDARDS SPECIFIED BY THE CITY OF RICHFIELD AND THE MPCA.
7. EROSION CONTROL MEASURES SHALL BE INSTALLED PRIOR THE DISTURBANCE OF ANY AREAS AND MAINTAINED UNTIL ALL TRIBUTARY DISTURBED AREAS ARE RESTORED.
8. THE CONTRACTOR SHALL BE RESPONSIBLE FOR THE REMOVAL OF ALL EROSION CONTROL MEASURES, INCLUDING SILT FENCE AND BALES, UPON ESTABLISHMENT OF PERMANENT VEGETATION IN SAID AREAS.
9. ALL SOILS TRACKED ONTO PAVEMENT OR ANY OTHER OFF-SITE AREA SHALL BE REMOVED DAILY.
10. THE SITE SEDIMENT CONTROL FACILITIES FOR THE PROJECT MUST BE INSTALLED PRIOR TO ANY GRADING OPERATION. ALL AREAS DISTURBED DURING CONSTRUCTION SHALL BE RESTORED AND VEGETATED AS SOON AS POSSIBLE. ANY FINISHED AREAS SHALL BE SEEDED AND MULCHED WITHIN 7 DAYS AFTER FINISHED GRADING IS COMPLETED IN ACCORDANCE TO MN/DOT 2575.
11. ALL INLET PROTECTION MUST BE HIGH FLOW INLET PROTECTION.
12. ALL DISTURBED AREAS SHALL BE REVEGETATED WITH SOD OR MN/DOT SEED MIX, MULCHED, FERTILIZED & DISK ANCHORED, PER THE FOLLOWING SCHEDULE:
SEED MIX 25-131: 220 LB/AC.
FERTILIZER 22-5-10: 350 LB/AC.
MULCH TYPE 3: 2 TONS/AC.

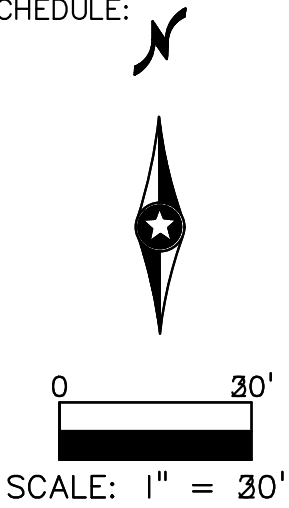
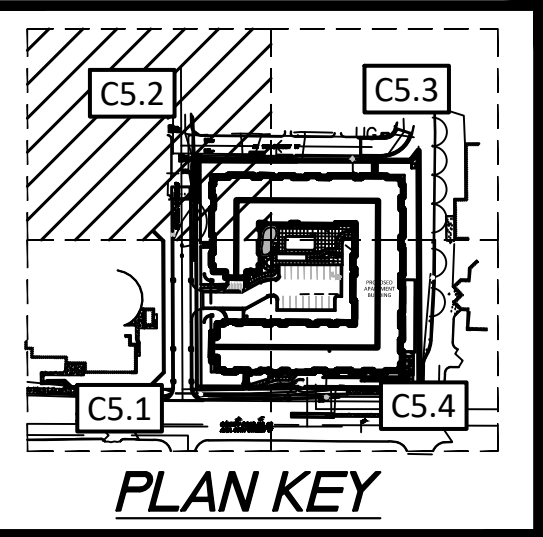

CALL 48 HOURS BEFORE DIGGING:
GOPHER STATE ONE CALL
TWIN CITY AREA 651-454-0002
MINNESOTA TOLL FREE 1-800-252-1166

REV	NO.	DATE	DESCRIPTION
1	1	10/11/2018	CITY CONCEPTUAL PLAN REVIEW
2	2	10/24/2018	SUBMITAL TO CITY SFR/PMR REVIEW
3	3	11/12/2018	SUBMIT REISED DRAWINGS PER CITY ARC REVIEW
4	4	11/30/2018	SUBMIT PER CITY PLANNING COMMISSION COMMENTS
5	5	04/15/2019	DMF SET FOR FOOTING & FOUNDATION PERMIT
6	6	09/06/2019	DRAWINGS ISSUED TO CITY FOR FINAL REVIEW
7	7	11/06/2019	FINAL CITY REVIEW

DATE: 09/09/2019
DESIGN BY: MJM,CJD
DRAWN BY: MJM,CJD
CHECKED BY: WPD
DWG FILE: 5.2-GRADING
FILE NO.: 18-0353.00

hereby certify that this plan, specification, or report was prepared by me or under my direct supervision and that I am a duly Licensed Professional Engineer under the laws of the State of Minnesota.

Signed: *Wesley Davis*
Wesley Davis, PE
Date: 11/08/2019 Lic. No. 55886

BOGART, PEDERSON & ASSOCIATES, INC.

LAND SURVEYING & ENVIRONMENTAL SERVICES

13076 FIRST STREET, BECKER, MN 55504-0822
TEL: 763-282-8822 FAX: 763-282-8844

Novo Apartments, 2400 66th St.
City of Richfield, MN
Part of Sec. 28, T. 28, R. 24
Hennepin County, Minnesota
Grading & Erosion Control Plan

SHEET NO.

C5.2