



# Finished Basement Check List

## Completed Building Application

### Two sets of floor plans

#### Floor Plan Requirements:

- Rooms labeled (Kitchen, Bedroom, Game room, etc.)
- Emergency egress window location and size if required. (All sleeping rooms require an egress window)

#### Wall Section (fill in form included w/Checklist):

- Wall type
- Draft stopping
- Height
- Insulation R-value

#### Smoke alarms shall be installed in the following locations:

- In each sleeping room.
- Outside each separate sleeping area in the immediate vicinity of the bedrooms.
- On each additional story of the dwelling, including basements and habitable attics but not including crawlspaces and uninhabitable attics.
- Carbon monoxide alarm required on each floor.
- Identify exhaust fans and plumbing fixtures on plan if applicable.

---

#### *Inspections Required\**

*Rough/Insulation*

*Final*

*\* Electrical, Mechanical, and Plumbing require separate permits and inspections.*

---



**ORION Township**  
Oakland County, MI ...est. March 1835

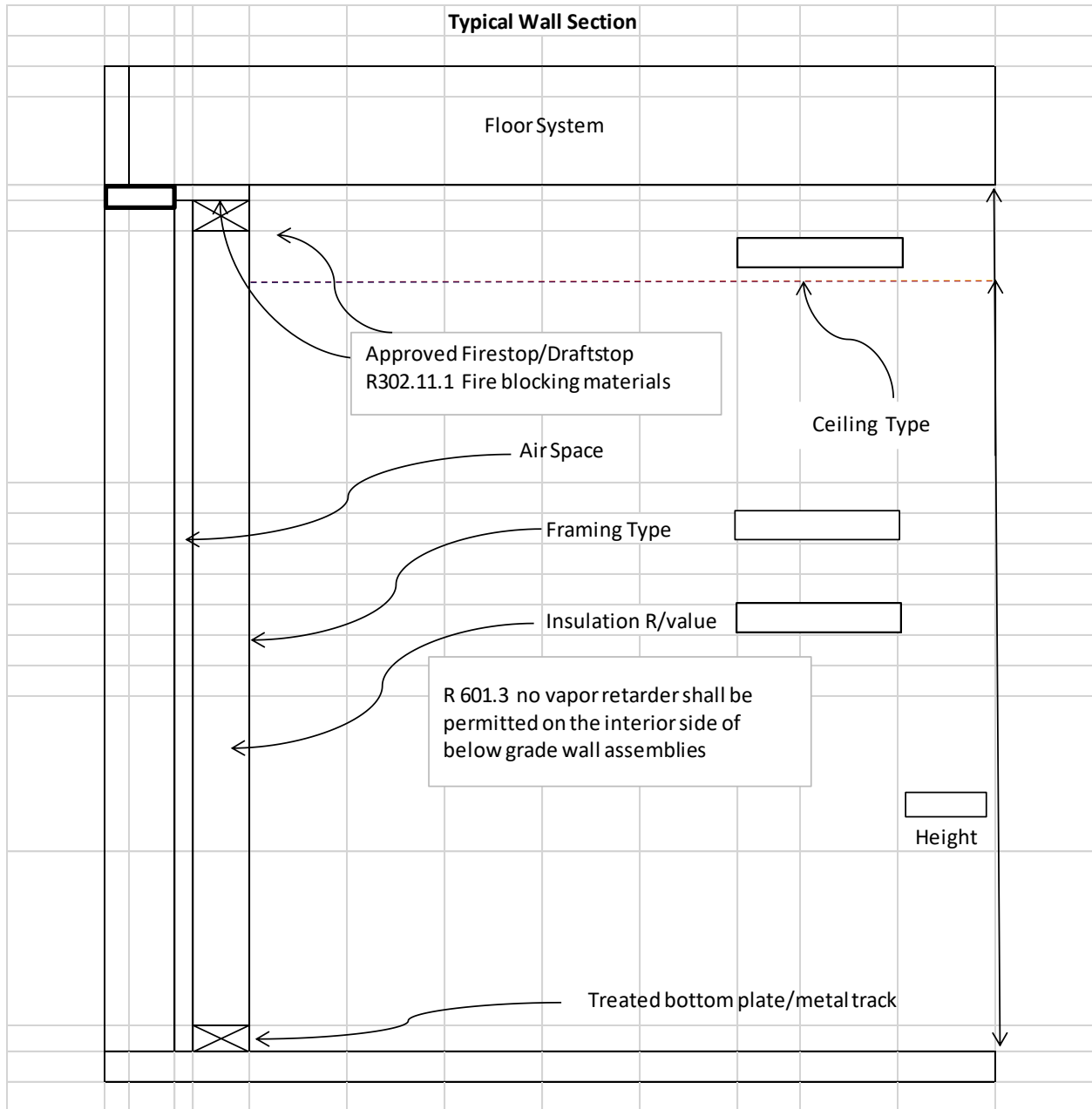

**ORION Township**  
Oakland County, MI ...est. March 1835