

Place fill in 0.15 acre of wetland
 Sample Wetland Fill
 Site Plan / Cross Sections

Purpose: Provide retail services to Urbanville
 Proposed: Place fill in 0.15 acre of wetlands
 Datum: NGVD
 Adjacent Property Owners:
 1. Charlie Rose
 2. King County

Reference no.: [assigned by Corps]
 Application by: Josephine Q. Retail Services, Inc.
 In: wetlands adjacent to Wolf Creek
 At: Urbanville
 County of: King State: WA
 Sheet 2 of 6 Date: 7/24/99

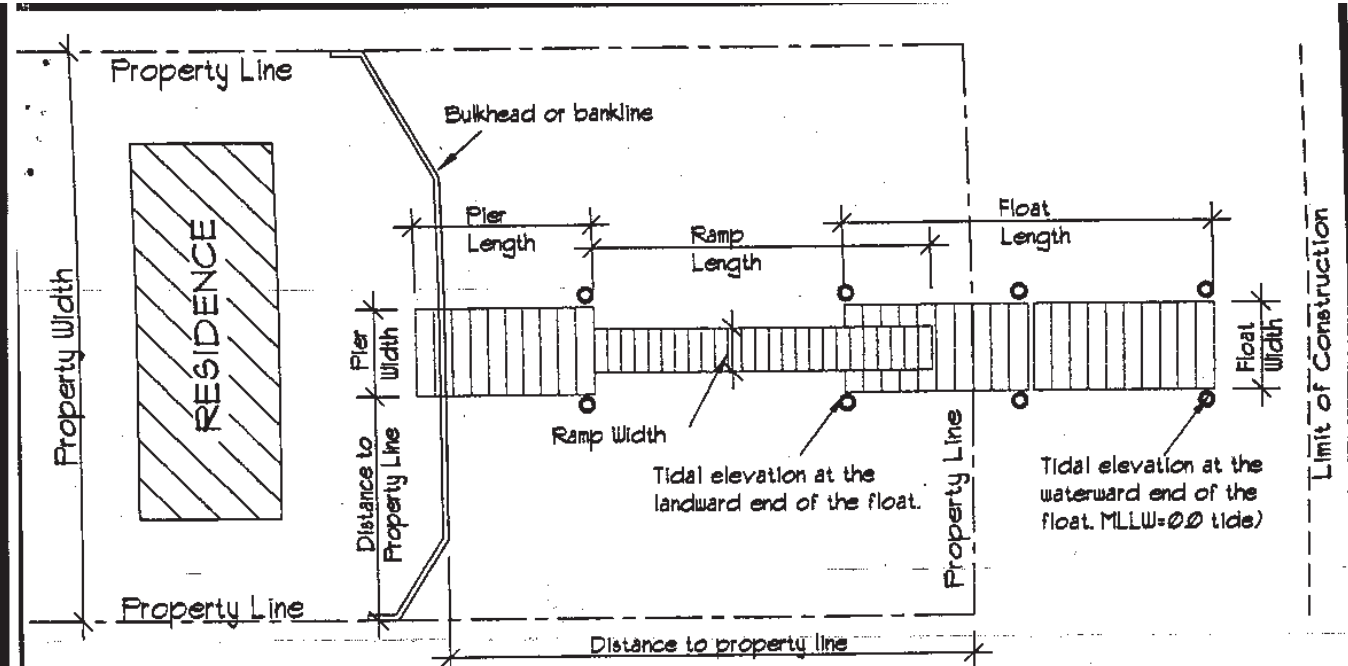

PLAN VIEW

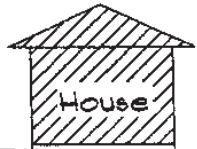

NOTES:

Provide the Following:

1. Location of OHW and MHHW on the beach, bank or existing bank protection. (MLLW=0.0 tide)
2. The type of flotation encasement.
3. Percentage of the float that will ground out within the beach area. (Above Extreme low water)
4. the type and location of any aquatic and/or wetland vegetation.
5. Number and type of piling.
6. Describe the nature of the waterward property boundary line on the tidelands (e.g., Mean Low Water, Extreme Low Tide, Meander Line, etc.) as found on the property deed.

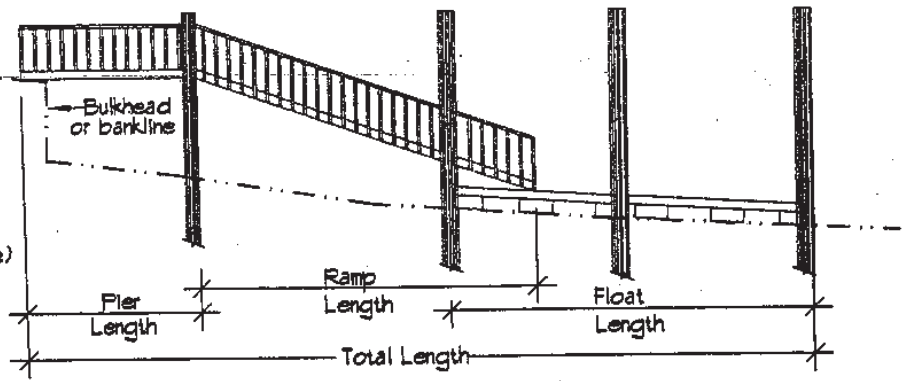

ELEVATION

TYPICAL PIER, RAMP, & FLOAT CONFIGURATION

THIS IS AN EXAMPLE OF THE INFORMATION REQUIRED

PROVIDE DIMENSIONS, DETAILS & SPECIFICATIONS AS APPROPRIATE FOR PROPOSED PROJECT.

IN 1/4 Sec. Sec. T. N. R.

COUNTY OF

APPLICATION BY

PROJECT ADDRESS:

SHEET OF DATE

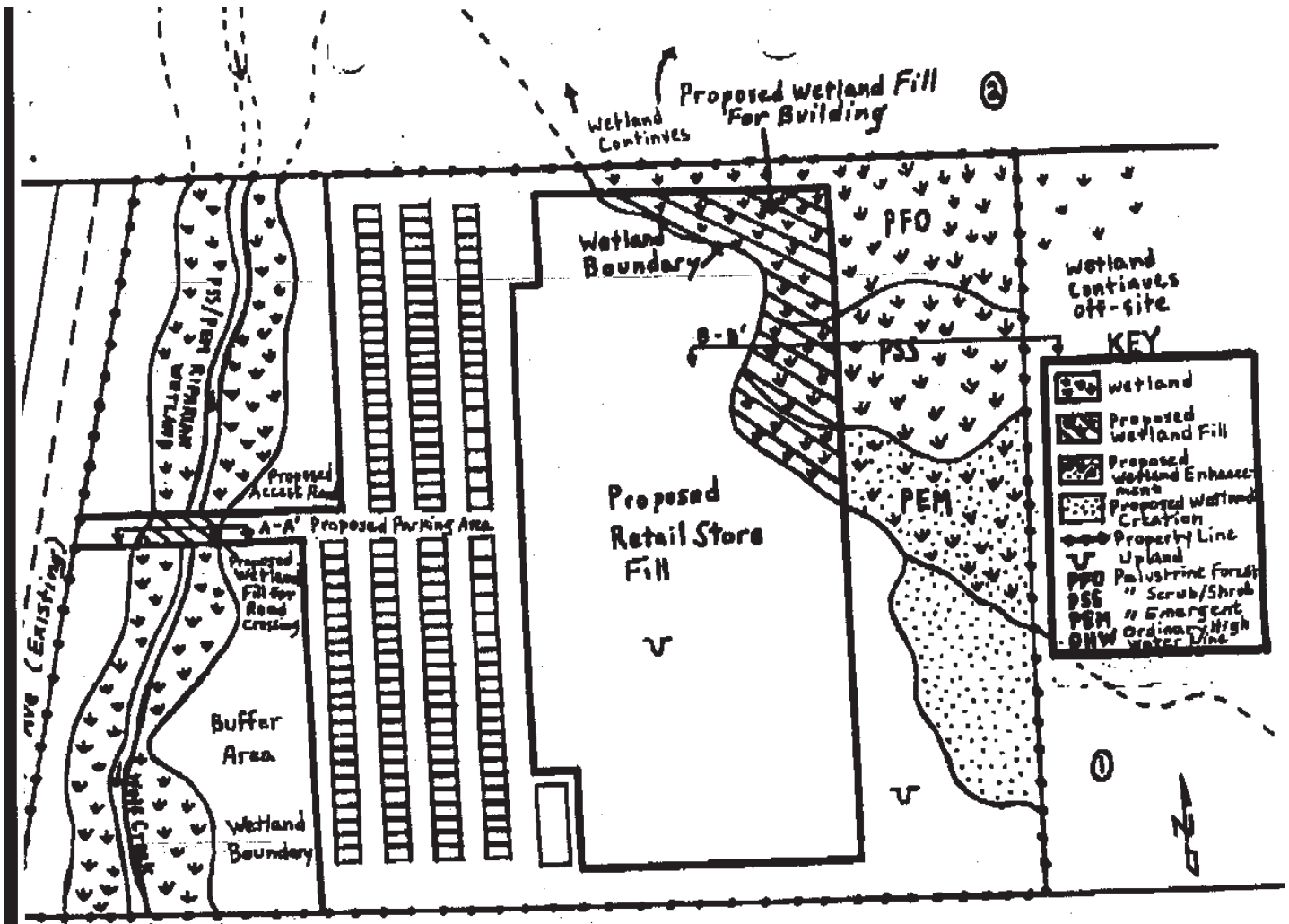

1" = 60'
SCALE

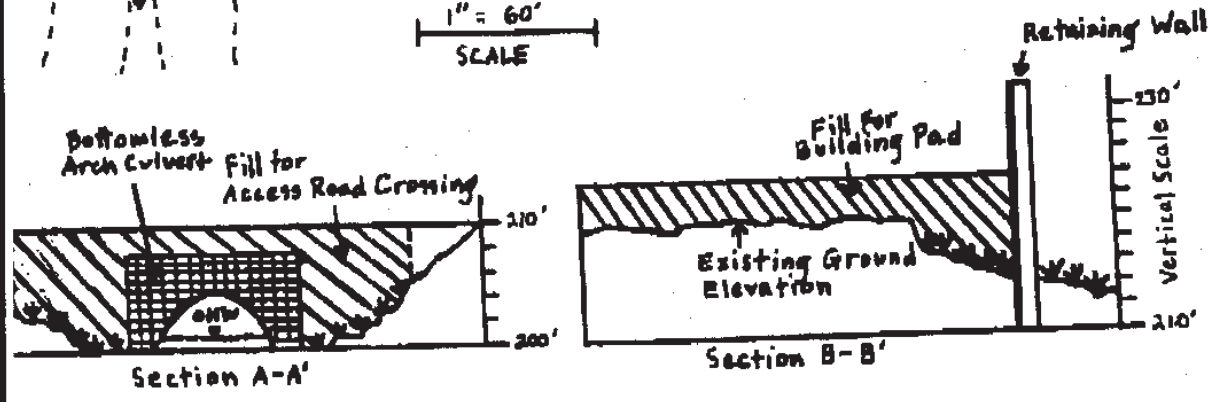

Place fill in 0.15 acre of wetland

Sample Wetland Fill
Site Plan / Cross Sections

Purpose: Provide retail services to Urbanville
 Proposed: Place fill in 0.15 acre of wetlands
 Datum: NGVD
 Adjacent Property Owners:
 1. Charlie Rose
 2. King County

Reference no.: [assigned by Corps]
 Application by: Josephine Q. Retail Services, Inc.
 In: wetlands adjacent to Wolf Creek
 At: Urbanville
 County of: King
 State: WA
 Sheet 2 of 5
 Date: 7/24/99

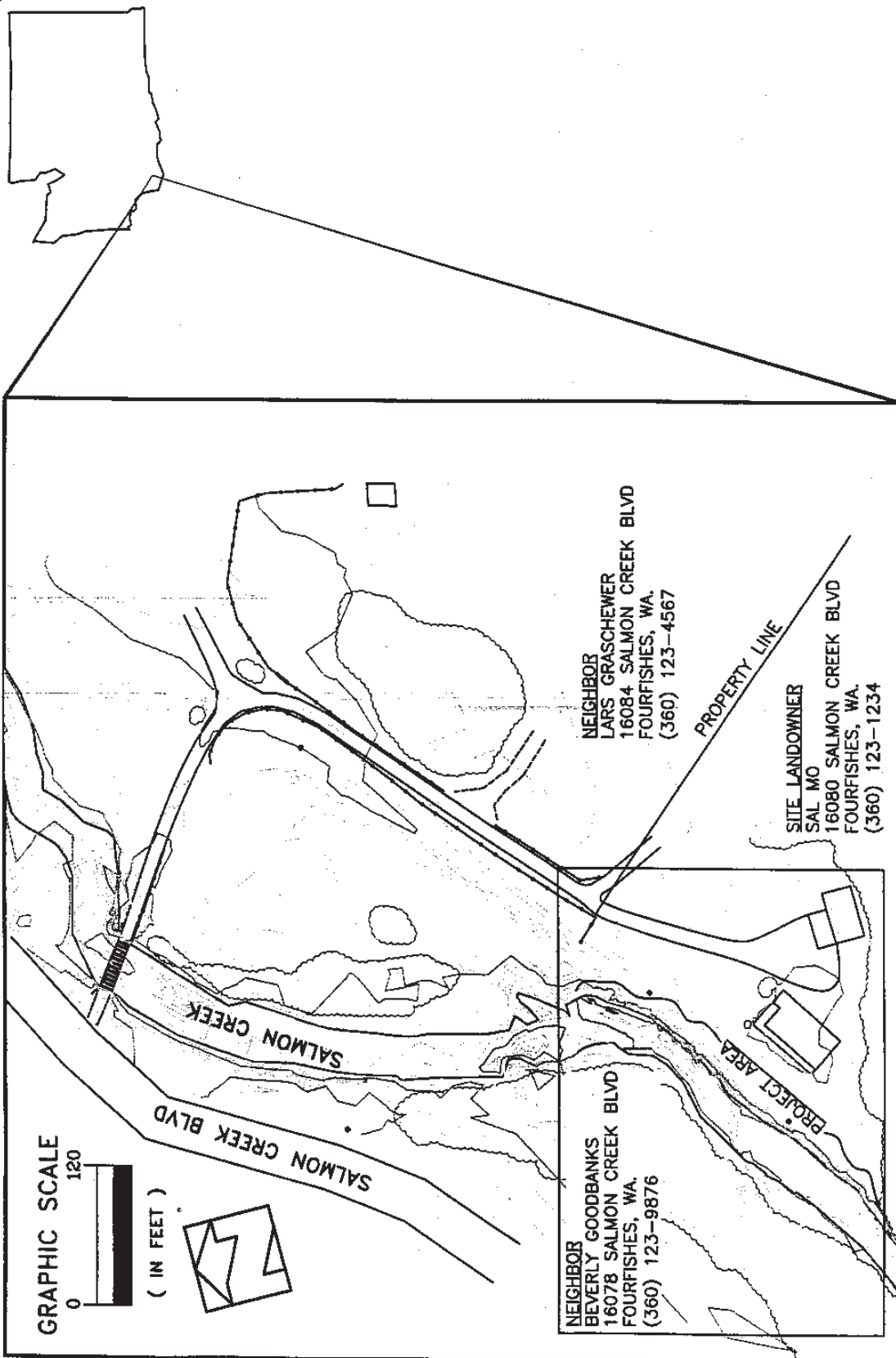

NEIGHBOR
 LARS GRASCHER
 16084 SALMON CREEK BLVD
 FOURFISHES, WA.
 (360) 123-4567

SITE LANDOWNER
 SAL MO
 16080 SALMON CREEK BLVD
 FOURFISHES, WA.
 (360) 123-1234

NEIGHBOR
 BEVERLY GOODBANKS
 16078 SALMON CREEK BLVD
 FOURFISHES, WA.
 (360) 123-9876



SALMON CREEK
 AT SAL MO PROPOERTY

SALMON CREEK BANK ENHANCEMENT PROJECT
 MO SITE

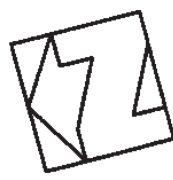
PLAN VIEW
 SITE MAP



LEGEND

-  EXISTING GABIIONS
-  EXISTING ERODING BANK
-  EXISTING GROUND CONTOUR

NOTE: CONTOURS
 CONTOURS GENERATED FROM
 SURVEY DATA RECORDED ON
 5/5/98. CONTOUR ELEVATIONS ARE
 SET RELATIVE TO ON-SITE
 TEMPORARY BENCHMARK.

RIGHT BANK AND FLOODPLAIN
 DENSE RIPARIAN VEGETATION ALONG
 STREAMBANK. RIPARIAN CORRIDOR
 WIDTH VARIES 80 FT TO 100 FT.
 MANICURED LAWNS ARE UPLAND OF
 RIPARIAN CORRIDOR.

LEFT BANK AND FLOODPLAIN
 APPROXIMATELY 350 LINEAL FT OF
 CREEK BANK IS ERODED. BANK
 SLOPE IS NEAR-VERTICAL WITH TOE
 TO TOP HEIGHT RANGING 5 FT TO
 7 FT. APPROXIMATELY 200 FT OF
 THE ERODED BANK IS COVERED BY
 NONWOVEN SYNTHETIC GEOTEXTILE
 FABRIC. APPROXIMATELY 90 FT OF
 BANK IS ARMORED WITH ROCK
 FILLED GABION BASKETS FROM TOE
 TO TOP. MANICURED LAWN EXTENDS
 FROM TOP OF BANK.

GRAPHIC SCALE



(IN FEET)

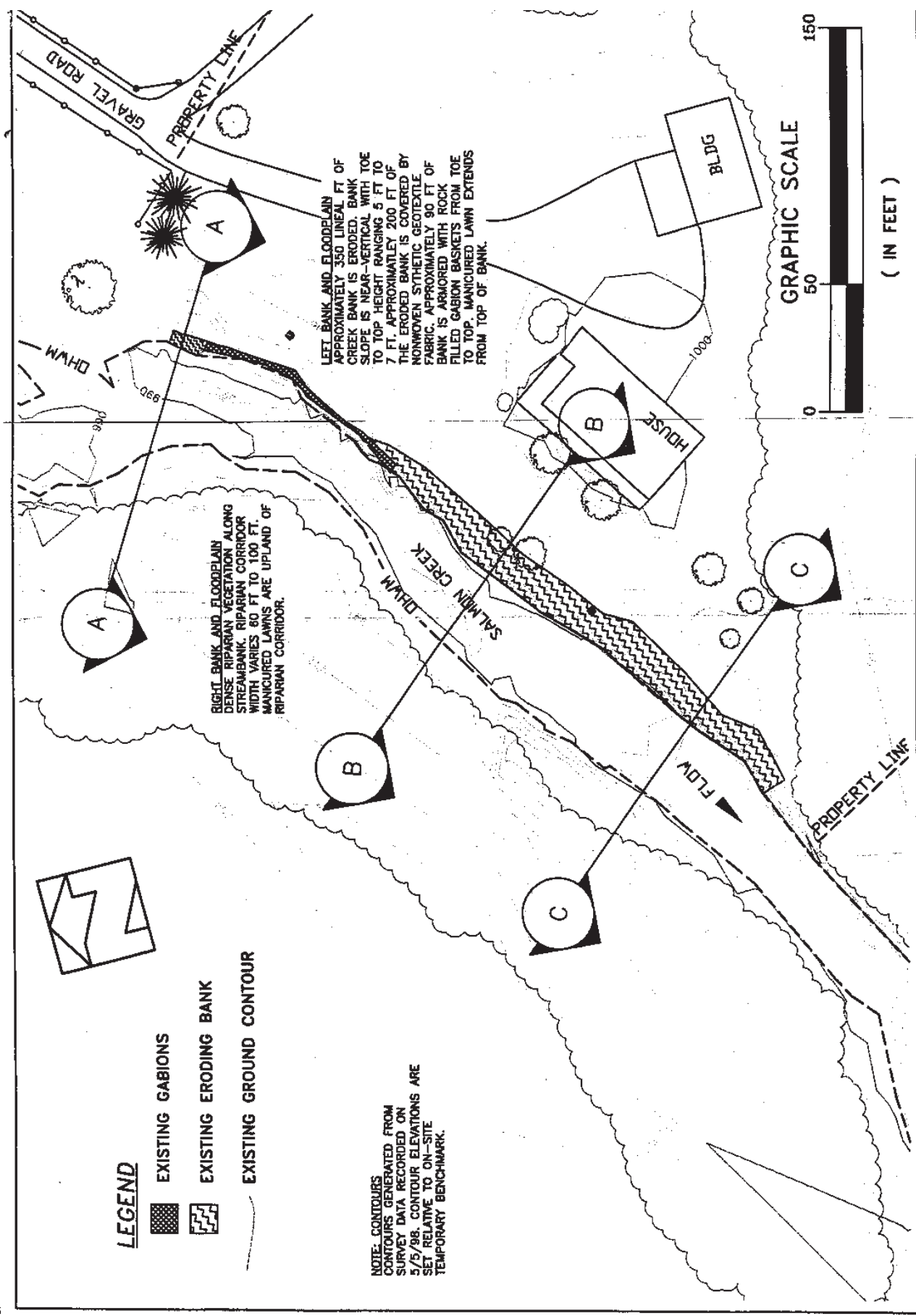

**SALMON CREEK BANK ENHANCEMENT PROJECT
 MO SITE**

PLAN VIEW
 EXISTING CONDITIONS

SHEET
 2 OF 5

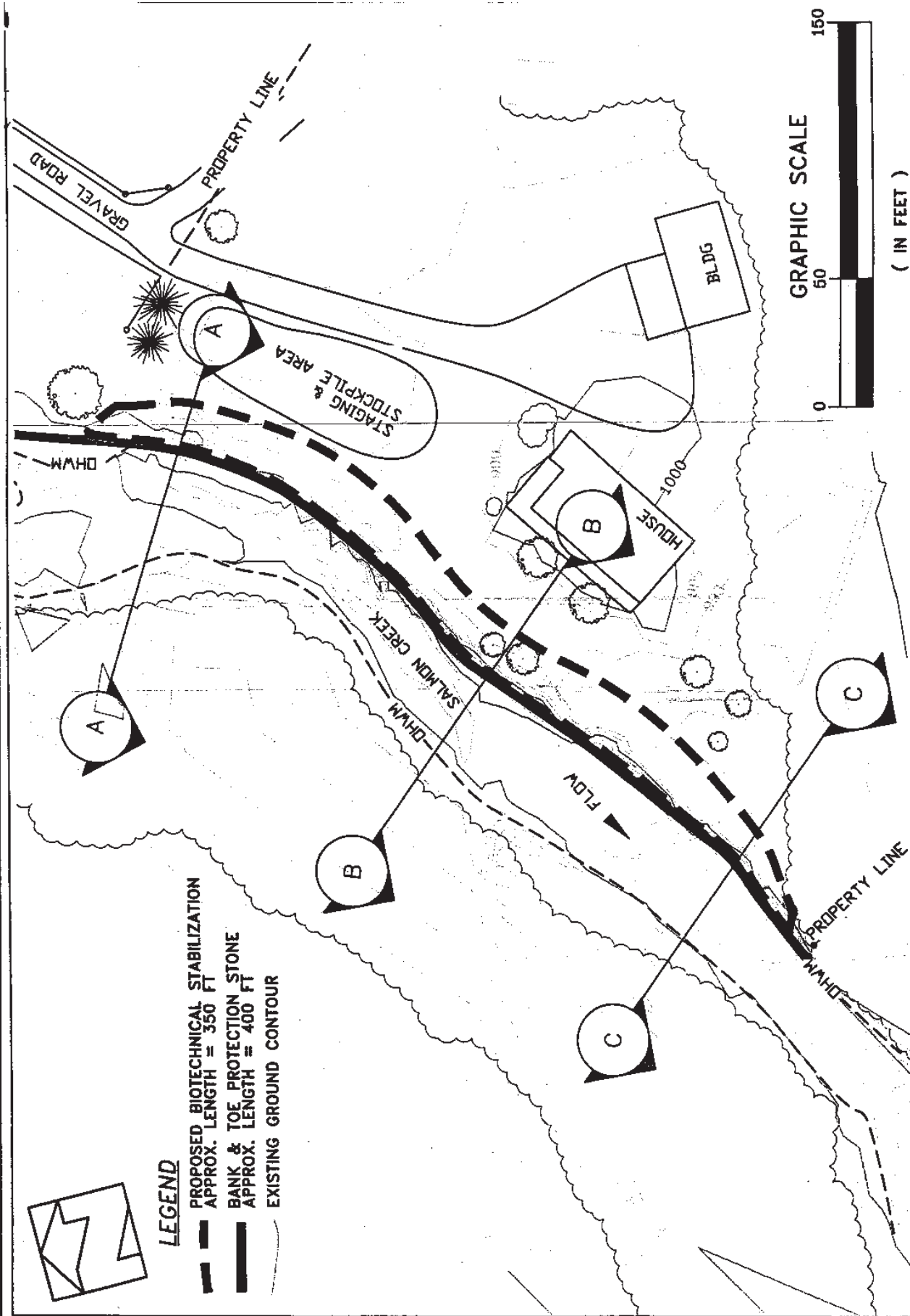

LEGEND

- PROPOSED BIOTECHNICAL STABILIZATION
APPROX. LENGTH = 350 FT
- - - BANK & TOE PROTECTION STONE
APPROX. LENGTH = 400 FT
- - - EXISTING GROUND CONTOUR



**SALMON CREEK BANK ENHANCEMENT PROJECT
MO SITE**

PLAN VIEW
TREATMENT AREA

SHEET
3 OF 5

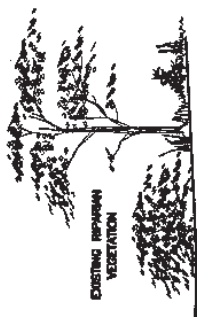

SECTION VIEW A
1 INCH = 10 FEET



SECTION VIEW B
1 INCH = 10 FEET



SECTION VIEW C
1 INCH = 10 FEET

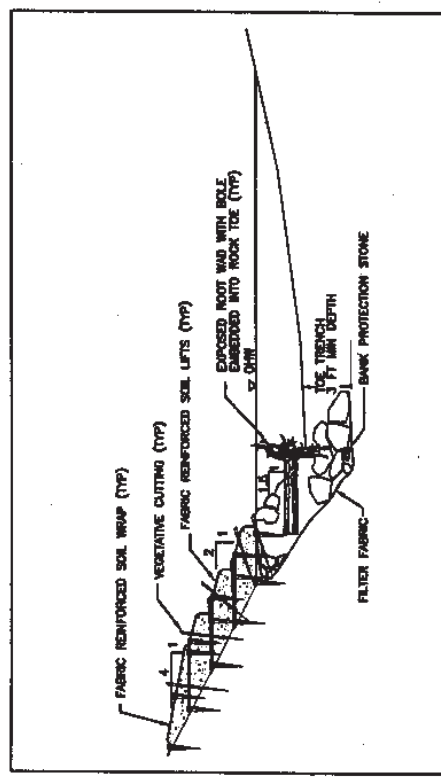

TYPICAL BIOTECHNICAL
STABILIZATION COMPONENTS
NO SCALE

SALMON CREEK BANK ENHANCEMENT PROJECT
MO SITE

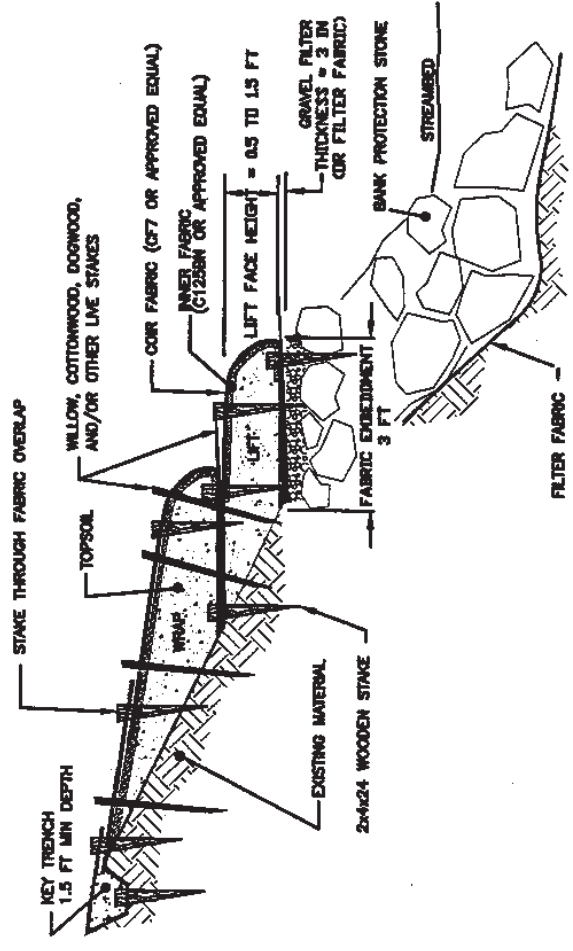

TYPICAL FABRIC REINFORCED BANK DETAIL

NO SCALE

CUT/FILL BUDGET	
EXCAVATED MATERIAL	1000CY
FILL MATERIAL	350 CY
BANK PROTECTION STONE	385 CY
NET CUT	265 CY

ROCK GRADATION			
% FINER	MIN (IN)	MAX (IN)	
D15	7	10	
D30	9	11	
D50	11	12	
D100	14	19	

ITEM	SPECIFICATION	QUANTITY
BANK PROTECTION STONE	MIN 165 PCF, ANGULAR, (SEE GRADATION)	385 CY*
INNER COIR FABRIC	C125BN OR APPROVED EQUAL	1400 SY
OUTER COIR FABRIC	CF7 OR APPROVED EQUAL (4 M WIDE)	2500 SY
FILTER FABRIC	AMOCO 4553 OR APPROVED EQUAL (5 M WIDE)	840 SY
ROOT WADS	MIN 12" DBH; 8' BOLE	24
WOODEN STAKES	2"x4"x24"	1500
VEGETATIVE CUTTINGS	WILLOW & DOGWOOD	3000
SEED MIX	NATIVE GRASSES	20 LBS

* IN-PLACE ROCK VOLUME