



MURRAY COUNTY HIGHWAY DEPARTMENT

3051 20TH STREET
SLAYTON, MN 56172
WWW.MURRAYCOUNTYMN.COM

TELEPHONE: 507-836-6327
FAX: 507-836-8891
EMAIL: MCHD@CO.MURRAY.MN.US

FEES: Moving Permit Only = _____
Moving Permit - Overweight = _____
Annual Moving Permit/Overweight = _____
(ANNUAL PERMITS ARE FROM MARCH 1ST TO FEBRUARY 29TH)

*Legal Weights are listed on Page 2, Number 15.
*Be sure to attach Page 3 with Sketch
(Per Truck) TRUCK LICENSE NO. _____

PERMIT NO. _____

TOTAL AMOUNT DUE: _____ Check / transaction #: _____

APPLICATION FOR PERMIT TO MOVE OVERSIZE AND OVERWEIGHT LOADS

- Object or material to be moved: * _____
- Length: _____ Width: _____ Height: _____ Gross Weight: _____ This will fill in automatically from pg. 3.

* If object is a building (not including manufactured homes, modular homes, farmers moving their own farm buildings, or moving building less than 16 feet wide by 20 feet long) provide Building Mover's License# _____ (See Mn Statute 221.81)

- Do axles and axle groups meet the Gross Weight Schedule as defined in MN Stat. 169.824, for all roads traveled? _____
- Applicant must attach a Sketch of the EQUIPMENT showing ALL axles and axle weights. See Page 3.**
- Movement to be from _____ to _____
Via County Road Numbers _____

Attach a map if possible

- Movement to be during dates of _____ to _____ daylight hours.

- Owner of towing equipment: _____
Address: _____

Phone: _____
Fax: _____

- Owner of load: _____

PUBLIC LIABILITY – PROPERTY DAMAGE

*Applicant must include **"Certificate of Insurance"** with this application.

Must exceed \$300,000 for a single claim arising from a single occurrence and \$1,000,000 for multiple claims arising from a single occurrence.

Amount of Public Liability and Property Damage insurance carried: \$ _____

If granted this permit, (I) (we) do hereby agree to comply with the provisions to take all necessary and reasonable precautions to maintain the safety of this movement and to be responsible for all liability for the personal injury or property damage which may occur in connection with this movement. In the event any claim is made against the County of Murray or department, office or employee thereof, through by reason of or in connection with any such act or omission, applicant shall indemnify and hold them and each of them harmless from such claims.

Applicants Signature: _____ Date: _____
(Owner of towing vehicle or owner of load)

This permit is not valid unless all 4 sheets are attached. This permit must be carried on the towing vehicle at all times of movement and is subject to inspection.

TRANSPORTATION PERMIT

Permission for this movement is hereby granted to: _____ subject to compliance with the provisions of the Minnesota Highway Traffic Regulation Act and under the terms, conditions and restrictions contained on the reverse side. Subject to revocation upon non-compliance.

Special Requirements: _____

Date: _____ AUTHORIZED BY: _____

(Title)

GENERAL CONDITIONS AND REQUIREMENTS

1. **RIGHT OF WAY** - When being passed by vehicles in either direction, no portion of equipment, vehicle or load shall extend beyond the centerline of the pavement or traveled way.
2. **RESTRICTED ROADS AND BRIDGES** – When traveling narrow roads or bridges where it is not possible for two-way traffic; flagmen shall be stationed ahead of and behind the vehicles, equipment or load. No overweight loads crossing any bridge or culvert unless a registered engineer verifies the structure will not be damaged. The applicant must pay for the engineering study. **No overweight permit will be issued during spring road postings.**
3. **HOURS/DAYS & DATES OF MOVEMENT** – Movement shall be during daylight hours ONLY, or as otherwise specifically stated on the permit. Weekend moves are discouraged. Movement shall be made on the dates specified on the permit. If extension of time is necessary, written authorization must be obtained.
4. **ADVERSE WEATHER AND HIGHWAY SURFACE CONDITIONS** – Movement shall not be started if visibility is poor or highway surfaces are hazardous or slippery or windy conditions exist that may cause to load to shift or become unstable.
5. **WARNING DEVICES AND EQUIPMENT** - All flags, flares, lights & reflectors must comply with legal requirements and limitations.
6. **USE OF FLAGS** – Any projection extending more than 3 feet ahead of the front bumper, 4 feet beyond the rear of the bed of a vehicle, or when a vehicle or combination of vehicles and/or loads exceeding 9 feet in width and/or 75 feet in length is required to display red warning flags. Such flags must be at least 18 inches square and in good repair, securely attached at the extreme tip of overhang, whether front or rear, and at the corners and at the widest points so as to be clearly visible to traffic. Whenever long loads are transported with pole dolly or steering dolly, warning flags shall be attached to the underside of the load spaced no more than 20 feet apart. At night, amber lenses lights, visible at least 500 feet, must be used in place of the required flags, except on the rear where light must be red.
7. **USE OF SIGNS** – When escort vehicle (s) are required, “Wide Load” and “Long Load” signs must be used and be at least 12 inches wide by 60 inches long, with 8 inch high, series C with 1 and 5/8 inch stroke or larger, black letters on a yellow background. An Oversize Load sign is the required wording for all signs used on the towing vehicle and trailed vehicle or load. The Oversize Load sign must be at least 18 inches by 84 inches with 10 inch series C, 1 and 5/8 inch stroke or larger, black letters on yellow. Sign must face oncoming traffic, be mounted at least 5 feet above the road on the towing vehicle, rear of the trailed vehicle or load, and escort(s). Wide Load or Oversize Load signs to be used with all vehicles or loads exceeding 10 feet 6 inches in width. Signs must be lighted and legible at least 500 feet for all night moves. Whenever signs are required, tow disc type 4 inch diameter lights showing amber to the front and amber or red to the rear must be mounted at least 20 inches above the ground as far apart as practical. These lights must flash simultaneously at rate of 60 to 90 flashes per minute and be visible at least 500 feet. Signs shall not extend beyond the line of the fenders on the left side nor more than 6 inches beyond fender line on the right side of the escort vehicle. When escorts are used, escorts and permitted rig(s) must have radio communication.
8. **BRAKE REQUIREMENTS** - All requirements relating to brakes and method of use must be compiled with in accordance with State Law.
9. **HITCHES** – The trailers, towed vehicles and equipment are to be hitched in such manner so they will track on turns and do not whip while being towed.
10. **TOWING EQUIPMENT** – The trailers, towed vehicles, and equipment are to be hitched in such manner so they will track on turns and not whip while being towed. It is the responsibility of the permittee that the towing vehicle is adequate and safe to handle the movement.
11. **TIRE LIMIT** - This permit does not allow any tire to exceed 500 pounds per inch of tire width (600 pounds per inch for foremost and rearmost steering axles) or the manufacturers rating, whichever is less.
12. **SPECIAL WHEELS, EQUIPMENT, ETC.** – A vehicle equipped with cleats, blocks, studs, spikes or a flange which will damage road surfaces, and steel tired vehicles on bituminous surfaces, except in case of emergency, is not authorized for movement.
13. **DIVISIBLE LOADING** – An over legal dimension and/or weight load which is divisible to legal dimensions and/or weight is not authorized for movement.
14. **LEGAL DIMENSION LIMITATIONS** – A permit for movement is required if the following legal limitations are exceeded by equipment and/or vehicles including load: maximum overall width – 8’; maximum overall height - 13’6”; maximum overall length (single) – 40’ (mobile truck cranes – 48’); Semitrailer - 53 feet with kingpin setting of 43 feet or less, and single trailer including tow bar - 45 feet. A trailer is limited to 45 feet long with 75 feet the maximum over length of a truck trailer combination.
15. **LEGAL GROSS WEIGHT LIMITATION** - A permit for overweight is required if any of the following weights are exceeded: 1. A single axle load exceeds 18,000 pounds on a 9-ton route; 2. A single axle load exceeds 20,000 pounds on a 10-ton route; 3. A tandem weight exceeds 34,000 pounds on either a 9 or 10 ton route; 4. Gross weights over 80,000 pounds; 5. Anytime the Minnesota axle weight limitations are exceeded in statute 169.824.
16. **License Plate, Motor Vehicle Registration and Tax Laws** - It shall be the permittee's responsibility to comply with the requirement to increase the registered gross weight of the vehicles license plates if needed. Registration information is available at the local motor vehicle registrar's offices or the state of Minnesota at (651) 296-6911.
17. **RESPONSIBILITY FOR STRUCTURES AND CLEAN-UP** – The permittee shall comply with all regulations posted on any structure over under which he (they) shall travel, and shall assume all risks. When tracked equipment or machinery is moving under its own power over asphaltic surface bridges, or railroad crossing, running planks of sufficient strength to protect the surface must be placed under the tracks and removed upon completion of such a crossing.
18. **LIABILITY FOR DAMAGE** – As set forth in Minn. Stat. §169.88 (c), the permittee is liable for damages to the road, street, or highway that occurs as a result of the permittee's willful act (s) or his/her negligence. The permittee is responsible for all liability for personal injury, property damage, or time lost, which may occur in relation to the movement and in the event any claim is made against the County of Murray or any employee thereof through, by reason of or in connection with any act or omission; permittee shall defend, indemnify and hold them harmless from any claim.
19. **REPAIR OF DAMAGE** – In accepting this permit, the permittee agrees to repair at his (their) own expense and to the satisfaction of the Murray County Engineer any damage to highways or structures. Work or repair may be done by Highway Department forces at the option of the Murray County Engineer and the cost of such work to be borne by the permittee.
20. **OTHER JURISDICTION** – Authorization for movement over streets and roads, other than those under the jurisdiction of the Murray County Highway Department must be obtained from the authorities under whose jurisdiction such roads and streets come.

SKETCH

IMPORTANT! Please sketch the truck/tractor and trailer showing the number of axles as well as the loads on each of the axles. Show the dimensions between all axles.

Important! Enter the Gross Weight for the load and the hauling units. _____ Pounds

Enter the axle weights in the boxes below. The gross weight above will be calculated automatically.

ALL BOXES IN RED ARE REQUIRED TO BE FILLED IN. ENTER A ZERO IN ANY UNUSED AXLE.

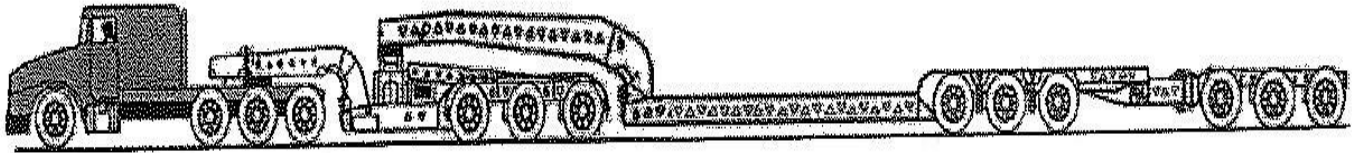

POSTED BRIDGES

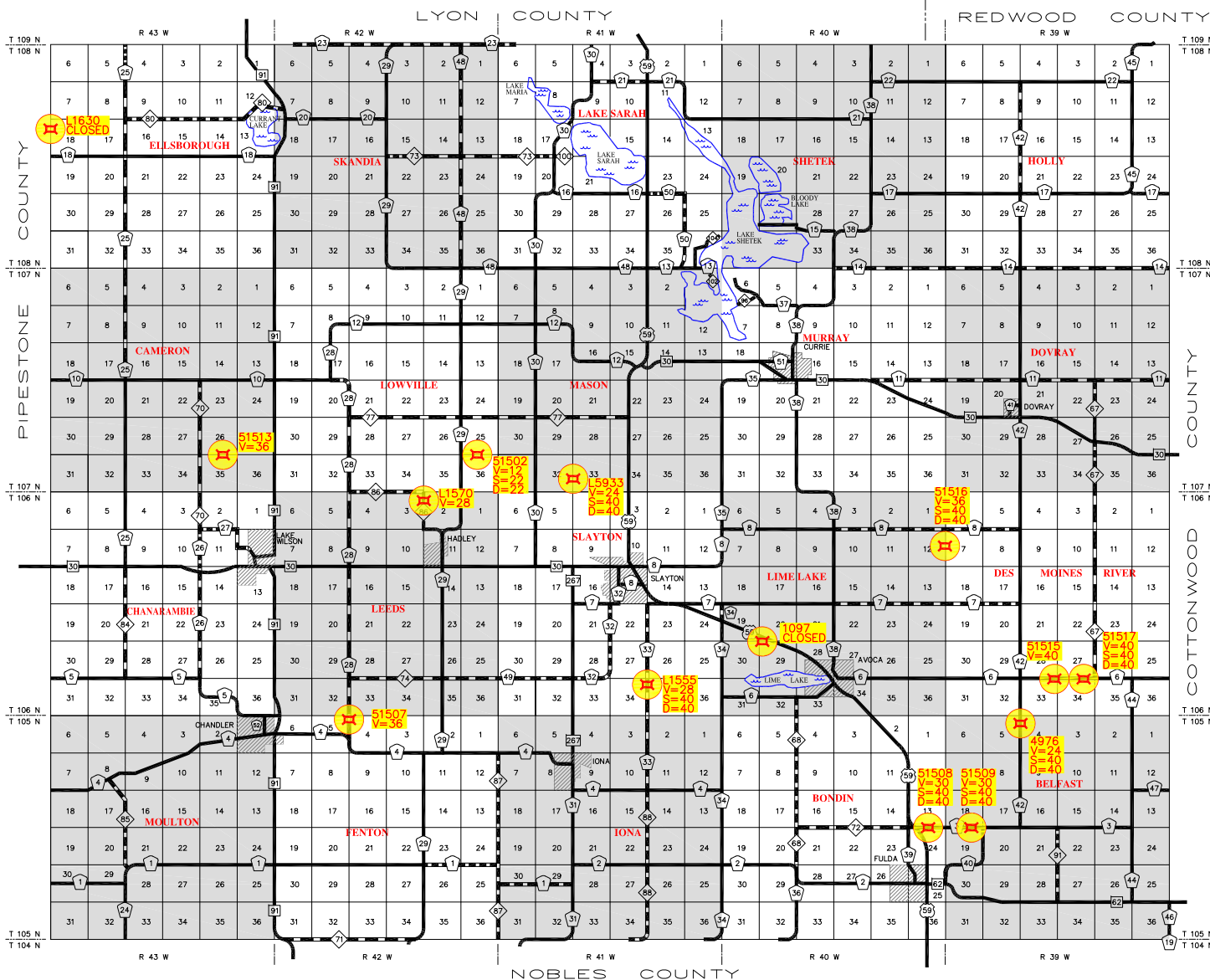

Posted Bridges						
Road	Jurisdiction	Bridge	V	S	D	Signs
CSAH 3	COUNTY	51508	30	40	40	
CSAH 3	COUNTY	51509	30	40	40	
CSAH 6	COUNTY	51515	40			
CSAH 6	COUNTY	51517	40	40	40	
CSAH 28	COUNTY	51507	36			
CSAH 33	COUNTY	L1555	28	40	40	
CSAH 42	COUNTY	4976	24	40	40	
C.R. 86	COUNTY	L1570	28			
81st ST	LIME LAKE	1097				CLOSED
240th AVE	DES MOINES RIVER	51516	36	40	40	
131st ST	CAMERON	51513	36			
131st ST	LOWVILLE	51502	12	22	22	
CTY LINE AVE	ELLSBOROUGH	L1630				CLOSED
140th AVE	MASON	L5933	24	40	40	

V = Vehicle
S = Semi
D = Double

