

2024 MURRAY COUNTY ROAD RESTRICTION AND POSTED BRIDGES

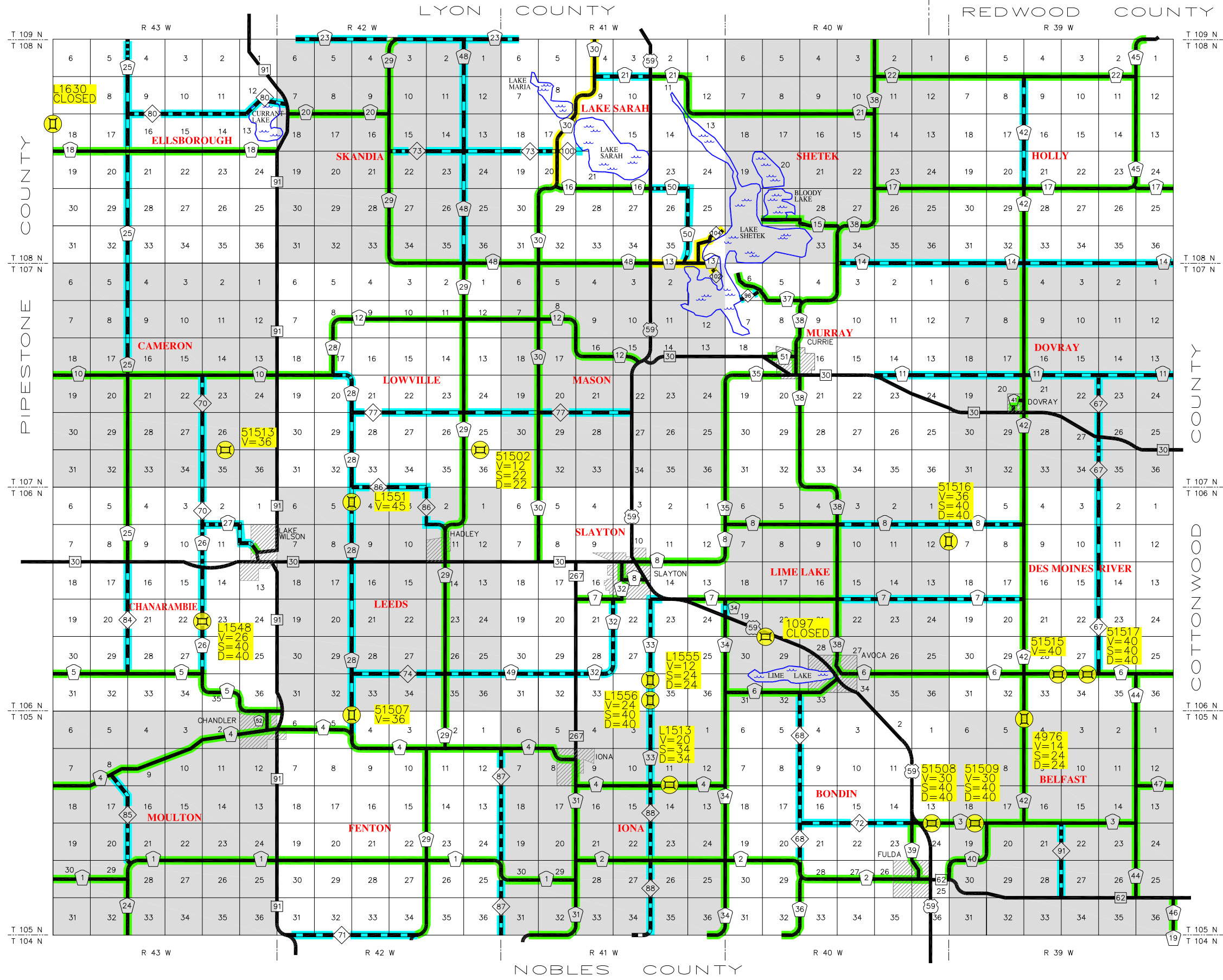

- COUNTY ROAD - GRAVEL
- COUNTY STATE AID HIGHWAY - GRAVEL
- COUNTY STATE AID HIGHWAY - BITUMINOUS
- STATE HIGHWAY - BITUMINOUS
- US HIGHWAY - BITUMINOUS

- 9 TON
- 7 TON
- 5 TON

LAKE WILSON

CURRIE

HADLEY

DOVRAY

SLAYTON

AVOCA

IONA

BELCAST

CHANDLER

FULDA