

CERTIFICATE OF LOCATION OF GOVERNMENT CORNER

S 1/4 Corner of Section 33, Township 101 N, Range 30 W, 5TH P.M.
STATE OF MINNESOTA, County of MARTIN

At the corner location shown on the sketch:

- On 5-29-96 found a STONE WITH RAIL ROAD SPIKE
DATE 5" DEEP
- left monument as found, lowered monument, removed monument (explain)
- On 5-29-96 placed a DRILLED HOLE IN HIGHEST POINT
DATE OF STONE SET 5/8" X 24" I.R. WITH ALUM. CAP 5" DEEP

SKETCH OF REFERENCE TIES

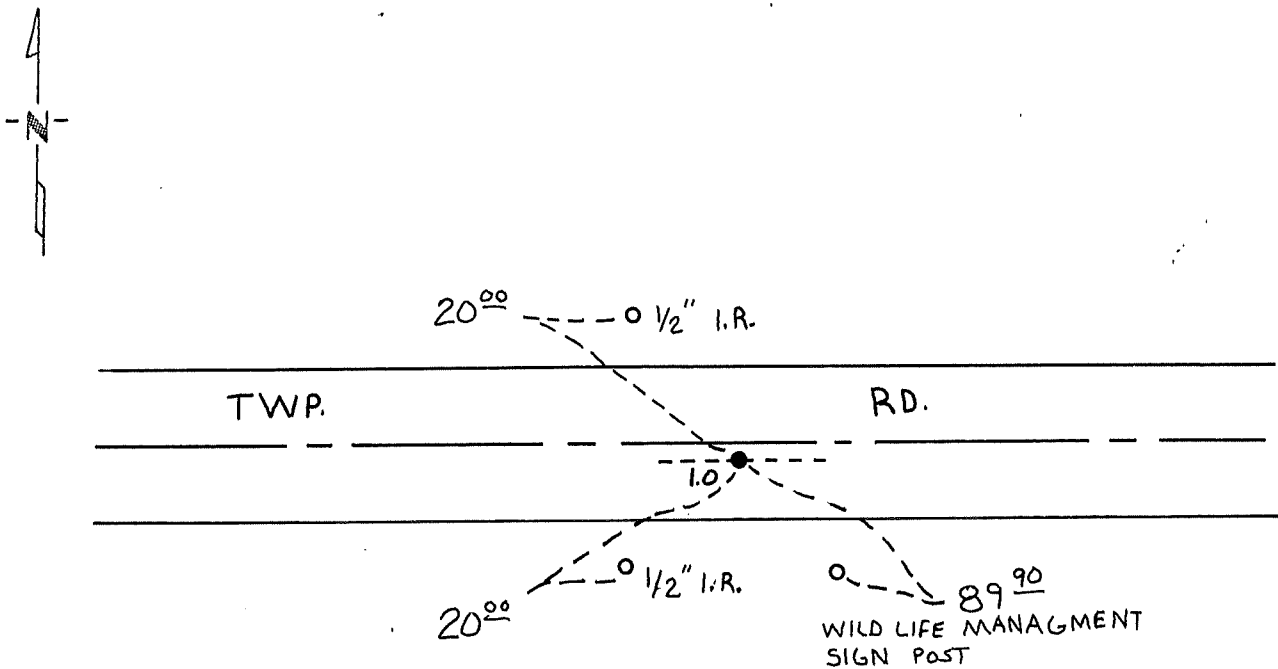

Statement of evidence relative to this corner location is on back of page.

I hereby certify that this document and the data contained herein was prepared by me or under my direct supervision.

SIGNATURE DATE

Registration No. _____

- Land Surveyor, Professional Engineer
- County Surveyor, County Engineer

OFFICE OF THE REGISTER OF DEEDS
County of _____

I hereby certify that this document was filed in the Reg. of Deeds office at _____ .M. on the _____ day of _____ A.D., 19 _____

Register of Deeds _____

By _____, Deputy

DOCUMENT NO. _____