

# CERTIFICATE OF LOCATION OF GOVERNMENT CORNER

CENTER Corner of Section 11, Township 101 N., Range 30 W., 5TH P.M.  
STATE OF MINNESOTA, County of MARTIN

At the corner location shown on the sketch:

- On 7-15-94 found a STONE WITH "+" (11" DEEP).  
DATE
- left monument as found,  lowered monument,  removed monument (explain)
- On 7-7-94 placed a DRILLED HOLE IN STONE "+" & SET 5/8" X 30" IRON MONUMENT  
DATE  
WITH AN ALUMINUM CAP IN HOLE (2" DEEP).

SKETCH OF REFERENCE TIES

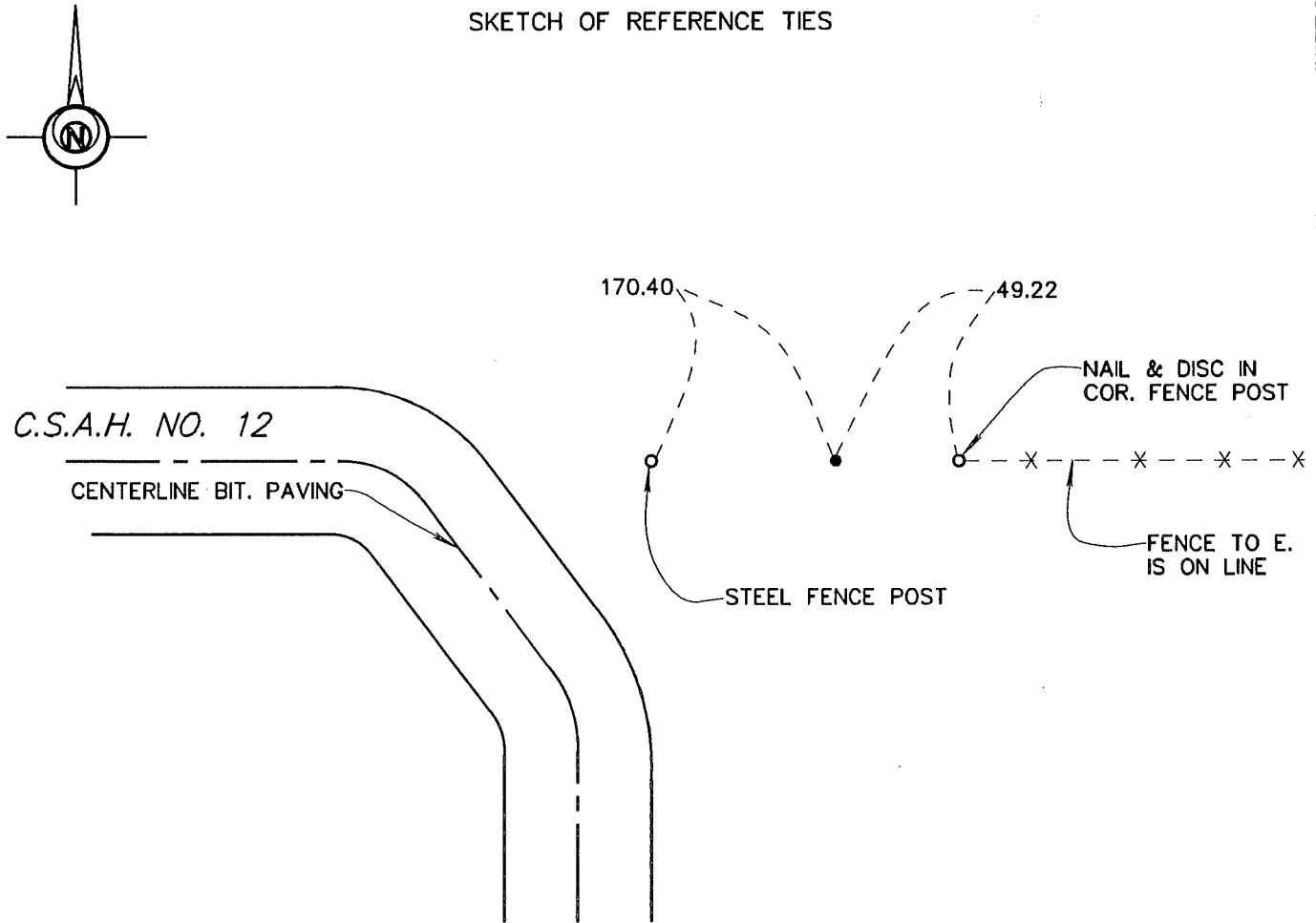

Statement of evidence relative to this corner location is on back of page.

I hereby certify that this document and the data contained herein was prepared by me or under my direct supervision.

John Markson 5/13/96  
SIGNATURE DATE

Registration No. 13593

- Land Surveyor,  Professional Engineer
- County Surveyor,  County Engineer

OFFICE OF THE COUNTY RECORDER  
County of MARTIN

I hereby certify that this document was filed in the Co. Recorders Office at \_\_\_\_\_ M. on the \_\_\_\_\_ day of \_\_\_\_\_ A.D., 19\_\_\_\_.

County Recorder \_\_\_\_\_

By \_\_\_\_\_, Deputy

DOCUMENT NO. \_\_\_\_\_

**Gen., Sec. 11, T. 101 N., R. 30 W.  
(Silver Lake Twp)**

**Statement of Evidence**

The Martin County Highway Dept. Tie Records indicate the corner was a 1" iron pipe under a stone "+" (20" deep), with a R.R. Spk over stone (12" deep). Ties - 19.1 N = Hub & Lath near RP Post, 27.9 NW = Hub & Lath near RP Post

On July 15, 1994, I found a stone "+" (18" deep). Drilled hole in stone and set a 5/8" x 30" iron rod with alum. cap over stone (2" deep)

The History shown was obtained from the Martin County Highway Dept. Tie Records and existing Certificates of Location, only. Further History information may be obtained from the Martin County Recorder.