

CERTIFICATE OF LOCATION OF GOVERNMENT CORNER

EAST QUARTER Corner of Section 10, Township 101 N., Range 30 W., 5TH P.M.

STATE OF MINNESOTA, County of MARTIN

At the corner location shown on the sketch:

- On 7-15-94 found a RAILROAD SPIKE IN THE BITUMINOUS PAVING (SURFACE).
DATE
- left monument as found, lowered monument, removed monument (explain)
- On 7-15-94 placed a REPLACED RAILROAD SPIKE WITH A 5/8" X 24" IRON MONUMENT
DATE
WITH AN ALUMINUM CAP (SURFACE).

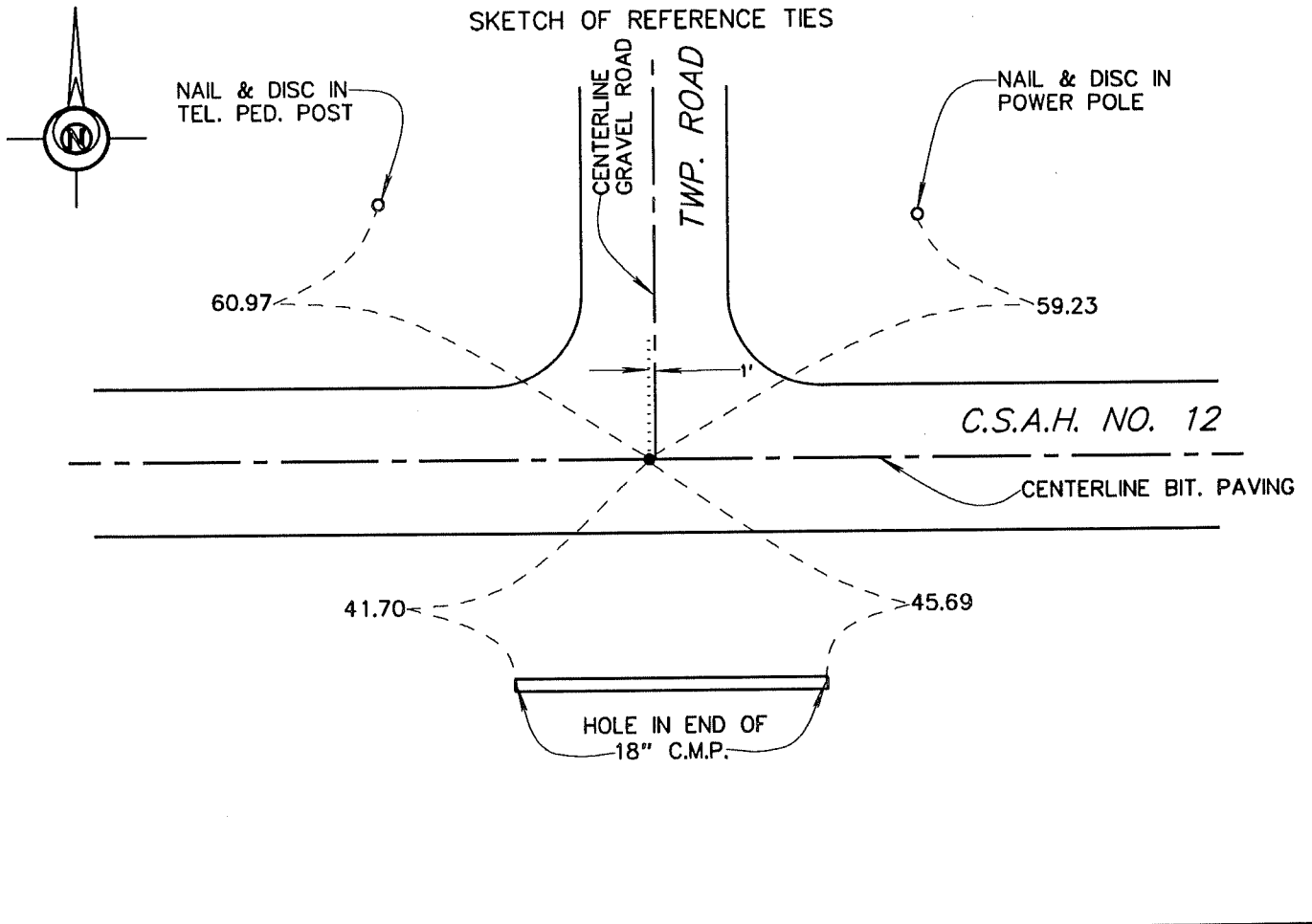

Statement of evidence relative to this corner location is on back of page.

I hereby certify that this document and the data contained herein was prepared by me or under my direct supervision.

John Madson 5/13/96
SIGNATURE DATE

Registration No. 13593
 Land Surveyor, Professional Engineer
 County Surveyor, County Engineer

OFFICE OF THE COUNTY RECORDER
County of MARTIN

I hereby certify that this document was filed in the Co. Recorders Office at _____ .M. on the _____ day of _____ A.D., 19____.

County Recorder _____
By _____, Deputy
DOCUMENT NO. _____

E. 1/4 Cor. Sec. 10, T. 101 N., R. 30 W.
(Silver Lake Twp)

Statement of Evidence

The corner was originally established during the Public Land Survey of 1854, by Oswald Brunius.

According to the recorded Certificate of Location, Doc. No. 251676 Date, April, 1963, the corner was a stone "+" (12" deep), with a 1/2" iron pin over stone (surface)

The Martin County Highway Dept. Tie Records indicate the corner was a stone "+" (?), with a R.R. Spk (21" deep), with a R.R. Spk over Spk (surface). Ties - 100.0 N = 60d Spk in Twp Road, 100.0 S = 60d Spk in Farm Ent.

On July 15, 1994, I found a R.R. Spk in bit. paving. Replaced R.R. Spk with a 5/8" x 24" iron rod with alum. cap.

The History shown was obtained from the Martin County Highway Dept. Tie Records and existing Certificates of Location, only. Further History information may be obtained from the Martin County Records Office.