

CERTIFICATE OF LOCATION OF GOVERNMENT CORNER

PLEASANT MOUND NORTH EDGE OF NASHVILLE

SOUTH-EAST COR Corner of Section 36, Township T 105 Range R 29 W, 5th P.M.

STATE OF MINNESOTA, County of MARTIN Blue Earth

At the corner location shown on the sketch:

- On \_\_\_\_\_ found a \_\_\_\_\_  
DATE
- left monument as found,  lowered monument,  removed monument (explain)
- On 7-18-97 Placed a 5/8" X 24" I.R. W/ALUM. CAP IN ACCORDANCE  
DATE WITH BLUE-EARTH CO. HWY. PLANS

SKETCH OF REFERENCE TIES

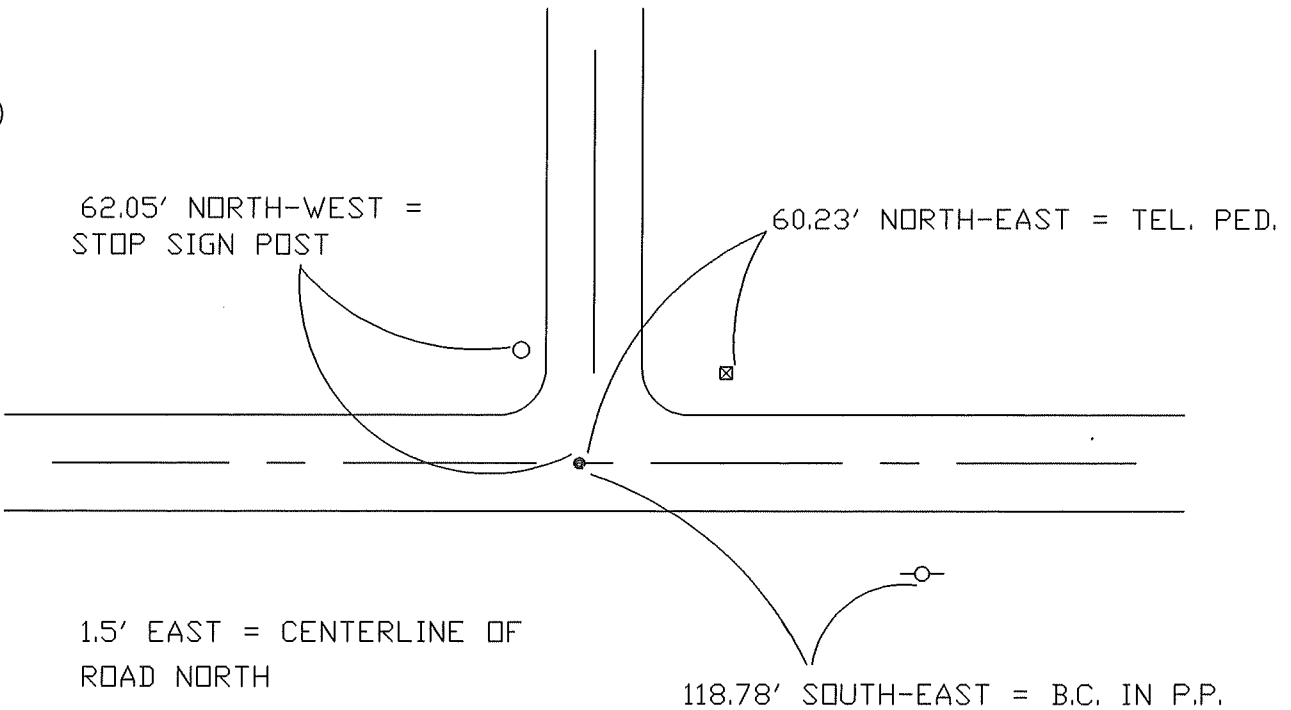

Statement of evidence relative to this corner location is on back of page.

I hereby certify that this document and the data contained herein was prepared by me or under my direct supervision.

\_\_\_\_\_  
SIGNATURE DATE

Registration No. \_\_\_\_\_

- Land Surveyor,  Professional Engineer
- County Surveyor,  County Engineer

OFFICE OF THE REGISTER OF DEEDS  
County of MARTIN

I hereby certify that this document was filed in the Reg. of Deeds office at \_\_\_\_\_M. on the

\_\_\_\_\_day of \_\_\_\_\_A.D., 19\_\_\_\_  
Register of Deeds \_\_\_\_\_

By \_\_\_\_\_, Deputy  
DOCUMENT NO. \_\_\_\_\_