

CERTIFICATE OF LOCATION OF GOVERNMENT CORNER
 PLEASANT MOUND NORTH EDGE OF NASHVILLE
 SOUTH-EAST COR SEC. 32, Township T 105 N, Range R 29 W, 5th P.M.

STATE OF MINNESOTA, County of MARTIN - Blue Earth Line

At the corner location shown on the sketch:

- On 5-8-97 found a NAIL (3" DEEP)
DATE
- left monument as found, lowered monument, removed monument (explain)
- On 5-8-97 Placed a 5/8' X 24" I.R. W/ALUM CAP (4" DEEP)
DATE

SKETCH OF REFERENCE TIES

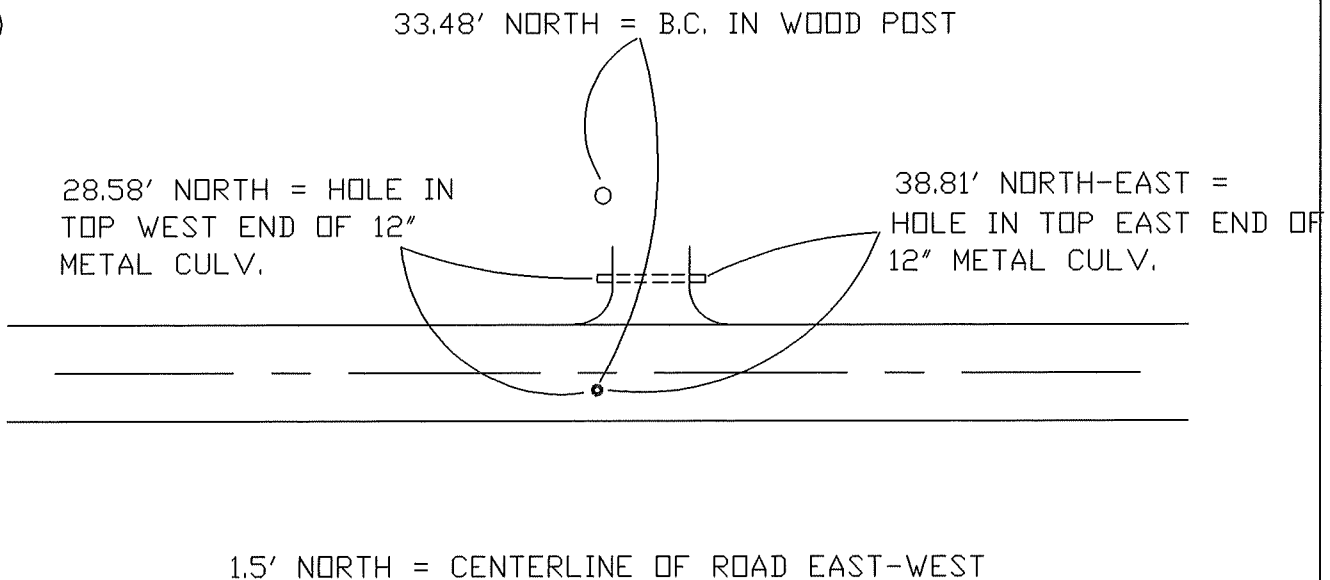

Statement of evidence relative to this corner location is on back of page.

I hereby certify that this document and the data contained herein was prepared by me or under my direct supervision.

SIGNATURE DATE

Registration No. _____

- Land Surveyor, Professional Engineer
- County Surveyor, County Engineer

OFFICE OF THE REGISTER OF DEEDS
 County of MARTIN

I hereby certify that this document was filed in the Reg. of Deeds office at _____M. on the

_____day of _____A.D., 19____

Register of Deeds _____

By _____, Deputy

DOCUMENT NO. _____