

CERTIFICATE OF LOCATION OF GOVERNMENT CORNER

Nashville

South 1/4 Cor. _____ Corner of Section 24, Township T 104 N, Range R 29 W 5th P.M.

STATE OF MINNESOTA, County of MARTIN

At the corner location shown on the sketch:

- On 5-13-97 found a 3/4" x 18" I.P.
DATE
- left monument as found, lowered monument, removed monument (explain)
- On 5-13-97 Placed a 5/8" x 24" I.P. w/alum cap (3" Deep)
DATE

SKETCH OF REFERENCE TIES

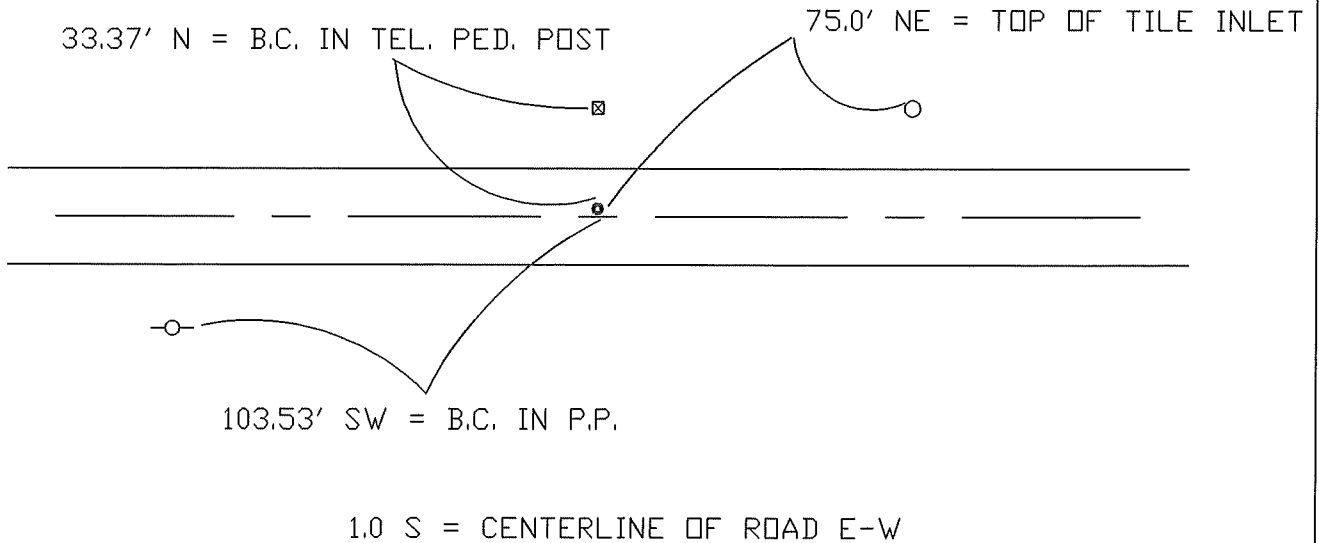

Statement of evidence relative to this corner location is on back of page.

I hereby certify that this document and the data contained herein was prepared by me or under my direct supervision.

SIGNATURE DATE

Registration No. _____

- Land Surveyor, Professional Engineer
- County Surveyor, County Engineer

OFFICE OF THE REGISTER OF DEEDS
County of MARTIN

I hereby certify that this document was filed in the Reg. of Deeds office at _____ M. on the

_____ day of _____ A.D., 19____

Register of Deeds _____

By _____, Deputy

DOCUMENT NO. _____