

CERTIFICATE OF LOCATION OF GOVERNMENT CORNER

NASHVILLE TWP.

~~SOUTH QUARTER~~

~~South East Quarter~~ Corner of Section 11, Township 104N, Range 29W, 5th P.M.

STATE OF MINNESOTA, County of MARTIN

At the corner location shown on the sketch:

On 6-3-97 found a Stone "+" (16" Deep), Drilled hole in stone.
DATE

left monument as found, lowered monument, removed monument (explain)

On 6-3-97 placed a 5/8"* 24" I.R. W/Alum. Cap Over Stone (4" Deep).
DATE

SKETCH OF REFERENCE TIES

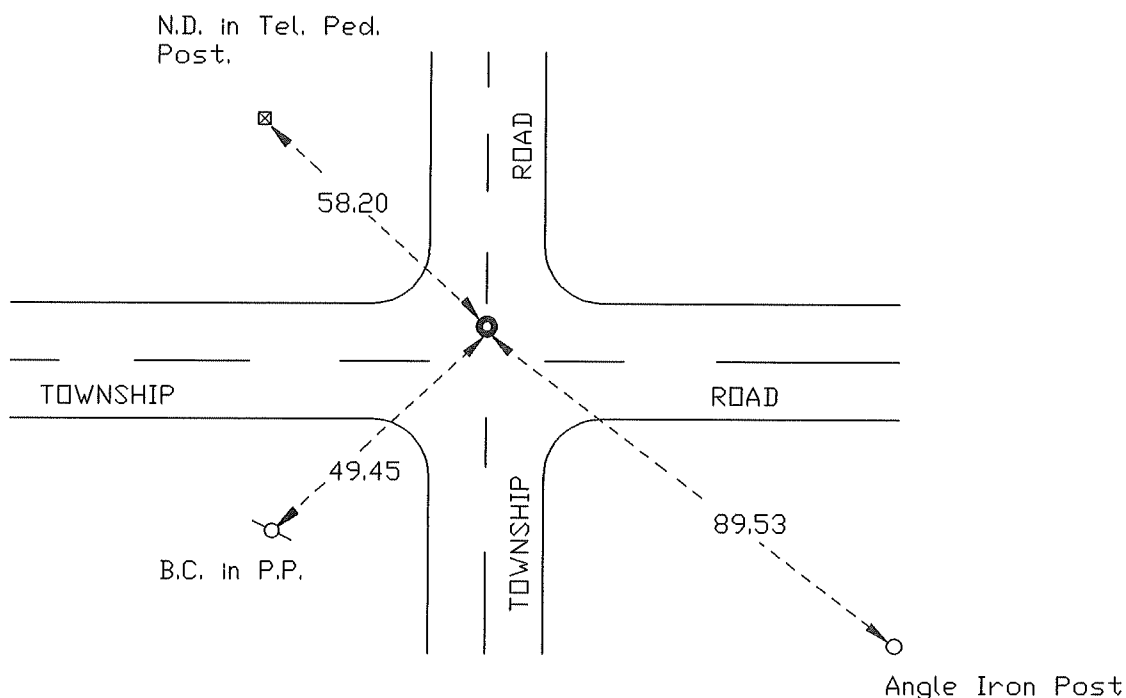

Statement of evidence relative to this corner location is on back of page.

I hereby certify that this document and the data contained herein was prepared by me or under my direct supervision.

SIGNATURE DATE

Registration No. _____

- Land Surveyor, Professional Engineer
- County Surveyor, County Engineer

OFFICE OF THE REGISTER OF DEEDS
County of MARTIN

I hereby certify that this document was filed in the Reg. of Deeds office at

_____.M. on the

____ day of _____ A.D., 19____

Register of Deeds _____

By _____, Deputy

DOCUMENT NO. _____