

CERTIFICATE OF LOCATION OF GOVERNMENT CORNER

NASHVILLE TWP.

NORTH QUARTER Corner of Section 1, Township 104N, Range 29W, 5th P.M.

STATE OF MINNESOTA, County of MARTIN

At the corner location shown on the sketch:

- On 7-18-97 found a _____
DATE
- left monument as found, lowered monument, removed monument (explain)
- On 7-18-97 Placed a 5/8" x 24" IRON ROD WITH ALUMINUM CAP IN
DATE
ACCORDANCE WITH BLUE EARTH COUNTY HIGHWAY PLANS

SKETCH OF REFERENCE TIES

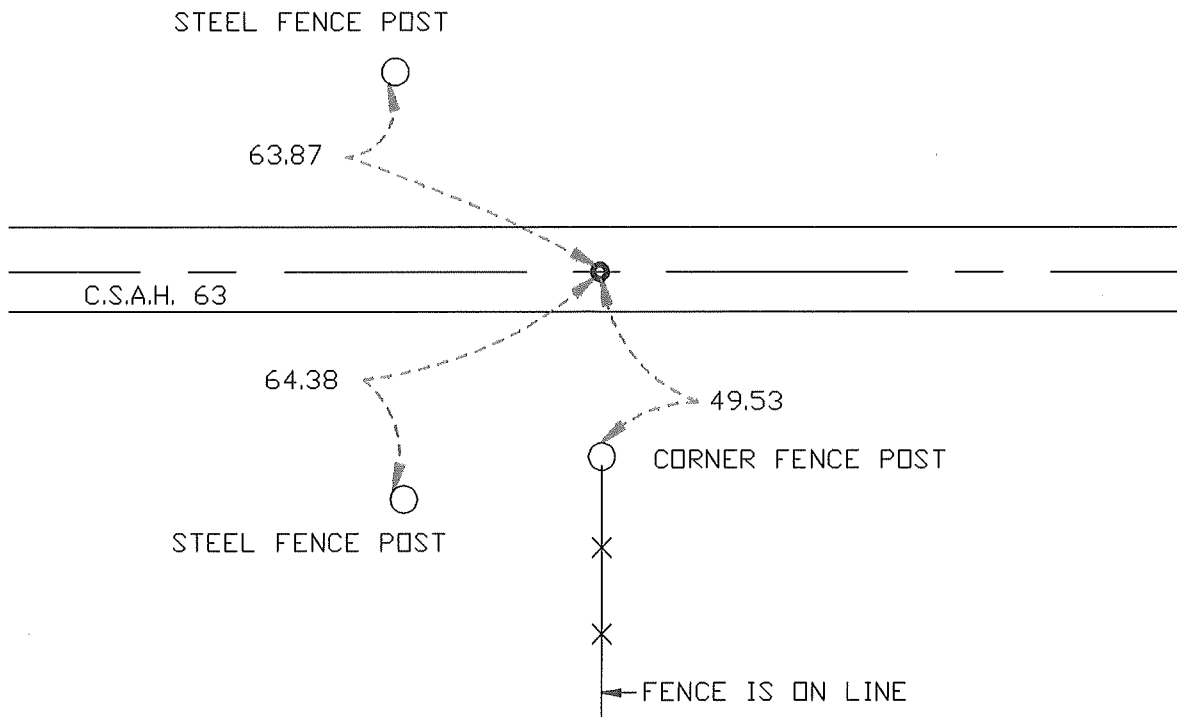

Statement of evidence relative to this corner location is on back of page.

I hereby certify that this document and the data contained herein was prepared by me or under my direct supervision.

SIGNATURE DATE

Registration No. _____

- Land Surveyor, Professional Engineer
- County Surveyor, County Engineer

OFFICE OF THE REGISTER OF DEEDS

County of _____

I hereby certify that this document was filed in the Reg. of Deeds office at

_____M. on the

_____day of _____A.D., 19____

Register of Deeds _____

By _____, Deputy

DOCUMENT NO. _____