

# CERTIFICATE OF LOCATION OF GOVERNMENT CORNER

MANYASKA

SOUTH 1/4 Corner of Section 8, Township T102N, Range R32W, 5th P.M.

STATE OF MINNESOTA, County of MARTIN

At the corner location shown on the sketch:

- On 3-2-00 found a SQUARE IRON ROD OVER STONE (16" DEEP)  
DATE
- left monument as found,  lowered monument,  removed monument (explain)
- On 3-2-00 Placed a DRILLED A HOLE IN STONE & SET A 5/8" X 24"  
DATE  
IRON ROD W/ALUM. CAP OVER STONE ( 4" DEEP )

## SKETCH OF REFERENCE TIES

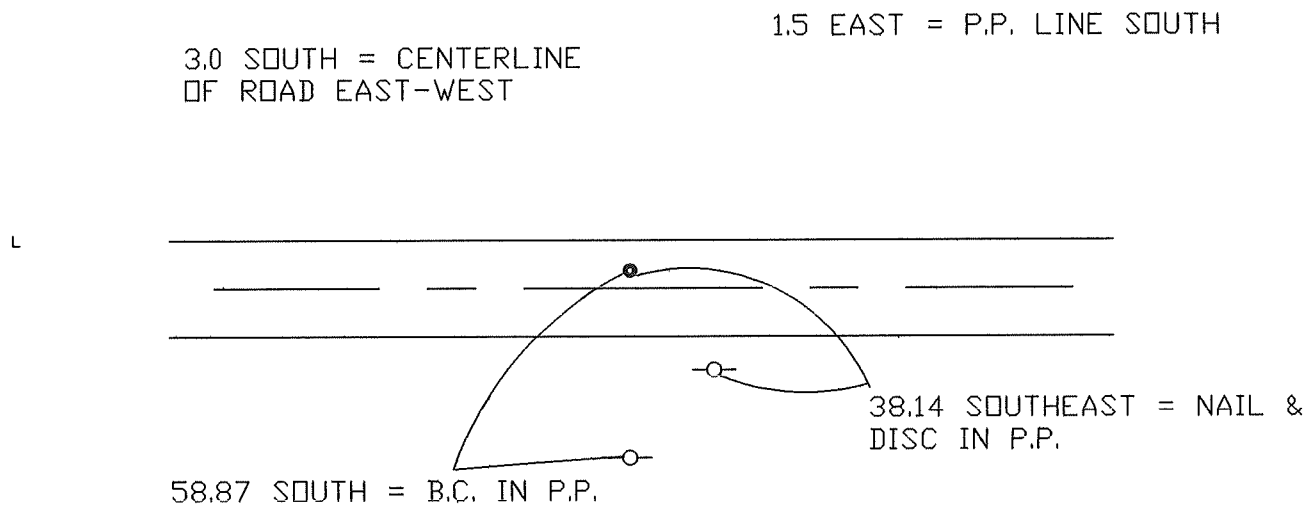

Statement of evidence relative to this corner location is on back of page.

I hereby certify that this document and the data contained herein was prepared by me or under my direct supervision.

\_\_\_\_\_  
SIGNATURE                      DATE

Registration No. \_\_\_\_\_

- Land Surveyor,                       Professional Engineer
- County Surveyor,                       County Engineer

OFFICE OF THE REGISTER OF DEEDS  
 County of MARTIN

I hereby certify that this document was filed in the Reg. of Deeds office at \_\_\_\_\_, M. on the

\_\_\_\_\_ day of \_\_\_\_\_, A.D., 19\_\_\_\_  
 Register of Deeds \_\_\_\_\_

By \_\_\_\_\_, Deputy  
 DOCUMENT NO. \_\_\_\_\_