

CERTIFICATE OF LOCATION OF GOVERNMENT CORNER

MANYASKA

EAST 1/4 _____ Corner of Section 7, Township T102-N, Range R32W, 5th P.M.

PER 1893 & 1944 SURVEY

STATE OF MINNESOTA, County of MARTIN

At the corner location shown on the sketch:

- On 10-4-00 found a BRICK + (7" DEEP) PER 1901 SURVEY
DATE
- left monument as found, lowered monument, removed monument (explain)
- On _____ Placed a IRON ROD W/ALUM. CAP (SURFACE)
DATE

SKETCH OF REFERENCE TIES

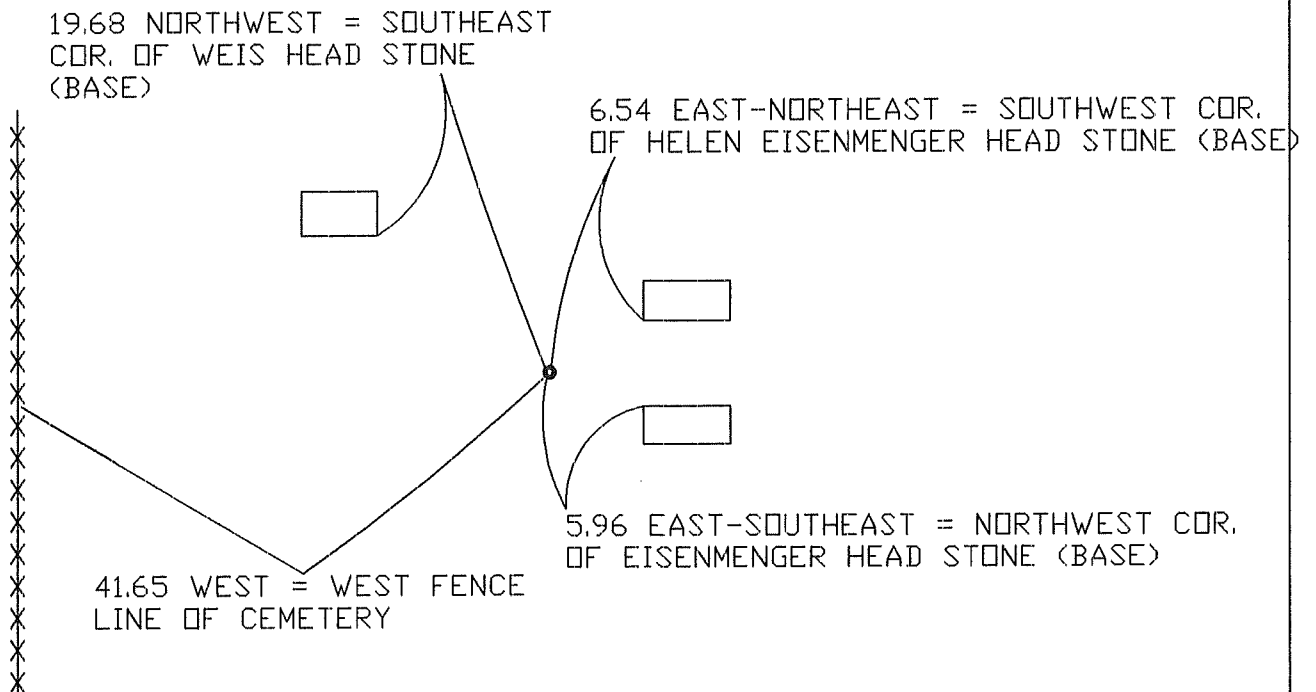

Statement of evidence relative to this corner location is on back of page.

I hereby certify that this document and the data contained herein was prepared by me or under my direct supervision.

SIGNATURE DATE

Registration No. _____

- Land Surveyor, Professional Engineer
- County Surveyor, County Engineer

OFFICE OF THE REGISTER OF DEEDS
 County of MARTIN

I hereby certify that this document was filed in the Reg. of Deeds office at _____M. on the

_____ day of _____ A.D., 19____

Register of Deeds _____

By _____, Deputy

DOCUMENT NO. _____