

# CERTIFICATE OF LOCATION OF GOVERNMENT CORNER

MANYASKA

SOUTH 1/4 Corner of Section 34, Township T-102 N, Range R32W, 5th P.M.

STATE OF MINNESOTA, County of MARTIN

At the corner location shown on the sketch:

On \_\_\_\_\_ found a \_\_\_\_\_  
DATE

left monument as found,  lowered monument,  removed monument (explain)

On 10-26-00 Placed a SET AN IRON ROD W/ALUM. CAP AT THE INTERSECTION  
DATE  
OF THE NORTH-SOUTH LINE AS DETERMINED IN 1891 AND STRAIGHT LINE  
BETWEEN SOUTHEAST & SOUTHWEST CORNERS

### SKETCH OF REFERENCE TIES

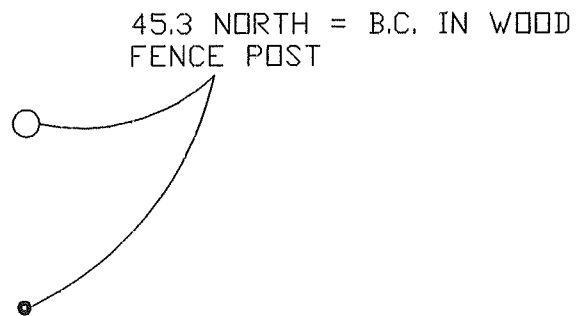

Statement of evidence relative to this corner location is on back of page.

I hereby certify that this document and the data contained herein was prepared by me or under my direct supervision.

\_\_\_\_\_  
SIGNATURE DATE

Registration No. \_\_\_\_\_

- Land Surveyor,  Professional Engineer
- County Surveyor,  County Engineer

OFFICE OF THE REGISTER OF DEEDS  
 County of MARTIN

I hereby certify that this document was filed in the Reg. of Deeds office at \_\_\_\_\_ M. on the

\_\_\_\_\_ day of \_\_\_\_\_ A.D., 19\_\_\_\_  
 Register of Deeds \_\_\_\_\_

By \_\_\_\_\_, Deputy  
 DOCUMENT NO. \_\_\_\_\_