

CERTIFICATE OF LOCATION OF CORNER

Reference Southeast Corner of Section ~~33~~ 33, Township 102N, Range 32W, 5 P.M.

STATE OF MINNESOTA, County of Martin

At the corner location shown on the sketch:

On Nov. 1996 found a Stone with Cross & Metal (6"Deep)
DATE

left monument as found, lowered monument, removed monument (explain)

On _____ placed a _____
DATE

SKETCH OF REFERENCE TIES

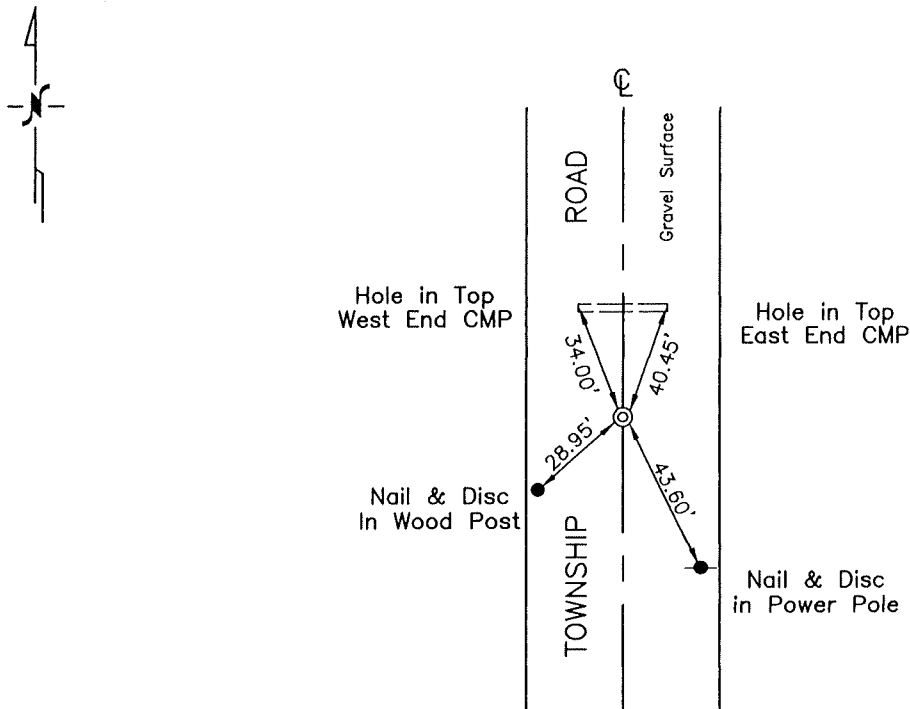

Statement of evidence relative to this corner is on the back of page.

I hereby certify that this document and the data contained herein was prepared by me or under my direct supervision.

SIGNATURE DATE

Registration No. 13309

- Land Surveyor, Professional Engineer
 County Surveyor, County Engineer

OFFICE OF THE COUNTY RECORDER
County of _____

I hereby certify that this document was filed in the Co. Recorders office at _____ P.M. on the _____ day of _____ A.D., 19__

County Recorder _____

By _____, Deputy

DOCUMENT NO. _____

Statement of Evidence

REFERENCE SOUTHEAST CORNER OF SECTION 33, T102N, R 32W

The Public Land Survey of the North line of Township 101 North, Range 32 West of Fifth Principal Meridian was run in 1857. The Northwest corner of Section 3 was in lake and not established.

In October, 1891, County Surveyor C.T. Montgomery (Survey No. 87-B-129) showed the corner in water.

In October, 1927, Deputy County Surveyor George E. Sawyer (Survey No. 234-F-81 1/2) established the corner with a grey granite stone with a chiseled cross on line between Meander Corner 31 and Meander Corner 10. North-South position computed to conform to PLS lot areas. Corner is 1044 feet north of M.C. No. 10 and 410.9 feet south of M.C. No. 31 by this survey. Comes about 16.5 feet south of south side ditch cut.

In July, 1977, Martin County Highway Department ties show a stone with a chiseled cross found with a 1" steel rod on north side.

In December, 1987, Madsen Land Surveying (Survey No. 87167) located the corner by detecting metal under frozen road in agreement with previous ties, as established in 1929 Survey in County Surveyor's Book F, Page 81.

In August, 1990, Madsen Land Surveying (Survey No. 9099) found a metal rod marking the corner.

In July; 1993, Lyle E. Moseng found an iron next to a stone marking the corner.

In July, 1995, a Bolton & Menk, Inc. survey crew found a stone with a chiseled cross marking the corner.

In May, 1996, Madsen Land Surveying (Survey No. 96058) found a metal rod marking the corner.

In November, 1996, a Bolton & Menk, Inc. survey crew found a stone with a chiseled cross with an iron over it marking the corner.

Analysis of record data and survey measurements support the monumented position as a valid perpetuation of the 1927 Sawyer position and a valid perpetuation of the line between Sections 3 and 34.