

# CERTIFICATE OF LOCATION OF GOVERNMENT CORNER

Center Corner of Section 3, Township 102 N., Range 32 W., 5<sup>th</sup> P.M.

STATE OF MINNESOTA, County of Martin

At the corner location shown on the sketch:

- On 5-1-76 found a 3/4" Iron Pin, 12" Deep  
DATE
- left monument as found,  lowered monument,  removed monument (explain)
- On 8-16-76 placed a R.R. Spike over Pin, "Surface"  
DATE

## SKETCH OF REFERENCE TIES

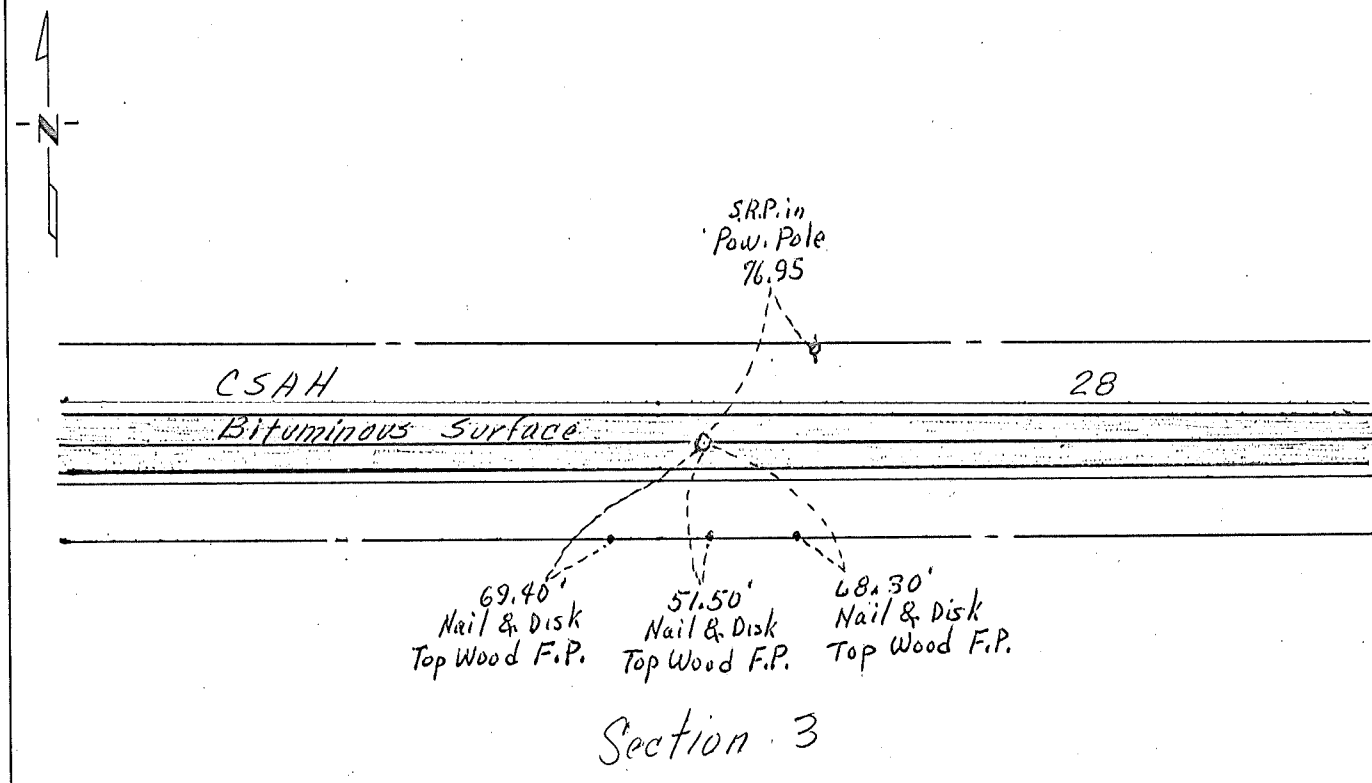

Statement of evidence relative to this corner location is on back of page. (over)

I hereby certify that this document and the data contained herein was prepared by me or under my direct supervision.

\_\_\_\_\_  
SIGNATURE DATE

Registration No. 10,000

Land Surveyor,  Professional Engineer  
 County Surveyor,  County Engineer

OFFICE OF THE COUNTY RECORDER  
County of \_\_\_\_\_

I hereby certify that this document was filed in the Co. Recorders office at \_\_\_\_\_ M. on the \_\_\_\_\_ day of \_\_\_\_\_ A.D., 19 \_\_\_\_\_

County Recorder \_\_\_\_\_  
By \_\_\_\_\_, Deputy

DOCUMENT NO. \_\_\_\_\_

Statement of Evidence:

Stone with "+" Lost during Construction of I 90, 1974,  
Replaced with  $\frac{3}{4}$ " Iron Pin, by the State Highway Dept.,  
Using existing Ties.

J H B  
Martin County Hwy Dept.