

CERTIFICATE OF LOCATION OF GOVERNMENT CORNER

MANYASKA

SOUTHEAST Corner of Section 27, Township T102-N, Range R32W, 5th P.M.

STATE OF MINNESOTA, County of MARTIN

At the corner location shown on the sketch:

On 5-15-00 found a IRON ROD W/ALUM. CAP (4" DEEP)
DATE

left monument as found, lowered monument, removed monument (explain)

On _____ Placed a _____
DATE

SKETCH OF REFERENCE TIES

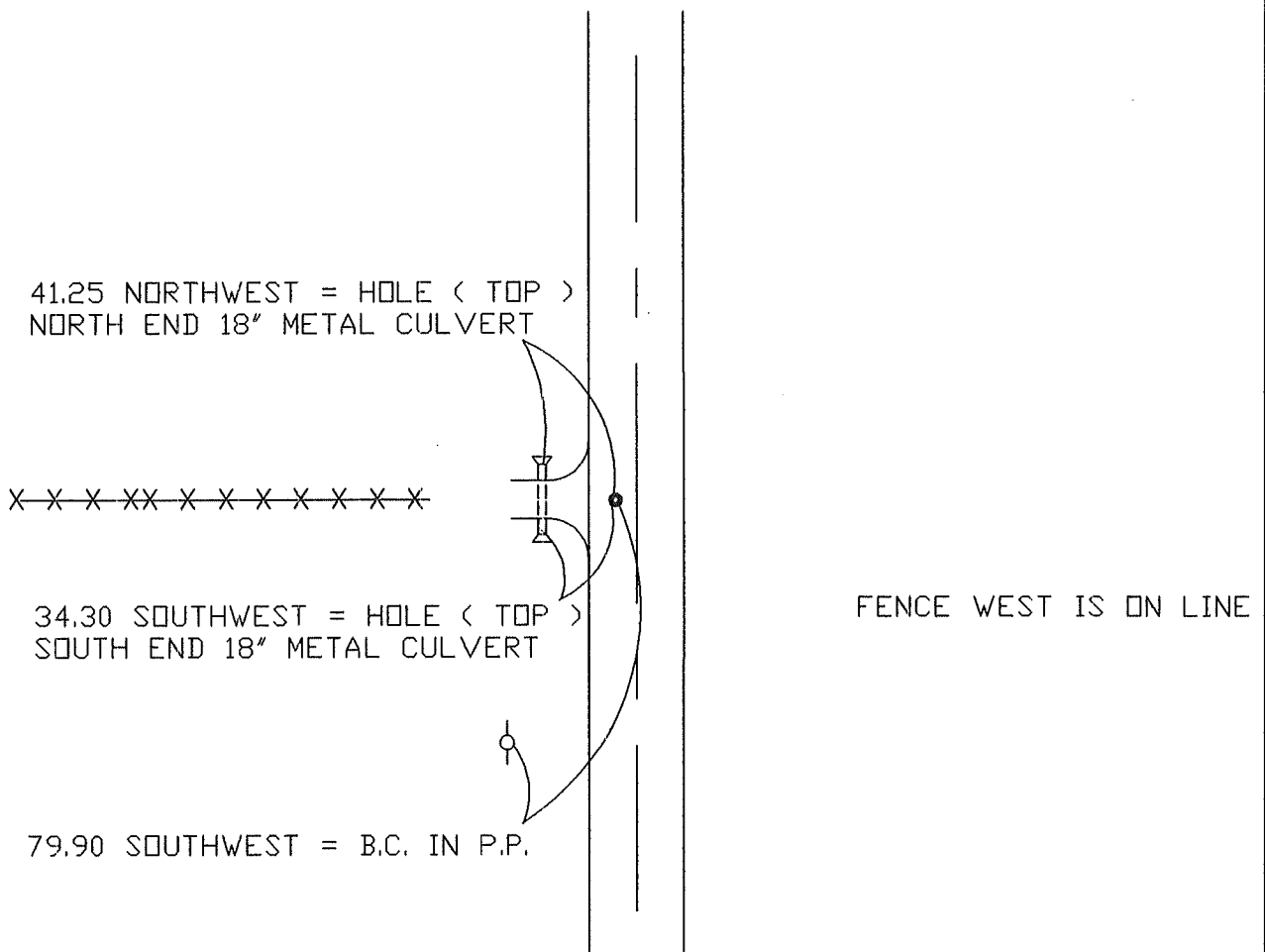

Statement of evidence relative to this corner location is on back of page.

I hereby certify that this document and the data contained herein was prepared by me or under my direct supervision.

SIGNATURE DATE

Registration No. _____

- Land Surveyor, Professional Engineer
- County Surveyor, County Engineer

OFFICE OF THE REGISTER OF DEEDS
County of MARTIN

I hereby certify that this document was filed in the Reg. of Deeds office at _____M. on the

_____ day of _____ A.D., 19_____

Register of Deeds _____

By _____, Deputy

DOCUMENT NO. _____

**S.E. Cor., Sec. 27, T. 102 N., R. 32 W.
(Manyaska Twp)**

Statement of Evidence

The corner was originally established during the Public Land Survey of 1857, by John O. Brunius.

The Martin County Highway Dept. Tie Records indicate the corner was a stone "+" (18" deep), with a 3/4" iron pipe over stone (3" deep) Ties - 85.0 NW = P.P., 78.7 W. = 2nd F.P. W., 0.5 N = Fen. W., 0.2 S = Fen. E.

On June 6, 1994, I found a 3/4" x 12" sq. rod (4" deep). Replaced rod with a 5/8" x 12" iron rod with alum. cap (4" deep)