

CERTIFICATE OF LOCATION OF GOVERNMENT CORNER

MANYASKA

SOUTH 1/4 _____ Corner of Section 26, Township T102-N, Range R32W, 5th P.M.

STATE OF MINNESOTA, County of MARTIN

At the corner location shown on the sketch:

On 10-2-00 found a GLASS DEPOSIT (12" DEEP) AS PER 1897 SURVEY
DATE

left monument as found, lowered monument, removed monument (explain)

On 10-2-00 Placed a IRON ROD WITH ALUM. CAP IN DEPOSIT (PROTRUDING 2")
DATE

SKETCH OF REFERENCE TIES

L

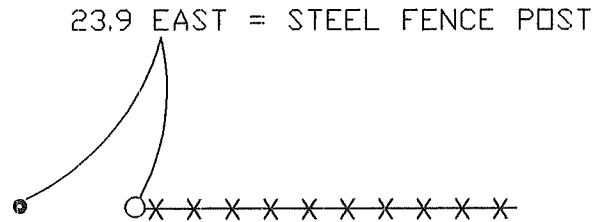

FENCE EAST IS ON LINE

Statement of evidence relative to this corner location is on back of page.

I hereby certify that this document and the data contained herein was prepared by me or under my direct supervision.

SIGNATURE DATE

Registration No. _____

- Land Surveyor, Professional Engineer
- County Surveyor, County Engineer

OFFICE OF THE REGISTER OF DEEDS
County of MARTIN

I hereby certify that this document was filed in the Reg. of Deeds office at _____ M. on the

_____ day of _____ A.D., 19____
Register of Deeds _____

By _____, Deputy
DOCUMENT NO. _____