

CERTIFICATE OF LOCATION OF GOVERNMENT CORNER

MANYASKA

SOUTH 1/4 _____ Corner of Section 22, Township T102N, Range R32W, 5th P.M.

STATE OF MINNESOTA, County of MARTIN

At the corner location shown on the sketch:

- On 10-2-00 found a STONE + (18" DEEP)
DATE
- left monument as found, lowered monument, removed monument (explain)
- On 10-2-00 Placed a IRON ROD ON SOUTH SIDE OF STONE + SET AN
DATE
IRON ROD W/ALUM. CAP OVER STONE (PROTRUDING 6")

SKETCH OF REFERENCE TIES

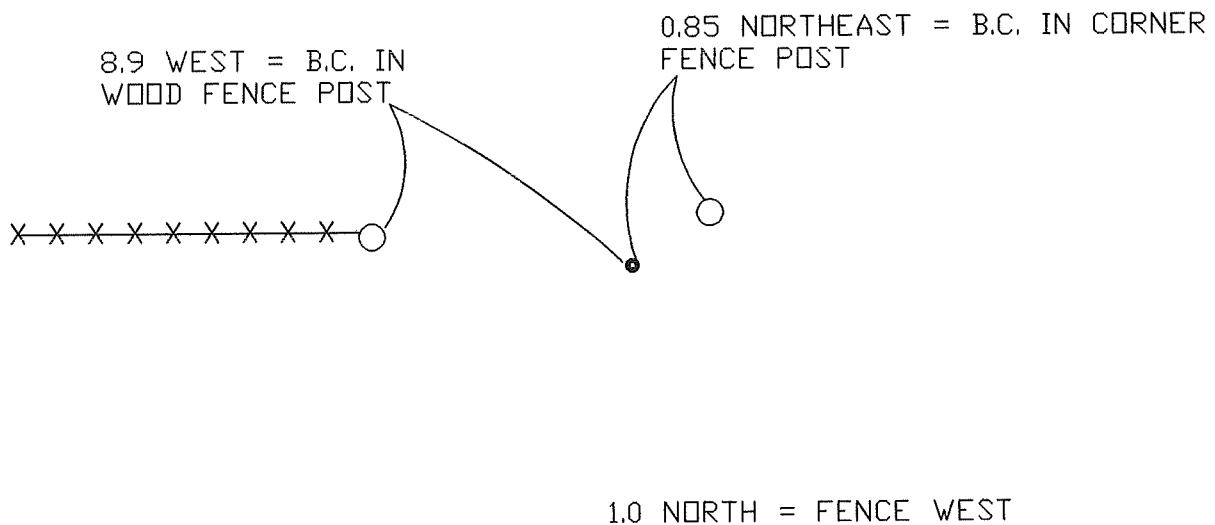

Statement of evidence relative to this corner location is on back of page.

I hereby certify that this document and the data contained herein was prepared by me or under my direct supervision.

SIGNATURE

DATE

Registration No. _____

- Land Surveyor, Professional Engineer
 County Surveyor, County Engineer

OFFICE OF THE REGISTER OF DEEDS
 County of MARTIN

I hereby certify that this document was filed in the Reg. of Deeds office at

_____.M. on the

_____ day of _____ A.D., 19____

Register of Deeds _____

By _____, Deputy

DOCUMENT NO. _____