

CERTIFICATE OF LOCATION OF GOVERNMENT CORNER

MANYASKA

SOUTH 1/4 _____ Corner of Section 11, Township T102-N, Range R32W, 5th P.M.

STATE OF MINNESOTA, County of MARTIN

At the corner location shown on the sketch:

- On 3-3-00 found a CONCRETE BLOCK (14" DEEP)
DATE
- left monument as found, lowered monument, removed monument (explain)
- On 3-3-00 Placed a DRILLED A HOLE IN BLOCK & SET A 5/8" X 24"
DATE
IRON ROD W/ALUM. CAP OVER BLOCK (4" DEEP)

SKETCH OF REFERENCE TIES

2.5 NORTH = CENTERLINE OF ROAD
EAST-WEST

41.43 NORTHWEST = B.C.
IN TEL. PED. POST

36.65 NORTH-NORTHEAST =
EAST POST OF ARROW SIGN

73.88 SOUTHWEST = B.C.
IN P.P.

54.53 SOUTHEAST = STREET
SIGN POST

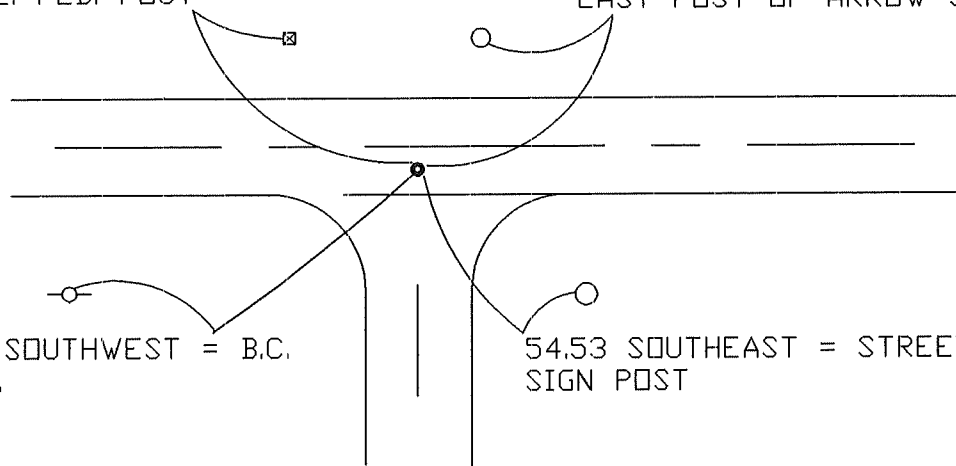

Statement of evidence relative to this corner location is on back of page.

I hereby certify that this document and the data contained herein was prepared by me or under my direct supervision.

SIGNATURE DATE

Registration No. _____

- Land Surveyor, Professional Engineer
- County Surveyor, County Engineer

OFFICE OF THE REGISTER OF DEEDS
County of MARTIN

I hereby certify that this document was filed in the Reg. of Deeds office at _____M. on the

_____day of _____A.D., 19____
Register of Deeds _____

By _____, Deputy
DOCUMENT NO. _____