

# CERTIFICATE OF LOCATION OF GOVERNMENT CORNER

South 1/4 Corner of Section 6, Township 101 N., Range 32 W., 5th P.M.

STATE OF MINNESOTA, County of Martin

At the corner location shown on the sketch:

- On April 26, 1982 found a Stone "t" Surface, over Stone "t", 12" Deep.  
DATE Stones too shallow for location.
  - left monument as found,  lowered monument,  removed monument (explain)
- On April 26, 1982 placed a 1" x 12" Steel Rod, 20" Deep, Stone "t" over, 12" Deep.  
DATE 1" x 10" Steel Rod over Stone, 2" Deep.

### SKETCH OF REFERENCE TIES

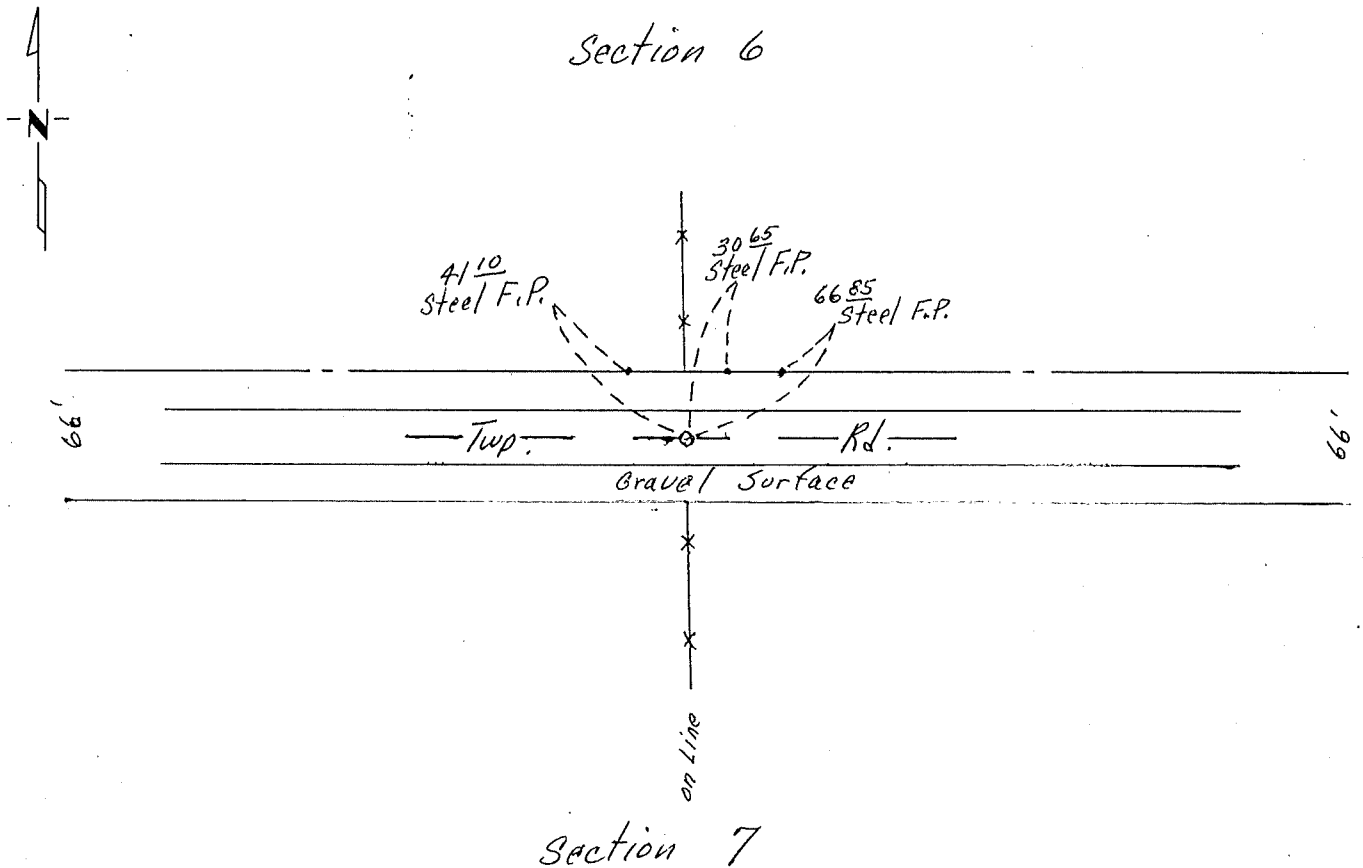

Statement of evidence relative to this corner location is on back of page.

I hereby certify that this document and the data contained herein was prepared by me or under my direct supervision.

Robert Witt 3-4-83  
SIGNATURE DATE

Registration No. 10,006

- Land Surveyor,  Professional Engineer
- County Surveyor,  County Engineer

### OFFICE OF THE COUNTY RECORDER

County of \_\_\_\_\_

I hereby certify that this document was filed in the Co. Recorders office at \_\_\_\_\_ M. on the \_\_\_\_\_ day of \_\_\_\_\_ A.D., 19 \_\_\_\_\_

County Recorder \_\_\_\_\_

By \_\_\_\_\_, Deputy

DOCUMENT NO. \_\_\_\_\_