

CERTIFICATE OF LOCATION OF GOVERNMENT CORNER

SouthEast 1/4 Corner of Section 36, Township 101N, Range 32W, 5th P.M.

STATE OF MINNESOTA, County of Martin

At the corner location shown on the sketch

- On 10/10/79 found a stone with " + " 10" deep with a 3/4" x 10" square
DATE
rebar over stone
 - left monument as found, lowered monument, removed monument (explain)
- On _____ placed a _____
DATE

SKETCH OF REFERENCE TIES

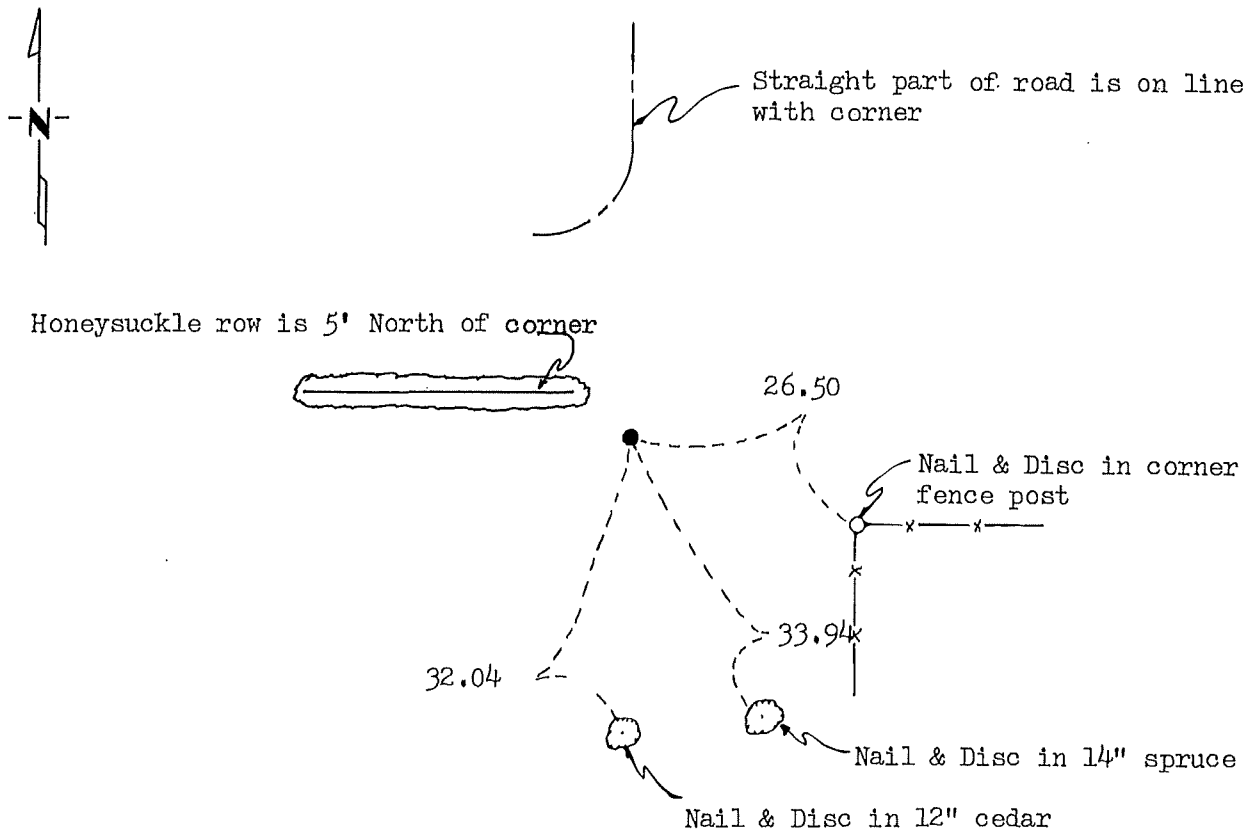

Statement of evidence relative to this corner location is on back of page.

I hereby certify that this document and the data contained herein was prepared by me or under my direct supervision.

[Signature] 2-7-80
SIGNATURE DATE

Registration No. 13593

- Land Surveyor, Professional Engineer
- County Surveyor, County Engineer

OFFICE OF THE COUNTY RECORDER

County of Martin

I hereby certify that this document was filed in the Co. Recorders office at _____ M. on the _____ day of _____ A.D., 19__.

County Recorder _____

By _____, Deputy

DOCUMENT NO. _____

Statement of Evidence:

The corner was originally established in the public land survey which was completed in Tenhassen Township in 1854.

A survey done in May of 1917 by County Surveyor George E. Sawyer, identified the corner as stone in mound and remains of stake. Crockery 30" deep and grey granite 15" x 10" x 9" with "+" at surface.

The Martin County Highway Department in 1978 found stone "+" (10" deep) and 3/4" iron pipe (protrudes 2"). Remaining ties are as follows:

26.50 S.E. = Corner fence post

33.94 S.E. = 14" spruce

32.04 S. = 12" cedar

E.-W. Honeysuckle row is 5' North of corner.

On 10/10/79, I found stone with "+" (10" deep) with a 3/4 square rebar over stone.