

CERTIFICATE OF LOCATION OF GOVERNMENT CORNER

South Quarter Corner of Section 3, Township 101N, Range 32W, 5 P.M.

STATE OF MINNESOTA, County of Martin

At the corner location shown on the sketch:

On Nov. 1996 found a Substantial Wooden Post Set in Concrete at Fence
DATE Intersection North, South, East & West

left monument as found, lowered monument, removed monument (explain)

On Nov. 1996 placed a 3/4"x12" Iron Pipe on North Side Wood Post
DATE

SKETCH OF REFERENCE TIES

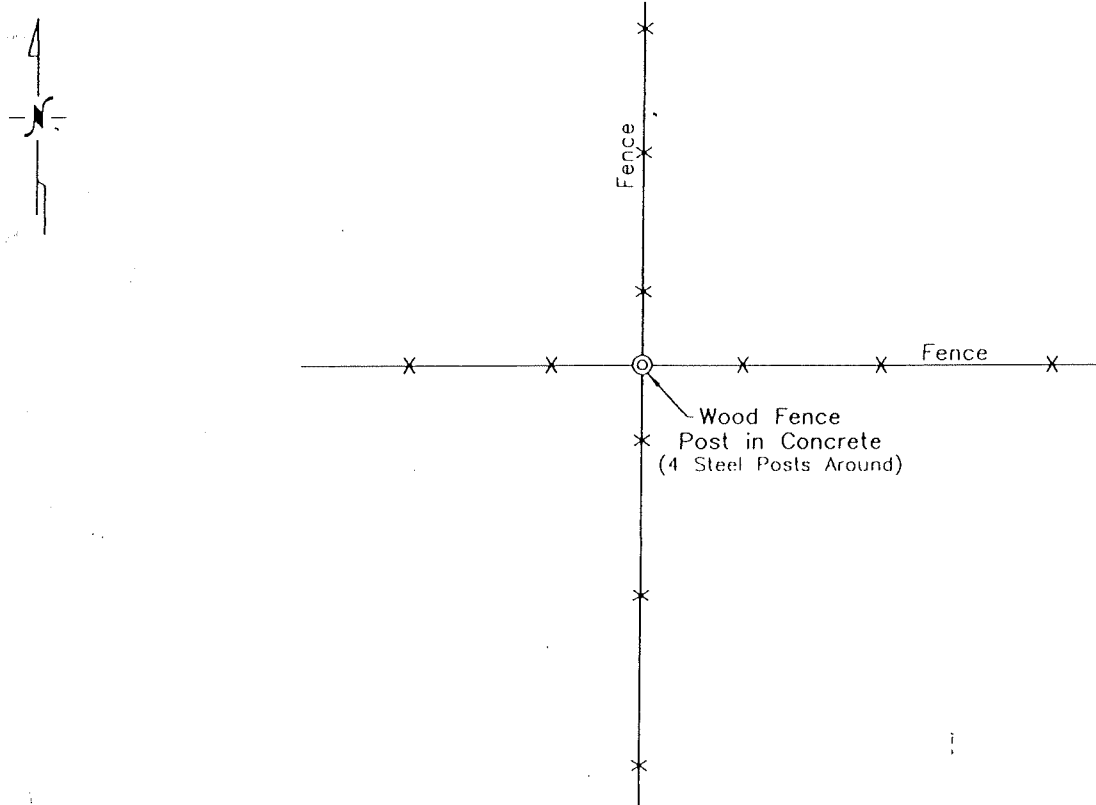

Statement of evidence relative to this corner is on the back of page.

I hereby certify that this document and the data contained herein was prepared by me or under my direct supervision.

Bruce D. Kil 12/23/1996
SIGNATURE DATE

Registration No. 13309

- Land Surveyor, Professional Engineer
 County Surveyor, County Engineer

OFFICE OF THE COUNTY RECORDER

County of _____

I hereby certify that this document was filed in the Co. Recorders office at _____ P.M. on the _____ day of _____ A.D., 19____

County Recorder _____

By _____, Deputy

DOCUMENT NO. _____

Statement of Evidence

SOUTH QUARTER CORNER OF SECTION 3, T101N, R32W

The Public Land Survey of Section 3, Township 101 North, Range 32 West of the Fifth Principal Meridian was run in 1857. A quarter section corner post was placed to mark the South Quarter corner of Section 3.

No other records were found for this corner. An indirect reference was made by County Surveyor L.F. Brainerd in May, 1884 (Survey No. 518-A-243): "Ran 1/4 line east and west across the section, Found the "middle point" on this line, put post in mound with pits. At middle point on N side of SW 1/4 set post in mound, 2 pits. At middle point on S side SW 1/4 put post in mound with 2 pits."

In November, 1996, a Bolton & Menk, Inc. survey crew found a substantial wooden post set in concrete at the corner at fence intersection north, south, east and west. Four adjoining steel posts also set in concrete. Crew placed an iron on the north side of post to mark the position.

The post position falls within 1.3 feet (east-west) and 2.5 feet (north-south) of the lost corner position.

In consideration of the long-standing occupation at this corner, lack of detailed survey records regarding the corner and approximate conformance with the lost position, the existing post is accepted as a valid perpetuation of the Public Land Survey corner.