

CERTIFICATE OF LOCATION OF GOVERNMENT CORNER

LAKE BELT

SOUTH 1/4 Corner of Section 24, Township 101N, Range 32W, 5th P.M.

STATE OF MINNESOTA, County of MARTIN

At the corner location shown on the sketch:

On 7-11-1994 found a 3/4" x 18" IRON ROD - 5" DEEP
DATE

left monument as found, lowered monument, removed monument (explain)

On 7-11-1994 Placed a 5/8" x 24" IRON ROD WITH ALUM. CAP - 4" DEEP.
DATE

SKETCH OF REFERENCE TIES

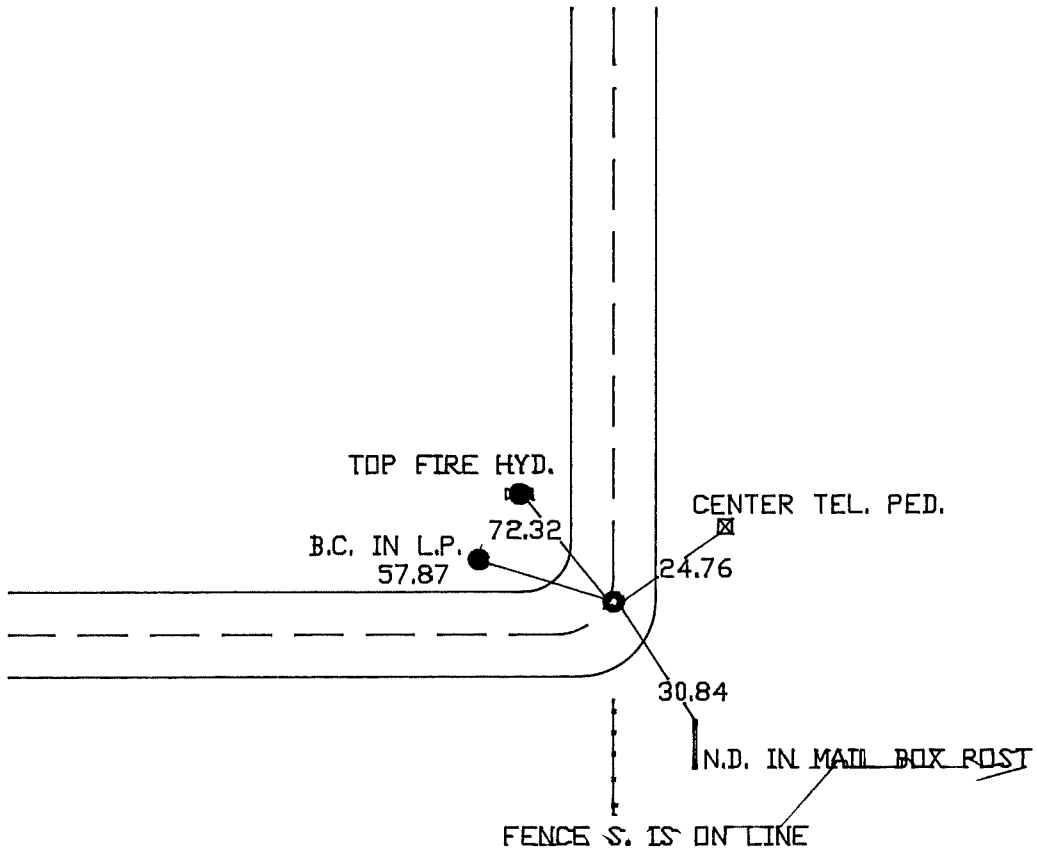

Statement of evidence relative to this corner location is on back of page.

I hereby certify that this document and the data contained herein was prepared by me or under my direct supervision.

SIGNATURE _____ DATE _____

Registration No. _____

- Land Surveyor, Professional Engineer
- County Surveyor, County Engineer

OFFICE OF THE REGISTER OF DEEDS

County of _____

I hereby certify that this document was filed in the Reg. of Deeds office at _____M. on the

_____ day of _____ A.D., 19____

Register of Deeds _____

By _____, Deputy

DOCUMENT NO. _____