

# CERTIFICATE OF LOCATION OF GOVERNMENT CORNER

East \_\_\_\_\_ Corner of Section 17, Township 101N, Range 32W, 5th P.M.

STATE OF MINNESOTA, County of Martin

At the corner location shown on the sketch:

On 8-1-78 found a 3/4" square iron 3" deep  
DATE

left monument as found,  lowered monument,  removed monument (explain)

On \_\_\_\_\_ placed a \_\_\_\_\_  
DATE

## SKETCH OF REFERENCE TIES

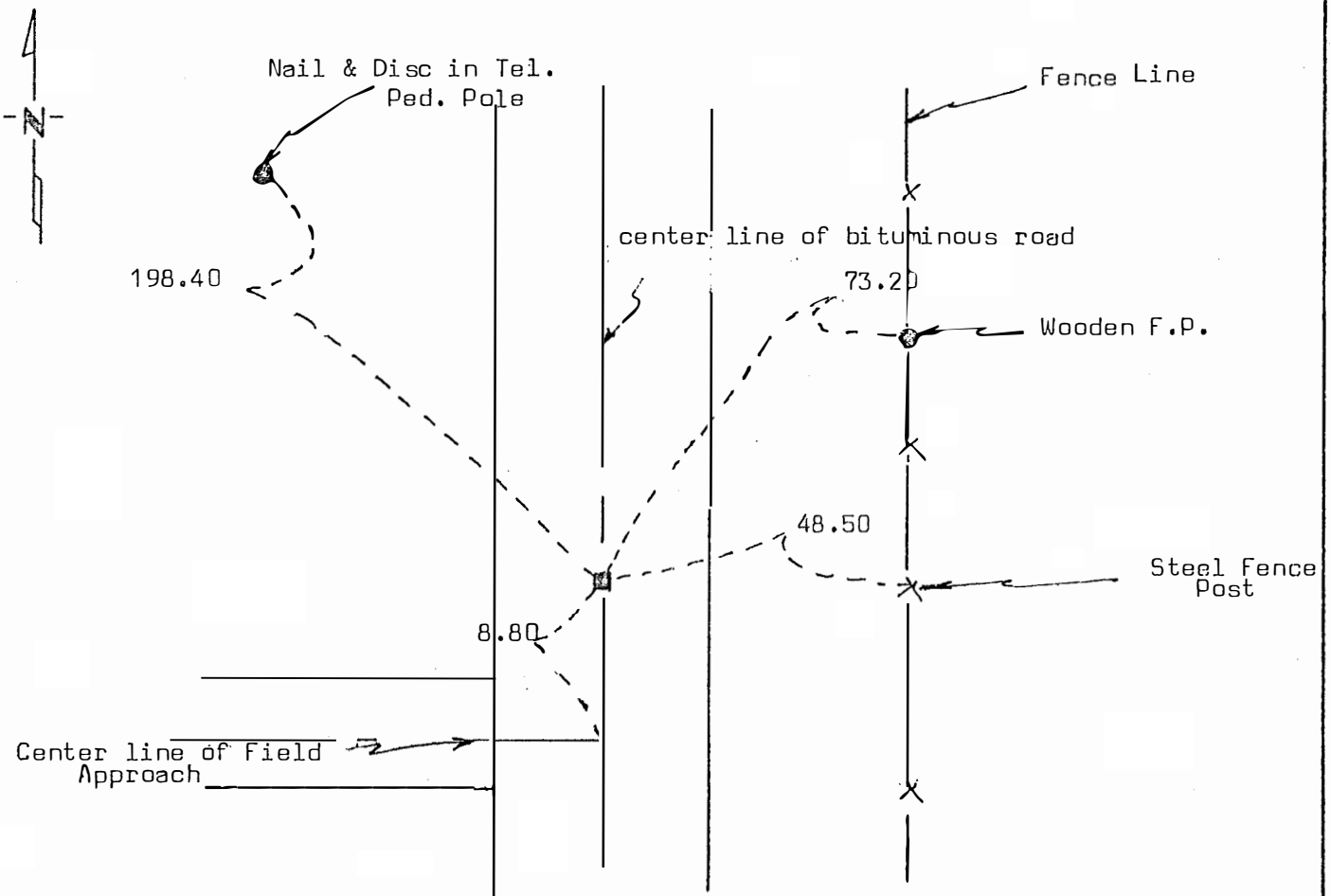

Statement of evidence relative to this corner location is on back of page.

I hereby certify that this document and the data contained herein was prepared by me or under my direct supervision.

Richard Davidson 10-4-78  
SIGNATURE DATE

Registration No. 9639  
Land Surveyor,  Professional Engineer  
 County Surveyor,  County Engineer

OFFICE OF THE REGISTER OF DEEDS  
County of Martin

I hereby certify that this document was filed in the Reg. of Deeds office at 4:00 P.M. on the 21 day of March A.D., 1979

Register of Deeds Gerald Johnson  
By [Signature], Deputy  
DOCUMENT NO. 255378

Statement of Evidence:

Previous Ties from the Martin County Highway Department

1972 2" x 2" hub (9") 3/4" I.P. (at surface) 73.35 N.E. Cor. Fence Post  
48.8 E. 2nd Steel Fence Post So. of Cor. Fence Post  
61.7 S.E. Steel Fence Post South