



In Remembrance...

Memorial Park FINAL PHASE



Marc Klaith states, "I have been committed to Memorial Park and its development. I want to thank our community and our supporters for establishing a remembrance to a significant event in our country's history. When we celebrated the "American Spirit" that day, we honored the public safety personnel and their sacrifices. There was a military presence with the jets overhead as well as representatives of our troops that have served."

This is a worthy project for the final phase of Memorial Park - to honor those who have sacrificed so we can enjoy our many freedoms. Please join in helping make this important project a reality - a park that will educate our children about those who made the ultimate sacrifice and to celebrate the determination of our citizens in protecting those freedoms.

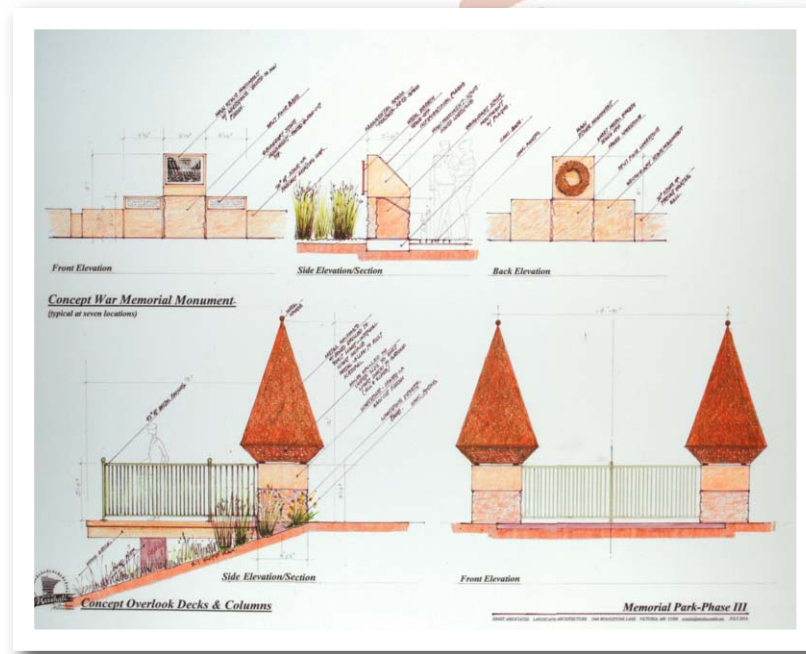

Veteran's Memorial...

The success of the 911 Memorial has demonstrated that a visual reminder of the sacrifices made can have a significant impact on our communities and citizens. The decision by the Veteran's Clubs of Lyon County to establish a memorial that honors the sacrifices made by our veterans over the years through the many conflicts and wars, makes a profound statement of cooperation and commitment.

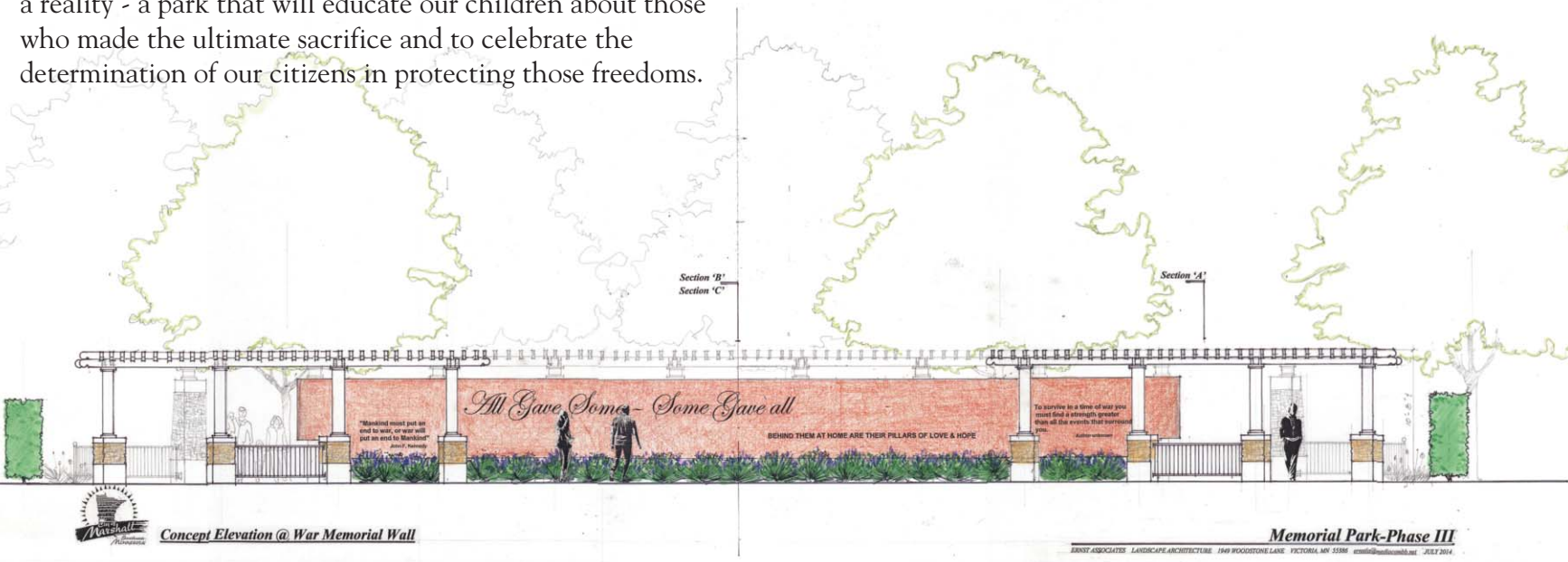
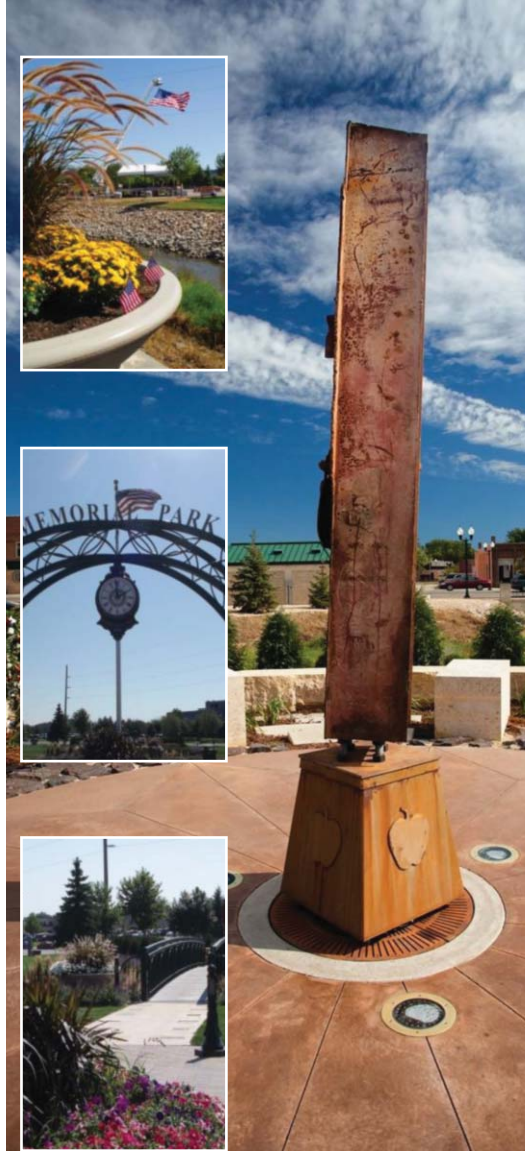

Concept Elevation @ War Memorial Wall

Memorial Park-Phase III
BENT ASSOCIATES LANDSCAPE ARCHITECTURE 1949 WOODSTONE LAKE VICTORIA, BC V8M 3S6
enb@bentassociates.com JULY 2014

Memorial Park Final Phase design is by Architect Gene Ernst who has worked on the 9/11 Memorial, the Mrs. Whitney Statue and the new entrance to the SMSU campus. Mr. Ernst has spent time in our community meeting with the veterans and other community leaders to capture the essence of the individuals' sacrifice in defending our country and its freedoms. As Ken Versaevel noted, "Gene has, in his design, captured the journey of a young citizen, the commitment to our country and finally returning to the home community for their gratitude and respect." It is the hope of our Veteran's Clubs that you share in this appreciation and help us to honor the service of our veterans with this significant memorial.

DONATE

Your brick donations are appreciated.

Brick Donations: (tax deductible)

- \$350 (4"x8" -16 characters per line; 3 lines)
 - \$600 (8"x8" -16 characters per line; 5 lines)
 - \$1000 (12"x12" -16 characters per line; 6 lines)
- Special recognition for KIA (Killed in Action)

Make checks payable to City of Marshall Vets Memorial.

Veteran's Club partners include: American Legion posts from Balaton, Cottonwood, Garvin, Ghent, Marshall, Minneota, Russell, Taunton and Tracy; VFW posts from Minneota/Taunton, Tracy and Marshall; Southwest Chapter 33 of Disabled American Veterans

Name: _____

Address: _____ Ph.: _____

City/State/Zip _____ Email: _____

Payment Method: Check# _____ Visa MC Discover Card# _____

CVC code _____ Exp. Date _____ Signature _____

Please fill out brick inscription:

Line 1 _____

Line 2 _____

Line 3 _____

Line 4 _____

Line 5 _____

Line 6 _____

Questions may be directed to Marshall Community Services at 507-537-6767.

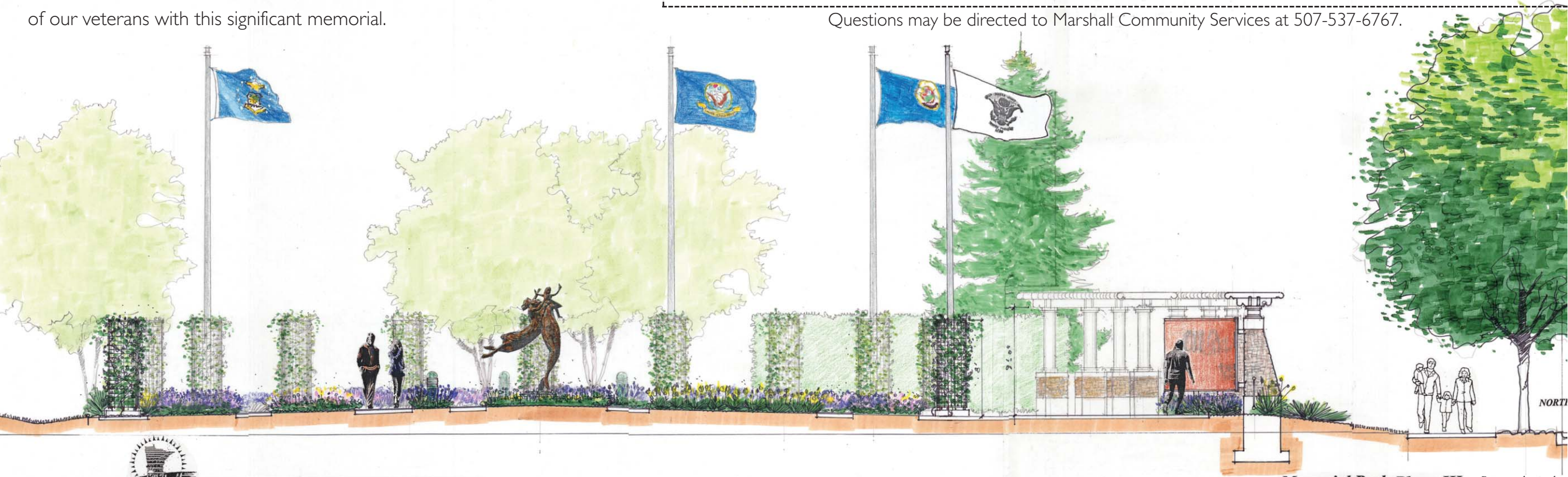

Concept Section 'C' thru Celebration Garden

Memorial Park-Phase III

ERNST ASSOCIATES LANDSCAPE ARCHITECTURE 1949 WOODSTONE LANE, VICTORIA, MN 55386 ernstla@mediacombh.net JULY 2014

Printing donated by Henle Printing