



# 2020-21 (\$75) WINTER PARKING PERMIT APPLICATION PARKING AREA REVIEW

Property Address: \_\_\_\_\_ Date: \_\_\_\_\_

Name: (Property Owner or Authorized Representative): \_\_\_\_\_  
*(Property Owner's Signature Required Below)*

Phone Number: \_\_\_\_\_ Email Address: \_\_\_\_\_

Number of Living Units: \_\_\_\_\_ Is the Property Grandfathered (if applicable): **Y** or **N**

Current Number of Parking Stalls on the Property: \_\_\_\_\_  
*(Parking stalls can be located in the garage, driveway, side-yard and rear-yard only, NO parking stall are allowed in the front yard or the park-strip areas)*

Requested Number of Permits: \_\_\_\_\_ Additional Comments/Info: \_\_\_\_\_

*(Use diagram below or backside if needed)*

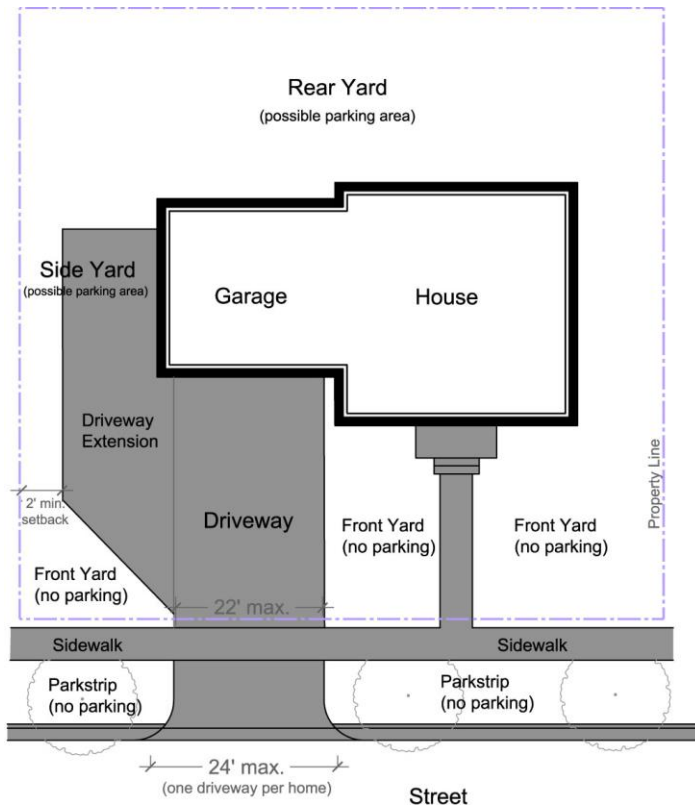

**Winter Parking Restriction**

10.52.170 (A) of the Municipal Code states: No person shall park a vehicle on any street or city owned parking lot between the hours of midnight (12:00) A.M. and six o'clock (6:00) A.M. of any day, beginning November 15 and ending March 15 of each year. Winter Parking Permits may be purchased by property owners of legally existing non-conforming residential properties built prior to 1968 if said properties cannot physically accommodate legal on-site parking. Permits shall be purchased and renewed annually and shall be limited to a maximum of two permits per legally existing unit. The actual number of permits per unit will be determined by considering, the number of existing off-street stalls and any physical space available for additional off-street parking stalls. Permit fees shall be set by council resolution. Other permit conditions may be required administratively if deemed necessary to minimize negative impacts (ORD# 16-33).

**FOR STAFF USE ONLY**

Grandfathering Verification Y / N  
Aerial Photo Property Review Y / N  
Year Built \_\_\_\_\_  
Number of Permits Justified \_\_\_\_\_  
Initial / Date \_\_\_\_\_

Winter Parking Permit Application

\_\_\_\_\_  
*(Initial)* Applicant acknowledges that Parking Permit(s) issued are non-refundable

**Property Owner's Signature:** \_\_\_\_\_  
*(The property owner **must** sign this form to authorize any representative on her/his behalf)*