

# CITY OF HUNTINGTON WOODS, MICHIGAN

## APPLICATION for FENCE INSTALLATION

(248) 581-2641 Fax: (248) 541-3102

BUILDING@HWMI.ORG

FOR OFFICE USE ONLY

APP # \_\_\_\_\_

DATE FILED: \_\_\_\_\_

BY: \_\_\_\_\_

JOB ADDRESS: \_\_\_\_\_

OWNERS NAME: \_\_\_\_\_ PHONE: \_\_\_\_\_

OWNERS ADDRESS: \_\_\_\_\_ CITY: \_\_\_\_\_ ZIP: \_\_\_\_\_

APPLICANT NAME: \_\_\_\_\_ PHONE: \_\_\_\_\_

APPLICANT ADDRESS: \_\_\_\_\_ CITY: \_\_\_\_\_ ZIP: \_\_\_\_\_

EMAIL ADDRESS: \_\_\_\_\_

### FENCE DESCRIPTION:

Type \_\_\_\_\_ Material \_\_\_\_\_ Height \_\_\_\_\_

### Indicate the following items on the plot plan:

1. The location of any existing fence or wall on or adjacent to the lot with a dashed line. (-----)
2. The location of the proposed fence or wall with a row of x's. (x x x x x x)
3. The length of the proposed fence or wall in all directions.
4. The height of all segments of the proposed fence or wall.
5. All gates, whether in existing or proposed fences or walls.
6. The side street if the property is a corner lot.

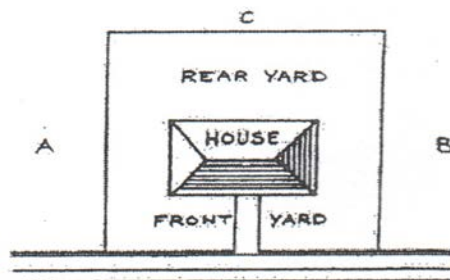

**NOTE:** All walls, privacy fences, or fences over 4 ft in height, require the written consent of the adjacent property owner(s). If the adjacent property is owned by more than one person, all owners must sign.

### APPLICATION FEE IS \$25.00

I, the undersigned property owner, adjacent to the proposed fence or wall described in this application, does hereby consent to the openings in the fence or wall being 50% less of its total area (privacy fence) and/or the height of the fence being greater than 4 ft. but no more than 6 ft.

#### PROPERTY OWNER A:

\_\_\_\_\_  
(Signature)

\_\_\_\_\_  
(Address)

#### CO -OWNER OF PROPERTY A:

\_\_\_\_\_  
(Signature)

\_\_\_\_\_  
(Address)

#### PROPERTY OWNER B:

\_\_\_\_\_  
(Signature)

\_\_\_\_\_  
(Address)

#### CO -OWNER OF PROPERTY B:

\_\_\_\_\_  
(Signature)

\_\_\_\_\_  
(Address)

#### PROPERTY OWNER C:

\_\_\_\_\_  
(Signature)

\_\_\_\_\_  
(Address)

#### CO -OWNER OF PROPERTY C:

\_\_\_\_\_  
(Signature)

\_\_\_\_\_  
(Address)

**NOTE:** No fence or wall is to be installed until the application fee has been paid and an approved copy of this permit is returned to the property owner or contractor. It is understood by the undersigned that only one fence may be constructed along a lot line and any existing fence or fences along the lot line will be removed *with the owner's permission* at the permit holder's expense prior to construction of the new fence. It is further understood by the undersigned that all requirements of the Huntington Woods City Code Chapter 80 will be complied with.

Signature \_\_\_\_\_ Date \_\_\_\_\_

APPROVED DATE: \_\_\_\_\_

NOT APPROVED DATE: \_\_\_\_\_

INSPECTOR \_\_\_\_\_

NOTES: \_\_\_\_\_