

ADDENDUM NO. 1
FRED MEIJER TRAIL HUB PHASE 1 CLEARING
401-751-977.851

January 19, 2023

To: All Plan Holders.

Notice: This addendum to the plans and specifications is to add to or supersede all pertinent information in the original plans and specifications. The amendments made herein shall become part of the bidding documents as originally issued.

Bid Date is unchanged. Tuesday, January 31, 2023 at 2:00 p.m.

Clarifications to Project Scope:

1. There are sheets on the plans that aren't included. *These plans serve multiple purposes. Only the sheets that pertain to the work were included.*
2. There are orange marks on trees on the river side of the trail near the NE corner of the building. Are they to be included? *No, those are outside the scope of this Contract.*
3. Is the intent for the clearing to go to the riverbank since the stakes are not on the bank? *The intent was to go to the riverbank, however a concern was brought up about the need to clear in order to set silt fence, which is a valid point. Therefore, the **scope is modified** to set the silt fence as directed by the Engineer and leave the brush and dead-fall along the riverbank in place.*
4. What kind of clearing equipment is allowed? *As long as the operation of equipment is not disturbing the ground surface to a degree that would create more than 6 inch deep ruts, it is allowed.*
5. Are you spraying stumps? *No spraying of stumps is necessary.*
6. Do all stumps need to be left 36" high? *The height left for stumps being 36" is for ease of removal by dozers at a later time. Selective stumps can be cut lower for ease of removal, but they cannot be removed at this time. This work is being done to comply with Endangered Species Act requirements: trees taken down considering bats, stumps being left considering snakes.*
7. Is any clearing being proposed on the riverside of the Trail north of the building? *No.*
8. What about silt fence north of the building? *Silt fence is proposed for the area between the M-57 bridge and the Trail bridge. We expect that operations can be mitigated in the upland area without silt fence.*

9. Where is the silt fence shown? *Sheet 7 is included here to show the approximate location of the fence. It is intended to be between the bridges only even though it is shown to continue north of the Trail bridge.*
10. *An SESC permit will not be required for this work, but we still want the silt fence.*
11. *Placing chipped material over surface scarring from the clearing operation will be an acceptable form of stabilization.*
12. Is access to the site from the building and driveway at 502 E. Washington acceptable? *Yes, the property belongs to the City and is the intended access point for the work.*
13. Can chipped material be taken to the compost area along with the trees? *Yes.*

Please acknowledge receipt of this Addendum on page 14 of the Bid Form.

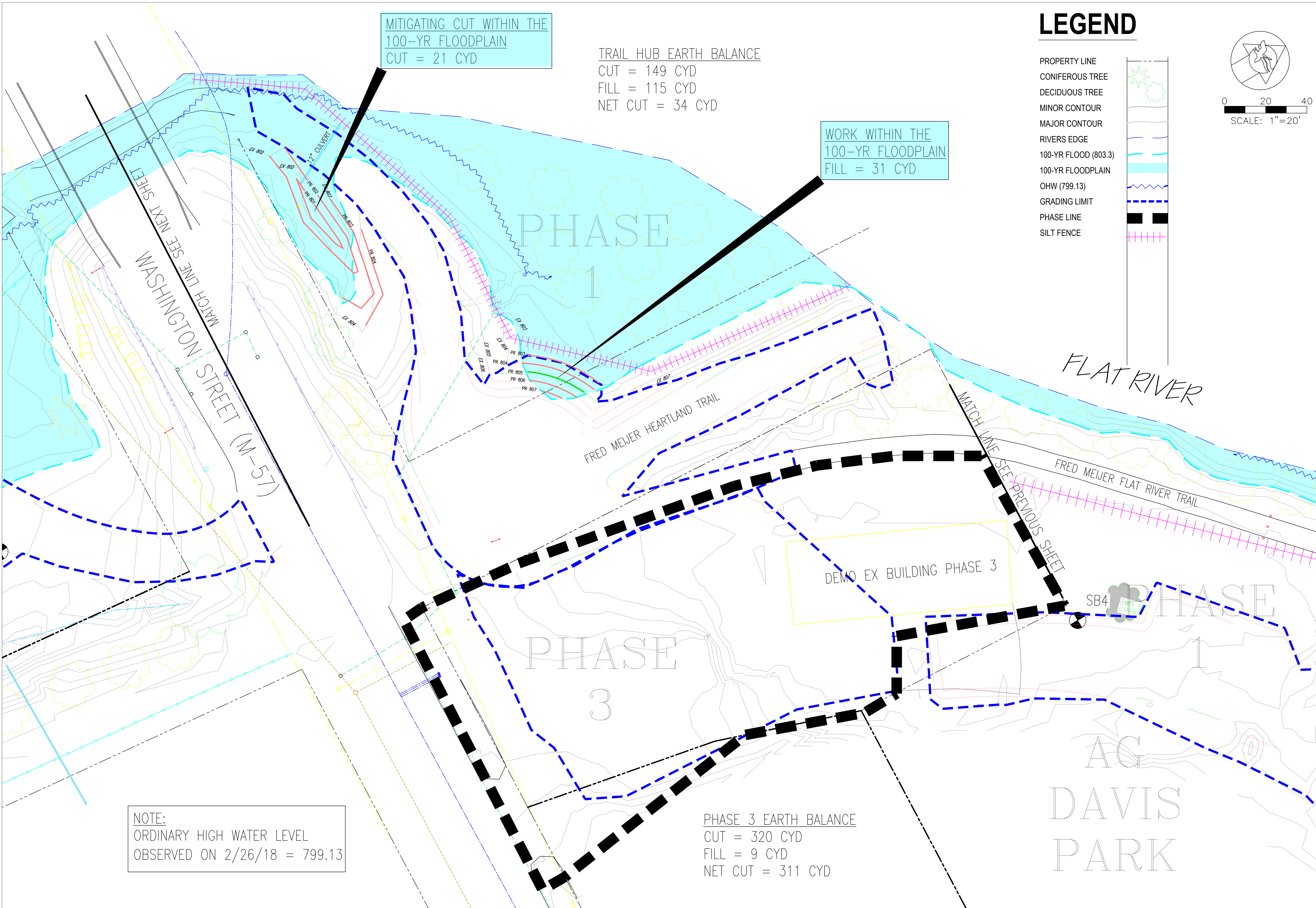

MITIGATING CUT WITHIN THE
100-YR FLOODPLAIN
CUT = 21 CYD

TRAIL HUB EARTH BALANCE
CUT = 149 CYD
FILL = 115 CYD
NET CUT = 34 CYD

WORK WITHIN THE
100-YR FLOODPLAIN
FILL = 31 CYD

LEGEND

- PROPERTY LINE
- CONIFEROUS TREE
- DECIDUOUS TREE
- MINOR CONTOUR
- MAJOR CONTOUR
- RIVERS EDGE
- 100-YR FLOOD (803.3)
- 100-YR FLOODPLAIN
- OHW (799.13)
- GRADING LIMIT
- PHASE LINE
- SILT FENCE

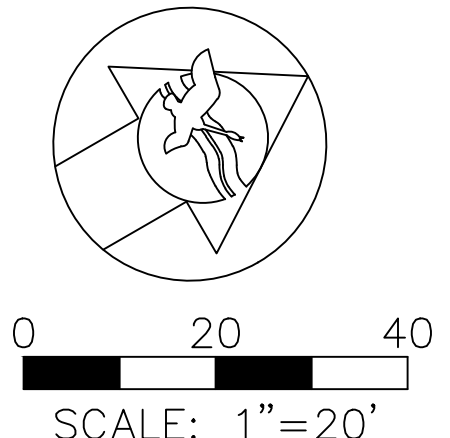

NOTE:
ORDINARY HIGH WATER LEVEL
OBSERVED ON 2/26/18 = 799.13

PHASE 3 EARTH BALANCE
CUT = 320 CYD
FILL = 9 CYD
NET CUT = 311 CYD

CITY OF GREENVILLE
ENGINEERING DEPARTMENT
411 S. LAFAYETTE, GREENVILLE, MI 48838
TELEPHONE (616) 754-5645

GRADING/SEC
PLAN
PART OF PHASE 1
& PHASE 3

FRED MEIJER TRAIL HUB
JACKSON'S LANDING AND AG DAVIS PARKS
LW22-0028
CITY OF GREENVILLE, MI

DRAWING ISSUE

1	JANUARY 3, 2023
2	
3	
4	
5	
6	
7	
8	
9	