



**SEA THE
FUTURE
WITH US**

Waterfront Place Central – Millwright Loop Roads Phase 1 Demolition & Pre-Load Project Update

Elise Gronewald, P.E., PMP
Port of Everett
December 12, 2022



@portofeverett | #portofeverett

**WATERFRONT
PLACE**
@ PORT OF EVERETT

TODAY'S PRESENTATION

- Project status update for the Millwright Loop Roads Phase 1 – Demolition & Pre-Load project.



PROJECT SITE WORK

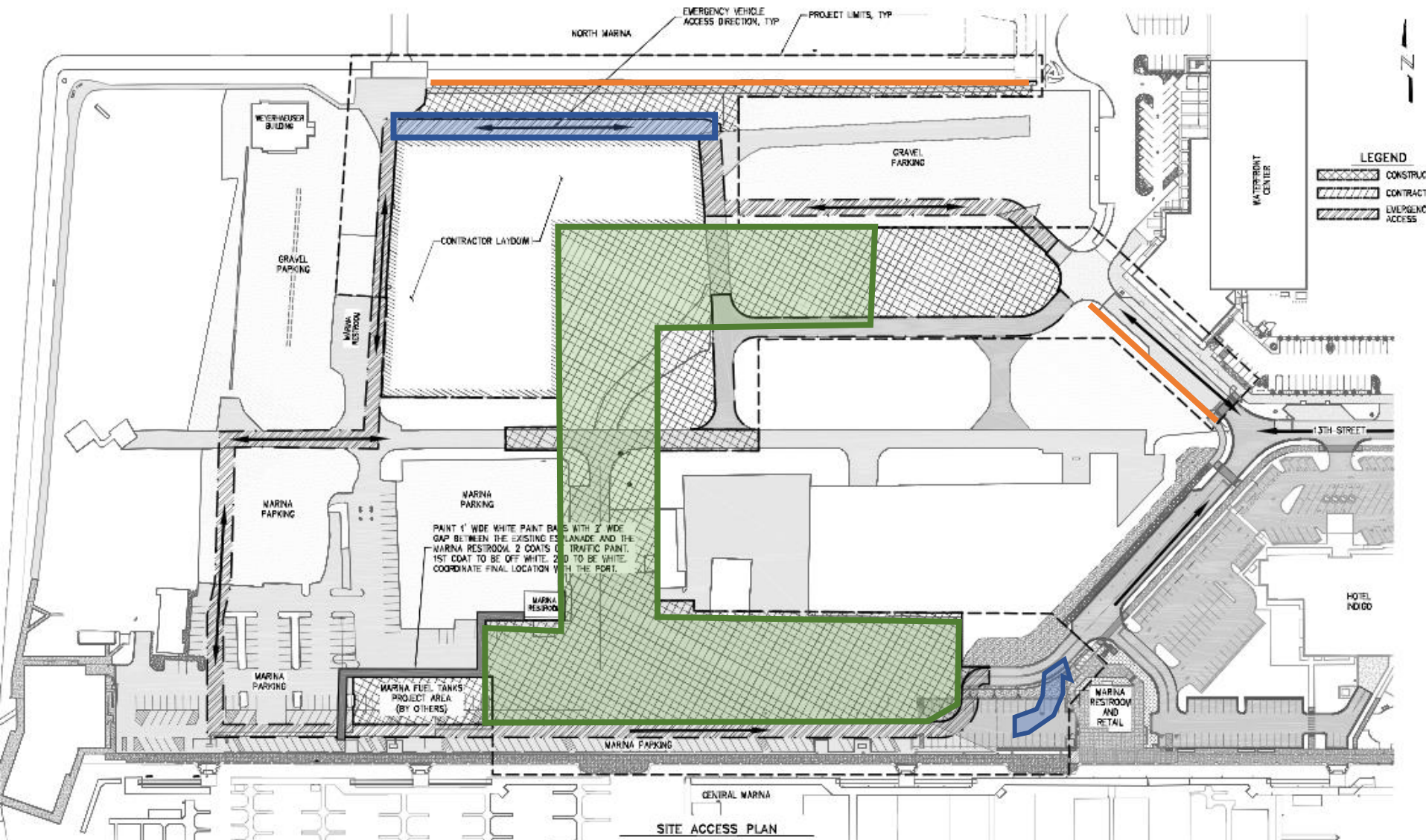

Project Progress

- Traffic Access routes installed, ongoing work to provide best route for public.
 - Utilities demolished, re-routed, and protected within surcharge area. New storm trench drain installed along southern project boundary.
 - Sand blanket brought onsite and placed.
 - Settlement monitoring plates placed; DEA surveyed.
 - Wick drains flagged and began drilling last week.
-
- Future Work: Pre-load to be brought in and placed next year once wick drains are complete.

Site Work



Construction Photos



Construction Photos



Future Work – Phase 2

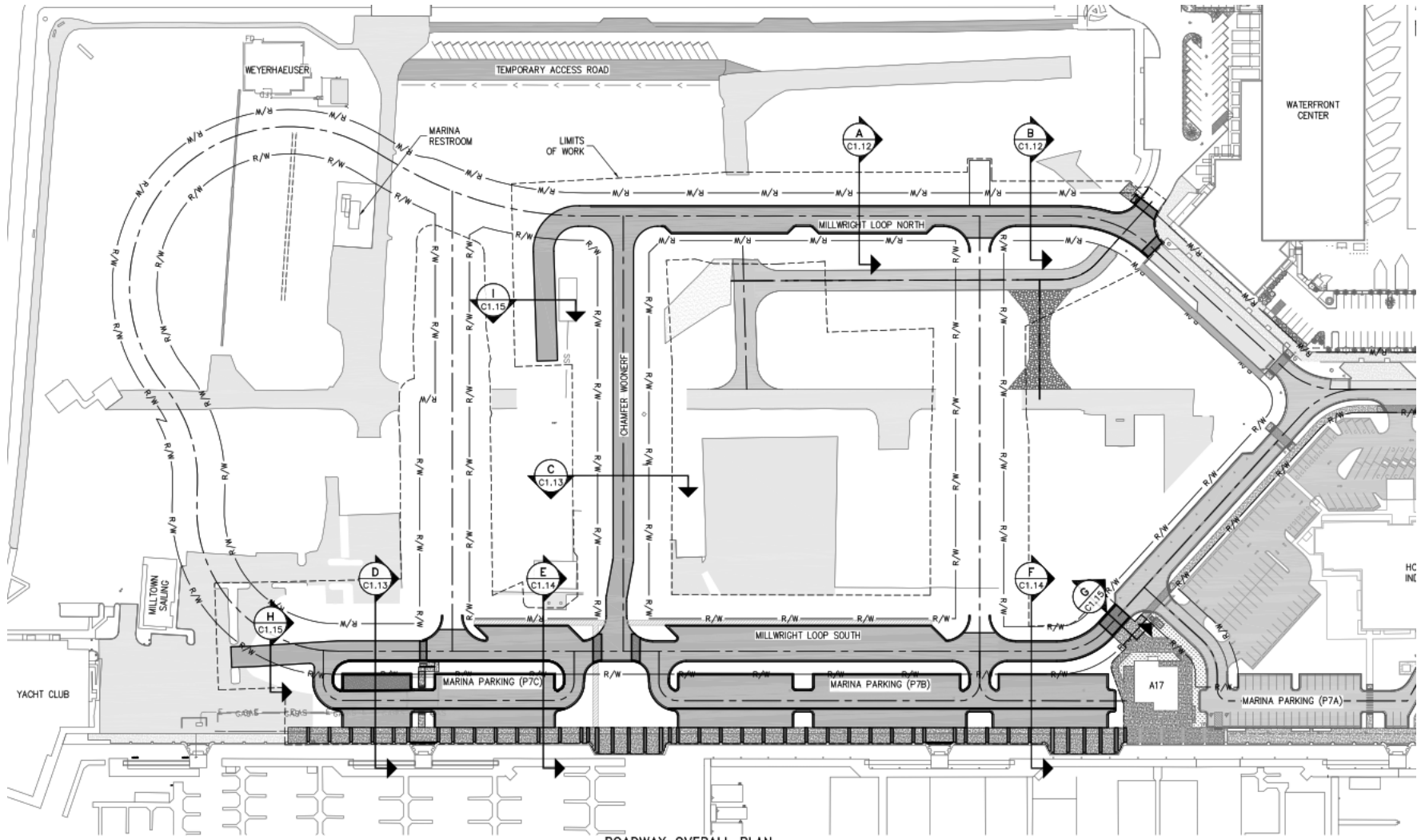

A large container ship is docked at a pier. A crane is visible on the left side of the ship, and a forklift is on the pier to the right. The ship has "Westwood Shipping Lines" written on its side. The image is dark and has a blue tint.

**COMMENTS OR
QUESTIONS?**



NEXT 100

WE PROVIDE VALUE: WE CREATE ECONOMIC OPPORTUNITIES

THANK YOU!



@portofeverett | #portofeverett