



**SEA THE  
FUTURE  
WITH US**

# **Maritime Industrial Expansion / Norton Terminal Task Order No. 016 Authorization for KPFF Engineers**

John Klekotka  
Port of Everett  
September 14, 2021



@portofeverett | #portofeverett



# BACKGROUND

- Commission Strategic Goal and Capital Initiative to redevelop the former K-C site and place into productive use as a maritime industrial facility
- Public solicitation for services (RFQ) for Qualifications for consultant services issued in November and ratified by Commission in December 2019
- Received four SOQs, Interviewed three teams, and Staff recommended KPFF Consulting Engineers
- Commission authorized a Task Order based contract with KPFF in February 2020 with maximum NTE amount of \$2,600,000
- In July Commission authorized a Contract Modification No. 1 to increase contract maximum to \$3,400,000

# CONSULTANT TEAM SCOPE OF WORK

- Project Management
- Surveying
- Environmental Services
- Geotechnical
- Land Use Regulations and Permit Support
- Site Engineering
- Architecture and Landscape Architecture
- Bid and Construction Phase Services
- Task Order Type Contract

# PROJECT SITE DEVELOPMENT

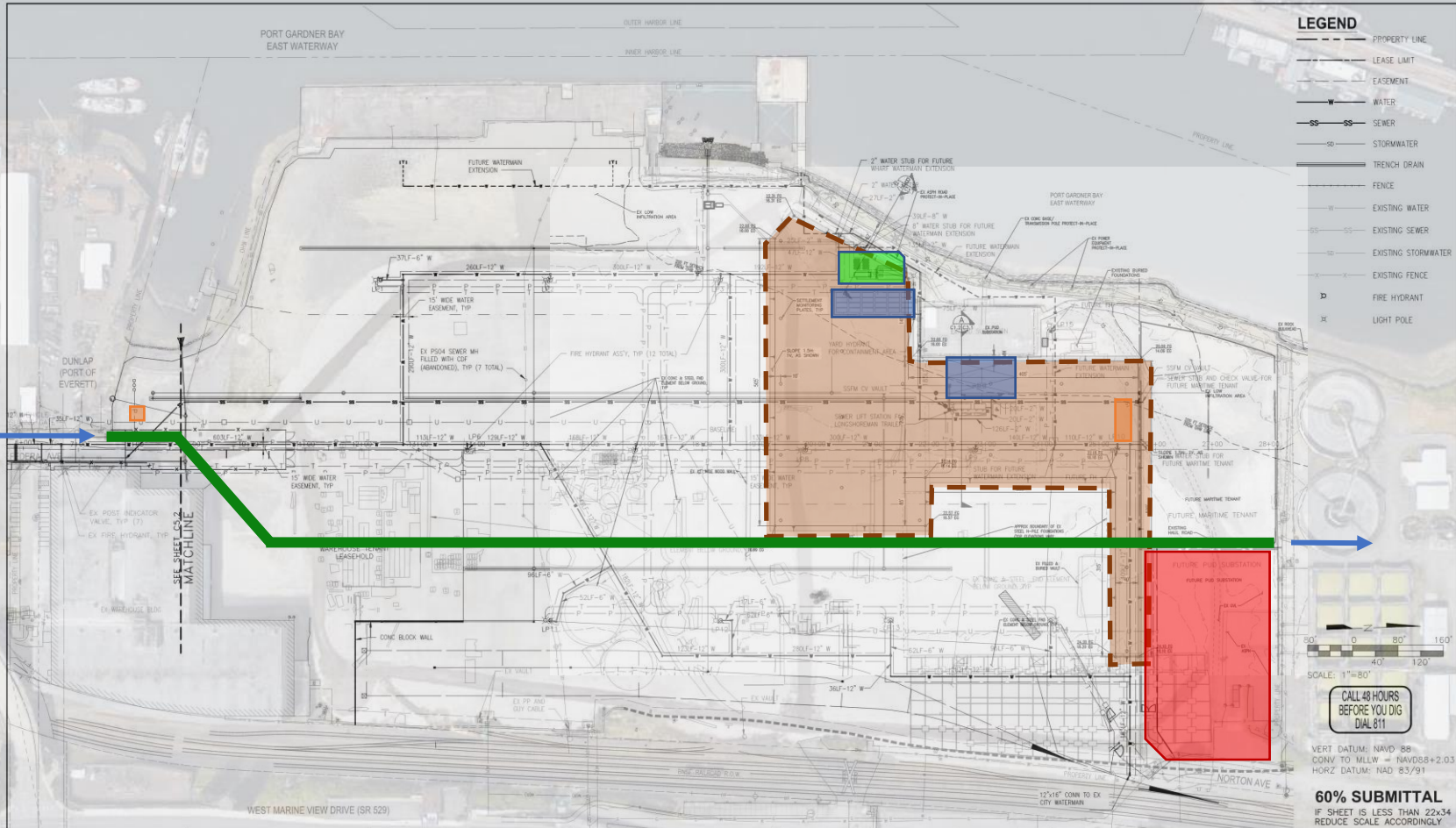

**LEGEND**

---	PROPERTY LINE
- - - -	LEASE LIMIT
- - - -	EASEMENT
— W —	WATER
— SS —	SEWER
— SD —	STORMWATER
—	TRENCH DRAIN
—	FENCE
— W —	EXISTING WATER
— SS —	EXISTING SEWER
— SD —	EXISTING STORMWATER
—	EXISTING FENCE
⊠	FIRE HYDRANT
⊕	LIGHT POLE

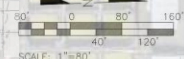

**CALL 48 HOURS BEFORE YOU DIG DIAL 811**

VERT DATUM: NAVD 88  
 CGNV TO MLLW = NAVD88+2.03  
 HORIZ DATUM: NAD 83/91

**60% SUBMITTAL**  
 IF SHEET IS LESS THAN 22x34  
 REDUCE SCALE ACCORDINGLY



**kpff**  
 1601 5th Avenue, Suite 1300  
 Seattle, Washington 98101  
 (206) 382-0500 Fax (206) 382-0500  
 PROJECT NO. 1600120

NO.	DATE	BY	REVISION	NO.	DATE	BY	REVISION

PROJECT ENGINEER  
N. WATSON  
 SCALE: 1" = 80'  
 DESIGNED BY  
J. REICHER  
 DATE: 12/04/2020  
 DRAWN BY  
K. EDWARDS, D. YU  
 CHECKED BY  
N. WATSON  
 APPROVED BY:

**PORT OF EVERETT**  
 MARITIME INDUSTRIAL EXPANSION  
 NORTON TERMINAL – 60% DESIGN  
 WATER AND SEWER PLAN

DWG. NO. **C5.1**  
 CIP NO. 1-8-900-05  
 PROJECT NO. TBD  
 SHEET NO. XX OF XX

# CONTRACT TASK ORDER STATUS

## BILLED THRU JULY 2021

TASK NO.	DESCRIPTION	BUDGET (in thousands)	% SPENT
001	Scoping	\$ 21.3	100%
002	K-C Post Closing	\$ 220.6	95%
003	Land Use and Permitting	\$ 149.0	85%
004	Design Support Services	\$ 252.6	97%
005	Conceptual Site Design / 30% Design	\$ 298.8	100%
006	PUD Substation	\$ 16.6	15%
007	60% Design	\$ 400.0	94%
008	Barge Dock Assessment	\$ 139.2	90%
009	Warehouse Assessment	\$ 70.9	85%
010	Wharf Evaluation	\$ 33.6	100%
	(continued on next slide)		

# CONTRACT TASK ORDER STATUS

## BILLED THRU JULY 2021

TASK NO.	DESCRIPTION	BUDGET (in thousands)	% SPENT
	(continued from previous slide)		
011	90% Site Design	\$ 493.0	100%
012	RR Siding Track Preliminary Design	\$ 32.0	36%
013	Additional Geotechnical Analysis	\$ 83.3	81%
014	Final Design	\$ 224.5	100%
015	Construction Support for Preload	\$ 99.8	7%
016	Construction Support for MTCA Related Work (PROPOSED)	\$ 506.8	-
017	Construction Support for Non-MTCA Related Work	\$ 246.3	-
	TOTAL	\$3,287.7*	70%*
	*Including proposed T.O. No. 016		

# **REQUESTED COMMISSION ACTION**

Staff requests that the Commission authorize the execution of Task Order No. 016 under PSA 1-2020-02 with KPFF Engineers for construction phase support services for the MTCA-related project work in the amount of \$506,791.



# NEXT 100

WE PROVIDE VALUE. WE CREATE ECONOMIC OPPORTUNITIES

THANK YOU!

---



@portofeverett | #portofeverett