

ORDINANCE NO. 20-38

AN ORDINANCE OF THE VILLAGE OF EAST DUNDEE, COOK AND KANE COUNTIES, ILLINOIS CLOSING OUT AND DISSOLVING EAST DUNDEE SPECIAL SERVICE AREAS NUMBER 2, 3 AND 4

WHEREAS, the Village of East Dundee (“Village”) is a home rule unit of local government pursuant to Section 6 of Article VII of the Constitution of the State of Illinois, and has the authority to exercise any power and perform any function pertaining to its government and affairs; and

WHEREAS, the Village created East Dundee Special Service Area Numbers 2, 3 and 4 pursuant to authority granted to the Village in the Illinois Constitution and the Illinois Special Service Area Tax Law, 35 ILCS 200/27-5, *et seq.*; and

WHEREAS, it is in the best interests of the Village that East Dundee Special Service Areas Number 2, 3 and 4 be closed out and dissolved, as all special services to be provided by the Village within the Special Service Areas have been completed and as the Special Service Areas are no longer needed;

BE IT ORDAINED BY THE VILLAGE PRESIDENT AND BOARD OF TRUSTEES OF THE VILLAGE OF EAST DUNDEE, COOK AND KANE COUNTIES, ILLINOIS, AS FOLLOWS:

SECTION 1: Findings. That the President and Board of Trustees of the Village find as follows:

- A. East Dundee Special Service Areas 2, 3 and 4 (together the “Special Service Areas 2, 3 and 4”) were established by Village Ordinance Numbers 97-25, adopted October 10, 1997, and 97-28, adopted October 22, 1997.
- B. All special services for Special Service Areas 2, 3 and 4 have been completed.
- C. All expenses and costs have been paid in full relative to Special Service Areas Number 2, 3 and 4.
- D. There are no outstanding bonds in relation to Special Service Areas Number 2, 3 and 4.
- E. There is no longer any tax levy in effect relative to Special Service Areas Number 2, 3 and 4.

- F. A review of the Village's accounts relative to Special Service Areas Number 2, 3 and 4 reveals that there are no excess funds in said accounts.

SECTION 2: Completion, Closure and Dissolution. That in light of the findings set forth in Section 1 above, Special Service Areas Number 2, 3 and 4 are hereby declared completed, closed and dissolved, and Village Ordinance Number 97-34, adopted December 15, 1997, which levied a tax in Special Service Areas Number 2, 3 and 4, is repealed.

SECTION 3: Filing and Recording. That the Village Clerk is hereby authorized and directed to file a certified copy of this Ordinance with the Kane County Clerk's Office, and to record a certified copy of this Ordinance with the Kane County Recorder of Deeds' Office, with the cover sheet for said recording to reference the recording date and document number for the ordinance that established Special Service Areas Number 2, 3 and 4.

SECTION 4: Severability. That if any Section, paragraph or provision of this Ordinance shall be held to be invalid or unenforceable for any reason, the invalidity or unenforceability of such Section, paragraph or provision shall not affect any of the remaining provisions of this Ordinance.

SECTION 5: Repeal. That all ordinances, resolutions, motions or parts thereof in conflict with this Ordinance shall be and the same are hereby repealed.

SECTION 6: Effect. That this Ordinance shall be in full force and effect upon its adoption, approval and publication in pamphlet form as provided by law.

[THIS SPACE INTENTIONALLY LEFT BLANK]

ADOPTED this 14th day of September, 2020 pursuant to a roll call vote as follows:

AYES: Trustees Lynam, Selep, Wood, Mahony, Andresen and Kunze

NAYES: None

ABSENT: None

APPROVED by me this 28th day of September, 2020.



Lael Miller, Village President

ATTEST:

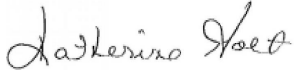

Katherine Holt, Village Clerk

Published in pamphlet form this 28th day of September, 2020 under the authority of the Village President and Board of Trustees.

Recorded in the Village records on October 12, 2020.

ORDINANCE NUMBER 97 - 25

AN ORDINANCE PROPOSING THE ESTABLISHMENT
OF SPECIAL SERVICE AREAS IN THE
VILLAGE OF EAST DUNDEE AND PROVIDING FOR A
PUBLIC HEARING AND OTHER PROCEDURES
IN CONNECTION THEREWITH

WHEREAS, the Village of East Dundee as a non-home rule unit has been granted such statutory powers pursuant to the Illinois Constitution either expressly or as may be impliedly necessary to the accomplishment of the intent of the duties expressly conferred on it by law;

WHEREAS, the Village of East Dundee applied to the Illinois Main Street Suburban Program and was accepted into the program and established a Dundee Main Street Program; and

WHEREAS, the Dundee Main Street organization has approached the Village and asked for the establishment for Special Service Areas to meet the private contribution requirements of establishing a Dundee Main Street organization.

BE IT ORDAINED BY THE PRESIDENT AND BOARD OF TRUSTEES OF THE VILLAGE OF EAST DUNDEE, KANE COUNTY, AS FOLLOWS:

SECTION 1. Authority. Special Service Areas Numbers 2, 3, and 4 are established pursuant to the provisions in Part (6) of Section 7 of Article 7 or in Part (2) paragraph L of Section 6 of Article 7 of the Constitution of the State of Illinois, and pursuant to:

An Act to provide the manner of levying or imposing taxes for the provision of special services to areas within the boundaries of home rule units and non-home rule municipalities and counties, (Public Act 88-455); 35 ILCS 200/27-5 et seq.

SECTION 2: Findings.

- A. The Village Board finds that Special Service Areas Numbers 2, 3, and 4 are zoned for commercial, business, and office purposes and will benefit specifically from the establishment of an overall Dundee Main Street organization. The primary purposes are to increase and improve the economic climate of downtown Dundee and promote downtown Dundee. The proposed services are unique and in addition to the municipal services provided to the East Dundee business community as a whole.
- B. The Village Board has committed \$15,000 of municipal funding towards the public/private partnership to establish the Dundee Main Street organization and the monies generated from Special Service Areas Numbers 2, 3, and 4 be used to meet the private contribution requirements of funding the Dundee Main Street organization.
- C. Said Special Service Areas are compact and contiguous and constitute the principal areas of commerce of downtown East Dundee.
- D. That it is in the best interest of said Special Service Areas that the Dundee Main Street organization be established for the common interests of said areas.
- E. That it is in the public interest that the areas hereinafter described as Special Service Areas for the purposes set forth herein be established.

SECTION 3. Village of East Dundee Special Service Areas Numbers 2, 3, and 4 Established. The Special Service Areas to be known and designated as "Village of East Dundee Special Service Areas Numbers 2, 3, and 4" are hereby proposed to be established and shall consist of the territory described in Exhibit "A" attached hereto and made a part hereof.

SECTION 4: Purpose of Areas.

- A. Village of East Dundee Special Service Areas Numbers 2, 3, and 4 are established to provide funding to meet the private contribution requirements of the Dundee Main Street organization, and said organization is in addition to the services provided to the Village generally. The monies which are generated from the Special Service Areas will be used specifically to further the goals, efforts, and programs of the Dundee Main Street organization as defined by the Dundee Main Street Board of Directors.

B. The Village of East Dundee Service Areas Numbers 2, 3, and 4 are also created with the following stipulations that:

1. After the period of three (3) years, said Special Service Areas can be removed by the submittal of the petition by 51 percent of the electors and property owners located within each Special Service Area as defined.
2. That after a period of five (5) years, Special Service Areas Numbers 2, 3, and 4 will require renewal submitted by a petition of 51 percent of the electors and property owners located within each such Special Service Areas as defined.

SECTION 5. Public Hearing - Tax Rate. A Public Hearing shall be held on the 22nd day of October, 1997, at 6:30 p.m., at the East Dundee Village Hall, 120 Barrington Avenue, East Dundee, Illinois, to consider the creation of Special Service Areas Numbers 2, 3, and 4 of the Village of East Dundee as described in Section 3 hereof. At the hearing there will be considered a levy of an annual tax of not to exceed an annual rate of .3% (or \$.30 per \$100.00) of the assessed value, as equalized, of the taxable real property in each proposed Special Service Area. Said tax shall be in addition to all other taxes provided by law, and shall be levied pursuant to the provisions set forth in Section 1 hereof.

SECTION 6. Notice of Hearing. Notice of hearing shall be published at least once not less than fifteen (15) days prior to the public hearing in a newspaper of general circulation in the Village of East Dundee. In addition, notice by mailing shall be given by depositing the notice into the United States Mail addressed to the person or persons in whose names the general taxes for the last preceding year were paid on each property lying within each proposed Special Service Area. A notice shall be mailed not less than ten (10) days prior to the time set for public hearing. In the event taxes for the last preceding year were not paid, the notice shall be sent to the person or persons last listed on the tax rolls prior to that year as the owner(s) of the property. Said notice shall conform in all respects to the requirements of Section 27-30 of Public Act 88-455, aforesaid, and substantially in the form of Exhibit "B" attached hereto and made a part hereof.

SECTION 7. Effective Date. This Ordinance shall be in full force and effect from and after its adoption and approval as provided by law, providing no petition is filed opposing the creation of the special service area pursuant to Chapter 35 ILCS, Illinois Compiled Statutes, Section 200/27-5 et seq.

SECTION 8. **Severability.** If any section, paragraph, or provision of this ordinance shall be held to be invalid or unenforceable for any reason, the invalidity or unenforceability of such section, paragraph or provision shall not affect any of the remaining provisions of this ordinance.

SECTION 9. **Repeal.** All ordinances, resolutions, motions or parts thereof in conflict herewith shall be and the same are hereby repealed.

SECTION 10. **Publication.** This ordinance shall be in full force and effect forthwith upon its adoption, approval and publication in pamphlet form as provided by law.

Adopted this 29th day of September, 1997, pursuant to a roll call vote as follows:

AYES: Bartels, Albrecht, Szalla, Zaeske, Ahrens, Arnone.

NYES: None.

ABSENT: None.

Approved by me this 29th day of September, 1997.

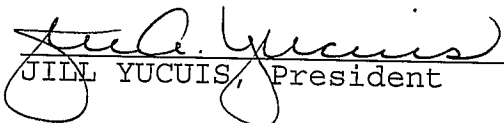

JILL YUCUIS, President

Published in pamphlet form this 10th day of October, 1997, under the authority of the President and Board of Trustees.

ATTEST:



JANE THEIS, Village Clerk

Recorded in the Village Records on October 10th, 1997.

C:\WP51\EASTDUND\SPCLSRV.ORD

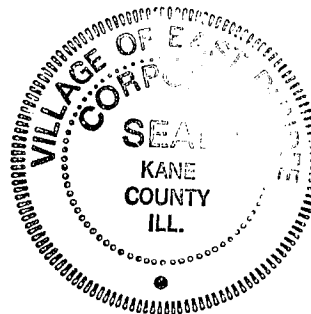

ORDINANCE NUMBER 97 - 28

AN ORDINANCE RATIFYING THE ESTABLISHMENT
OF SPECIAL SERVICE AREAS WITHIN THE
VILLAGE OF EAST DUNDEE TO PROVIDE
SPECIAL MUNICIPAL SERVICES

WHEREAS, the Village of East Dundee as a non-home rule unit has been granted such statutory powers pursuant to the Illinois Constitution either expressly or as may be impliedly necessary to the accomplishment of the intent of the duties expressly conferred on it by law;

WHEREAS, the Village of East Dundee Board of Trustees found that it was in the best interest of the Village that Special Service Areas No's. 2, 3, and 4 be formed to provide special municipal services to certain property described in Section 1 herein, including but not limited to:

1. Funding to meet the private contribution requirements of the Dundee Main Street organization;
2. Further the goals, efforts, and programs of the Dundee Main Street organization as defined by the Dundee Main Street Board of Directors; and
3. All legal, administration, and professional fees related to the operation of Special Service Areas No's. 2, 3, and 4; and

WHEREAS, the areas of Special Service Areas No's. 2, 3, and 4 are compact and contiguous, and constitutes a separate distinct subdivision of the Village; that the said areas will benefit specially from the municipal services to be provided; that the proposed municipal services are in addition to municipal services provided to the Village as a whole; and it is, therefore, in the best interests of the Village that the levy of special taxes against said areas for services to be provided be considered; and

WHEREAS, said services will be funded by the levy of an annual tax not to exceed the annual rate of .3 percent of the assessed value, as equalized, of the property in the Special Service Areas; and

WHEREAS, a public hearing was held on October 22, 1997, at the hour of 6:30 p.m., at 120 Barrington Avenue, East Dundee, Illinois, to consider the creation of Special Service Areas No's. 2, 3, and 4 of the Village of East Dundee within 60 days of the passage of Ordinance No. 97-25, proposing the establishment of Special Service Areas No's. 2, 3, and 4, and due notice of said hearing was given as required by 35 ILCS 200/27-30 et seq.

BE IT ORDAINED BY THE PRESIDENT AND BOARD OF TRUSTEES OF THE VILLAGE OF EAST DUNDEE, KANE COUNTY, AS FOLLOWS:

Section One. That Special Service Areas No's. 2, 3, and 4 are hereby established and consist of the territory legally described in the attached exhibit subject to the provisions of Section Two below. Special Service Areas No's. 2, 3, and 4 are considered the "downtown" areas of the Village, east of the Fox River.

Section Two. If, within 60 days of the final adjournment of the aforesaid public hearing held on October 22, 1997, the Village does not receive a petition as provided by statute objecting to the formation of Special Service Areas No's. 2, 3, and 4, this ordinance shall take full force and effect.

Section Three. After its effective date, a certified copy of this Ordinance shall be filed with the Kane County Clerk and recorded in the Office of the Kane County Recorder of Deeds.

VILLAGE OF EAST DUNDEE
SPECIAL SERVICE AREA NO. 2, 3 AND 4

EXHIBIT "A"

LEGAL DESCRIPTION FOR SPECIAL SERVICE AREA NO. 2:

That part of the West half of Section 23, Township 42 North, Range 8 East of the Third Principal Meridian described as follows:

Beginning at the intersection of the easterly line of Block 3 of Edwards Addition to the Village of East Dundee, Kane County, Illinois with the northerly line of Barrington Avenue; thence northerly along the easterly line of said Block 3, 100.0 feet; thence easterly along a line which is perpendicular to the easterly line of Block 3 aforesaid 49.0 feet, more or less, to a curved line, concave to the southwest, being concentric with and 25.0 feet southwesterly, measured radially, from the center line of the now abandoned Chicago and Northwestern Company's main track; thence southeasterly along said curved line to the northerly line of Barrington Avenue; thence easterly along said northerly line of Barrington Avenue to a curved line, concave to the southwest, being concentric with and 33.0 feet northeasterly, measured radially from the said center line of the now abandoned Chicago and Northwestern Company's main track; thence northwesterly along said curved line to a point in a line that is parallel with and 50.0 feet westerly, measured at right angles, from the northerly extension of the center line of the tangent portion of the main track of the Chicago and Northwestern Company's, as said main track (now removed) was originally located and established over and across said Section 23 and as it existed southeasterly of Railroad Street; thence northerly along said parallel line for a distance of 42.0 feet, more or less, to a point on the easterly extension of the northerly line of North Street; thence northwesterly parallel with said original main track centerline extended, a distance of 469.97 feet; thence southeasterly along a line which forms an angle of 107 degrees 10 minutes 29 seconds to the right with the prolongation of the last described line at the last described point, a distance of 238.11 feet; thence southwesterly along a line which forms an angle of 100 21' 01" to the right with the prolongation of that last described line at the last described point, a distance of 288.16 feet to a point in the easterly line of the Chicago and Northwestern right-of-way, being a line parallel with and 50.0 feet easterly, measured at right angles, from the said northerly extension of the centerline of the tangent portion of the main track (now removed) as originally located and established over and across said Section 23 and as it existed southeasterly of Railroad Street; thence southerly along said easterly right-of-way line 149.51 feet to the easterly extension of the northerly line of North Street; thence easterly 80.47 feet along said easterly extension of the northerly line of North Street to the westerly line of Block 4 of Edwards Addition aforesaid; thence southeasterly 15.0 feet, more or less, along said westerly line of Block 4 to a point in the northerly line of the southerly 10 feet of Lot 11 in said Block 4; thence northeasterly along said northerly line of the southerly 10 feet of Lot 11, 60 feet to the easterly line of said Block 4 of

Third Street, for a record distance of 610 feet to the northwest corner of Block 2 of Edwards Addition to Dundee aforesaid; thence northeasterly 130 feet along the northerly line of said Block 2 to the northeast corner thereof; thence northwesterly 60.0 feet along the northerly extension of the easterly line of said Block 2, being also the southerly extension of the easterly line of Block 3 of Edwards Addition aforesaid to the point of beginning; **except** therefrom dedicated, deeded or used for public highways and streets, **except** the easterly 3.5 feet of Lot 7, and Lots 8 and 9 in Block 4 in the Plat of East Dundee; **except** that portion of Railroad North in Edwards Addition to Dundee bounded on the west by a line that is parallel with and 87.5 feet easterly, measured at right angles, of the easterly line of Block 2 in the Plat of East Dundee, bounded on the north by the southerly line of Barrington Avenue, bounded on the south by the northerly line of Railroad Street, and bounded on the east by a line that is parallel with and 50 feet westerly, measured at right angles, of the westerly line of Block 5 in the Plat of East Dundee; **except** that part of the Northwest quarter of the Southwest quarter of Section 23, Township 43 North, Range 8 East of the Third Principal Meridian described as follows: Beginning at the point of intersection of the south line of Railroad Street with a line that is parallel with and 50.0 feet southwesterly, as measured at right angles, from the southwesterly line of Block 6, in Edward's Addition to the Village of East Dundee, Kane County, Illinois; thence southeasterly along the line that is parallel with and 50.0 feet southwesterly, as measured at right angles, from the southwesterly line of said Block 6 for a distance of 118.81 feet to a point of curvature; thence southerly along a curve to the right, having a radius of 344.06 feet, and being tangent to the last described line at the last described point for an arc distance of 157.72 feet to a point of tangency; thence southwesterly along a line that is tangent with the last described point for a distance of 4.22 feet, said line herein after referred to as Line "A", to a point in the north line of Hill Street (formerly known as South Street); thence southwesterly along the said northerly line of Hill Street for a distance of 17.62 feet to a point in a line that is parallel with and 25.0 feet easterly, as measured at right angles, from the center line of the main track (now removed) of the Chicago and Northwestern Transportation Company; thence northwesterly along said line that is parallel with and 25.0 feet easterly, as measured at right angles, from the center line of the Chicago and Northwestern Transportation Company's main track for a distance of 8.82 feet to a point in a line that is parallel with and 20.0 feet northwesterly, as measured at right angles, from Line "A" aforesaid; thence northeasterly along the said line that is parallel with and 20.0 feet northwesterly as measured at right angles, from Line "A" aforesaid, for a distance of 3.49 feet to a point of curvature; thence northerly along a curve to the left, having a radius of 324.06 feet, and being tangent to the last described line at the last described point for an arc distance of 148.55 feet to a point of tangency; thence northwesterly along a line that is tangent with the last described curve at the last described point, said line being also parallel with and 70.0 feet southwesterly, as measured at right angles, from the southwesterly line of Block 6 in Edwards Addition to the Village of East Dundee aforesaid, for a distance of 119.70 feet to a point in the south line of Railroad Street; thence northeasterly along the said south line of Railroad Street for a distance of 20.0 feet to the point of beginning, all in the Village of East Dundee, Kane County, Illinois; and **except** the westerly 14 feet of the following described property: That part of the Northwest quarter of the Southwest quarter of Section 23, Township 43 North, Range 8 East of the Third Principal Meridian lying between the northerly line of Railroad Street and the southerly line of Barrington Avenue, and lying between lines parallel with and distant 25 feet easterly and 22.5 feet westerly, measured at right angles and radially, from the centerline of the main track (now removed) of said Chicago and

Edwards Addition; thence southeasterly along said easterly line of Block 4 and of Block 5 of Edwards Addition to the westerly extension of the north line of Lot 9 in Block 11 of Edwards Addition; thence northeasterly along said extension of the north line and along said north line of Lot 9 in Block 11 to the northeast corner of said Lot 9; thence southeasterly 50 feet along the easterly line of said Lot 9 and Lot 8 to the southeast corner of Lot 8 in Block 11 of Edwards Addition; thence southwesterly along the south line of said Lot 8 and the southwesterly extension thereof to the easterly line of Block 5 of Edwards Addition aforesaid; thence southeasterly along said easterly line of Block 5 and Block 6 of said Edwards Addition to the southeasterly corner of said Block 6; thence southwesterly 60 feet along the southerly line of said Block 6 to the southwesterly corner thereof; thence southwesterly to the northwest corner of the easterly 36 feet of Lot 5 in Block 2 in the Plat of East Dundee, being also the easterly line of River Street; thence southeasterly 120 feet, more or less, along the westerly line of the easterly 36 feet of said Lot 5 to the southerly line thereof; thence northeasterly 102 feet, more or less, along the southerly line of Lot 5 and Lot 4 in said Block 2 to the northeast corner of Lot 7 in Block 2 aforesaid; thence southeasterly 120 feet along the easterly line of said Lot 7 to the southeast corner thereof; thence southwesterly to the northeast corner of the westerly 39 feet of Lot 4 in Block 5 in the Plat of East Dundee; thence southeasterly 120 feet along the easterly line of the westerly 39 feet of Lot 4 in Block 5 aforesaid to the southerly line thereof; thence northeasterly along said southerly line of Lot 4 and Lot 3, being also the northerly line of Lot 7 and Lot 8 in said Block 5, for a distance of 60 feet, more or less, to the northeast corner of the westerly half of Lot 8 in Block 5 aforesaid; thence southeasterly 120 feet along the easterly line of the westerly half of said Lot 8 to the southeast corner thereof; thence westerly along the southerly line of Block 5 in the Plat of East Dundee and the westerly extension thereof 225 feet, more or less, to the southeast corner of Block 4 in the Plat of East Dundee, aforesaid, being also in the westerly right-of-way line of River Street; thence southeasterly 146 feet, more or less, along said westerly line of River Street and along the easterly line of Block 9 in the Plat of East Dundee to a point in the northerly line of the southerly 40 feet of Lots 1 and 2 and the easterly 6 feet of Lot 3, all in Block 9 aforesaid; thence southwesterly along said northerly line 138 feet to a point in the westerly line of the said easterly 6 feet of Lot 3; thence southeasterly 40 feet along said westerly line of the easterly 6 feet of Lot 3 to the southerly line of Lots 3, 2 and 1 in Block 9 aforesaid; thence northeasterly 138 feet along said southerly line of Lots 3, 2 and 1 to a point in the easterly line of Block 9 aforesaid; thence southeasterly 120 feet along said easterly line of Block 9 to the southeast corner of Lot 10 thereof; thence westerly along the southerly line of Lots 10, 9, 8, 7 and 6 of Block 9 aforesaid and the westerly extension thereof to the easterly bank of the Fox River; thence northerly along the easterly bank of the Fox River to the northerly line of the southerly 63 feet of Lot 3, as measured along the westerly line of Water Street, in Haertel's Subdivision; thence northeasterly along said northerly line and the northeasterly extension thereof to a point in the easterly line of Water Street; thence northwesterly along said easterly line of Water Street to a point in the westerly extension of the southerly line of Lots 3, 4 and 5 of Block 3 in the Plat of East Dundee; thence northeasterly along said westerly extension and of the southerly line of Lots 5, 4 and 3 to the southeast corner of Lot 3; thence northwesterly 170 feet, more or less, along the easterly line of said Lot 3 and the northwesterly extension thereof to a point in the southerly line of Block 1 of Edwards Addition to Dundee aforesaid; thence southwesterly along said southerly line to the southwest corner of Block 1 aforesaid; thence northwesterly along the westerly line of Block 1 and Block 2 of said Edwards Addition to Dundee, being also the easterly right-of-way line of

Northwestern Transportation Company, as located prior to its removal.

LEGAL DESCRIPTION FOR SPECIAL SERVICE AREA NO. 3:

Lots 6, 7, 8, 9 and 10 in Block 11 in the Plat of East Dundee, in the Village of East Dundee, Kane County, Illinois.

LEGAL DESCRIPTION FOR SPECIAL SERVICE AREA NO. 4:

That part of the Northwest quarter of Section 26, Township 42 North, Range 8 East of the Third Principal Meridian bounded on the north by the southerly line of Block 14 in the Plat of East Dundee and the westerly extension thereof, bounded on the east by the westerly line of Van Buren Street, bounded on the south by the northerly line of Williams Place, and bounded on the west by the easterly line of River Street, all in the Village of Est Dundee, Kane County, Illinois.

SUBDIVISION REFERENCE

- WALKER'S, EATON, ADD. 1/4"
- EDWARDS, ALMED, SUB. 1/4"
- LAKEMOOD LODGE ESTATES 1/4"
- EDWARD'S ADD. TO DUNDEE 1/4"
- OWNER'S SUB. OF PT. BLK. 7 1/4"
- EDWARD'S ADD. & BLK. 1 OF 1/4"
- ASSIGNOR'S EXT. OF EDWARD'S ADD. 1/4"
- HAERTEL'S SUB. 1/4"
- EAST DUNDEE ORIGINAL TOWN 1/4"
- WEST DUNDEE ORIGINAL TOWN 1/4"
- MUSSELL'S, JOSEPH, ADD 1/4"
- EAST DUNDEE, VILLAGE OF, ACRES OF BLK. 8 1/4"

SPECIAL SERVICE AREA #2

SPECIAL SERVICE AREA #3

SPECIAL SERVICE AREA #4

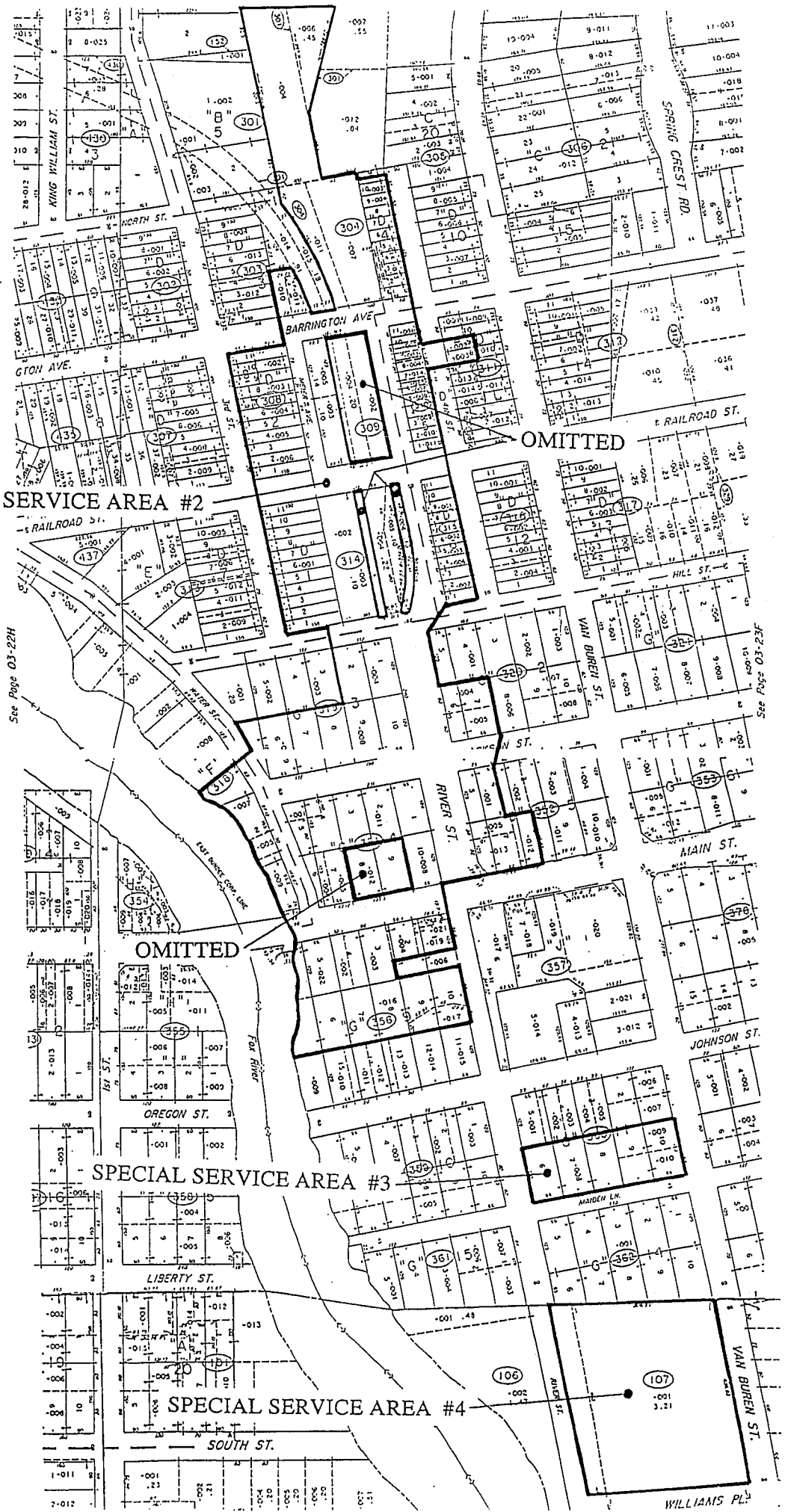

- RIVERSIDE ADD. TO DUNDEE 1/4"
- RIKEL'S RIVER BARPOOKS ADD. 1/4"

See Page 03-22H

See Page 03-23F

Section Four. Severability. If any section, paragraph, or provision of this ordinance shall be held to be invalid or unenforceable for any reason, the invalidity or unenforceability of such section, paragraph or provision shall not affect any of the remaining provisions of this ordinance.

Section Five. Repeal. All ordinances, resolutions, motions or parts thereof in conflict herewith shall be and the same are hereby repealed.

Section Six. Publication and Effective Date. This ordinance shall be in full force and effect on the date first following the passage of 60 days after the final adjournment of the public hearing aforesaid; but only if no petition conforming to statute has been filed with the Village objecting to said Special Service Areas. This ordinance shall be published in pamphlet form as provided by law.

Adopted this 22nd day of October, 1997, pursuant to a roll call vote as follows:

AYES: Bartels, Albrecht, Szalla, Zaeske, Ahrens, Arnone.
NYES: None
ABSENT: None.

Approved by me this 22nd day of October, 1997.

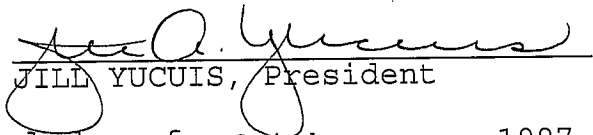
JILL YUCUIS, President

Published in pamphlet form this 23rd day of October, 1997, under the authority of the President and Board of Trustees.

ATTEST:

JANE THEIS, Village Clerk

Recorded in the Village Records on October 23rd, 1997.
C:\WP51\EASTDUND\SPCLSRV2.ORD

