

Ordinance No. 14-02

**ORDINANCE APPROVING A PLAT OF DEDICATION FOR A PORTION OF MEIER STREET  
IN THE VILLAGE OF EAST DUNDEE, ILLINOIS**

**WHEREAS**, the Village of East Dundee, Kane and Cook Counties, Illinois (the “Village”), is a home-rule municipality authorized by Article VII, Section 6(a) of the Constitution of the State of Illinois of 1970; and,

**WHEREAS**, in furtherance of development, it is necessary for the Village to widen Meier Street and to approve a Plat of Dedication to permit such improvements to Meier Street as hereinafter set forth.

**NOW, THEREFORE, BE IT ORDAINED**, by the President and Board of Trustees of the Village of East Dundee, Kane and Cook Counties, Illinois, that the Plat of Dedication prepared by Gerald L. Heinz & Associates, dated January 3, 2014, as attached to this Ordinance, is hereby approved, and the Village Clerk is hereby authorized to record said Plat with the Kane County Recorder.

This Ordinance shall be in full force and effect upon its adoption, approval and publication in pamphlet form as provided by law.

**PASSED** this 13 day of January, 2014, pursuant to a roll call vote as

follows:

AYES: Trustees Gorman, Lynam, Skillieorn, Selep and Wood

NAYS: Ø

ABSENT: Trustee Ruffulo

**APPROVED:**

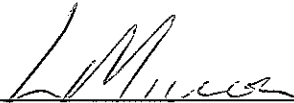
  
\_\_\_\_\_  
President

*Attest:*  
  
\_\_\_\_\_  
Village Clerk

Alternatives

# PLAT OF DEDICATION

## IN THE VILLAGE OF EAST DUNDEE, ILLINOIS

BEING A PART OF THE SOUTHWEST QUARTER OF SECTION 23, TOWNSHIP 42 NORTH, RANGE 8, EAST OF THE THIRD PRINCIPAL MERIDIAN, IN THE VILLAGE OF EAST DUNDEE, KANE COUNTY, ILLINOIS.

### LEGAL DESCRIPTION FOR RIGHT-OF-WAY DEDICATION (MEIER STREET)

THAT PART OF THE SOUTHWEST QUARTER OF SECTION 23, TOWNSHIP 42 NORTH, RANGE 8, EAST OF THE THIRD PRINCIPAL MERIDIAN DESCRIBED AS FOLLOWS:

BEGINNING AT A POINT ON THE SOUTHERLY LINE OF BARRINGTON AVENUE, 22.5 FEET WESTERLY OF, MEASURED AT RIGHT ANGLES, THE CENTER LINE OF THE MAIN TRACK OF THE CHICAGO AND NORTH WESTERN RAILWAY COMPANY, AS NOW LOCATED AND ESTABLISHED; THENCE SOUTHERLY PARALLEL WITH THE CENTER LINE OF SAID MAIN TRACK 275 FEET TO THE NORTHERLY LINE OF RAILROAD STREET; THENCE WESTERLY ALONG THE NORTHERLY LINE OF RAILROAD STREET, 49.5 FEET TO A POINT 38 FEET EASTERLY OF, MEASURED AT RIGHT ANGLES, THE EASTERLY LINE OF BLOCK 2 OF EDWARD'S ADDITION TO DUNDEE; THENCE NORTHERLY PARALLEL WITH THE EASTERLY LINE OF SAID BLOCK 2, 275 FEET TO THE SOUTHERLY LINE OF BARRINGTON AVENUE; THENCE EASTERLY ALONG THE SOUTHERLY LINE OF BARRINGTON AVENUE, 49.5 FEET TO THE POINT OF BEGINNING, IN THE VILLAGE OF EAST DUNDEE, KANE COUNTY, ILLINOIS.

TOTAL AREA OF DEDICATION 0.313 ACRES (MORE OR LESS).

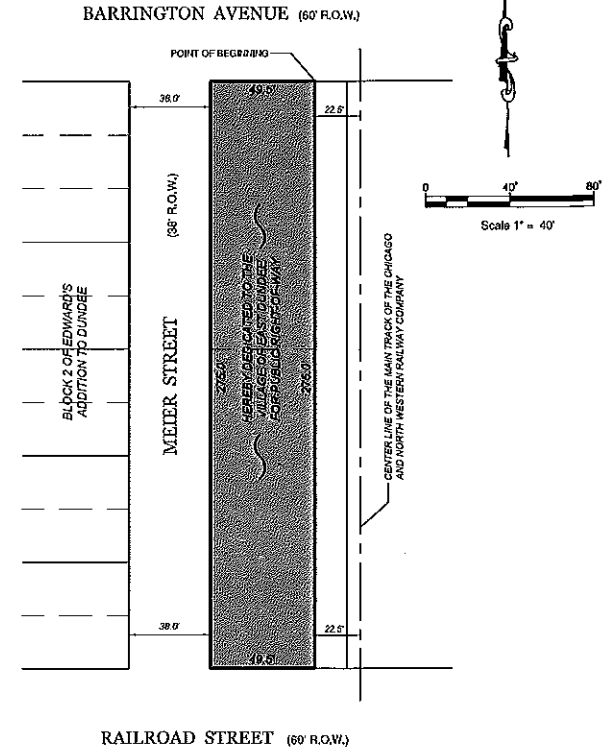

### COUNTY CLERK'S CERTIFICATE

STATE OF ILLINOIS }  
COUNTY OF KANE } ss.

I, \_\_\_\_\_, COUNTY CLERK OF KANE COUNTY, ILLINOIS, DO HEREBY CERTIFY THAT THERE ARE NO DELINQUENT GENERAL TAXES, NO UNPAID FORFEITED TAXES, AND NO REDEEMABLE TAX SALES AGAINST ANY OF THE LAND INCLUDED IN THE PLAT HEREIN DRAWN. I FURTHER CERTIFY THAT I HAVE RECEIVED ALL STATUTORY FEES IN CONNECTION WITH THE PLAT HEREIN DRAWN.

GIVEN UNDER MY HAND AND SEAL AT GENEVA, KANE COUNTY, ILLINOIS, THIS \_\_\_\_ DAY OF \_\_\_\_\_ AD. 2014.

COUNTY CLERK

### KANE COUNTY RECORDER'S CERTIFICATE

STATE OF ILLINOIS }  
COUNTY OF KANE } ss.

THIS INSTRUMENT NO. \_\_\_\_\_ WAS FILED FOR RECORD IN THE RECORDER'S OFFICE OF KANE COUNTY, ILLINOIS, ON THE \_\_\_\_ DAY OF \_\_\_\_\_, A.D., 20\_\_\_\_ AT \_\_\_\_ O'CLOCK, \_\_\_\_ M.

COUNTY RECORDER

### CERTIFICATE OF DEDICATION APPROVAL

STATE OF ILLINOIS }  
COUNTY OF KANE } ss.

THIS PLAT OF DEDICATION HAS BEEN APPROVED BY THE VILLAGE BOARD OF TRUSTEES OF THE VILLAGE OF EAST DUNDEE, ILLINOIS AT A MEETING HELD ON THIS 13 DAY OF January, A.D. 2014.

*[Signature]*  
VILLAGE PRESIDENT  
*[Signature]*  
VILLAGE CLERK

### OWNER'S CERTIFICATE

STATE OF ILLINOIS }  
COUNTY OF KANE } ss.

THIS IS TO CERTIFY THAT THE UNDERSIGNED IS THE OWNER OF THE LAND DESCRIBED IN THE PLAT, AND HAS CAUSED THE SAME TO BE SURVEYED, AS INDICATED THEREON, FOR THE USES AND PURPOSES THEREIN SET FORTH, AND DOES HEREBY ACKNOWLEDGE AND ADOPT THE SAME UNDER THE STYLE AND TITLE THEREON INDICATED.

WITNESS OUR HANDS AND SEALS THIS 14 DAY OF January, A.D. 2014.

BY: *[Signature]*  
FOR: VILLAGE OF EAST DUNDEE

### NOTARY CERTIFICATE

STATE OF ILLINOIS }  
COUNTY OF KANE } ss.

BEFORE ME THE UNDERSIGNED NOTARY PUBLIC, IN AND FOR THE COUNTY AND STATE AFORESAID, PERSONALLY APPEARED Robert A. Skelton AND EACH SEPARATELY AND SEVERALLY ACKNOWLEDGED THE EXECUTION OF THE FOREGOING INSTRUMENT AS HIS OR HER VOLUNTARY ACT AND DEED, FOR THE PURPOSES THEREIN EXPRESSED.

WITNESS OUR HANDS AND SEALS THIS 14 DAY OF January, A.D. 2014.

*[Signature]*  
NOTARY PUBLIC  
MY COMMISSION EXPIRES 5/28/17



### SURVEYOR'S CERTIFICATE

STATE OF ILLINOIS }  
COUNTY OF KANE } ss.

I, JOSEPH D. HEINZ, ILLINOIS PROFESSIONAL LAND SURVEYOR NO. 3551, DO HEREBY CERTIFY THAT I HAVE SURVEYED THE ABOVE DESCRIBED PROPERTY AND THAT THE PLAT HEREON DRAWN CORRECTLY REPRESENTS SAID SURVEY.

DATED AT EAST DUNDEE, ILLINOIS  
THIS 3rd DAY OF JANUARY, 2014, A.D.



*[Signature]*  
ILLINOIS PROFESSIONAL LAND SURVEYOR NO. 3551  
LICENSE EXPIRES 11-30-14  
DESIGN FIRM REGISTRATION NO. 184-002048

GERALD L. HEINZ & ASSOCIATES, INC.  
CONSULTING ENGINEERS & LAND SURVEYORS  
206 NORTH RIVER STREET  
EAST DUNDEE, ILLINOIS 60118

PLAT OF DEDICATION

MEIER STREET  
EAST DUNDEE, ILLINOIS

This drawing is copyrighted and is the sole property of GERALD L. HEINZ & ASSOCIATES, INC. Reproduction or use of this drawing in whole or in part and/or the information contained in it is forbidden without the written consent of GERALD L. HEINZ & ASSOCIATES, INC. Unauthorized use will be prosecuted to the fullest extent of the law.

DATE: 01/03/14  
JOB NO.: ED-2000  
SCALE: 1"=40'  
SHEET 1 of 1