

ADDENDUM NUMBER 1

FOR THE

CITY OF CORCORAN

WATER WELL 5F & 8C

March 23, 2023



OWNER:

**City of Corcoran
832 Whitley Avenue
Corcoran, CA 93212
(559) 992-2151**

PREPARED BY:

**A&M Consulting Engineers
220 N Locust Street
Visalia, CA 93291
(559) 429-4747**

ADDENDUM NUMBER 1

The following additions, deletions or modifications shall become part of the Contract Documents for the City of Corcoran Water Well 5F & 8C project:

CONTRACTOR QUESTIONS:

Q1: Who will be responsible for construction staking?

A1: The contractor is responsible for the construction staking work.

--

Q2: Please clarify the quantity of separators needed. The plans show a quantity of two (2) PWC-1080-V separators (one per site, 5F & 8C) is this correct?

A2: Only one will be required. The existing separator at site "8" will be relocated.

--

Q3: Is there a Well Completion Report for Well 8B? What is the casing depth and diameter?

A3: Yes, it's been attached. 16" Outside Diameter, Depth of Boring 945 feet, Depth of completed Well 920 feet.

--

Q4: Are there specs for the vertical turbine pumps? What is the pump setting (depth) and what is the design point (head and flow rate)?

A4: No vertical pump is called out. The vertical pump will be selected once the water well work is completed and developed. This scope of work will be addressed as change order work.

--

Q5: Please clarify if the pump and installation of the pump will be approved and paid as change order work or if it is part of the contract?

A5: The pump installation will be approved and paid as change order work.

--

Q6: Will electrical/instrumentation design with conduit locations, wiring diagrams, conduit sizes be provided for both 5F and 8C?

A6: Electrical/instrumentation design will be provided for Well 5F. All existing conduits/instrumentation for Well 8C will need to be extended to the new location. The previous plans for the site have been attached for reference.

--

Q7: Bid Item 2 for Water Well 8C, description describes rewiring existing transformer and MCC from well 8B (abandonment) to service location 8C, can you provide existing MCC model and spec info for electrical subcontractors to evaluate? Or a Electrical plan defining what all work is included in this bid item?

A7: The previous plans for the water well 8 site have been attached for reference.

--

Q8: The specifications indicate that contractor shall complete work within 60 Calendar Days from the Notice to proceed. Amongst the industry we are seeing unforeseen, and uncontrollable delayed delivery dates on many materials. Can you confirm that the owner will work with the general contractor on contract duration once the project is awarded and product lead times are solidified? If not, should contractors account for liquidated damages in their bids?

A8: The city will work with the contractor on project completion days.

--

Q9: Please confirm that the project duration time is longer than the 60 calendar days as indicated in the project specifications. Pump and electrical submittals alone will take around 60 calendar days to procure. Pump and MCC lead times are typically more than 35 weeks after approved submittals.

A9: The city will work with the contractor on project completion days.

--

Q10: Will there be a secondary pre-bid meeting for those who could not make it to the mandatory pre-bid meeting due to the weather and road conditions?

A10: Yes, the city will be scheduling a second pre-bid meeting. It will only be mandatory for those that didn't make the first one.

--

Q11: Bid Item 2 for Water Well 8C, description describes "relocating and installing all existing piping and connections including but not limited to valves, sand separator, electromagnetic flow meter, pressure sensor, pre-lube tubing," Plan sheet 2 of well 8C plans shows only relocating Shade Structure and certain piping with arrows including underground DIP, valves, tanks and other appurtenances, not clearly defined. Will new hardware, gaskets, bolts, pipe supports, etc. be required for this pipe relocation? if so, how many, what sizes and class, metal type, are they? Can you confirm that on drawing 5 we are replacing underground piping with C900 is this correct? What will be required of the contractor for warranty of this relocated equipment, as it is used? Will any non functioning or non operational or previously damaged items be replaced by the City? What are the testing parameters for used equipment relocated?

A11: New hardware, gaskets, bolts, pipe supports, etc. will be required for all pipe relocations. No warranty will be required for relocated equipment. However, a fully functioning water well is expected before the project closeout. Any non-functioning or non-operational or previously damaged items will be replaced by the city. Any items which are found to have issues shall be reported to the city before commencing work.

--

Q12: Per the General Provision, Section 3-13.3 Warranty, the warranty period is not specified. Please confirm the warranty period will be 1 year to align with the most recent Standard Specification for Public Works Construction.

A12: Yes, the warranty period will be 1 year.

--

Q13: Please clarify the following regarding the bidder's bond; are bidders to provide an electronic bidder's bond via email as instructed in the Notice Inviting Bids or submit a paper bond with their Bid on the Bid Bond form provided in the project specifications?

A13: Submit a paper bond with their Bid on the Bid Bond form provided in the project specifications.

--

Q14: Please confirm owner is responsible for paying for soils testing, competition, and concrete testing.

A14: The city will pay for all testing requirements. The contractor will pay for any failed tests.

--

Q15: Please confirm a formal PG&E plan will be provided before bid date to adequately acquire pricing on the PG&E connection charge the contractor is to be responsible for as stated in the project specifications.

A15: No PG&E plan will be provided. PG&E connection will be addressed on a separate scope of work.

--

Q16: What is the status of the existing well drilling being performed at the sites? What well head equipping should we (the contractor) expect to be performing? Welding a flange on the casing? Modifying the casing to elevation? Extending sounding tubes, casing vents, etc?

A16: The only work that is expected from the contractor is to install a flange to install the vertical pumps.

--

Q17: Will a water well abandonment permit be required?

A17: Yes, as shown on the plans per AWWA standards.

--

Q18: Will bidding line items be provided or should we expect this project to be only (2) lump sum bid items?

A18: Only two lump sum items.

--

Q19: What exact MBE requirements are on this project?

A19: It is strongly encouraged but optional.

--

Q20: Will an engineered slab be required under the MCC?

A20: Yes, include a 6" concrete slab with No. 4 rebars at 18" on center both ways over 6" Aggregate Base Class 2, over 12" native soil compacted to 90% relative density.

--

Q21: Would the engineer please entertain pushing the bid date back at least a week (if not more), due to missing portions of the project specifications?

A21: Yes, the dates have been revised.

--

Q22: Per the specifications the city of Corcoran is charging the contractor for a utility water connection to a watermain? This seems counterintuitive if we are performing work for them. Please clarify.

A22: No utility water connection fee will be charged.

--

Q23: Please confirm there are no pump to waste facilities and/or drainage piping will be required at the well sites (ie. Pump control valves, drop inlets, storm drain, etc.)

A23: All storm drain improvements are shown on the plans.

--

Q24: Please confirm there are no chlorination (ie. Disinfection) facilities located at the well sites.

A24: No chlorination facilities are located at the well sites.

--

Q25: Will the contractor have access to construction water from the city (via. hydrant?) free of charge?

A25: A hydrant will be provided to the contractor with a water meter.

--

Q26: Where does the existing shade structure at Well 8B get moved to? The plans specify well 8C. Will the dimensions of this fit over the new pump or on the new pedestal at Well 8C?

A26: The shade structure will be moved to the new well location. The contractor will need to make sure the vertical pump used will fit under the relocated shade structure.

--

Q27: Where can the contractor find the requirements of the latest NPDES General Permit for Storm Water Discharges Associated with Construction and Land Disturbance Activities Order No. 2009-0009-DWQ according to SWQCB and standard industry practice?

A27: The state water board website.

--

Q28: Will the sand separator at Well 8B be relocated to Well 8C? or will Well 8C require a new sand separator?

A28: It will be relocated.

--

Q29: On pg. 6 - the plan view - it shows the shade structure columns on one side to be 3" dia. and 4" dia. on the other side. Please Clarify what size the columns should be.

A29: 4"

--

Q30: Please provide information on the shade structure roof panels. We suggest either 26ga or 24ga PBR panel. Please clarify.

A30: 26 ga PBR panel will be used.

--

NOTE: One copy of this Addendum Number 1 shall be signed by the Contractor and must be submitted with the bid as acknowledgment of receipt and acceptance of this Addendum Number 1.

Prepared by: 
Orfil Muniz, P.E.
A&M Consulting Engineers

3/23/23
Date

Accepted by: _____
Contractor (Signature)

Date

Publish: February 2023

**NOTICE INVITING BIDS
FOR**

Water Well 5F & 8C [the “Project”]

NOTICE IS HEREBY GIVEN that the City of CORCORAN, California, will receive sealed bids from contractors licensed to do business in the State of California and qualified to provide the necessary services at City Hall of the City of Corcoran located at 832 Whitley Avenue, Corcoran, California, until **11:00 AM on May 2, 2023**, for the above project. At the time designated for receiving sealed bids on said Project, the bids will be publicly opened, examined, and read aloud.

The City of Corcoran hereby notifies all bidders that it will affirmatively ensure that, in any contract entered into pursuant to the Notice, minority business enterprises will be afforded full opportunity to submit bids in response to this invitation and will not be discriminated against on the grounds of race, color, sex, or national origin in consideration for the award.

All bids must be in writing, and the envelope containing the Proposal shall be sealed and addressed to the Agency and delivered or mailed to the Agency, City Hall, at 832 Whitley Avenue, Corcoran CA 93212. The envelope shall be plainly marked in the upper left-hand corner as follows:

ATTENTION: CITY CLERK
(Bidder's Name and Address)
PROJECT NO. **220-005 & 221-051**
PROJECT TITLE: **Water Well 5F & 8C**

Any bid received after the hour stated above for any reason whatsoever will not be considered for any purpose but will be returned, unopened, to the bidder. Each bidder must submit a proposal on standard forms available at City Hall. Said proposal is to be accompanied by a cash deposit, a certified or cashier's check, or a bidder's bond, made payable to the City of Corcoran, in an amount not less than 10 percent of the total submitted.

Bids submitted will be evaluated by the City of Corcoran. Proposals will be first evaluated for completeness. Incomplete proposals will be disqualified from consideration. The City reserves the right to reject any or all bids and to waive any informality or irregularity in any bid received and to be the sole judge of the merits of the respective bids received.

SCOPE OF WORK. The Project includes, without limitation, furnishing all necessary labor, materials, equipment, and other incidental and appurtenant Work necessary to satisfactorily complete the Project, as more specifically described in the Contract Documents. This Work will be performed in strict conformance with the Contract Documents, permits from regulatory agencies with jurisdiction, and applicable regulations. The quantity of Work to be performed and materials to be furnished are approximations only, being given as a basis for the comparison of Bids. Actual quantities of Work to be performed may vary at the discretion of the City Engineer. The work may consist of, but is not limited to: Concrete, installation of new water well pumps, apparatuses, piping, valves, and other equipment, relocation of existing water well piping, valves, apparatuses, and other equipment, and other items of, or details not mentioned above, that are required by typical construction or these special provisions.

PROJECT DESCRIPTION. Water Well 5F will include but not be limited to: construction of a new water well pump and motor, piping, valves, meters and other equipment, transformer, motor control center with shade structure, and chain link fence and security fence gates with mow strip. Water Well 8C will include but not be limited to: abandonment of existing Well 8B, installation of a new water well pump and motor, chain link fence and security fence gates with mow strip, retaining curb, and relocation of existing piping, valves, meters and other equipment.

OBTAINING BID DOCUMENTS. Full specifications and plans are available on Central Valley Builders Exchange site <https://cencalbx.com/> and the City's website https://www.cityofcorcoran.com/government/public_notices.php. Bidders shall register and be put on the bidders list by calling (559) 429-4747 or emailing orfil@am-engr.com to be considered.

A **Pre-Bid Meeting** is scheduled for **March 14, 2023, at 9:00 AM**, at the intersection of Nevada and 5th Avenue in Corcoran, CA. This meeting is to inform bidders of project requirements and subcontractors of subcontracting and material supply opportunities. **A second Pre-Bid Meeting is scheduled for April 18, 2023, at 9:00 AM, at the intersection of Nevada and 5th Avenue in Corcoran, CA. Bidder's attendance at this second meeting will be mandatory only for those who did not attend the first pre-bid meeting scheduled for March 14, 2023, at 9:00 AM.** Please direct project questions to Orfil Muniz, PE at (559) 429-4747 or by email at orfil@am-engr.com. **Bid inquiries are to be in writing and emailed to orfil@am-engr.com. Bid inquiries will end on April 25, 2023 at 4:00 p.m. Any addendums will be issued no later than April 27, 2023.**

TOTAL APPROVED PROJECT BUDGET. The City of Corcoran does not provide an Engineer's Estimate; however, the total approved Project Budget as was approved in the City for this project is approximately \$1,200,000.00. The total approved Project Budget is an estimate of the total project delivery costs which includes but is not limited to construction, engineering design, construction support, city project management and administrative costs.

REGISTRATION WITH THE DEPARTMENT OF INDUSTRIAL RELATIONS. In accordance with Labor Code Sections 1725.5 and 1771.1, no contractor or subcontractor shall be qualified to bid on, be listed in a bid proposal, subject to the requirements of Section 4104 of the Public Contract Code, or engage in the performance of any contract for public work, unless currently registered and qualified to perform public work pursuant to Section 1725.5 [with limited exceptions for bid purposes only under Labor Code Section 1771.1(a)].

PREVAILING WAGES. In accordance with Labor Code Section 1770 *et seq.*, the Project is a "public work." The selected Bidder (Contractor) and any Subcontractors shall pay wages in accordance with the determination of the Director of the Department of Industrial Relations ("DIR") regarding the prevailing rate of per diem wages. Bidders can obtain the most current prevailing

Project Name: Water Well 5F & 8C
 Pre Bid Date: 03/14/2023 @ 9:00 AM
 Bid Date: 03/28/2023 @ 11:00 AM

City of
CORCORAN
 Public Works Department FOUNDED 1914

Pre-Bid Sign-In

	COMPANY NAME	COMPANY ADDRESS	CONTACT NAME	PHONE NUMBER	EMAIL	FAX
1	Dawson-Mauldin, LLC	1071 E. Nebraska Ave Selma CA 95362	Michael Mauldin	559 896-0098	bidse@dawson-mauldin.com	559 896-1572
2	Brough Const.	634 Paintz Rd Arroyo Grande	JEFF Brough	805 489-7729	JEFF@BroughConstruction.com	805 473-2479
3	Specialty Construction	645 Clavon Court, San Luis Obispo	Jared Schlenker	951-692 -6209	jschlenker@specialtyconstruction.com	805- 543-1706
4	Zim Industries	4532 Jefferson Fresno, CA	Bob Zimmerman	(559) 351- 3427	bob@zimindustries.com	
5	Unified	6406 Downing Ave Reckersfield	Johnny White	661 578 8873	Johnny.White@UFSC.com	
6	1000 Co	1707 N CLARK ST VISALIA CA	DAVID HALOPOFF	559 805 8644	FLG@STZINC.COM	
7	WMLYLES Co.	2810 DAIKOTEN BLVD, CA 93308	KENT AMBERG	661 387 2810	KAMBERG@WMLYLES.CO.COM	
8	Steve Doual	8461 E Olive Irwin	Tim Doual	255 7603	Doual, Construction @gmail.com	
9						
10						
11						
12						

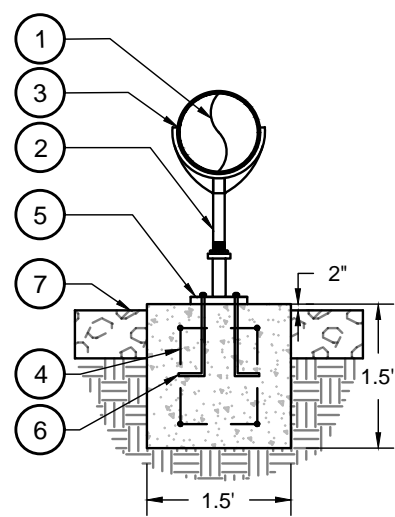

- KEYNOTE LEGEND:**
- 1 PIPE SIZE VARIES, SEE PLANS
 - 2 INSTALL ANVIL ADJUSTABLE PIPE SADDLE SUPPORT FIG 265 WITH FLANGE STAND (OR APPROVED EQUAL)
 - 3 INSTALL 1/2" THICK NEOPRENE GASKET BETWEEN PIPE SADDLE AND PIPE
 - 4 CONSTRUCT CONCRETE FOOTING FOR PIPE SUPPORT WITH #4 REBAR EACH WAY
 - 5 INSTALL 9" DIAMETER 150 LB THREAD REDUCING FLANGE
 - 6 FLANGE STAND SHALL BE BOLTED TO BASED WITH J-HOOK CAST IN PLACE BOLTS OR POWER DRIVEN ANCHORS (TYP. OF 4)
 - 7 FINISHED GRADE OF ADJACENT CRUSHED ROCK SURFACING

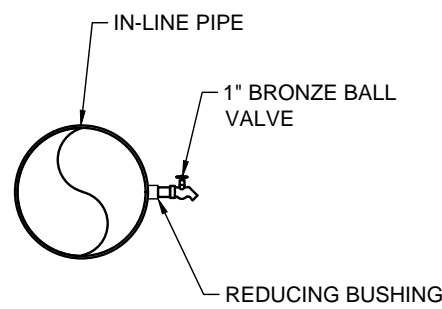

DETAIL 2 - SAMPLING TAP
SCALE: N.T.S.

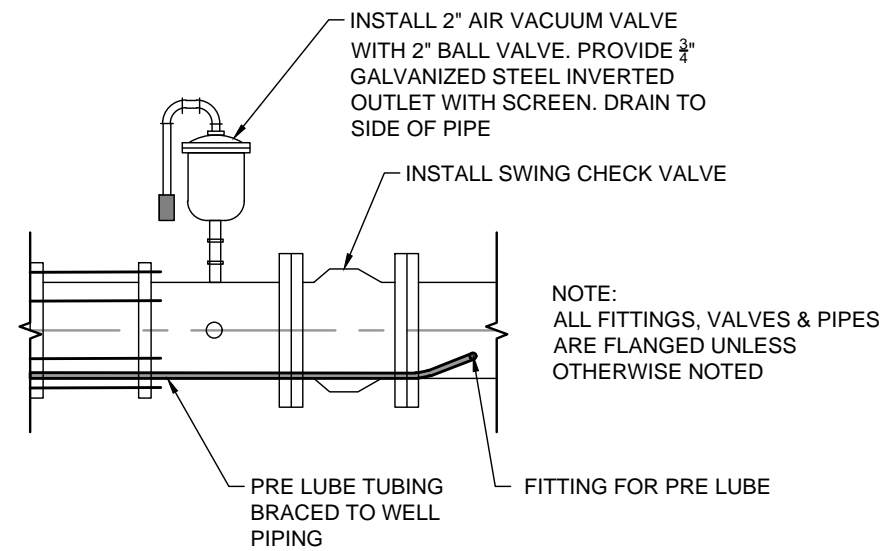

DETAIL 3 - CONTROL VALVE
SCALE: N.T.S.

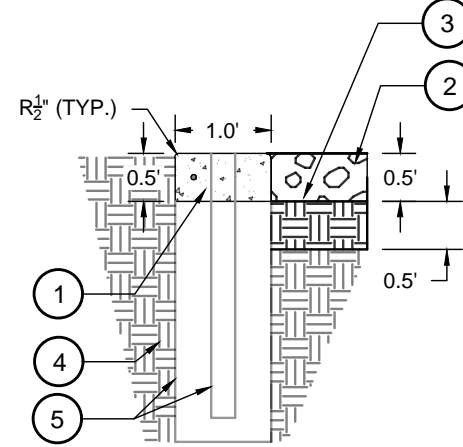

- KEYNOTE LEGEND:**
- 1 CONSTRUCT 12" X 6" CONCRETE MOW STRIP WITH CONTINUOUS #4 REBAR, CENTERED VERTICALLY IN MOW STRIP
 - 2 ADJACENT CRUSHED ROCK SURFACING
 - 3 COMPACT 6" OF NATIVE SOIL AT 90% RELATIVE COMPACTION
 - 4 NATIVE SOIL
 - 5 CHAIN-LINK FENCE POST AND FOOTING PER CITY STANDARD DETAILS M-10 AND M-11 ON SHEET 7
- CONTRACTOR NOTE:**
1. CONTROL JOINTS SHALL BE INSTALLED EVERY 10' ON CENTER
 2. EXPANSION JOINTS SHALL BE INSTALLED EVERY 30' ON CENTER

DETAIL 4 - CONCRETE MOW STRIP
SCALE: N.T.S.

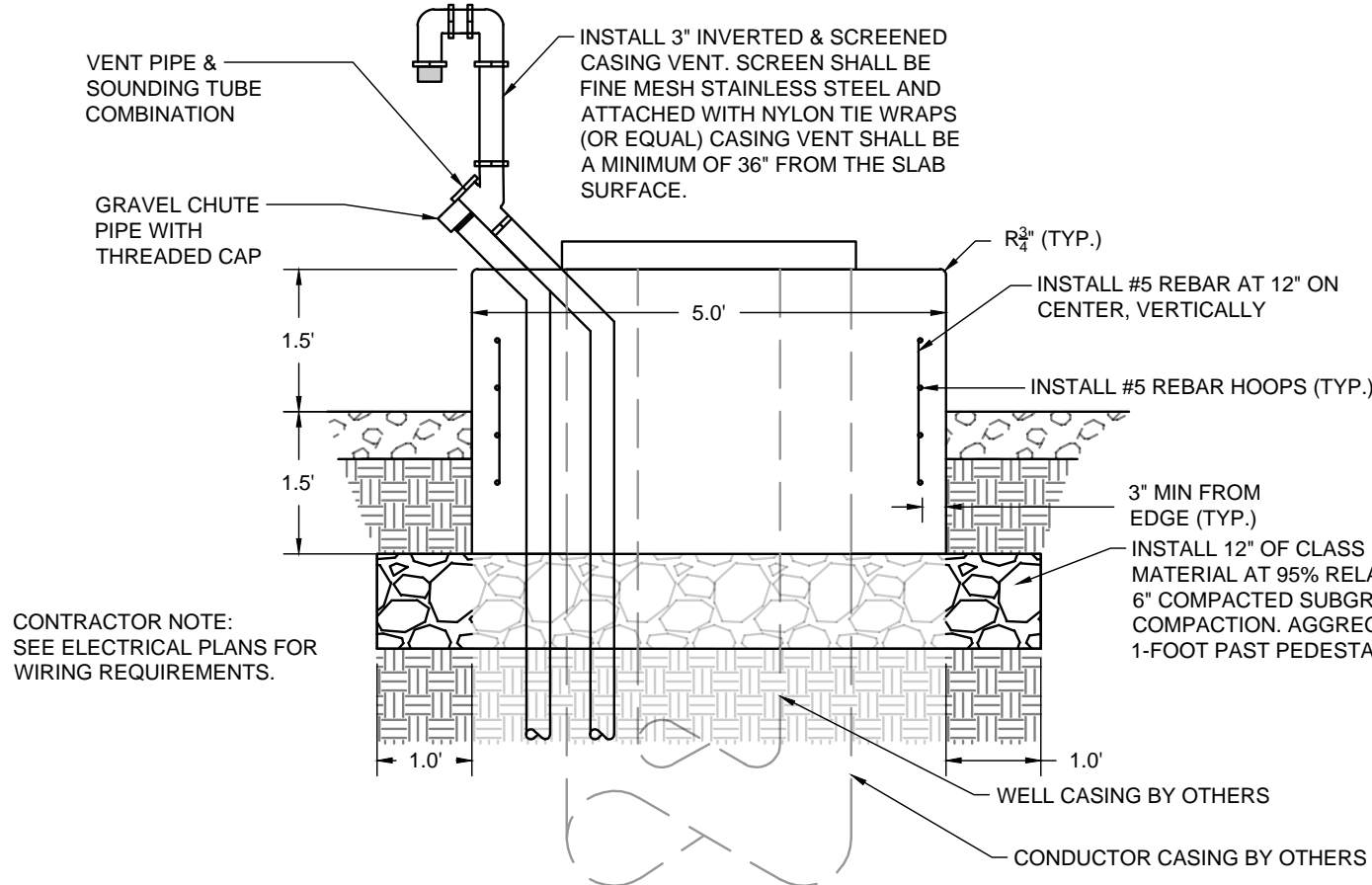

DETAIL 5 - PUMP PEDESTAL
SCALE: N.T.S.

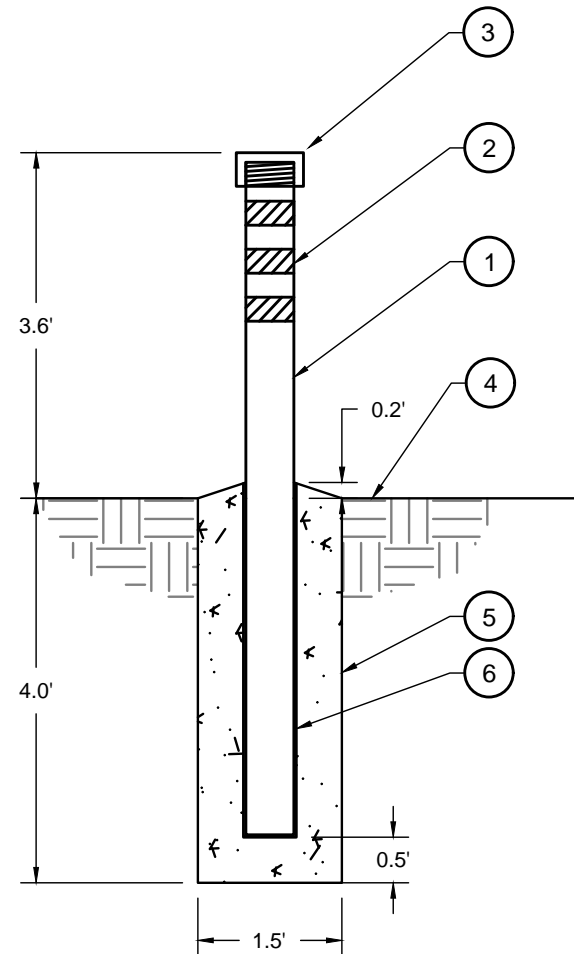

DETAIL 6 - REMOVABLE POSTS
SCALE: N.T.S.

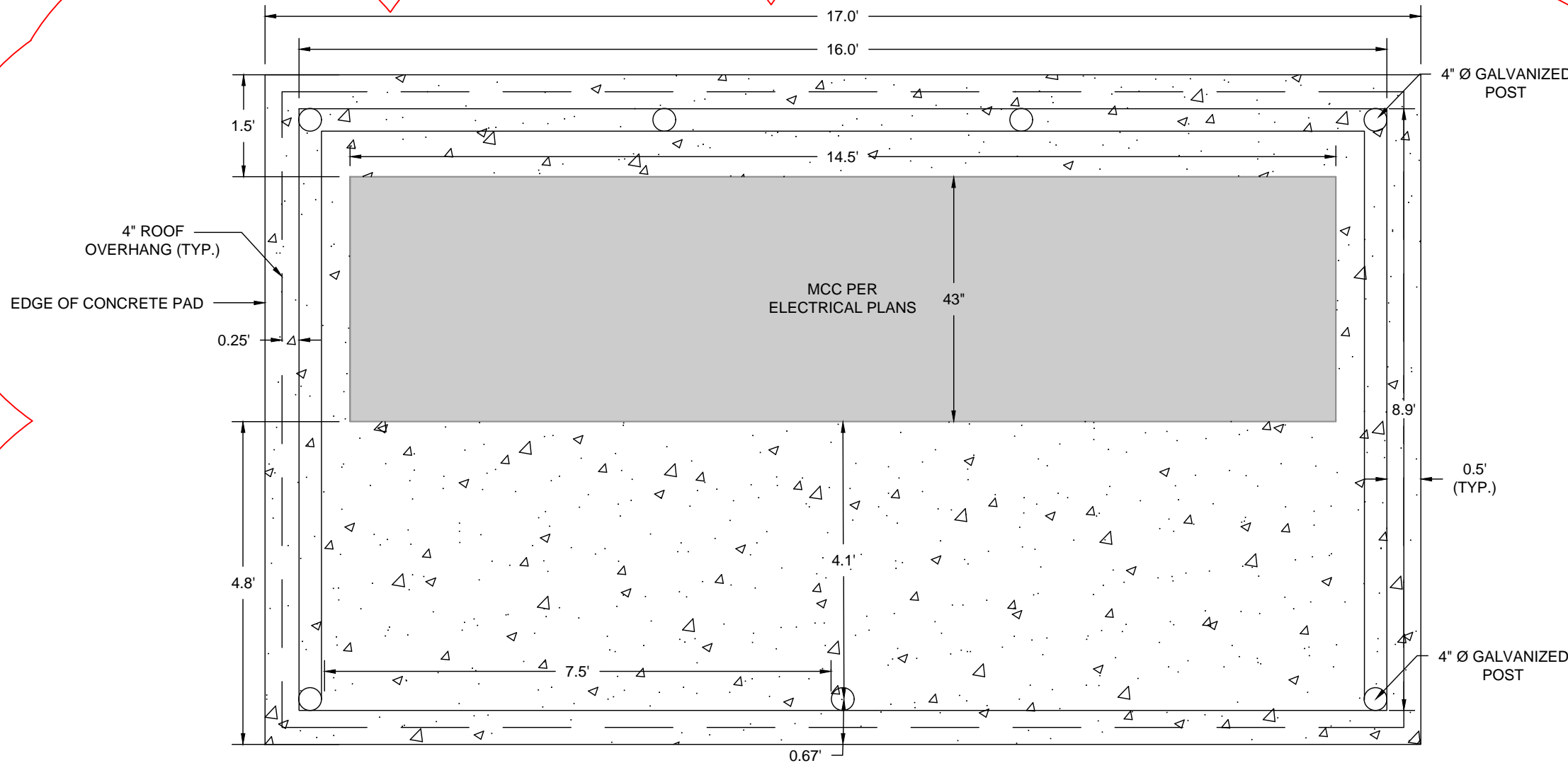

DETAIL 7 - MCC (PLAN VIEW)
SCALE: N.T.S.

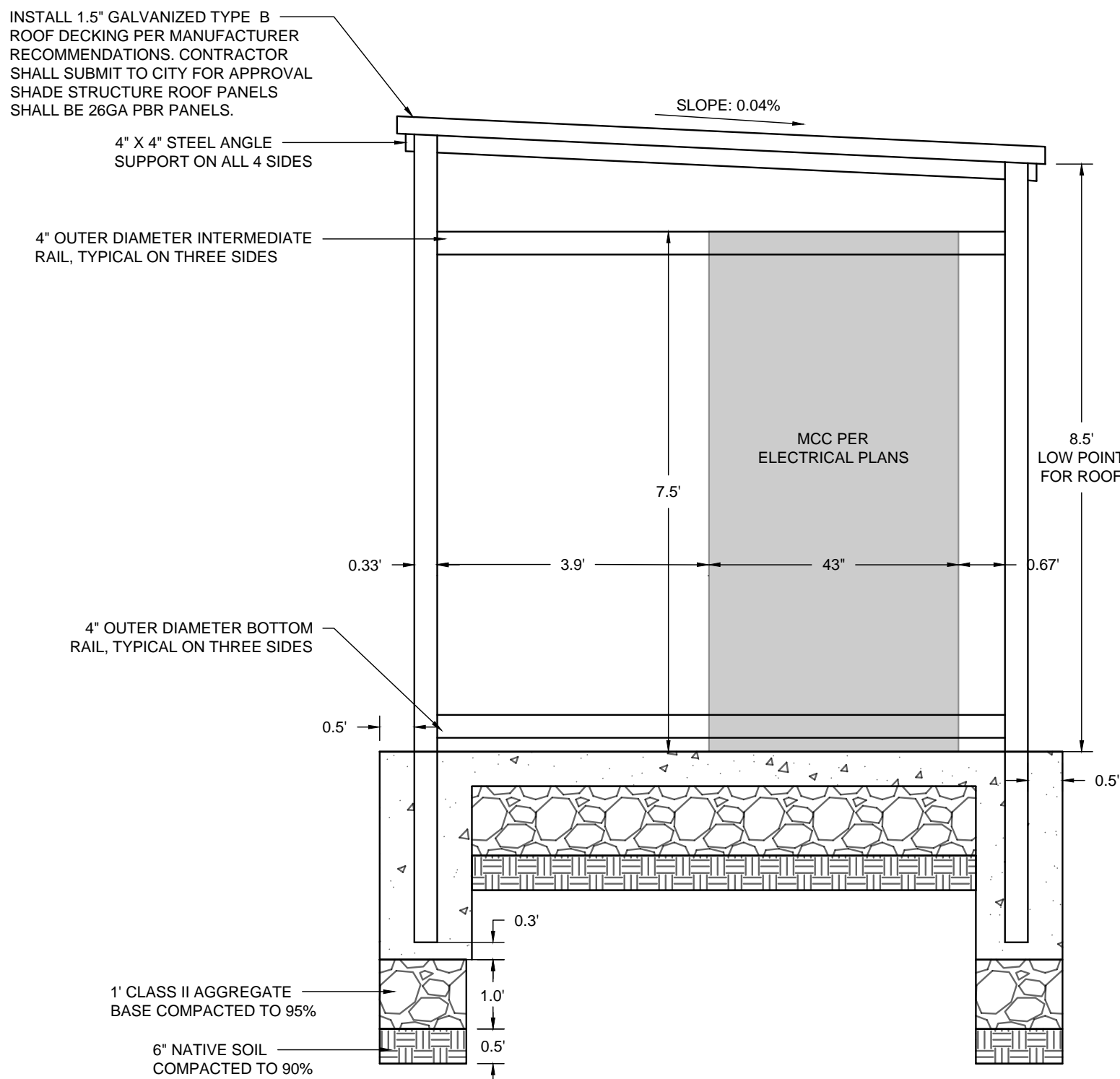

DETAIL 8 - MCC (ELEVATION VIEW)
SCALE: N.T.S.

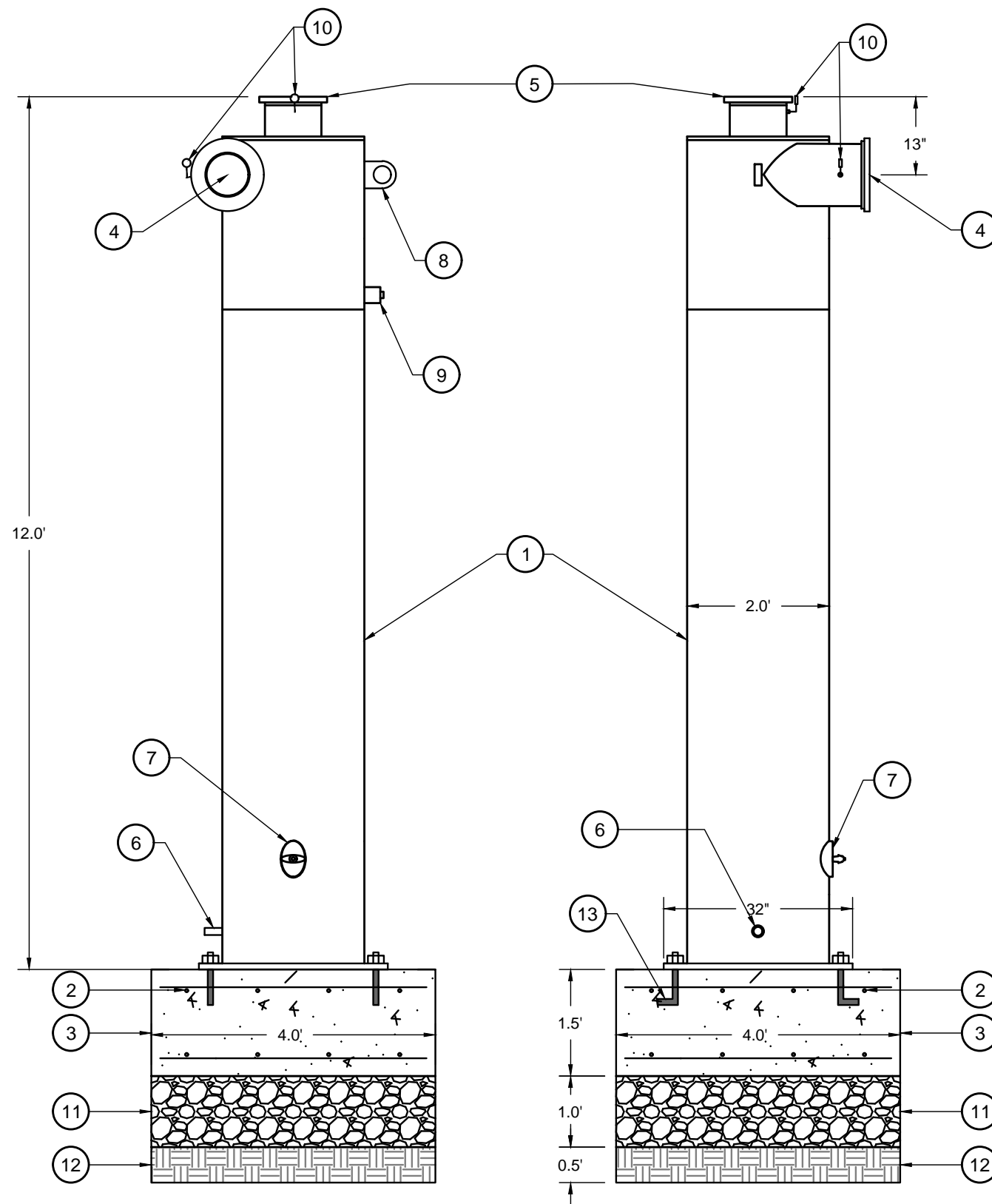

DETAIL 9 - SAND SEPARATOR
SCALE: N.T.S.

- KEYNOTE LEGEND:**
- 1 INSTALL LAKOS PWC SAND SEPARATOR MODEL PWC-1080-V (OR APPROVED EQUAL) PER MANUFACTURER RECOMMENDATIONS
 - 2 INSTALL #4 REBAR 12" ON CENTER EACH WAY (TYP.)
 - 3 CONSTRUCT SAND SEPARATOR FOOTING. DESIGN SHOWN IS FOR MINIMUM FOOTING REQUIREMENTS. CONTRACTOR SHALL OBTAIN STAMPED AND SIGNED FOOTING DESIGN FROM SAND SEPARATOR MANUFACTURER.
 - 4 SAND SEPARATOR INLET
 - 5 SAND SEPARATOR OUTLET
 - 6 SOLIDS PURGE
 - 7 HAND-HOLE INSPECTION PORT
 - 8 LIFTING RINGS
 - 9 1" NPT FEMALE INSPECTION/DRAIN PLUG
 - 10 PRESSURE GAUGE
 - 11 INSTALL 12" CLASS II AGGREGATE BASE AT 95% RELATIVE COMPACTION
 - 12 6" NATIVE SOIL COMPACTED TO 90% RELATIVE COMPACTION
 - 13 ANCHORS PER MANUFACTURER'S RECOMMENDATIONS

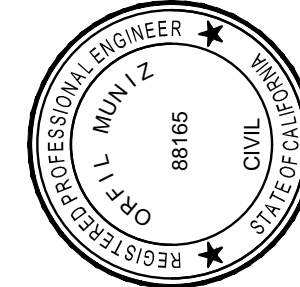

ENGINEERING PLANS FOR:
WATER WELL 5F IMPROVEMENTS

SHEET TITLE:
CONSTRUCTION DETAILS

REVISIONS
DETAIL REVISIONS

NO. **1**

AS SHOWN
JOB NO: 221_051
QA/QC: JA
FILE: 221_051_CONSTRUCTION
DETAILS_ADD01.DWG
DATE: 3/23/2023

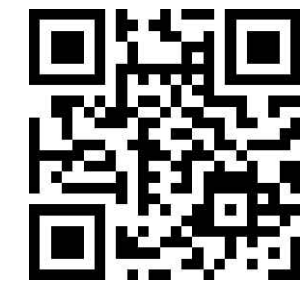

SHEET NO.

6

OF 7

Anthony J. Prieto
State Contractor's
Lic. 425883
Cell (559) 269-9166

Anthony J. Prieto Water Well Drilling, Inc.

891 So. Golden State Blvd. Selma, California 93662

(559) 896-4879

Fax (559) 896-5668

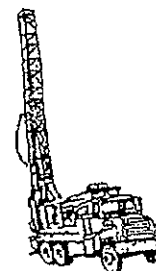

Attention: Ralph Boyajian

Fax Number 233-7821

From: Pamela

Re: 8B Well Log for Corcoran

Date: 3-24-14

Pages with cover sheet: 5

Comments: _____

*The free Adobe Reader may be used to view and complete this form. However, software must be purchased to complete, save, and reuse a saved form.

File Original with DWR

Well Completion Report

State of California

Refer to Instruction Pamphlet
No. xxxxxxxx

Page 1 of 4

Owner's Well Number 44

Date Work Began 05/20/2013

Date Work Ended 5/25/2013

Local Permit Agency Kings County

Permit Number Permit Date

DWR Use Only - Do Not Fill In

State Well Number/Site Number

Latitude Longitude

APN/IRS/Other

Geologic Log		
Orientation		Specify
<input checked="" type="radio"/> Vertical	<input type="radio"/> Horizontal	
Drilling Method Reverse Rotary		Drilling Fluid
Depth from Surface	Description	
Feet to Feet	Describe material, grain size, color, etc.	
0	Heavy Top Soil	
30	Sand	
36	Clay	
41	Sand	
47	Clay	
58	Sand	
64	Clay	
78	Sand	
82	Brown Clay	
92	Sand	
101	Clay	
108	Sand	
128	Clay	
131	Sand	
134	Grey Clay	
141	Sand	
155	Brown Clay	
160	Sandy Clay	
166	Brown Clay	
182	Sand	
188	Brown Clay	
193	Sand	
198	Brown Clay	
267	Sand	
222	Brown Clay	
230	Sand	
247	Brown Clay	
251	Sand	
262	Grey Clay	
265	Sand & Clay	
Total Depth of Boring 945 Feet		
Total Depth of Completed Well 920 Feet		

Well Owner

Name City of Corcoran Well B

Mailing Address

City Corcoran State CA Zip 93212

Well Location

Address 100' S/Nevada Ave. - 1/4 mile E/5th Ave.

City Corcoran County Kings

Latitude Longitude

Datum Dec. Lat. Dec. Long.

APN Book Page Parcel

Township Range Section

Location Sketch

(Sketch must be drawn by hand after form is printed.)

North

West East

South

Illustrate or describe distance of well from roads, buildings, fences, rivers, etc. and attach a map. Use additional paper if necessary. Please be accurate and complete.

Activity

☒ New Well

☐ Modification/Repair

☐ Deepen

☐ Other

☐ Destroy

Describe procedures and materials under "GEOLOGIC LOG"

Planned Uses

☒ Water Supply

☐ Domestic ☐ Public

☐ Irrigation ☐ Industrial

☐ Cathodic Protection

☐ Dewatering

☐ Heat Exchange

☐ Injection

☐ Monitoring

☐ Remediation

☐ Sparging

☐ Test Well

☐ Vapor Extraction

☐ Other

Water Level and Yield of Completed Well

Depth to first water 249 (Feet below surface)

Depth to Static Water Level 240 (Feet) Date Measured 06/17/2013

Estimated Yield * 1,400 (GPM) Test Type Pump

Test Length 24.0 (Hours) Total Drawdown 120 (Feet)

*May not be representative of a well's long term yield.

Casings								Annular Material			
Depth from Surface	Borehole Diameter	Type	Material	Wall Thickness	Outside Diameter	Screen Type	Slot Size	Depth from Surface	Fill	Description	
Feet to Feet	(Inches)			(Inches)	(Inches)		If Any (Inches)	Feet to Feet			
0	920	28"						0	50	Cement	32" Conductor
0	370		Blank	Steel	5/16"	16"		0	920		6 x 20 Silica
370	470		Perf.	Steel	5/16"	16"	Full Flo				
470	530		Blank	Steel	5/16"	16"					
530	900		Perf.	Steel	5/16"	16"	Full Flo				
900	920		Blank	Steel	5/16"	16"					

*** Note Attachments**

☐ Geologic Log

☐ Well Construction Diagram

☐ Geophysical Log(s)

☐ Soil/Water Chemical Analyses

☐ Other

Attach additional information, if it exists

Certification Statement

I, the undersigned, certify that this report is complete and accurate to the best of my knowledge and belief.

Name Anthony J. Prieto Water Well Drilling, Inc.

Person, Firm or Corporation

891 So. Golden State Blvd. Selma City CA 93662

Signed [Signature] 06/25/2013 C-57 425883

C-57 Licensed Water Well Contractor Date Signed C-57 License Number

* 356-370 Compression Joint

Refer to Instruction Pamphlet
No. xxxxxxxx

DWR Use Only – Do Not Fill In

State Well Number/Site Number

Latitude N Longitude W

APN/TRS/Other

Permit Number _____ Permit Date _____

Permit Number _____			Geologic Log		Date _____	
Orientation		<input type="radio"/> Vertical	<input type="radio"/> Horizontal	<input type="radio"/> Angle	Specify _____	
Drilling Method _____			Drilling Fluid _____			
Depth from Surface			Description			
Feet	to	Feet	Describe material, grain size, color, etc			
	270		Clay			
	276		Sand			
	281		Blue Clay			
	288		Sand			
	310		Blue Clay			
	312		Sand			
	332		Blue Clay			
	335		Sand			
	344		Blue Clay			
	377		Sand			
	388		Blue Clay			
	418		Sand			
	427		Blue Clay			
	431		Sand			
	437		Blue Clay			
	447		Sand			
	450		Blue Clay			
	453		Sand			
	456		Blue Clay			
	477		Joint Blue Clay			
	481		Blue Clay			
	537		Sand			
	540		Clay			
	547		Joint Clay			
	550		Sand			
	554		Blue Clay			
	560		Sand			
	562		Blue Clay			
	580		Sand			
	582		Blue Clay			
Total Depth of Boring _____			Feet			
Total Depth of Completed Well _____			Feet			

Well Owner

Name City of Corcoran

Mailing Address _____

City _____ State _____ Zip _____

Well Location

Address _____

City _____ County _____

Latitude _____ Deg. Min. Sec. N Longitude _____ Deg. Min. Sec. W

Datum _____ Dec. Lat. _____ Dec. Long. _____

APN Book _____ Page _____ Parcel _____

Township _____ Range _____ Section _____

Location Sketch (Sketch must be drawn by hand after form is printed.)		Activity
<div style="text-align: center; margin-bottom: 10px;">North</div> <div style="display: flex; justify-content: space-between; align-items: center; padding: 0 10px;"> West <div style="flex-grow: 1; border: 1px solid black; margin: 0 10px;"></div> East </div> <div style="text-align: center; margin-top: 10px;">South</div>		<input type="radio"/> New Well <input type="radio"/> Modification/Repair <input type="radio"/> Deepen <input type="radio"/> Other _____ <input type="radio"/> Destroy Describe procedures and materials under "GEOLOGIC LOG"
		Planned Uses <input type="radio"/> Water Supply <input type="checkbox"/> Domestic <input type="checkbox"/> Public <input type="checkbox"/> Irrigation <input type="checkbox"/> Industrial <input type="radio"/> Cathodic Protection <input type="radio"/> Dewatering <input type="radio"/> Heat Exchange <input type="radio"/> Injection <input type="radio"/> Monitoring <input type="radio"/> Remediation <input type="radio"/> Sparging <input type="radio"/> Test Well <input type="radio"/> Vapor Extraction <input type="radio"/> Other _____

Illustrate or describe distance of well from roads, buildings, fences, rivers, etc. and attach a map. Use additional paper if necessary.

Water Level and Yield of Completed Well

Depth to first water _____ (Feet below surface)

Depth to Static _____

Water Level _____ (Feet) Date Measured _____

Estimated Yield * _____ (GPM) Test Type _____

Test Length _____ (Hours) Total Drawdown _____ (Feet)

*May not be representative of a well's long term yield.

[illegible]

Attachments

☐ Geologic Log

☐ Well Construction Diagram

☐ Geophysical Log(s)

☐ Soil/Water Chemical Analyses

☐ Other _____

attach additional information if exists.

Certification Statement			
I, the undersigned, certify that this report is complete and accurate to the best of my knowledge and belief			
Name _____	Person, Firm or Corporation _____	City _____	State _____ Zip _____
Signed _____	Address _____	City _____	State _____ Zip _____
C-57 Licensed Water Well Contractor _____		Date Signed _____	C-57 License Number _____

*The free Adobe Reader may be used to view and complete this form. However, software must be purchased to complete, save, and reuse a saved form.

File Original with DWR

State of California
Well Completion Report

Refer to Instruction Pamphlet
No. xxxxxxxx

DWR Use Only – Do Not Fill In

State Well Number / Site Number

Latitude N Longitude W

APN/RS/Other

Page _____ of _____

Owner's Well Number _____

Date Work Began _____ Date Work Ended _____

Local Permit Agency _____

Permit Number _____ Permit Date _____

Permit Number _____		Geologic Log		Orientation <input type="radio"/> Vertical <input type="radio"/> Horizontal <input type="radio"/> Angle Specify _____		Drilling Method _____ Drilling Fluid _____	
Depth from Surface Feet to Feet			Description Describe material grain size, color, etc.				
	583		Sand				
	588		Blue Clay				
	597		Sand				
	607		Clay				
	613		Sand				
	617		Clay				
	620		Sand				
	627		Clay				
	636		Sand				
	640		Clay				
	657		Sand				
	663		Clay				
	668		Coarse Sand				
	674		Blue Clay				
	681		Sand				
	688		Blue Clay				
	691		Sand				
	695		Blue Clay				
	697		Sandstone				
	700		Blue Clay				
	717		Sand				
	722		Blue Clay				
	728		Sandy Clay				
	736		Blue Clay				
	738		Sand				
	744		Blue Clay				
	746		Sand				
	748		Blue Clay				
	758		Sand				
	763		Blue Clay				
Total Depth of Boring _____			Feet				
Total Depth of Completed Well _____			Feet				

Well Owner

Name _____

Mailing Address _____

City _____ State _____ Zip _____

Well Location

Address _____

City _____ County _____

Latitude _____ Deg. _____ Min. _____ Sec. _____ N Longitude _____ Deg. _____ Min. _____ Sec. _____ y/y

Datum _____ Dec. Lat. _____ Dec. Long. _____

APN Book _____ Page _____ Parcel _____

Township _____ Range _____ Section _____

Location Sketch		Activity	
(Sketch must be drawn by hand after form is printed.)		<input type="radio"/> New Well <input type="radio"/> Modification/Repair <input type="radio"/> Deepen <input type="radio"/> Other _____ <input type="radio"/> Destroy Describe procedures and materials under "GEOLOGIC LOG"	
North		Planned Uses	
West		<input type="radio"/> Water Supply <input type="checkbox"/> Domestic <input type="checkbox"/> Public <input type="checkbox"/> Irrigation <input type="checkbox"/> Industrial <input type="radio"/> Cathodic Protection <input type="radio"/> Dewatering <input type="radio"/> Heat Exchange <input type="radio"/> Injection <input type="radio"/> Monitoring <input type="radio"/> Remediation <input type="radio"/> Sparging <input type="radio"/> Test Well <input type="radio"/> Vapor Extraction <input type="radio"/> Other _____	
East	South	Illustrate or describe distance of well from roads, buildings, fences, rivers, etc. and attach a map. Use additional paper if necessary. Give the acreage and contents.	

Water Level and Yield of Completed Well

Depth to first water _____ (Feet below surface)

Depth to Static _____

Water Level _____ (Feet) Date Measured _____

Estimated Yield * _____ (GPM) Test Type _____

Test Length _____ (Hours) Total Drawdown _____ (Feet)

*May not be representative of a well's long term yield.

[illegible]

Attachments	Certification Statement
<input type="checkbox"/> Geologic Log <input type="checkbox"/> Well Construction Diagram <input type="checkbox"/> Geophysical Log(s) <input type="checkbox"/> Soil/Water Chemical Analyses <input type="checkbox"/> Other _____ <small>Municipal and/or Interstate U.L. exists</small>	<p>I, the undersigned, certify that this report is complete and accurate to the best of my knowledge and belief</p> <p>Name _____ Person, Firm or Corporation _____ CA _____ State _____ Zip _____</p> <p>Signed <u><i>[Signature]</i></u> Address _____ City _____ Date Signed _____ C-57 License Number _____</p> <p style="text-align: center;"><small>C-57 Licensed Water Well Contractor</small></p>

DWR Use Only - Do Not Fill In									
State Well Number/Site Number									
Latitude					Longitude				
APN/TRS/Other									

Permit Number _____ Permit Date _____

IF ADDITIONAL SPACE IS NEEDED, USE NEXT CONSECUTIVELY NUMBERED FORM

City of Corcoran

County of Kings

State of California

WELLS 8B AND 9B
DRILLING, DEVELOPMENT, AND SITE IMPROVEMENTS

SHEET INDEX

COVER SHEET	1
WELL 8B SITE PLAN	2
WELL 9B SITE PLAN	3
WELL 8B AND 9B ELEVATION	4
WELL 8B AND 9B ELECTRICAL SCHEDULES	5

GENERAL NOTES

- ALL IMPROVEMENTS SHALL BE PER CITY OF CORCORAN AND KINGS COUNTY STANDARDS
- CONTRACTOR SHALL NOTIFY THE ENGINEER OF ANY AND ALL CONFLICTS BETWEEN CONTRACT DRAWINGS AND THE ACTUAL SITE CONDITIONS PRIOR TO COMMENCING ANY WORK IN QUESTION
- CONTRACTOR SHALL PROVIDE PEDESTRIAN, VEHICLE, WORKER AND TREE PROTECTION AS NECESSARY FOR THE FULL DURATION OF THE PROJECT
- CONTRACTOR SHALL SUBMIT TRAFFIC CONTROL PLANS FOR APPROVAL BY THE CITY AND SHALL INSTALL APPROVED TRAFFIC CONTROL SIGNS PRIOR TO COMMENCEMENT OF ANY WORK, IN CONFORMANCE WITH CALTRANS "MANUAL OF TRAFFIC CONTROL"
- CONTRACTOR SHALL MAINTAIN DUST CONTROL ABOUT THE SITE OF WORK AS SPECIFIED BY "CALTRANS STANDARD SPECIFICATIONS"
- CONTRACTOR SHALL BE LICENSED AS CLASS "A" GENERAL ENGINEERING CONTRACTOR (OR A COMBINATION OF SPECIALTY LICENSES THAT WOULD INCLUDE ALL ITEMS OF WORK) IN ACCORDANCE WITH THE PROVISIONS OF CHAPTER 9, DIVISION 3 OF THE BUSINESS AND PROFESSIONS CODE
- CONTRACTOR SHALL PERFORM ALL WORK NECESSARY TO COMPLETE THE CONTRACT IN A SATISFACTORY MANNER, PROVIDING ALL MATERIALS, LABOR, EQUIPMENT AND INCIDENTALS NECESSARY TO COMPLETE THE WORK UNLESS SPECIFIED OTHERWISE
- CONTRACTOR SHALL NOTIFY THE APPROPRIATE AGENCY AT LEAST 8 DAYS PRIOR TO COMMENCING WORK SO THAT SAID AGENCY MAY PRESERVE MONUMENTS AND BENCH MARKS, WHICH MAY NOT BE DISTURBED WITHOUT AGENCY CONSENT. THE CONTRACTOR SHALL BE RESPONSIBLE FOR REPLACING DESTROYED BENCHMARKS
- CONTRACTOR SHALL INDEMNIFY, DEFEND AND HOLD HARMLESS THE CITY, ITS ENGINEER AND CONSULTANTS, THEIR OFFICERS, EMPLOYEES AND AGENTS, FROM ANY AND ALL LIABILITY CLAIMS, LOSSES OR DAMAGES ARISING OR ALLEGED FROM THE PERFORMANCE OF THE WORK DESCRIBED ON THESE PLANS, NOT INCLUDING NEGLIGENCE ON THE PART OF THE CITY.
- CONTRACTOR SHALL EXPOSE ALL EXISTING PIPELINES OR OTHER UNDERGROUND OBSTRUCTIONS TO VERIFY THAT THERE ARE NO GRADE CONFLICTS PRIOR TO LAYING ANY GRAVITY PIPELINES UPSTREAM OF SAID PIPELINES OR OBSTRUCTIONS
- LOCATION AND RELOCATION OF UTILITY POLES SHALL BE THE RESPONSIBILITY OF THE UTILITY COMPANY.
- THE LOCATION OF EXISTING UNDERGROUND UTILITIES AS SHOWN ON THESE PLANS ARE BASED ON THE BEST INFORMATION AVAILABLE, HOWEVER, THE CITY OF CORCORAN AND THE ENGINEER ASSUME NO RESPONSIBILITY FOR THE ACCURACY OF THE INFORMATION SHOWN, OR FOR THE INADVERTENT OMISSION OF ANY SUCH INFORMATION. THE CONTRACTOR SHALL COOPERATE WITH ALL UTILITY COMPANIES AND OTHER CONTRACTORS WORKING WITHIN THE LIMITS OF THIS PROJECT.
- THE CONTRACTOR SHALL INSTALL AND MAINTAIN STORM DRAIN BMP'S IN CONFORMANCE WITH THE STORM WATER POLLUTION PREVENTION PLAN (SWPPP) PREPARED FOR THE PROJECT AND COMPLY FULLY WITH THE NOTICE OF INTENT AND THE STATE'S STORM WATER GENERAL CONSTRUCTION PERMIT

BENCH MARK

09. RAILROAD SPIKE IN NORTH FACE OF POWER POLE, 4th POWER POLE WEST OF 4 1/2 AVENUE, SOUTH SIDE OF ORANGE AVENUE
ELEVATION=204.41

APPROVED BY:

STEVEN T. KROEGER, PUBLIC WORKS DIRECTOR 4/4/12 DATE
CHARLES D. SANFORD, P.E., CITY ENGINEER 4/4/12 DATE
MATTHEW J. WILLBANKS, P.E., PROJECT ENGINEER 4.4.12 DATE
QUAD KNOPF INC.

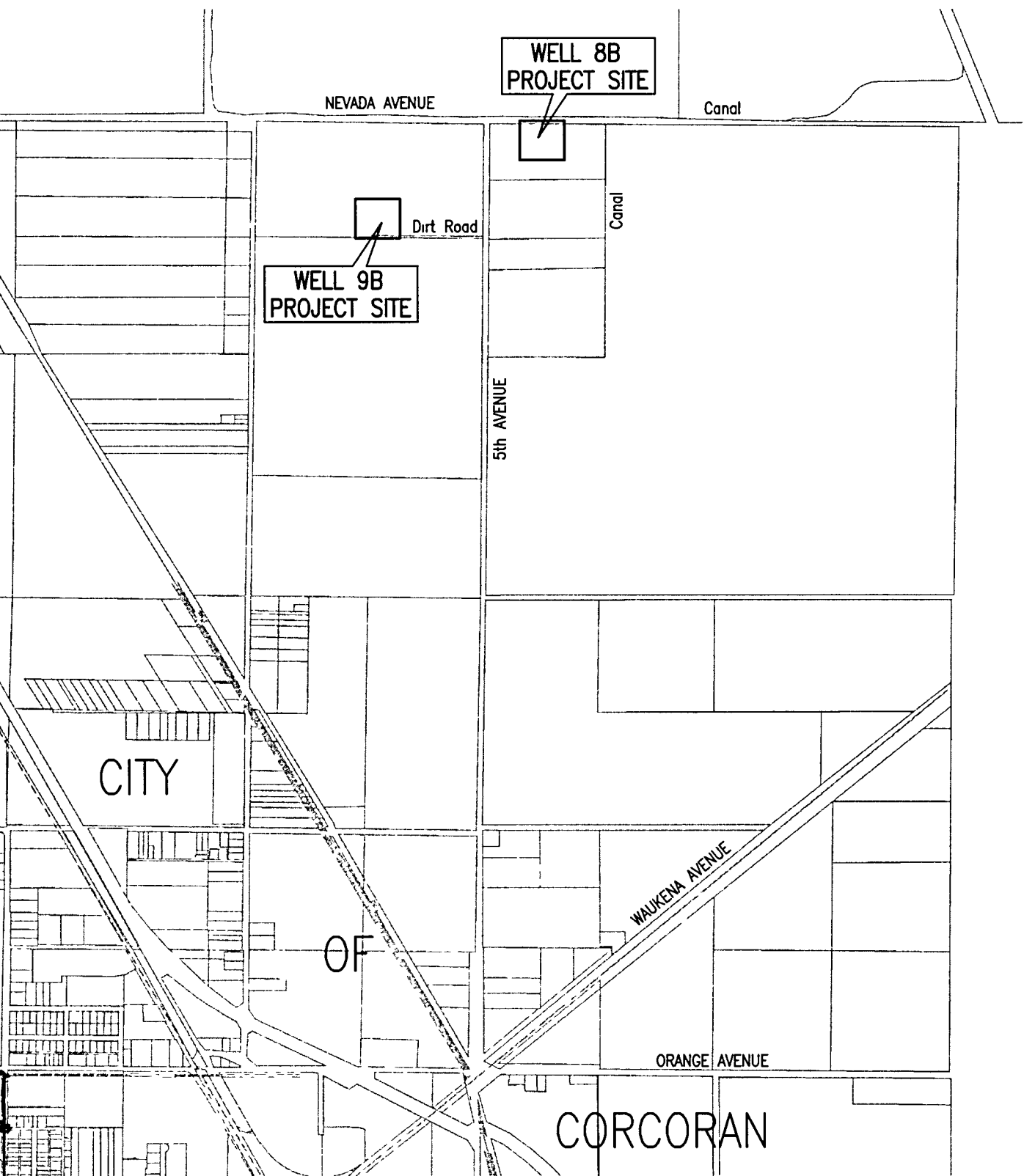
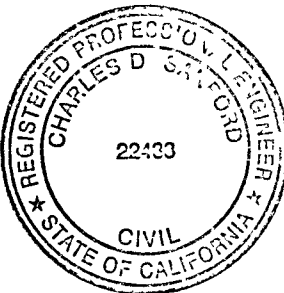

VICINITY MAP
Not to Scale

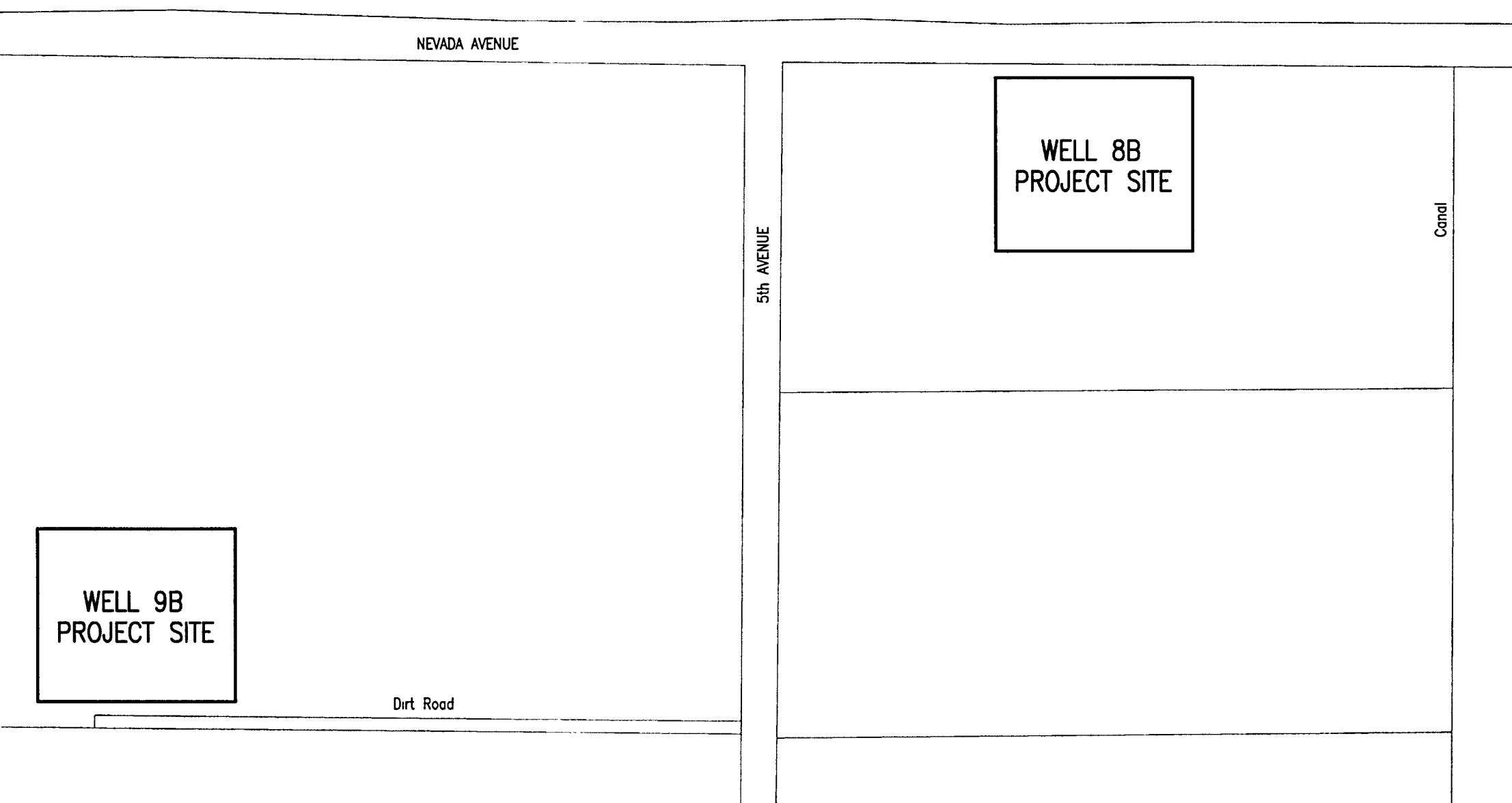

PROJECT AREA
Not to Scale

REVISIONS	DATE	BY	DESCRIPTION

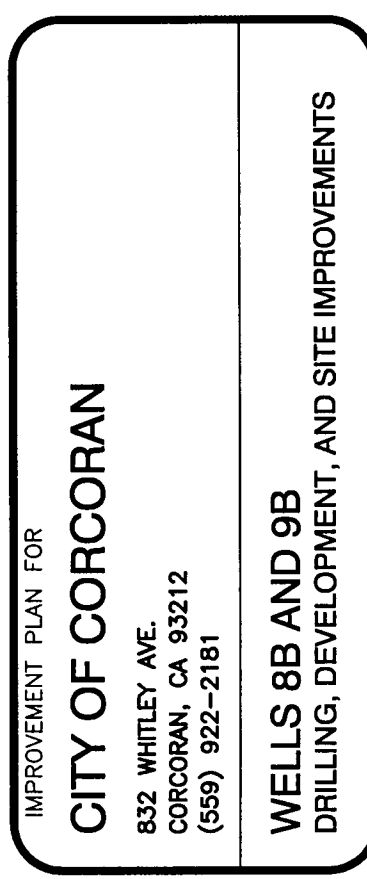
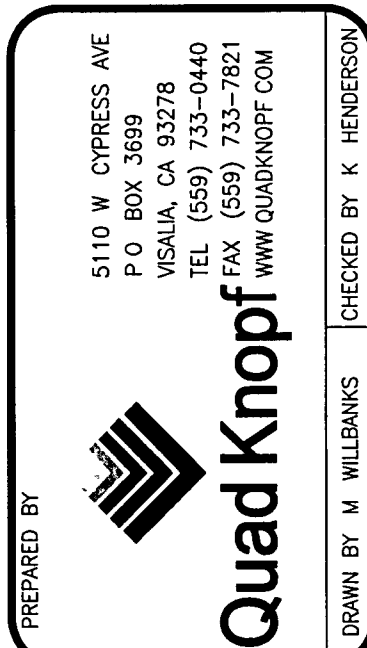
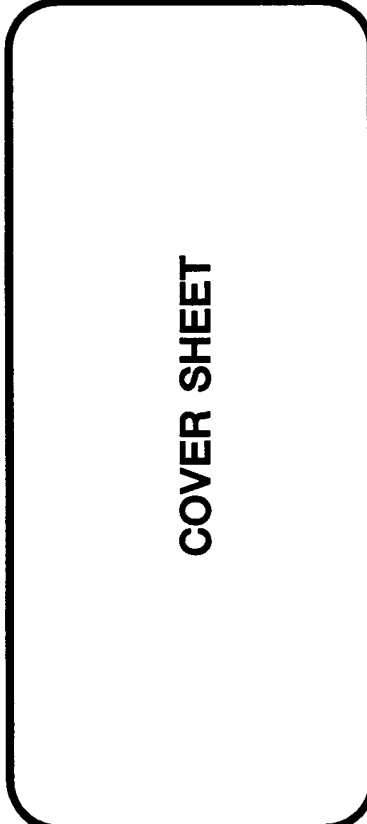
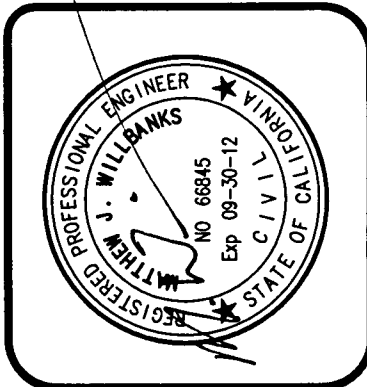
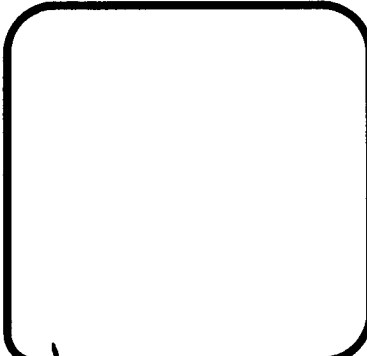

PLOT DATE	4/4/2012
JOB NO	C120046
FILE NAME	
SCALE	
SHEET NO	1

BEFORE EXCAVATING
CALL • USA
1-800-227-2800

STA 10+00.00 NEVADA AVE =
STA 115+39.30 5th AVE

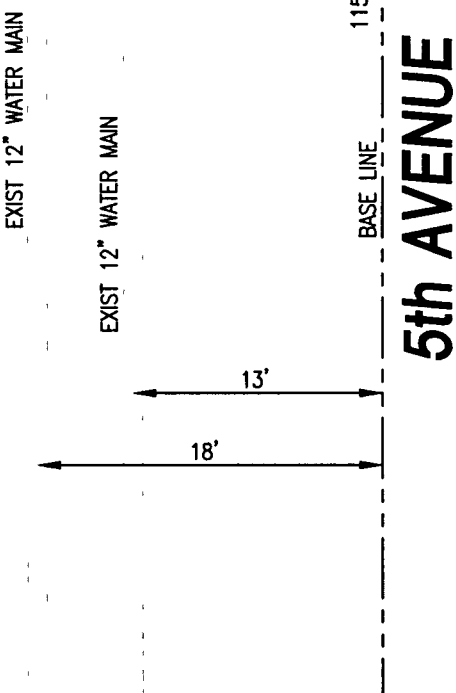

NEVADA AVENUE

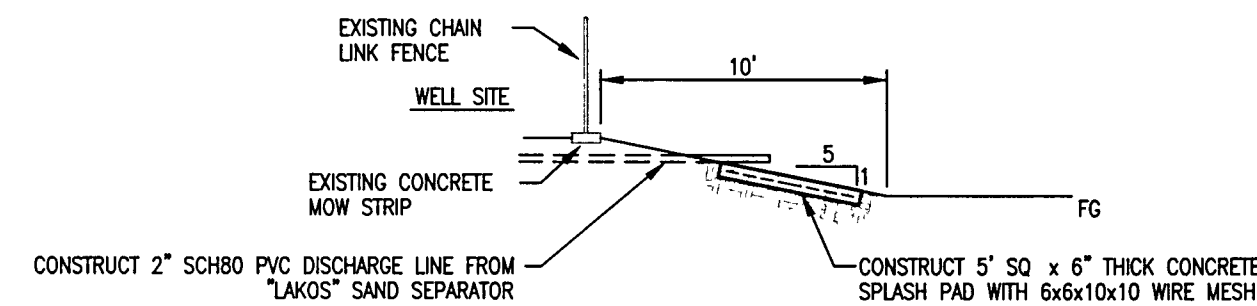
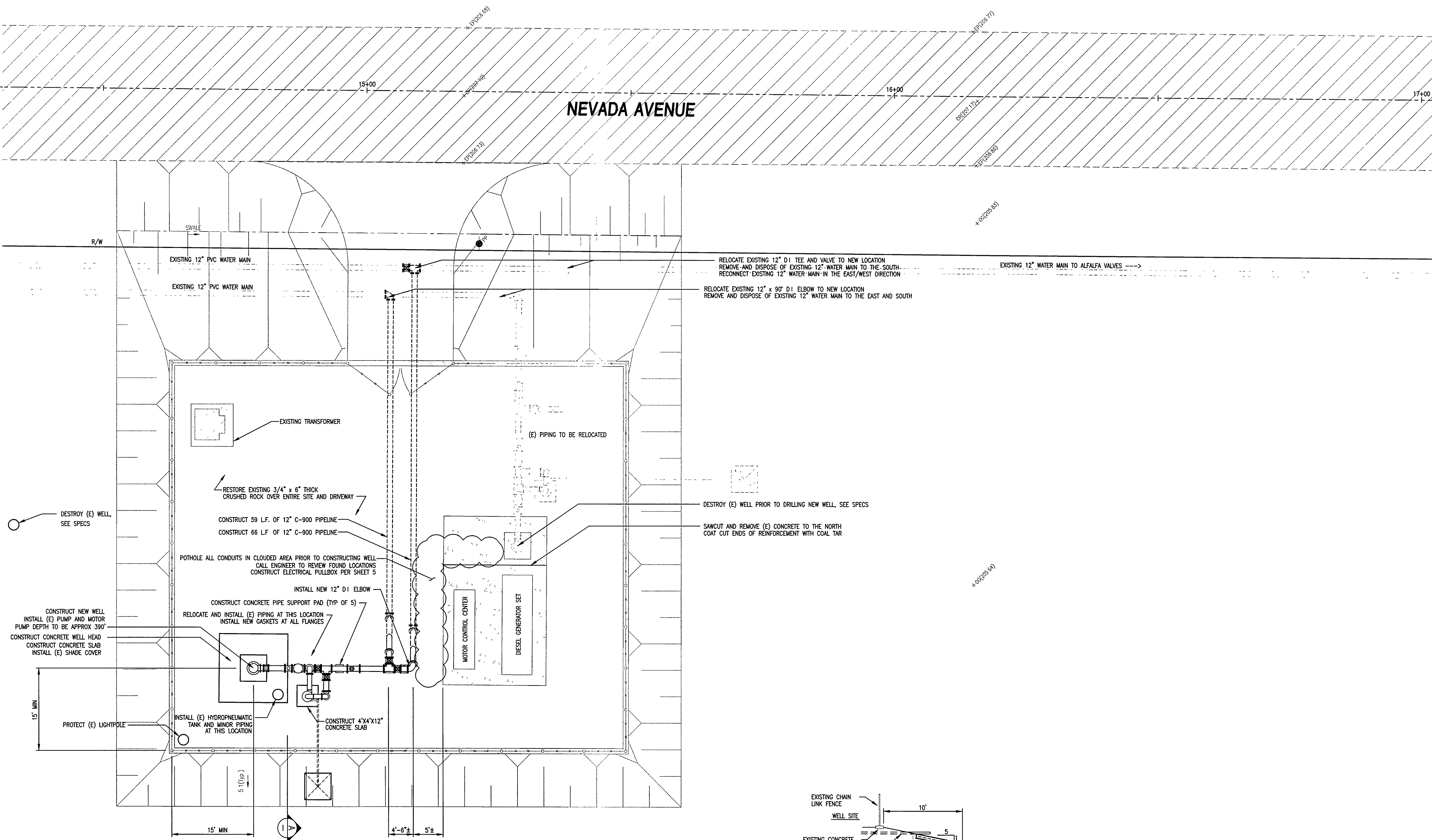

DETAIL A
2" Discharge Line and Concrete Splash Pad

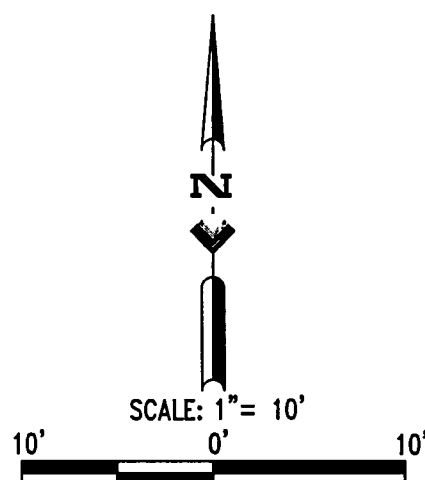

BENCH MARK

QUAD KNOFF BENCH MARK NO. 09 - RAILROAD SPIKE IN
FACE OF POWER POLE, 4TH POWER POLE WEST OF 4 1/2
AVENUE, SOUTH SIDE ORANGE AVENUE
ELEV=204.41

WATER WELL 8B
Site Plan

REVISIONS		DATE	BY	DESCRIPTION

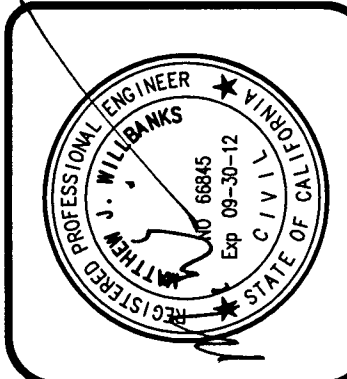
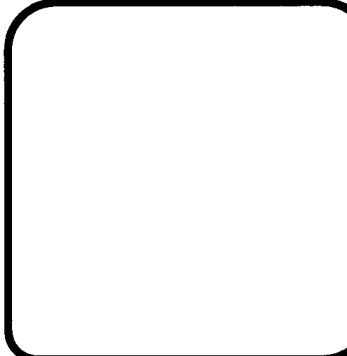

WELL 8B
SITE PLAN

5110 W. CYRESS AVE
P.O. BOX 3699
VISALIA, CA 93278
TEL (559) 733-0440
FAX (559) 733-7821
WWW.QUADKNOFF.COM

Quad Knopf

PREPARED BY: **Quad Knopf**
DRAWN BY: M. WILLIAMS
CHECKED BY: K. HENDERSON

IMPROVEMENT PLAN FOR
CITY OF CORCORAN
832 WHITLEY AVE.
CORCORAN, CA 93212
(559) 922-2181

WELLS 8B AND 9B
DRILLING, DEVELOPMENT, AND SITE IMPROVEMENTS

PLOT DATE	4/4/2012
JOB NO	C120046
FILE NAME	C120046-BB-S&D.dwg
SCALE	1" = 10'
SHEET NO	2

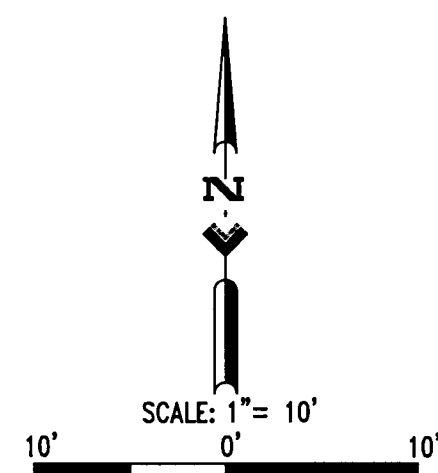

BENCH MARK
QUAD KNOFF BENCH MARK NO. Q9 - RAILROAD SPIKE IN
FACE OF POWER POLE, 4TH POWER POLE WEST OF 4 1/2
AVENUE, SOUTH SIDE ORANGE AVENUE
ELEV=204.41

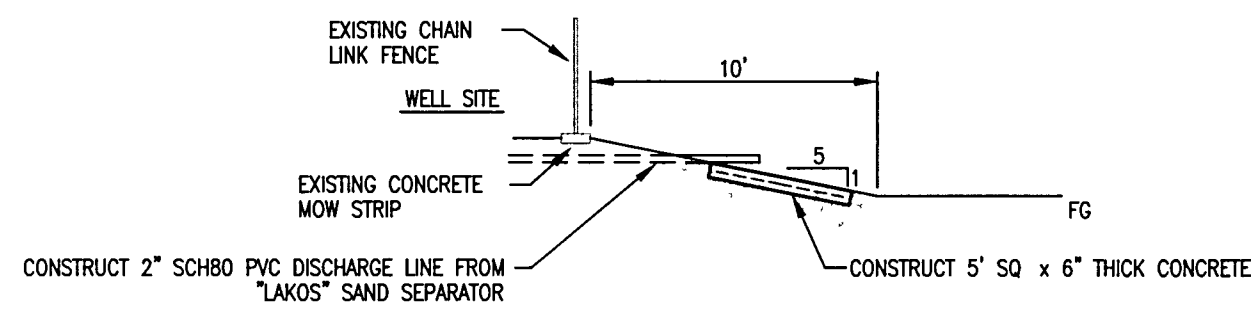

DETAIL A
2" Discharge Line and Concrete Spash Pad

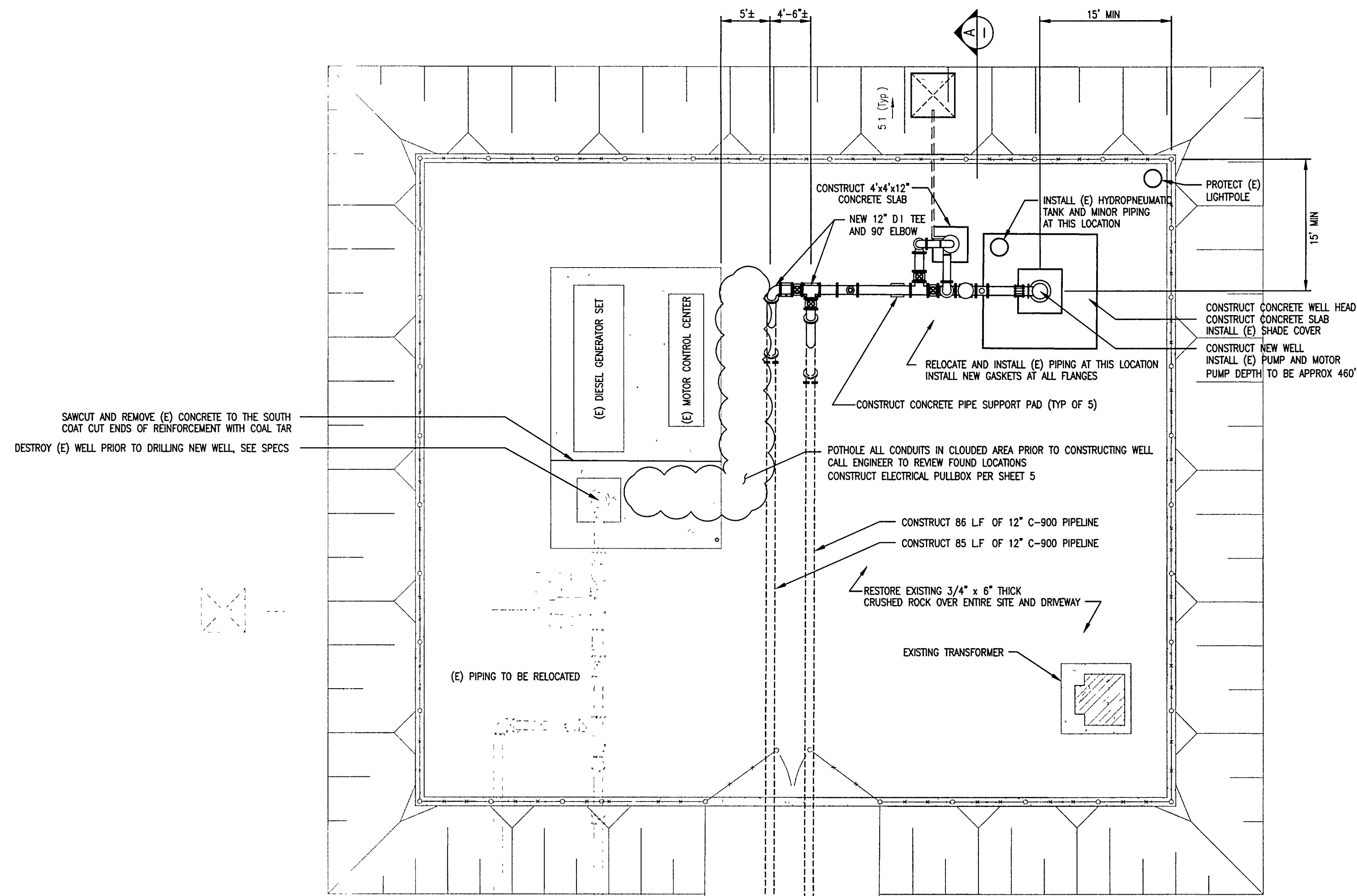

WATER WELL 9B
Site Plan

REVISIONS		DATE	BY	DESCRIPTION

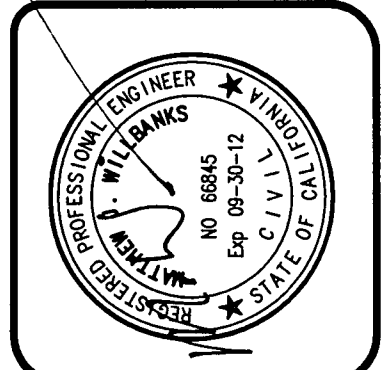

WELL 9B
SITE PLAN

PREPARED BY: **Quad Knopf**
5110 W. CYPRESS AVE
P.O. BOX 3699
VISALIA, CA 93278
TEL: (559) 733-0440
FAX: (559) 733-7821
WWW.QUADKNOPF.COM
DRAWN BY: M. WILKBANKS
CHECKED BY: K. HENDERSON

IMPROVEMENT PLAN FOR
CITY OF CORCORAN
832 WHITLEY AVE
CORCORAN, CA 93212
(559) 922-2181
WELLS 8B AND 9B
DRILLING, DEVELOPMENT, AND SITE IMPROVEMENTS

PLOT DATE	4/4/2012
JOB NO	C120046
FILE NAME	C120046-9B-S&D.dwg
SCALE	1" = 10'
SHEET NO	3

REQUIRED BEARING AREA – TOTAL SQUARE FEET						
TYPE OF FITTING	90° BEND	45° BEND	11 1/4° OR 22 1/2° BEND	TEE OR DEAD END	TEE WITH PLUG	CROSS WITH PLUG
TYPICAL INSTALLATION						
SIZE OF PIPE	4"	2 SF	1 SF	1 SF	2 SF	2 SF
	6"	4 SF	2 SF	1 SF	3 SF	4 SF
	8"	7 SF	4 SF	2 SF	5 SF	7 SF
	10"	12 SF	6 SF	3 SF	8 SF	12 SF
	12"	16 SF	10 SF	5 SF	12 SF	16 SF
	14"	22 SF	14 SF	7 SF	16 SF	22 SF
	16"	29 SF	18 SF	9 SF	22 SF	29 SF

THRUST BLOCK BEARING AREA REQUIREMENTS

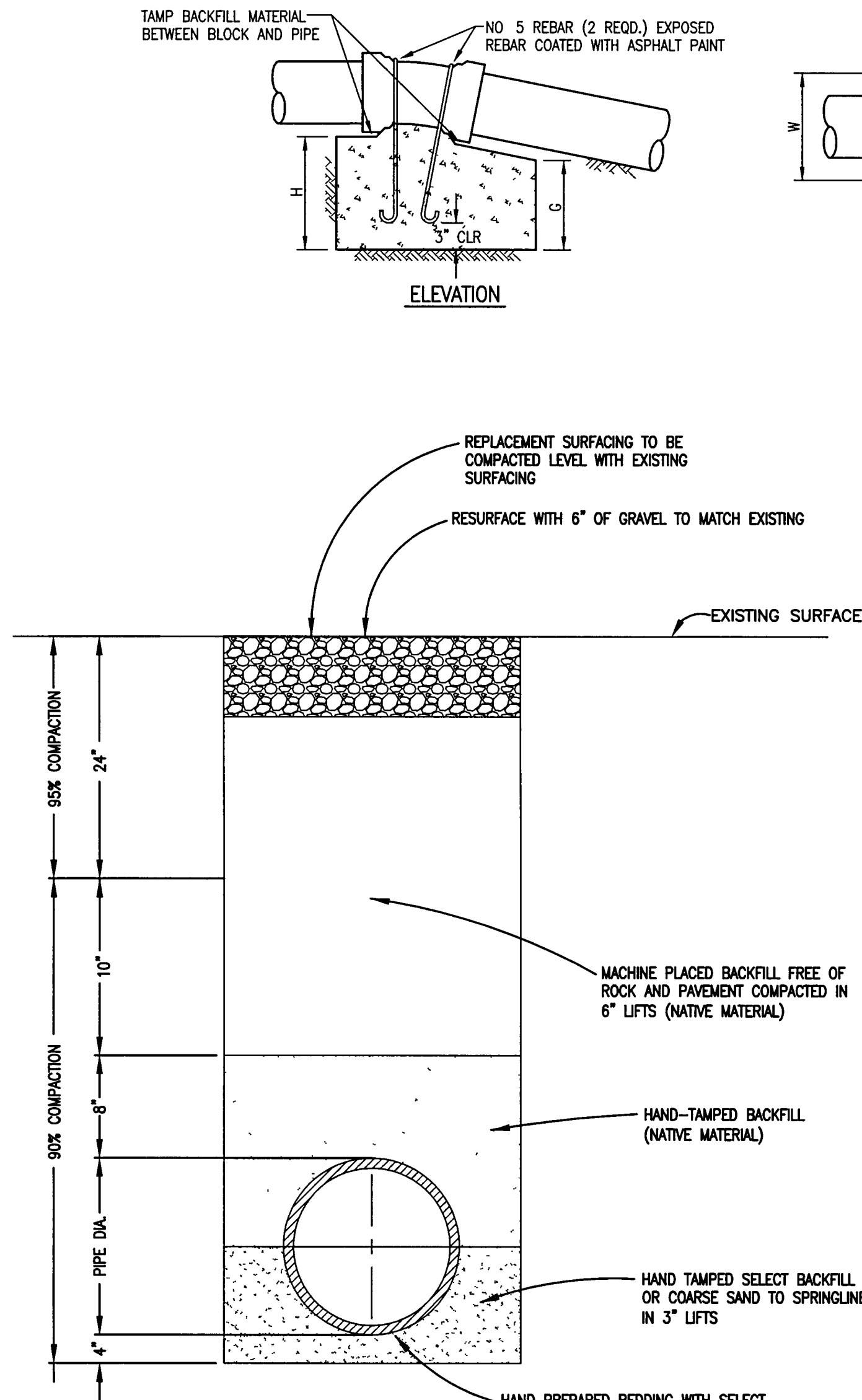

TYPICAL TRENCH SECTION

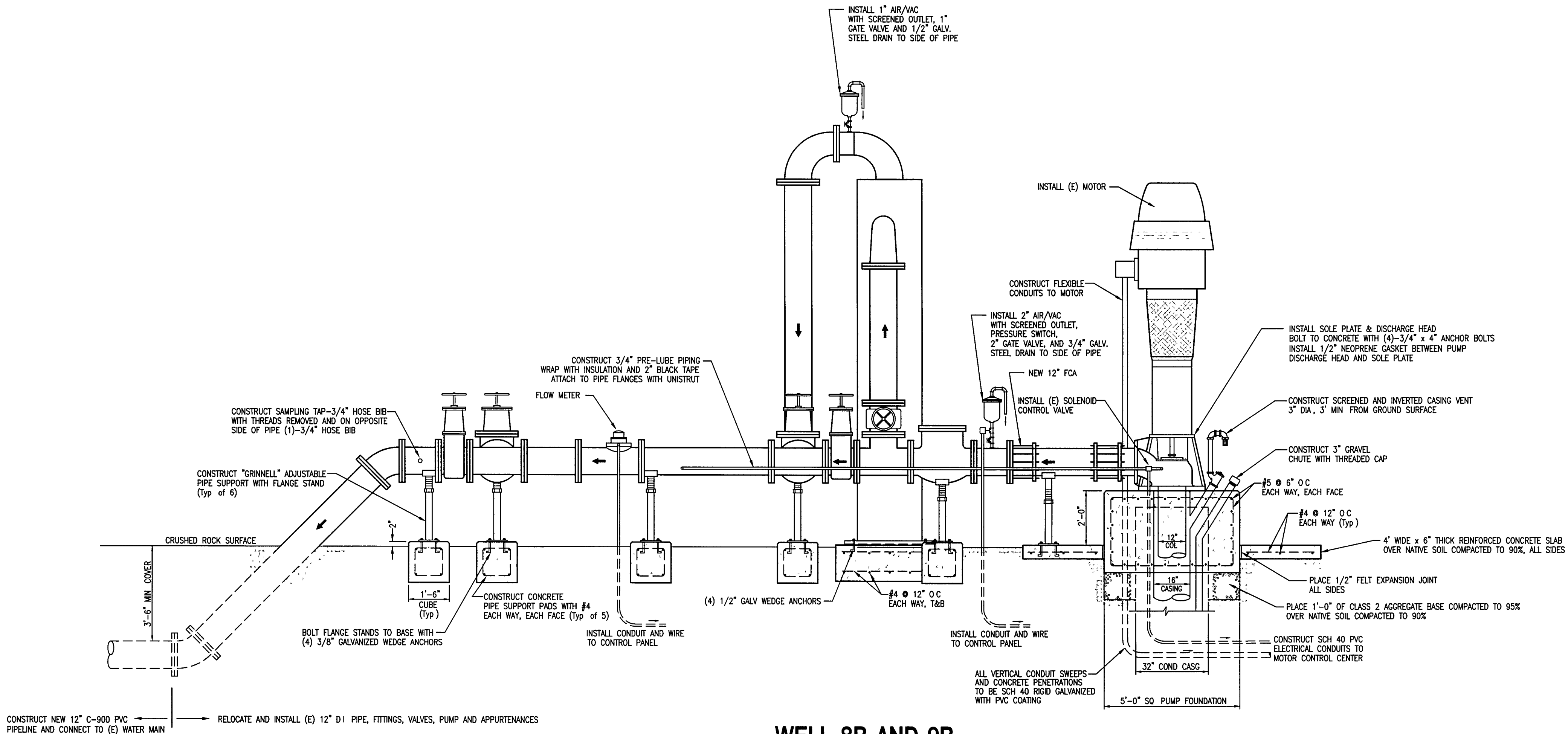
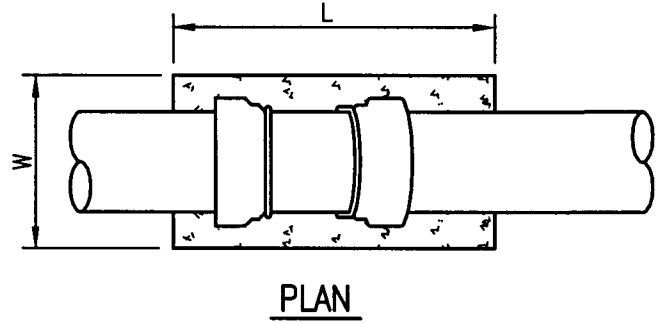

WELL 8B AND 9B
Well Head and Discharge Piping
Not to Scale

THRUST BLOCK DIMENSIONS – UPWARD THRUST												
PIPE SIZE	11 1/4° BEND				22 1/2° BEND				45° BEND			
	L	W	H	G	L	W	H	G	L	W	H	G
4" & 6"	2'-0"	2'-0"	1'-0"	9"	2'-0"	2'-0"	2'-0"	1'-0"	3'-0"	2'-0"	2'-0"	6"
8"	2'-0"	2'-0"	1'-0"	9"	3'-0"	2'-0"	2'-0"	1'-0"	4'-6"	2'-0"	3'-0"	6"
10"	3'-0"	2'-0"	2'-0"	1'-8"	4'-0"	2'-0"	2'-0"	1'-0"	6'-0"	2'-0"	3'-8"	8"
12"	3'-0"	2'-0"	2'-0"	1'-8"	6'-0"	2'-0"	2'-0"	1'-0"	7'-0"	2'-6"	4'-0"	6"
14"	4'-0"	2'-6"	2'-6"	1'-8"	7'-0"	2'-6"	2'-6"	1'-0"	9'-0"	3'-0"	4'-8"	8"
16"	4'-0"	2'-6"	3'-0"	1'-8"	7'-0"	2'-6"	3'-0"	1'-0"	9'-0"	3'-0"	4'-8"	8"

THRUST BLOCKING AT VERTICAL BENDS

- NOTES:
- ALL CONCRETE TO BE CALTRANS CLASS 2, WITH GRADE 60 REINFORCEMENT.
 - BLOCKS TO BE POURED AGAINST UNDISTURBED SOIL.
 - JOINTS AND FACE OF PLUG TO BE KEPT CLEAR OF CONCRETE.
 - MINIMUM THICKNESS OF THRUST BLOCKS TO BE 5 INCHES.
 - AREAS GIVEN ARE FOR CLASS 150 PIPE AT PRESSURE OF 150 P.S.I. IN SOIL WITH 2,000 P.S.F. BEARING CAPACITY. INSTALLATION USING DIFFERENT PIPE, TEST PRESSURES, AND/OR SOIL TYPES SHOULD ADJUST AREAS ACCORDINGLY, SUBJECT TO APPROVAL OF ENGINEER.
 - RESTRAINED FITTINGS MAY BE USED IN PLACE OF THRUST BLOCKS.
 - LIGHTLY SANDBLAST ABOVEGROUND PIPING AND EQUIPMENT TO REMOVE FLAKES AND DEBRIS. DO NOT BLAST TO BARE METAL. PRIME AND PAINT ABOVEGROUND PIPING AND EQUIPMENT WITH COMPATIBLE COATING SYSTEM. EXISTING COATING IS "DEVCO DEVTHANE 379", COLOR IS "DESERT SAND".

REVISIONS		DATE	BY	DESCRIPTION
NO.	DESCRIPTION			

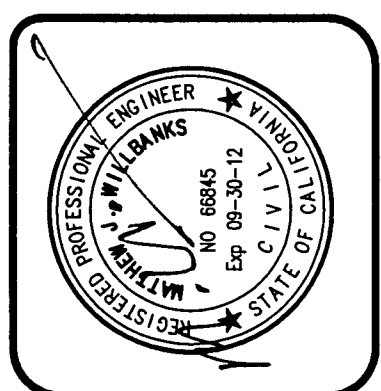
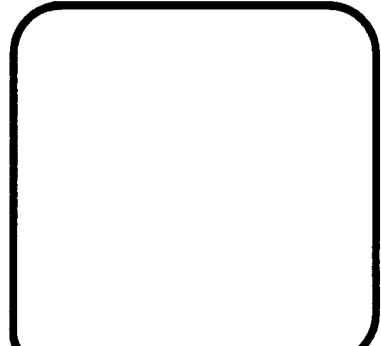

WELL 8B AND 9B
WELL HEAD ELEVATION

5110 W. CYPRESS AVE
P.O. BOX 3699
VISALIA, CA 93278
TEL: (559) 733-0440
FAX: (559) 733-7821
WWW.QUADKNOPF.COM

PREPARED BY: M. WILLBANKS
CHECKED BY: K. HENDERSON

QUADKNOPF

IMPROVEMENT PLAN FOR
CITY OF CORCORAN
832 WHITLEY AVE.
CORCORAN, CA 93212
(559) 922-2181

WELLS 8B AND 9B
DRILLING, DEVELOPMENT, AND SITE IMPROVEMENTS

PLOT DATE	4/4/2012
JOB NO	C120046
FILE NAME	C120046-9B-S&D.dwg
SCALE	NONE
SHEET NO	4

WELL 8B CONDUIT AND WIRE SCHEDULE

NO.	QTY	SIZE	NO. WIRES	WIRE SIZE	GND	FUNCTION	FROM	TO
1	2	3"	6-(2/phase)	500KCMIL	3/0	Pump Motor	MCC	Pump Motor
2	1	3/4"	2	#12	#12	Pump Winding heater	Panel LP	Pump Motor
3	1	3/4"	2	#12	#12	Pump Lube Solenoid	MCC	Pump Head
4	1	3/4"	3	#14	#14	Pump Pressure Switch Hi-Lo	PLC	Pressure Switch
5	1	3/4"	1	#18 TSP		Flow 4-20ma	PLC	Flow Transmitter
6	1	3/4"	2	#12	#12	Air Compressor	Panel LP	Hydropneumatic Tank
7								
8								
9								
10								

WELL 9B CONDUIT AND WIRE SCHEDULE

NO.	QTY	SIZE	NO. WIRES	WIRE SIZE	GND	FUNCTION	FROM	TO
1	2	3"	6-(2/phase)	500KCMIL	3/0	Pump Motor	MCC	Pump Motor
2	1	3/4"	2	#12	#12	Pump Winding heater	Panel LP	Pump Motor
3	1	3/4"	2	#12	#12	Pump Lube Solenoid	MCC	Pump Head
4	1	3/4"	3	#14	#14	Pump Pressure Switch Hi-Lo	PLC	Pressure Switch
5	1	3/4"	1	#18 TSP		Flow 4-20ma	PLC	Flow Transmitter
6	1	3/4"	2	#12	#12	Air Compressor	Panel LP	Hydropneumatic Tank
7								
8								
9								
10								

CONDUIT AND WIRE MATERIALS:

ABOVE GRADE – HOT DIPPED GALVANIZED RIGID STEEL CONDUIT TO BE USED FOR ALL LOCATIONS ABOVE GRADE. ALL RIGID CONDUIT AND FITTINGS TO BE THREADED. USE OF SET SCREW OR COMPRESSION TYPE CONNECTOR IS PROHIBITED. MEYERS HUBS TO BE USED ON ALL EXTERIOR PANEL CONNECTIONS.

BELOW GRADE – RIGID PVC NONMETALLIC CONDUIT SCHEDULE 40 TO BE USED FOR ALL UNDERGROUND LOCATIONS. NO CONDUITS SHALL BE INSTALLED TO REDUCE THE STRUCTURAL INTEGRITY OF FOOTINGS.

THROUGH CONCRETE SLABS – PVC COATED GALVANIZED RIGID STEEL CONDUIT MINIMUM 40 MIL FACTORY COATING TO BE USED FOR ALL EXPOSED CONDUITS THROUGH CONCRETE SLABS (MINIMUM 12" ABOVE AND BELOW SLAB). USE MANUFACTURERS' SPECIFIED TOOLS AND PROCEDURES FOR INSTALLATION.

MOTOR OR SENSOR CONNECTIONS – LIQUID TIGHT FLEXIBLE METAL CONDUIT (UV RESISTANT) TO ONLY BE USED ON CONNECTIONS TO MOTORS OR SENSORS. MAXIMUM LENGTH TO BE 30".

JUNCTION BOXES – MINIMUM SIZE PER NEC. EXPOSED LOCATION 1 AND 2 GANG TO BE CAST IRON DEVICE BOXES TYPE FS/FD SUITABLE FOR WET LOCATIONS, EXPOSED LOCATION EXTERIOR LARGER SIZES CONTINUOUS HINGE TYPE 4, CORROSIVE LOCATIONS CONTINUOUS HINGE TYPE 4X STAINLESS STEEL

WIRE SHALL BE COPPER WITH XHHW INSULATION BY "CERROWIRE", "SOUTHWIRE", OR APPROVED EQUAL

NOTES:

1. THE EXACT LOCATIONS OF EXISTING CONDUITS ARE UNKNOWN. FOLLOWING POTHOLING, THE ENGINEER WILL PROVIDE DIRECTION ON LOCATIONS FOR NEW CONDUITS AND PULLBOXES.
2. FOR BIDDING PURPOSES, THE CONTRACTOR SHALL ASSUME THAT UNDERGROUND CONDUITS WILL BE INTERCEPTED AT THE EXISTING WELL (THIS IS THE FURTHEST LOCATION FROM THE NEW WELL.
3. CONSTRUCT ONE 24"x36"x2'DEEP CONCRETE PULL BOX WITH STEEL LID EACH WELL SITE. THE 3" CONDUITS SHALL BE BROUGHT INTO THE PULL BOXES USING PREFORMED SCH40 PVC SWEEPS. EXPOSE AND REROUTE EXISTING 3/4" CONDUITS TO THE PULL BOX. INSTALL NEW CONDUITS FROM THE PULL BOXES TO THE LOCATIONS SHOWN ON THE PLANS AND ELEVATION.
4. SEPARATE POWER WIRES FROM ANALOG SIGNAL WIRES BY 12" MINIMUM.
5. REMOVE AND DISPOSE OF EXISTING WIRE AND INSTALL NEW WIRE FOR ALL ITEMS ON THE WIRE SCHEDULE.
6. THE EXISTING MOTOR STARTER IS RVSS TYPE, "TELEMECANIQUE, ALITISTART 48".
7. THE ELECTRICAL CONTRACTOR SHALL VISIT EACH WELL SITE AND INSPECT EACH MCC/CONTROL PANEL PRIOR TO BID. TERMINATIONS TO THE PANELS AND EQUIPMENT SHALL BE OF LIKE KIND TO THE EXISTING CONNECTIONS.
8. VERIFY PROPER OPERATION OF PUMP AND EQUIPMENT IN THE PRESENCE OF THE ENGINEER.

REVISIONS					DESCRIPTION
					DATE
					BY

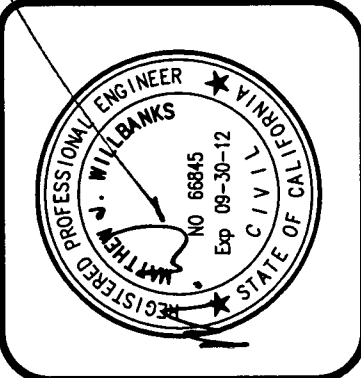
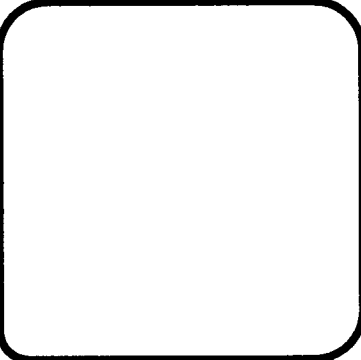

WELL 8B AND 9B
ELECTRICAL SCHEDULES

5110 W. CYPRUS AVE
P.O. BOX 3699
VISALIA, CA 93278
TEL (559) 733-0440
FAX (559) 733-7821
WWW.QUADKNOPF.COM

Quad Knopf

PREPARED BY:
DRAWN BY: M. WILLBANKS
CHECKED BY: K. HENDERSON

IMPROVEMENT PLAN FOR
CITY OF CORCORAN
830 WHITLEY AVE
CORCORAN, CA 93312
(559) 922-2181

WELLS 8B AND 9B
DRILLING, DEVELOPMENT, AND SITE IMPROVEMENTS

PLOT DATE	4/4/2012
JOB NO	C120046
FILE NAME	C120046-9B-S&D.dwg
SCALE	1" = 10'
SHEET NO	5