

CITY OF CORCORAN

# WATER TREATMENT PLANT

## STORM WATER BASIN RELOCATION

### NOTICE TO CONTRACTORS

- CONSTRUCTION SHALL BE PERFORMED IN ACCORDANCE WITH THE STANDARD SPECIFICATIONS FOR PUBLIC WORKS CONSTRUCTION AND THE APPLICABLE REQUIREMENTS OF THE STATE OF CALIFORNIA DEPARTMENT OF TRANSPORTATION STANDARD SPECIFICATIONS, 2018 EDITION EXCEPT AS MODIFIED BY THE CITY'S STANDARD DRAWINGS OR THE SPECIAL PROVISIONS.
- THE CONTRACTOR SHALL VERIFY ALL DIMENSIONS AND CONDITIONS BEFORE STARTING WORK.
- ALL A.C. PAVEMENT AND CONCRETE IMPROVEMENTS TO BE JOINED SHALL BE SAWCUT.
- THE ENGINEER DOES NOT WARRANT THE ACCURACY OF SCALED DIMENSIONS ON ANY PLAN. ALL DIMENSIONS SHALL BE AS DESIGNED ON THE PLANS. THE CONTRACTOR SHALL PROTECT ALL PUBLIC AND PRIVATE PROPERTY.
- DURING THE PERFORMANCE OF WORK DONE UNDER THE CONTRACT, THE CONTRACTOR SHALL TAKE THE NECESSARY PRECAUTIONS TO AVOID ANY DAMAGE TO ANY STRUCTURES ADJACENT TO THE PROJECT BOUNDARIES.
- EXISTING UTILITIES SHOWN ARE BASED ON AVAILABLE RECORDS OR PARENT UTILITY COMPANIES AND MAY NOT ACCURATELY REPRESENT THEIR ACTUAL LOCATIONS. PRIOR TO BEGINNING ANY CONSTRUCTION, THE CONTRACTOR SHALL VERIFY THE ACTUAL LOCATIONS (VERTICAL AND HORIZONTAL) OF ALL UTILITIES. IN THE FIELD OR COORDINATE SUCH INDEPENDENT VERIFICATION WITH THE PARENT UTILITY COMPANIES AND PROVIDE THE CITY WITH THE POT HOLE INFORMATION. THE CONTRACTOR SHALL PROTECT IN PLACE OR COORDINATE WITH PARENT COMPANY FOR THE RELOCATION OF CONFLICTING UTILITIES ENCOUNTERED DURING CONSTRUCTION.
- THE CONTRACTOR SHALL NOTIFY UNDERGROUND SERVICE ALERT (USA) AT 811 TWO WORKING DAYS PRIOR TO ANY EXCAVATION.
- A VISIT TO THE SITE IS REQUIRED. VERIFY ALL CONDITIONS PRIOR TO SUBMITTING A BID.
- EXTRA WORK AND/OR CHANGES TO BE APPROVED IN WRITING BY THE CITY PRIOR TO COMMENCEMENT OF WORK.
- OBTAIN ALL PERMITS REQUIRED TO COMPLETE THE WORK SPECIFIED PRIOR TO COMMENCEMENT OF WORK.

### CONTRACTOR NOTES

- IT IS THE RESPONSIBILITY OF THE CONTRACTOR TO PROTECT ALL EXISTING SURVEY MONUMENTS, LOT STAKES (TAGGED), OR BENCH MARKS. ANY MONUMENT DISTURBED DURING CONSTRUCTION SHALL BE PERPETUATED PER THE PROFESSIONAL LAND SURVEYOR'S ACT, BUSINESS AND PROFESSIONS CODE 8771, AT THE CONTRACTORS EXPENSE.
- CONTRACTOR IS RESPONSIBLE FOR SUBMITTING A TEMPORARY TRAFFIC CONTROL PLAN TO THE CITY OF CORCORAN FOR APPROVAL.
- NOTIFY THE ENGINEER OF ANY DISCREPANCIES BETWEEN THE PLANS AND THE PROJECT SITE.
- CONTRACTOR IS RESPONSIBLE FOR PREPARING & SUBMITTING A WATER POLLUTION CONTROL PLAN (WPCP) TO THE ENGINEER FOR APPROVAL FOR ALL CONSTRUCTION ACTIVITIES PRIOR TO THE BEGINNING OF WORK, AND REVISED TO REMAIN CURRENT THROUGHOUT THE PROJECT.
- CONTRACTOR TO PROVIDE 2 WEEKS NOTICE (EXCLUDING WEEKENDS), 3 DAY NOTICE AND 24 HOUR NOTICE TO PROPERTY OWNERS AND RESIDENTS PRIOR TO COMMENCING CONSTRUCTION WORK. NOTIFICATION TO BE BY LETTER AND SHALL BE APPROVED BY THE ENGINEER.
- CONTRACTOR SHALL RESTORE ALL FACILITIES DAMAGED BY CONSTRUCTION OPERATION TO THEIR ORIGINAL CONDITION AT NO ADDITIONAL COST. NO MATERIAL MAY BE STORED IN PUBLIC RIGHT OF WAY.
- TRAFFIC CONTROL DURING CONSTRUCTION SHALL BE THE CONTRACTORS RESPONSIBILITY AND IN ACCORDANCE WITH THE CONTRACT DOCUMENTS. THE CONTRACTOR SHALL SUBMIT A WRITTEN TRAFFIC CONTROL & SIGNING PLAN (INCLUDING STREET CLOSURE DETAILS) TO THE ENGINEER WITHIN TEN (10) WORKING DAYS AFTER AWARD OF CONTRACT.
- THE CONTRACTOR SHALL PROVIDE ALL LIGHTS, SIGNS BARRICADES, TEMPORARY RAMPS, FLAGMEN AND OTHER DEVICES TO PROVIDE VEHICULAR AND PEDESTRIAN SAFETY.
- CONTRACTOR SHALL PROTECT ALL UTILITY STRUCTURES, AND SURVEY MONUMENTS WITHIN THE WORK AREAS. THE CONTRACTOR SHALL REVIEW THE WORK SITES PRIOR TO SUBMISSION OF BIDS.
- RIGHT OF WAY LINES ARE SHOWN AT APPROXIMATE LOCATIONS.
- IT SHALL BE CONTRACTORS RESPONSIBILITY TO FIELD VERIFY LOCATION, ELEVATIONS, OF EXISTING FACILITIES AND TO IMMEDIATELY NOTIFY THE ENGINEER OF ANY FIELD CONFLICTS OR OMISSIONS.
- THE CONTRACTOR SHALL FURNISH A SELF-LOADING MOTOR SWEEPER WITH SPRAY NOZZLE AND OPERATE AT LEAST ONCE A DAY AND MORE AS NECESSARY TO CONTROL DUST CONDITIONS.
- THE CONTRACTOR SHALL MAINTAIN ACCESS TO RESIDENCES AND BUSINESSES THROUGHOUT THE LIFE OF THE CONTRACT.
- ANY DAMAGE TO THE EXISTING FACILITIES INCLUDING, BUT NOT LIMITED TO, TRESS, LANDSCAPING, IRRIGATION, FENCES, WALL, SIDEWALK, ANY OTHER PAVEMENT SURFACES SHALL BE REPAIRED AT CONTRACTOR'S EXPENSE. CONTRACTOR SHALL RESTORE ANY AND ALL PAVEMENT AND OTHER FACILITIES OUTSIDE LIMITS OF WORK AFFECTED BY THE CONSTRUCTION OPERATIONS AT NO ADDITIONAL COST.
- BIDDERS SHOULD NOTE PRESENCE OF OVERHEAD UTILITIES IN THE WORK AREA ALL OVERHEAD UTILITIES MAY NOT BE SHOWN ANY IF SHOWN, MAY BE IN THEIR APPROXIMATE ALIGNMENT. AS PART OF THEIR PRE-BID INSPECTION, BIDDERS SHALL NOTE THE TYPE ANY LOCATION OF OVERHEAD UTILITIES IN THE PROPOSED WORK AREA BIDDERS PRICE SHALL INCLUDE PROVISIONS FOR WORKING IN AREAS WHERE OVERHEAD UTILITIES EXIST AT THE TIME OF BIDDING, WHETHER SHOWN ON THE PLANS OR NOT, AND NO ADDITIONAL COMPENSATION IS ALLOWED.

### TEMPORARY REPAVING REQUIREMENTS

- THE CONTRACTOR SHALL FURNISH, PLACE AND COMPACT TWO (2)-INCHES OF COLD PATCH AS TEMPORARY PAVEMENT SURFACE OVER ALL BACKFILL AREAS CREATED FOR PIPELINE AND STRUCTURE INSTALLATION LOCATED IN ROADWAYS OR DRIVEWAYS. THIS SURFACE SHALL BE MAINTAINED BY THE CONTRACTOR UNTIL PERMANENT SURFACE RESTORATION HAS BEEN PERFORMED.
- SHOULD THE CONTRACTOR REMOVE EXISTING PAVEMENT BEYOND THE WIDTH SPECIFIED OR DETAILED ON THE PLANS, OR SHOULD PAVEMENT BE DISTURBED FROM SETTLEMENT SLIDES OR OTHER CONSTRUCTION ACTIVITIES, HE SHALL SAWCUT BACK THE PAVEMENT AND PROVIDE TEMPORARY PAVING IN THESE AREAS.

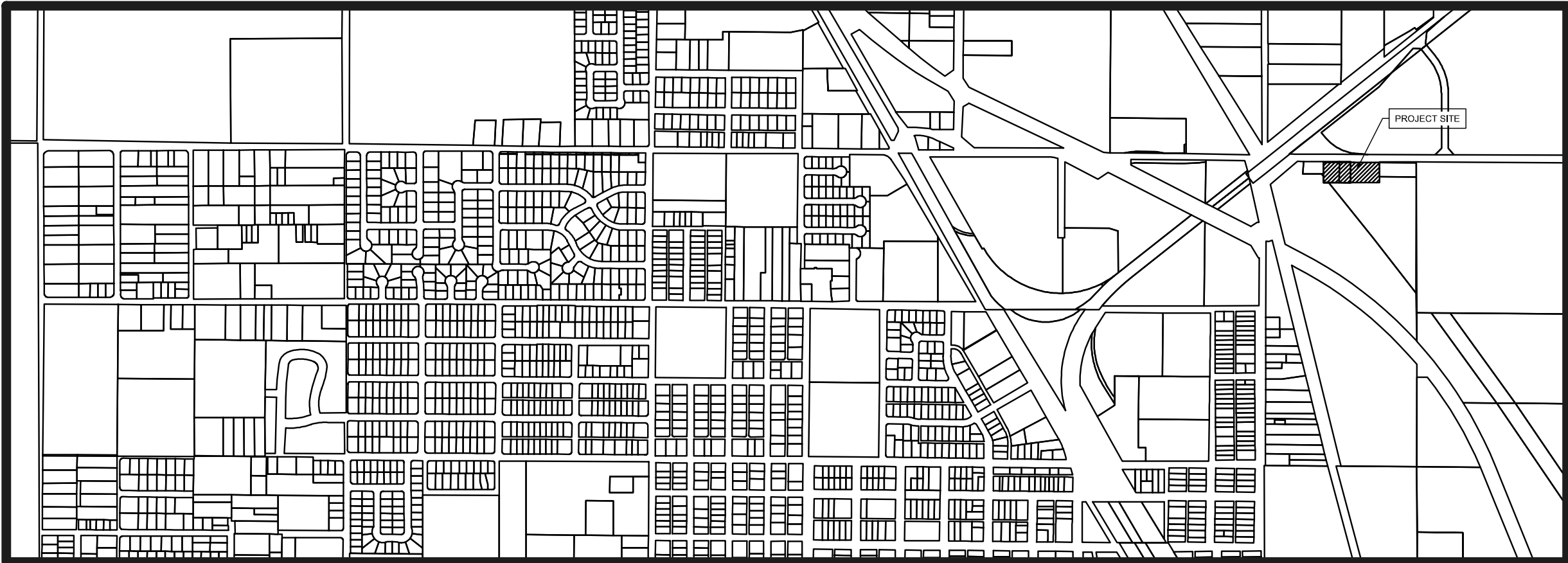

### VICINITY MAP

CITY OF CORCORAN

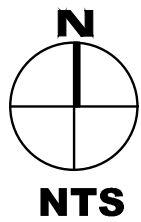

### BENCHMARKS

COORDINATES ARE REFERENCED TO THE CGCS83, ZONE 4 NAD83 (NSRS2007) EPOCH 2007.00. VERTICAL DATUM IS NAVD88 VIA GEOID09 REFERENCED TO GEODETIC DATUM EPOCH OF 2007.00 AS PUBLISHED IN CAHST AUTHORITY "RFP NO. HSR 13-57-BOOK IV, PART 6.4 RECORD OF SUPPLY AND CONTROL MONUMENT DATA.

### CONTROL POINTS

CONTROL POINT 1:  
CHISELED 'X' LOCATED ON THE TOP OF MANHOLE NEAR WATER TANK

CONTROL POINT 2:  
CHISELED 'X' LOCATED ON THE TOP OF FOOTING ON ELECTRICAL TOWER ON THE NORTH SIDE OF ORANGE AVENUE.

CONTROL POINT 3:  
CHISELED 'X' LOCATED ON THE EASTSIDE OF A CONCRETE CULVERT BOTTOM HEADWALL

CONTROL POINT 4:  
CHISELED 'X' LOCATED ON THE NORTH EASTSIDE OF A CONCRETE HEADWALL CROSSING THE IRRIGATION CANAL

### ESTIMATED EARTHWORK QUANTITIES

CUT (C.Y.): 3.398  
FILL (C.Y.): 0

NET (C.Y.): 3.398 <CUT>

#### NOTE:

QUANTITIES ARE SHOWN AS ESTIMATES ONLY. QUANTITIES SHALL NOT BE TAKEN AS EXACT QUANTITIES. CONTRACTOR SHALL BE RESPONSIBLE TO COMPLETE INDEPENDENT QUANTITY TAKE OFF AND VERIFY EARTHWORK MATERIAL TO COMPLETE THE PROJECT.

### CITY & ENGINEER CONTACTS

#### PUBLIC WORKS DIRECTOR

JOSEPH FAULKNER  
CITY OF CORCORAN  
832 WHITLEY AVE  
CORCORAN, CA 93212  
(559) 992-2151 EXT. Z210

#### CIVIL ENGINEER

ORFIL MUNIZ, PE, QSD  
A&M CONSULTING ENGINEERS  
220 N LOCUST AVE  
VISALIA, CA 93291  
(559) 429-4747

### PROJECT UTILITY CONTACTS

PG&E  
JEFF HEIDINGER  
705 "P" ST  
FRESNO, CA 93760  
(559) 263-7368

FRONTIER COMMUNICATION  
SOCRATES LUNA  
1359 "G" STREET,  
REEDLEY, CA 93654  
(559) 637-0666

SOUTHERN CALIFORNIA GAS CO  
CHAD MUELLER  
404 N TIPTON STREET  
VISALIA, CA 93292  
(559) 739-2241

COMCAST  
MICHAEL CORRAL  
(559) 217-9003

CITY OF CORCORAN WATER AND WASTEWATER  
JOSEPH FAULKNER  
832 WHITLEY AVE  
CORCORAN, CA 93212  
(559) 992-2151 EXT. Z210

### INDEX OF PLANS

TS - 1.01 - TITLE SHEET  
TS - 1.02 - GENERAL NOTES AND LEGEND  
DM - 1.01 - DEMOLITION PLAN  
CD - 1.01 - SITE PLAN  
CD - 1.02 - PROFILE ALIGNMENTS  
GR - 1.01 - GRADING AND DRAINAGE PLAN  
DS - 1.01 - DETAILS

### PIPELINE TRENCH EXCAVATION NOTES

- THE CONTRACTOR SHALL EXCAVATE, MAINTAIN AND BACKFILL ALL EXCAVATION NECESSARY FOR COMPLETING THE WORK UNDER THE CONTRACT. UNLESS OTHERWISE SPECIFIED OR APPROVED, EXCAVATION SHALL BE OPEN CUT.
- TRENCHES SHALL BE EXCAVATED TO THE NECESSARY WIDTH AND DEPTH, AS SHOWN ON THE DRAWINGS AND AS REQUIRED FOR THE SAFE INSTALLATION OF THE UTILITY, ETC.
- THE SIDES OF THE TRENCHES SHALL BE PRACTICALLY PLUMB AND SHALL NOT BE SLOPED UNLESS APPROVED IN WRITING BY THE ENGINEER. TRENCH SIDES SHALL BE SUPPORTED OR SHEETED AS REQUIRED TO PROTECT PAVEMENT SURFACES, CURBING, UTILITIES, ETC., AND REQUIRED FOR SAFETY. SAFETY REGULATIONS SHALL BE AS REQUIRED BY STATE SAFETY CODES AND OSHA.
- IN PAVED AREAS, THE CONTRACTOR SHALL REMOVE THE PAVING ONLY AS NECESSARY FOR THE EXCAVATION OF THE TRENCH OR AS DETAILED. PAVEMENT EDGES AT THE TRENCH SHALL BE SAW CUT NEAT AND STRAIGHT PRIOR TO THE START OF ANY EXCAVATION. SHOULD THE PAVEMENT DAMAGE RESULT FROM CAVE-INS, SETTLEMENT, ETC., HE SHALL REPLACE SUCH PAVING AT HIS OWN EXPENSE.
- THE EXCAVATION OF ALL TRENCHES SHALL BE FULLY COMPLETED AT LEAST TWENTY (20) FEET IN ADVANCE OF PIPE LAYING. UNLESS OTHERWISE AUTHORIZED OR DIRECTED, THE ENGINEER OR OWNER MAY REQUIRE THE BACKFILLING OF OPEN TRENCH, OVER COMPLETED PIPELINES, OR AHEAD OF THE PIPE LAYING OPERATION, IF IN HIS JUDGEMENT, SUCH ACTION IS NECESSARY.
- SHOULD WORK BE STOPPED FOR ANY REASON AND ANY EXCAVATION IS LEFT OPEN FOR AN UNREASONABLE LENGTH OF TIME, THE CONTRACTOR SHALL REFILL THE EXCAVATION AT HIS OWN EXPENSE IF SO DIRECTED, AND SHALL NOT REOPEN THE EXCAVATION UNTIL HE IS READY TO COMPLETE THE FACILITY. SHOULD THE CONTRACTOR REFUSE OR FAIL TO REFILL ANY EXCAVATION COMPLETELY WITHIN EIGHT (8) HOURS AFTER A PROPER NOTICE, THE OWNER SHALL BE AUTHORIZED TO DO THE WORK AND EXPENSES RESULTING SHALL BE PAID BY THE CONTRACTOR.
- THE CONTRACTOR SHALL COMPLETE EXCAVATION AS NEARLY AS PRACTICABLE TO THE LINES OF THE UTILITY TO BE INSTALLED AS DETAILED. ALL CAVITIES IN THE BOTTOM OF THE TRENCH SHALL BE FILLED TO THE REQUIRED LEVEL WITH COMPACTED CRUSHED STONE OR GRAVEL.
- EXCAVATED MATERIALS SHALL BE GRADED, HAULED, STORED AND PROTECTED AS SUCH MATERIAL FOUND. SUITABLE WILL BE REQUIRED FOR BACKFILLING, REPAVING OR OTHER PURPOSES. MATERIAL CLASSIFIED AS UNSUITABLE SHALL BE DISPOSED OF BY THE CONTRACTOR.
- EXCAVATED MATERIALS SHALL NOT BE PLACED ON PRIVATE PROPERTY, UNLESS WRITTEN PERMISSION IS OBTAINED FROM THE PROPERTY OWNER.
- THE CONTRACTOR SHALL BE RESPONSIBLE FOR ANY DAMAGE TO CURB, GUTTER, SIDEWALK, TRAFFIC CONTROL DEVICES, PAVEMENT MATERIAL, ANY DAMAGE RESULTING DIRECTLY OR INDIRECTLY SHALL BE REPLACED IN KIND BY THE CONTRACTOR. THE REUSE OF DISTURBED CURB, GUTTER OR SIDEWALK IS PROHIBITED. NEW SECTIONS SHALL BE INSTALLED TO THE NEAREST UNDISTURBED CONTROL JOINT.

### PIPELINE TRENCH BACKFILL

- MATERIALS EXCAVATED FROM THE TRENCH SHALL BE USED FOR TRENCH BACKFILL, PROVIDED THAT, IN THE OPINION OF THE ENGINEER, THE EXCAVATED MATERIAL IS SUITABLE FOR THIS PURPOSE. BACKFILL MATERIAL SHALL BE FREE FROM LARGE LUMPS AND STONES HAVING ANY DIMENSION GREATER THAN TWO (2)-INCHES.
- SUITABLE MATERIAL, AS APPROVED BY THE ENGINEER, SHALL BE CAREFULLY DEPOSITED IN THE TRENCH BY METHODS WHICH WILL NOT DAMAGE OR DISTURB THE PIPE OR STRUCTURE. BACKFILL MATERIAL SHALL BE PLACED IN EIGHT (8)-INCH LOOSE LAYERS. CARE SHALL BE TAKEN IN THE USE OF MECHANICAL TAMPERS NOT TO INJURE OR MOVE THE PIPE OR TO CAUSE THE PIPE TO BE SUPPORTED UNEVENLY.
- ALL BACKFILL MATERIAL SHALL BE COMPACTED TO 95% OF MAXIMUM DENSITY BETWEEN MINUS TWO TO PLUS TWO (2) PERCENT OF OPTIMUM MOISTURE CONTENT AS DETERMINED BY THE MODIFIED PROCTOR TEST, ASTM D1557. MATERIALS CONTAINING AN EXCESS OF MOISTURE SHALL BE PERMITTED TO DRY UNTIL THE MOISTURE CONTENT IS WITHIN THE SPECIFIED RANGE. MATERIALS TOO DRY SHALL BE WETTED UNIFORMLY UNTIL THE MOISTURE CONTENT IS IN THE SPECIFIED RANGE.
- NO COMPACTING SHALL BE DONE WHEN THE MATERIAL IS TOO WET TO BE COMPACTED PROPERLY. AT SUCH TIMES THE WORK SHALL BE SUSPENDED UNTIL THE BACKFILL MATERIALS HAVE DRIED OUT SUFFICIENTLY TO PERMIT PROPER COMPACTION OR SUCH OTHER PRECAUTIONS SHALL BE TAKEN AS MAY BE NECESSARY TO OBTAIN PROPER COMPACTION. THE CONTRACTOR IS RESPONSIBLE FOR HAULING, STORING AND DRYING OF EXCAVATED MATERIAL TO BE USED IN BACKFILL OPERATIONS.
- THE ENGINEER MAY REQUEST COMPACTION TESTS OF THE BACKFILLED TRENCHES AT ANY TIME DURING CONSTRUCTION OR UPON COMPLETION OF THE BACKFILL OPERATIONS. SUCH TESTING SHALL BE ARRANGED BY THE CONTRACTOR AND PERFORMED BY AN INDEPENDENT TESTING AGENCY APPROVED BY THE ENGINEER. THE CONTRACTOR SHALL PAY THE TESTING LABORATORY FOR ALL TESTS PERFORMED INCLUSIVE OF SAMPLE COLLECTION, PREPARATION AND TRANSPORTATION. IF THE RESULTS OF ANY TESTS SHOW THAT BACKFILLS DO NOT MEET THE SPECIFIED COMPACTION, THE CONTRACTOR SHALL, AT HIS OWN EXPENSE, CORRECT THE CONDITION AS DIRECTED BY THE ENGINEER.
- THE CONTRACTOR SHALL, AT HIS OWN EXPENSE, MAINTAIN ALL REFILLED EXCAVATIONS IN PROPER CONDITION. TRENCH SURFACES SHALL BE RESHAPED WHEN NECESSARY. IF THE CONTRACTOR FAILS TO MAKE REPAIRS WITHIN FORTY-EIGHT (48) HOURS AFTER RECEIPT OF WRITTEN NOTICE FROM THE OWNER, THE OWNER MAY REFILL SAID DEPRESSION WHEREVER NECESSARY AND THE COST OF SO DOING WILL BE PAID BY THE CONTRACTOR. THE CONTRACTOR SHALL BE RESPONSIBLE FOR ANY INJURY OR DAMAGE THAT MAY RESULT FROM LACK OF MAINTENANCE OF ANY REFILLED EXCAVATION AT ANY TIME PRIOR TO FINAL ACCEPTANCE.
- ALL UNAUTHORIZED EXCAVATIONS MADE BY THE CONTRACTOR SHALL BE IMMEDIATELY BACKFILLED IN ACCORDANCE WITH THE REQUIREMENTS OF THE SPECIFICATIONS FOR TRENCH BACKFILL, AT THE CONTRACTOR'S EXPENSE.
- AFTER COMPLETION OF BACKFILLING, ALL MATERIAL NOT USED, SHALL BE DISPOSED OF, AND ALL PLACES ON THE LINE OF THE WORK SHALL BE LEFT CLEAN AND IN GOOD CONDITION. THIS CLEANING UP SHALL BE DONE BY THE CONTRACTOR. IF HE FAILS TO DO THIS WORK WITHIN A REASONABLE TIME AFTER RECEIPT OF NOTICE, IT WILL BE PERFORMED BY THE OWNER, AND THE COST WILL BE ASSESSED TO THE CONTRACTOR.
- NO BACKFILL SHALL BE PLACED AGAINST NEW CONCRETE OR MASONRY STRUCTURES UNTIL PROPERLY CURED. IN THE CASE OF CONCRETE, TEST REPORTS MUST INDICATE THAT A 2500 PSI COMPRESSIVE STRENGTH EXISTS.
- THE CONTRACTOR SHALL EXERCISE CAUTION IN BACKFILL AND COMPACTION TO PREVENT DAMAGE TO STRUCTURES.
- NO TRENCH SHALL BE LEFT OPENED AT THE END OF THE WORKING DAY, UNLESS DIRECTED BY THE ENGINEER. ALL TRENCHES SHALL BE BACKFILLED. NO METAL PLATES ALLOWED FOR THE PROJECT.

### DUST CONTROL PLAN REQUIREMENTS

- IDENTIFY THE DUST SOURCES AND DESCRIBE THE DUST CONTROL MEASURES THAT WILL BE IMPLEMENTED BEFORE, DURING, AND AFTER ANY DUST GENERATING ACTIVITY FOR THE DURATION OF THE PROJECT. THE CONTRACTOR IS REQUIRED TO SUBMIT PLANS, OBTAIN PERMIT, AND PAY ALL FEES TO THE SAN JOAQUIN VALLEY AIR POLLUTION CONTROL DISTRICT AT LEAST 30 DAYS PRIOR TO COMMENCING THE WORK FOR THE FOLLOWING:
  - THE RELOCATION OF MORE THAN 2,500 CUBIC YARDS PER DAY OF MATERIALS ON AT LEAST THREE DAYS.
- OPERATIONS MAY NOT COMMENCE UNTIL THE DISTRICT HAS APPROVED THE DUST CONTROL PLAN. A COPY OF THE PLAN MUST BE ON SITE AND AVAILABLE TO WORKERS AND DISTRICT EMPLOYEES. ALL WORK ON THE SITE IS SUBJECT TO THE REQUIREMENTS OF THE APPROVED DUST CONTROL PLAN. A FAILURE TO ABIDE BY THE PLAN BY ANYONE ON SITE MAY BE SUBJECT TO ENFORCEMENT ACTION. THE CITY OF LEMOORE IS NOT RESPONSIBLE FOR ANY VIOLATION FEES, THE CONTRACTOR SHALL BE RESPONSIBLE TO PAY FOR ALL ASSOCIATED FEES.
- RECORD KEEPING IS REQUIRED TO DOCUMENT COMPLIANCE WITH THE RULES AND MUST BE KEPT FOR EACH DAY ANY DUST CONTROL MEASURE IS USED. THE DISTRICT HAS DEVELOPED RECORD FORMS FOR WATER APPLICATION, STREET SWEEPING, AND "PERMANENT" CONTROLS SUCH AS APPLYING LONG TERM DUST PALLIATIVES, VEGETATION, GROUND COVER MATERIALS, PAVING, OR OTHER DURABLE MATERIALS. RECORDS MUST BE KEPT FOR ONE YEAR AFTER THE END OF DUST GENERATING ACTIVITIES (TITLE V SOURCES MUST KEEP RECORDS FOR FIVE YEARS).

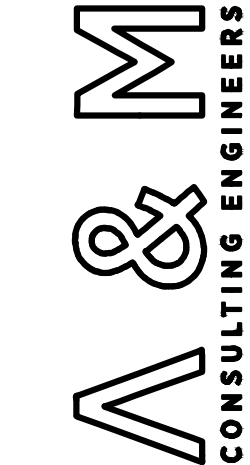
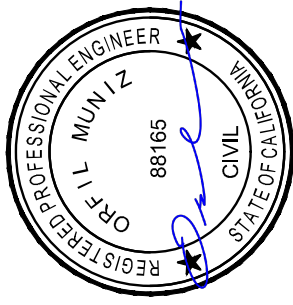

ENGINEERING PLANS FOR:  
**WATER TREATMENT PLANT  
STORM WATER BASIN RELOCATION**  
SHEET TITLE:  
**TITLE SHEET**

REVISIONS

NO.

SCALE: AS SHOWN  
JOB NO: 221-048  
DATE: 2/2/2023  
FILE: BASIN\_TSDWG

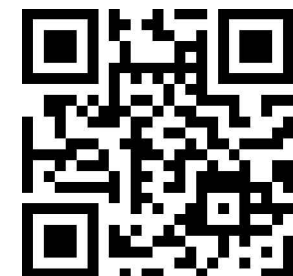

SHEET NO.

**TS-1.01**



## ABREVIATIONS & LEGEND

	AGGREGATE BASE	LID	LOW IMPACT DEVELOPMENT						
ABV	ABOVE	LIP	GUTTER LIP						EXISTING RIGHT-OF-WAY
AC	ASPHALT CONCRETE	LOC	LOCATION						
ACP	ASPHALT CONCRETE PAVING/PAVEMENT	LP	LOW POINT						DEMOLITION / SAWCUT LIMITS
ADJ	ADJACENT	LS	LIFT STATION						
AGG	AGGREGATE	LT	LEFT			(GAS2)			EXISTING 2" GAS UTILITY
ALT	ALTERNATE	MAS	MASONRY						
AP	ANGLE POINT	MATL	MATERIAL			(GAS4)			EXISTING 4" GAS UTILITY
APPROX	APPROXIMATE	MAX	MAXIMUM						
ARCH	ARCHITECT(URAL)	ME	MATCH EXISTING			(GAS6)			EXISTING 6" GAS UTILITY
BEL	BELOW	MED	MEDIUM						
BLDG	BUILDING	MFG	MANUFACTURING			(UU)			EXISTING UNDERGROUND COMM.
BLK	BLACK	MFR	MANUFACTURE(R)						
BMP	BEST MANAGEMENT PRACTICE	MH	MANHOLE			(OU)			EXISTING OVERHEAD COMM.
BOT	BOTTOM	MIN	MINIMUM						
BOW	BACK OF WALK	MISC	MISCELLANEOUS			(E)			EXISTING ELECTRICITY UTILITY
BR	BOTTOM OF RAMP	ML	MAINLINE						
BRG	BEARING	N	NEW			(OE)			EXISTING OVERHEAD ELECTRICITY
C	CONCRETE	NIC	NOT IN CONTRACT						
CB	CATCH BASIN	NO	NUMBER			(W16)			EXISTING 16" WATER LINE
CF	CUBIC FOOT	NOM	NOMINAL						
CI	CAST IRON	NTS	NOT TO SCALE			(SS8)			EXISTING 8" SANITARY SEWER
CITY	CITY OF CORCORAN	OC	ON CENTER						
CIP	CAST IN PLACE	OD	OUTSIDE DIAMETER			(FM4)			EXISTING 4" SANITARY SEWER FORCEMAIN
CL	CENTERLINE	OG	ORIGINAL GROUND						
CLR	CLEAR	OH	OVERHEAD						
CMU	CONCRETE MASONRY UNIT	OPP	OPPOSITE						
CO	CLEAN OUT	OPT	OPTIONAL						
COL	COLUMN	P	PAVEMENT						
COMM	COMMUNICATION	PA	PLANTER AREA						
CONC	CONCRETE	PCR	POINT OF CURVE RADIUS						
CONST	CONSTRUCTION	PERF	PERFORATE(D)						
CONT	CONTINUE, CONTINUOUS	PERP	PERPENDICULAR						
CP	CENTER POINT	PFE	PUBLIC FACILITIES EASEMENT						
CP#	CONTROL POINT #	PL	PROPERTY LINE						
CR	CURB RETURN	POB	POINT OF BEGINNING						
CTC	CENTER TO CENTER	POC	POINT OF CONNECTION						
CTR	CENTER	PRC	POINT OF REVERSE CURVE						
DAS	DIRECTION AS SHOWN	PROPD	PROPOSED						
DET	DETAIL	PSI	POUNDS PER SQUARE INCH						
DF	DRINKING FOUNTAIN	PT	POINT						
DI	DRAIN INLET	PTL	PRESSURE TREATED LUMBER						
DIA	DIAMETER	PUE	PUBLIC UTILITY EASEMENT						
DIAG	DIAGRAM	PVC	POLYVINYL CHLORIDE						
DIM	DIMENSION	R, RAD	RADIUS						
DIP	DUCTILE IRON PIPE	REBAR	REINFORCING BAR						
DS	DOWN SPOUT	REF	REFERENCE						
DWG	DRAWING	REM	REMOVE						
EA	EACH	REQ'D	REQUIRED						
EJ	EXPANSION JOINT	REV	REVISION(S), REVISED						
ELECT	ELECTRICAL	RH	RIGHT HAND						
ELEV	ELEVATION	ROW	RIGHT-OF-WAY						
ENCL	ENCLOSURE	RT	RIGHT						
EP	EDGE OF PAVEMENT	R/W	RIGHT-OF-WAY						
EQ	EQUAL	R(XX.X)	RADIUS						
EQUPT	EQUIPMENT	SCH	SCHEDULE						
ESMT	EASEMENT	SD	STORM DRAIN						
EXIST	EXISTING	SDMH	STORM DRAIN MANHOLE						
(E)	EXISTING	SG	SQUARE FEET						
FAB	FABRICATION	SG	SUBGRADE						
FBO	FURNISHED BY OTHERS	SHT	SHEET						
FF	FINISHED FLOOR	SIM	SIMILAR						
FFE	FINISHED FLOOR ELEVATION	SL	SLOPE						
FG	FINISHED GRADE	SPEC	SPECIFICATION(S)						
FIN	FINISHED)	SQ	SQUARE						
FL	FLOWLINE	SS	SANITARY SEWER						
FOC	FACE OF CONCRETE	S/S	STAINLESS STEEL						
FOF	FACE OF FINISH	SSFM	SANITARY SEWER FORCE MAIN						
FOM	FACE OF MASONRY	SMH	SANITARY SEWER MANHOLE						
FOS	FACE OF STEP	ST	STREET						
FND	FOUNDATION	STA	STATION						
FS	FINISHED SURFACE	STD	STANDARD						
FST	FINISHED SURFACE TURF	STL	STEEL						
FTG	FOOTING	STRUC	STRUCTURE/STRUCTURAL						
FUT	FUTURE	SURF	SURFACE						
GA	GAGE, GAUGE	SWCL	SIDEWALK CENTERLINE						
GB	GRADE BREAK	SYS	SYSTEM						
GKT	GASKET	SYN	SYNTHETIC						
GLV	GALVANIZED	TBC	TOP BACK OF CURB						
GPH	GALLONS PER HOUR	TC	TOP OF CURB						
GPM	GALLONS PER MINUTE	TF	TOP OF FOOTING						
GR	GRATE	TG	TOP OF GRATE						
HB	HOSE BIB	TR	TOP OF RAMP						
HC	HANDICAPPED	TS	TOP OF STEP						
HCAP	HANDICAPPED	TW	TOP OF WALL						
HDB	HEADBOARD	TYP	TYPICAL						
HEX	HEXAGONAL	UON	UNLESS OTHERWISE NOTED						
HOR	HORIZONTAL	VAR	VARIABLE						
HP	HIGH POINT	VERT	VERTICAL						
HT	HEIGHT	W	WATER						
HYD	FIRE HYDRANT	W/	WITH						
ID	INSIDE DIAMETER	W/O	WITHOUT						
INT	INTERSECTION	WS	WATER SERVICE						
INV	INVERT	WV	WATER VALVE						
IRR	IRRIGATION	@	AT						
J	JOINT	Ø	DIAMETER						
L	LENGTH	(XXX.XX)	EXISTING ELEVATION						
LB	LAG BOLT	S=0.XXXX	PROPOSED SLOPE IN DECIMAL						
LH	LEFT HAND								

## GENERAL CONSTRUCTION NOTES

1. EXISTING UTILITIES AND EXISTING IMPROVEMENTS MAY BE SHOWN AT APPROXIMATED LOCATIONS DUE TO THE AVAILABLE RECORD INFORMATION AT THE TIME OF PLAN PREPARATION. OTHER UTILITY LINES MAY EXIST. IT SHALL BE THE RESPONSIBILITY OF THE CONTRACTOR TO FIELD VERIFY ALL EXISTING UTILITIES BY POT-HOLING OR LOCATING SERVICES "811" IF FOUND NECESSARY.
2. THE CONTRACTOR SHALL NOTIFY ALL CORRESPONDING UTILITY COMPANIES AND CALL "811" AT LEAST 48 HOURS BEFORE THE COMMENCEMENT OF ANY WORK WHICH MAY REQUIRE UTILITY VERIFICATION. ADDITIONALLY, THE CONTRACTOR WILL SUPPLY SOUTHERN CALIFORNIA GAS COMPANY WITH A CONSTRUCTION SCHEDULE AND NOTIFY OF ANY PRE-CONSTRUCTION MEETINGS.
3. THE EXISTENCE AND LOCATION OF ANY UNDERGROUND UTILITY OR SUBSTRUCTURE SHOWN ON THESE PLANS WERE OBTAINED BY A SEARCH OF AVAILABLE RECORDS. NO CERTIFICATIONS IS MADE AS THE ACCURACY OR THOROUGHNESS OF THESE RECORDS. APPROVAL OF THESE PLANS BY THE CITY OF CORCORAN DOES NOT CONSTITUTE A REPRESENTATION AS THE ACCURACY OR COMPLETENESS OF LOCATION OR THE EXISTENCE OR NONEXISTENCE OF ANY UNDERGROUND UTILITY OR SUBSTRUCTURE WITHIN THE LIMITS OF THE PROJECT.
4. IT IS THE RESPONSIBILITY OF THE CONTRACTOR TO REVIEW THE FULL SET OF PLANS FOR ANY DISCREPANCIES AND OMISSIONS PRIOR TO THE COMMENCEMENT OF WORK. IF ANY DISCREPANCIES BETWEEN THESE PLANS AND THE FIELD ARE IDENTIFIED, THE CONTRACTOR SHALL NOTIFY THE ENGINEER. THE CONTRACTOR SHALL BE RESPONSIBLE FOR ANY WORK NOT IN CONFORMANCE WITH THE PLANS OR IN CONFLICT WITH ANY CODE.
5. AN APPROVED SET OF PLANS MUST BE AVAILABLE ON THE JOB SITE AT ALL TIMES.
6. THE CONTRACTOR SHALL POSSESS THE CLASS (OR CLASSES) OF LICENSE AS SPECIFIED IN THE "NOTICE TO BIDDERS."
7. ALL WORK SHALL BE PERFORMED IN CONFORMANCE WITH THE PROVISIONS IN THE CALTRANS STANDARD SPECIFICATIONS AND PLANS DATED 2018, ALONG WITH THE CITY OF CORCORAN STANDARD DRAWINGS AND THE LATEST VERSION OF THE GREEN BOOK.
8. THE CONTRACTOR SHALL BE RESPONSIBLE FOR PROVIDING ALL MATERIALS, FABRICATIONS, EQUIPMENT, APPLIANCES, TRANSPORTATION, SERVICES AND LABOR NECESSARY FOR THE CONSTRUCTION, ERECTION AND INSTALLATION OF ALL WORK INDICATED ON THESE DRAWINGS AND/OR OUTLINED IN EACH SECTION OF THE SPECIFICATIONS.
9. FOR THE DURATION OF THE WORK, THE CONTRACTOR SHALL PROVIDE, INSTALL AND MAINTAIN, AS MAY BE REQUIRED, ALL NECESSARY BARRICADES AND RAILINGS, LIGHTS, WARNING SIGNS AND SIGNALS, AND SHALL TAKE ALL OTHER PRECAUTIONS AS MAY BE REQUIRED TO SAFEGUARD PERSONS, THE JOB SITE AND ADJOINING PROPERTY, AGAINST INJURIES AND DAMAGE OF ANY NATURE.
10. THE CONTRACTOR AND EACH SUBCONTRACTOR SHALL GIVE THEIR PERSONAL ATTENTION TO THE WORK; BE RESPONSIBLE FOR THE LAYOUT AND CORRECTNESS OF THEIR WORK AND COOPERATE WITH EACH OF THE VARIOUS TRADES TO OBTAIN A NEAT FINISHED AND WORKMANLIKE JOB.
11. THE CONSTRUCTION CONTRACTOR AGREES THAT IN ACCORDANCE WITH GENERALLY ACCEPTED CONSTRUCTION PRACTICES, THE CONSTRUCTION CONTRACTOR WILL BE REQUIRED TO ASSUME SOLE AND COMPLETE RESPONSIBILITY FOR JOB SITE CONDITIONS DURING THE COURSE OF CONSTRUCTION OF THE PROJECT, INCLUDING SAFETY OF ALL PERSONS AND PROPERTY THAT THIS REQUIREMENT SHALL BE MADE TO APPLY CONTINUOUSLY AND NOT BE LIMITED TO NORMAL WORKING HOURS.
12. TO THE FULLEST EXTENT PERMITTED BY LAWS AND REGULATIONS, CONTRACTOR SHALL INDEMNIFY AND HOLD HARMLESS OWNER AND ENGINEER, AND THE OFFICERS, DIRECTORS, MEMBERS, PARTNERS, EMPLOYEES, AGENTS, CONSULTANTS AND SUBCONTRACTORS OF EACH AND ANY OF THEM FROM AND AGAINST ALL CLAIMS, COSTS, LOSSES, AND DAMAGES (INCLUDING BUT NOT LIMITED TO ALL FEES AND CHARGES OF ENGINEERS, ARCHITECTS, ATTORNEYS, AND OTHER PROFESSIONALS AND ALL COURT OR ARBITRATION OR OTHER DISPUTE RESOLUTION COSTS) ARISING OUT OF OR RELATING TO THE PERFORMANCE OF THE WORK, PROVIDED THAT ANY SUCH CLAIM, COST, LOSS, OR DAMAGE IS ATTRIBUTABLE TO BODILY INJURY, SICKNESS, DISEASE, OR DEATH, OR TO INJURY TO OR DESTRUCTION OF TANGIBLE PROPERTY (OTHER THAN THE WORK ITSELF), INCLUDING THE LOSS OF USE RESULTING THEREFROM BUT ONLY TO THE EXTENT CAUSED BY ANY NEGLIGENT ACT OR OMISSION OF CONTRACTOR, ANY SUBCONTRACTOR, ANY SUPPLIER, OR ANY INDIVIDUAL OR ENTITY DIRECTLY OR INDIRECTLY EMPLOYED BY ANY OF THEM TO PERFORM ANY OF THE WORK OR ANYONE FOR WHOM ACTS ANY OF THEM MAY BE LIABLE.
13. SHOULD A CONSTRUCTION SURVEY OR CONSTRUCTION STAKING BE NECESSARY, THE CONTRACTOR SHALL BE RESPONSIBLE FOR PROVIDING THIS SERVICE.
14. DO NOT SCALE DRAWINGS. IF UNABLE TO LOCATE DIMENSIONS FOR ANY ITEM OF WORK, CONTACT THE ENGINEER FOR DIRECTION BEFORE PROCEEDING.
15. ALL DAMAGE TO AREAS AND/OR PROPERTY NOT SPECIFICALLY PART OF THE PROJECT SITE CAUSED DURING CONSTRUCTION ACTIVITIES WILL BE THE RESPONSIBILITY OF THE CONTRACTOR TO RETURN TO PRE-CONSTRUCTION CONDITIONS.
16. CHANGES TO THE APPROVED DRAWINGS AND/OR SPECIFICATIONS SHALL BE MADE BY ADDENDUM OR A CHANGE ORDER SIGNED BY THE ENGINEER AND APPROVED BY THE PUBLIC WORKS/ENGINEERING OFFICIALS.
17. DUST AND DEBRIS CONTROL MEASURES SHALL BE IMPLEMENTED IN ACCORDANCE WITH THE REQUIREMENTS OF THE SAN JOAQUIN VALLEY UNIFIED AIR POLLUTION CONTROL DISTRICT - DISTRICT REGULATION VIII - FUGITIVE DUST RULES.
18. CONTRACTOR SHALL OBTAIN AND PAY FOR ALL PERMITS NECESSARY TO COMPLETE THE WORK, UNLESS OTHERWISE NOTED.

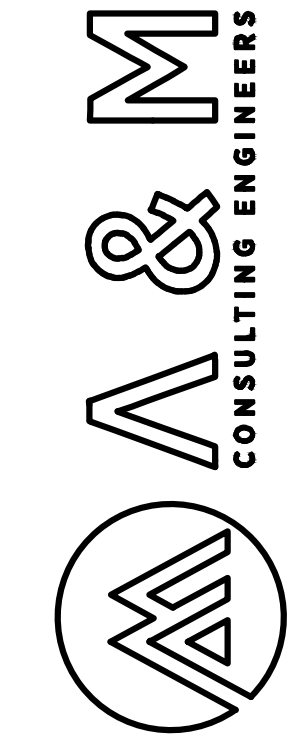
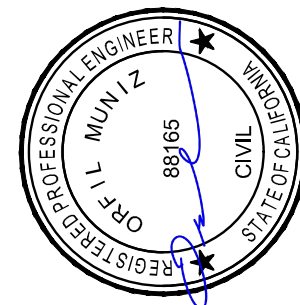

ENGINEERING PLANS FOR:  
WATER TREATMENT PLANT  
STORM WATER BASIN RELOCATION

SHEET TITLE:  
GENERAL NOTES AND LEGEND

## REVISIONS

NO.

SCALE:	AS SHOWN
JOB NO:	221-048
QA/QC:	JA
FILE:	BASIN_TS.DWG
DATE:	2/3/2023



SHEET NO.

# TS-1.02



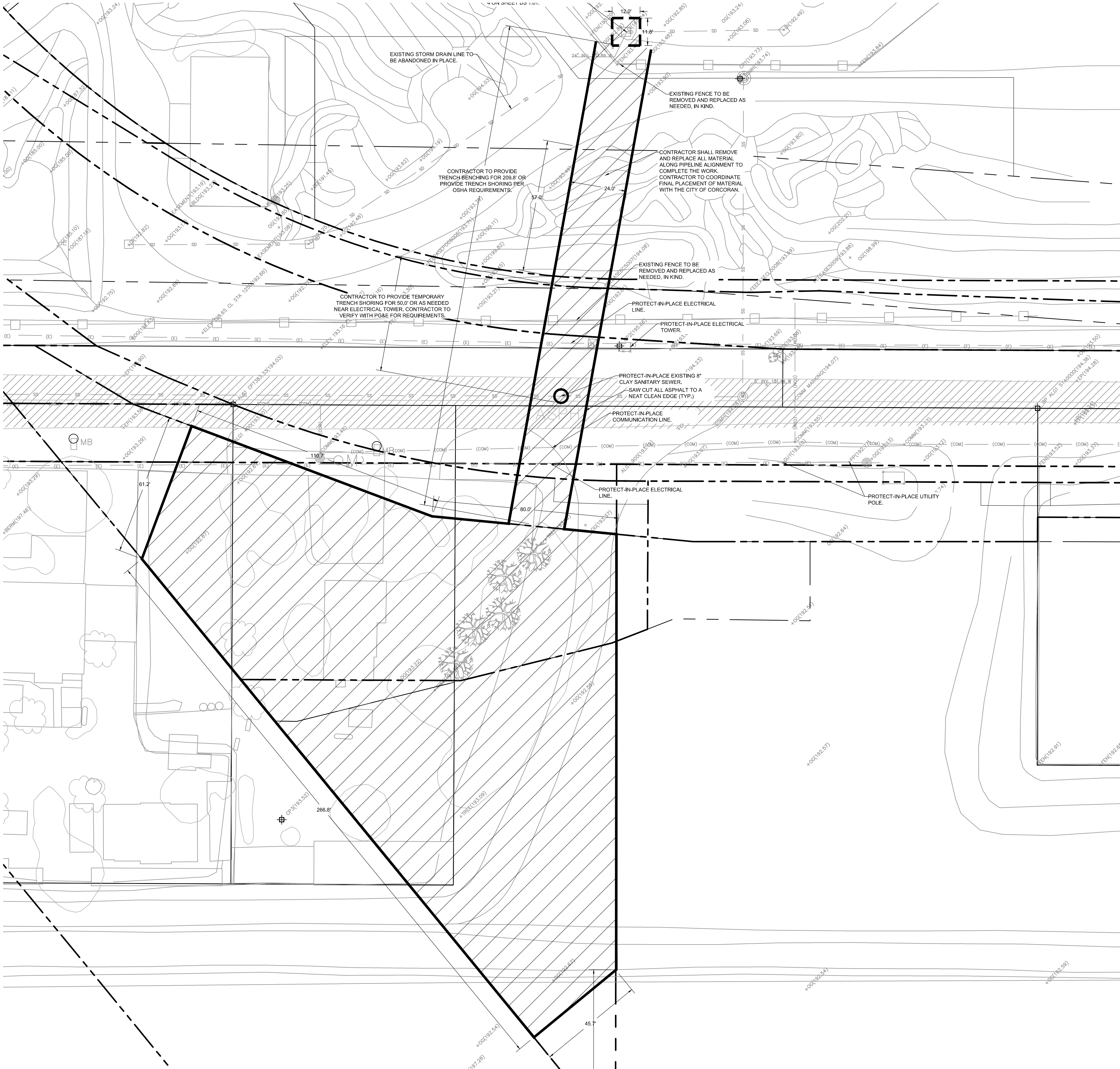

CONTRACTOR NOTES

1. IT IS THE RESPONSIBILITY OF THE CONTRACTOR TO PRESERVE ALL SURVEY MONUMENTS. ANY MONUMENT DISTURBED DURING CONSTRUCTION SHALL BE PERPETUATED PER THE PROFESSIONAL LAND SURVEYOR'S ACT, BUSINESS AND PROFESSIONS CODE 8771, AT THE CONTRACTORS EXPENSE.
2. LOCATIONS OF EXISTING UTILITIES ARE APPROXIMATED. CONTRACTOR TO FIELD VERIFY ALL EXISTING UTILITIES BEFORE COMMENCEMENT OF WORK.

GRADING NOTES

ALL SURFACE VEGETATION AND ANY MISCELLANEOUS SURFACE OBSTRUCTIONS SHOULD BE REMOVED FROM THE PROJECT AREA, PRIOR TO ANY SITE GRADING. IT IS ANTICIPATED THAT STRIPPING OF VEGETATION COULD INVOLVE THE UPPER 3 TO 5 INCHES OF THE SITE. SURFACE STRIPPINGS SHOULD NOT BE INCORPORATED INTO FILL UNLESS THEY CAN BE SUFFICIENTLY BLENDED TO RESULT IN AN ORGANIC CONTENT LESS THAN 3 PERCENT BY WEIGHT (ASTM D2974). STRIPPED TOPSOIL, WITH AN ORGANIC CONTENT BETWEEN 3 AND 12 PERCENT BY WEIGHT MAY BE STOCKPILED AND USED AS NON-STRUCTURAL FILL (I.E. LANDSCAPED AREAS). IF USED IN LANDSCAPE AREAS, SOIL WITH AN ORGANIC CONTENT BETWEEN 3 AND 12 PERCENT SHOULD BE PLACED WITHIN 2 FEET OF FINISHED GRADE AND AT LEAST 5 FEET OUTSIDE OF BUILDING PERIMETERS. SOIL WITH AN ORGANIC CONTENT GREATER THAN 12 PERCENT BY WEIGHT SHOULD BE EXCLUDED FROM FILL.

LEGEND

- SITE DEMOLITION AREA - REMOVE AND DISPOSE OF EXISTING SURFACES, CONCRETE, ROCKS, SOLID WASTE, TREES, AND VEGETATION AS SHOWN ON PLAN.
- CONTROL POINT
- EXISTING FOUND MONUMENT
- CONTRACTOR SHALL POTHOLE AND VERIFY SEWER LINE DEPTH WITH ENGINEER BEFORE COMMENCING WORK.

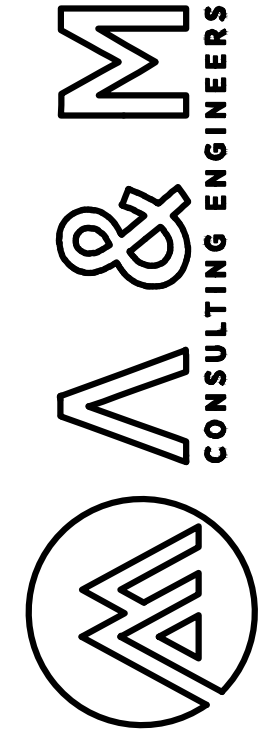
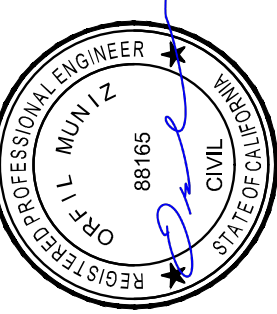
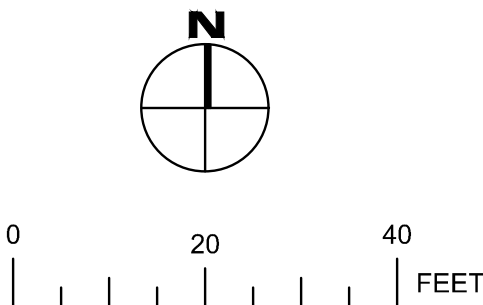

ENGINEERING PLANS FOR:  
**WATER TREATMENT PLANT  
STORM WATER BASIN RELOCATION**  
SHEET TITLE:  
**DEMOLITION PLAN**

REVISIONS		NO.
SCALE:	1" = 20'	
JOB NO:	221-048	
QA/QC:	JA	
FILE:	BASIN_DEMO.DWG	
DATE:	2/3/2023	



SHEET NO.

**DM-1.01**







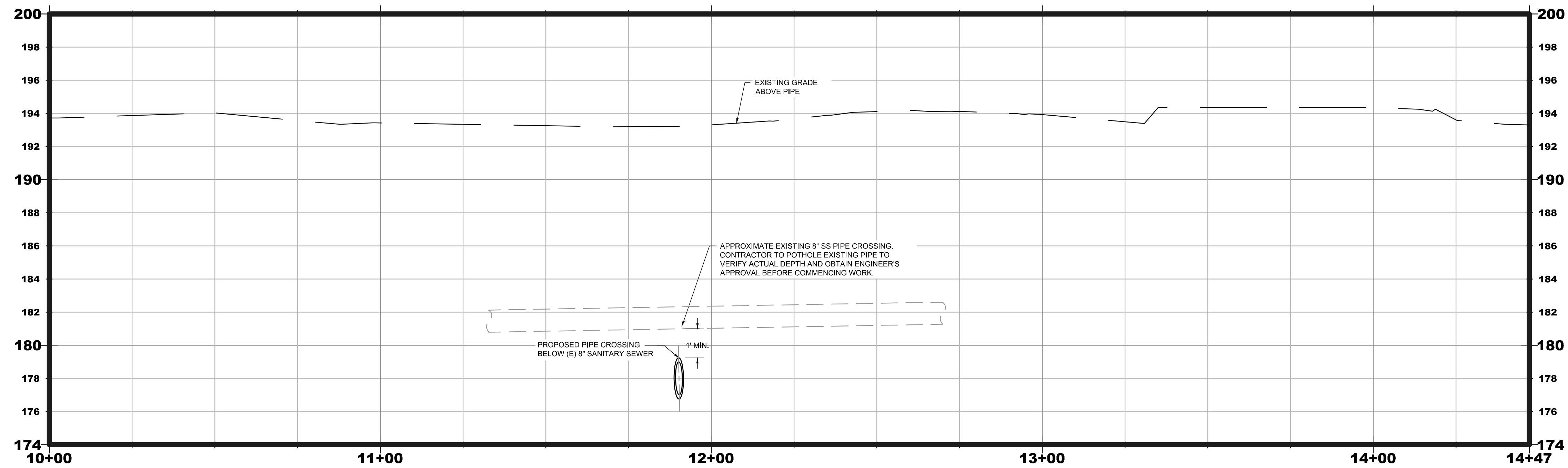

**ORANGE AVENUE STA: 10+00 TO 14+47**  
PLAN VIEW

HORZ: 1" = 20'  
VERT: 1" = 2'

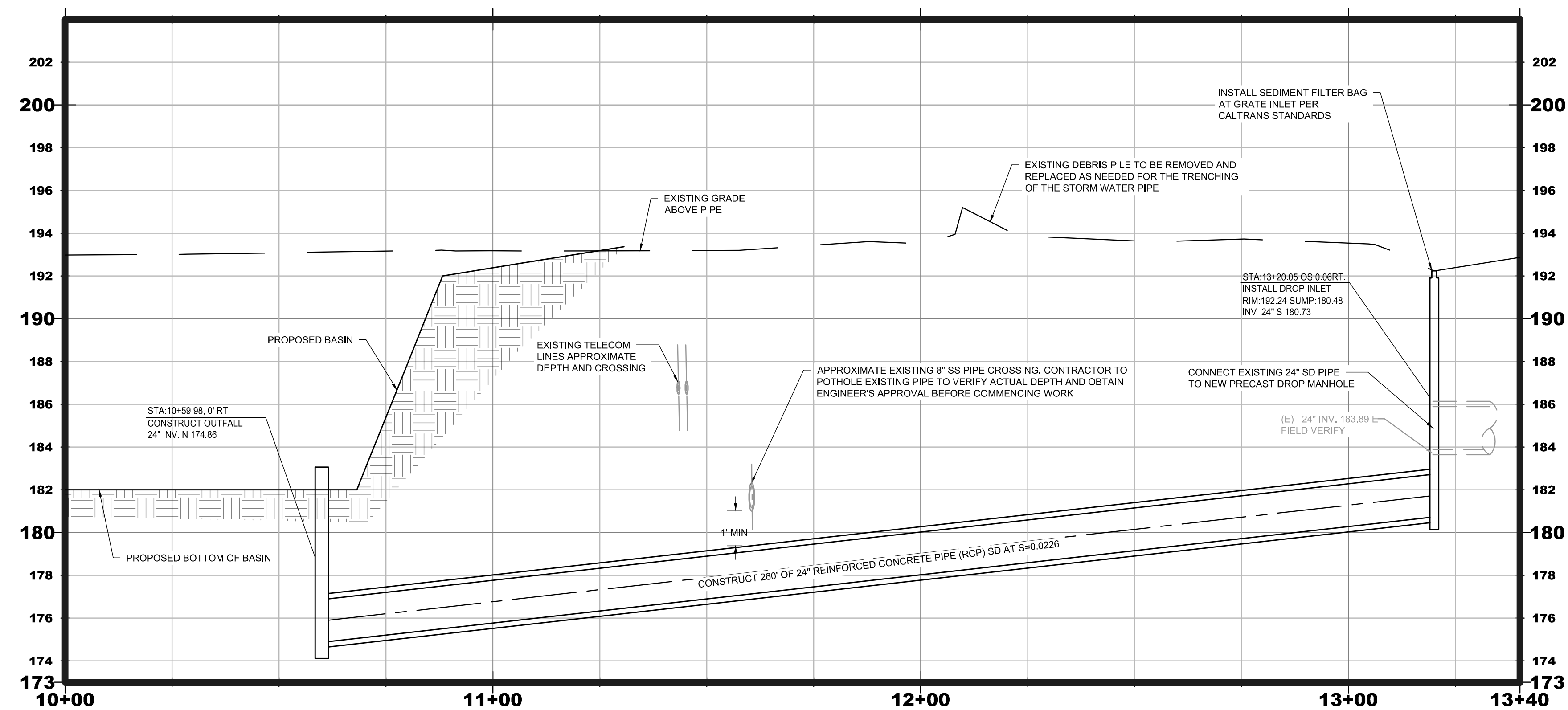

**PIPELINE ALIGNMENT STA: 10+00 TO 13+40**  
PLAN VIEW

HORZ: 1" = 20'  
VERT: 1" = 2'

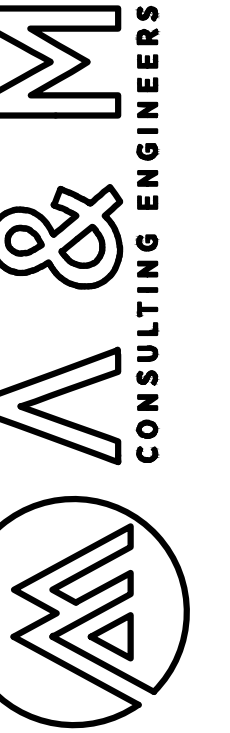
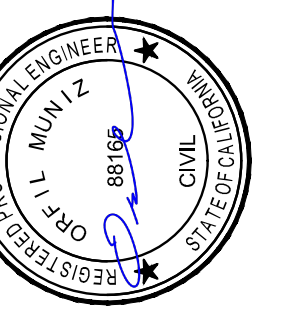

ENGINEERING PLANS FOR:  
**WATER TREATMENT PLANT  
STORM WATER BASIN RELOCATION**  
SHEET TITLE:  
**PROFILE ALIGNMENTS**

REVISIONS

NO.

SCALE: 1" = 20'  
JOB NO: 221-048  
O/A/C: J/A  
FILE: BASIN\_P&P.DWG  
DATE: 2/3/2023

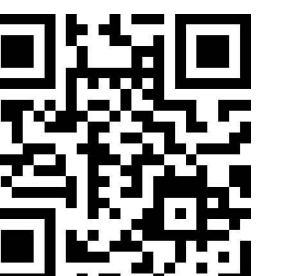

SHEET NO.

**CD-1.02**

OF 7







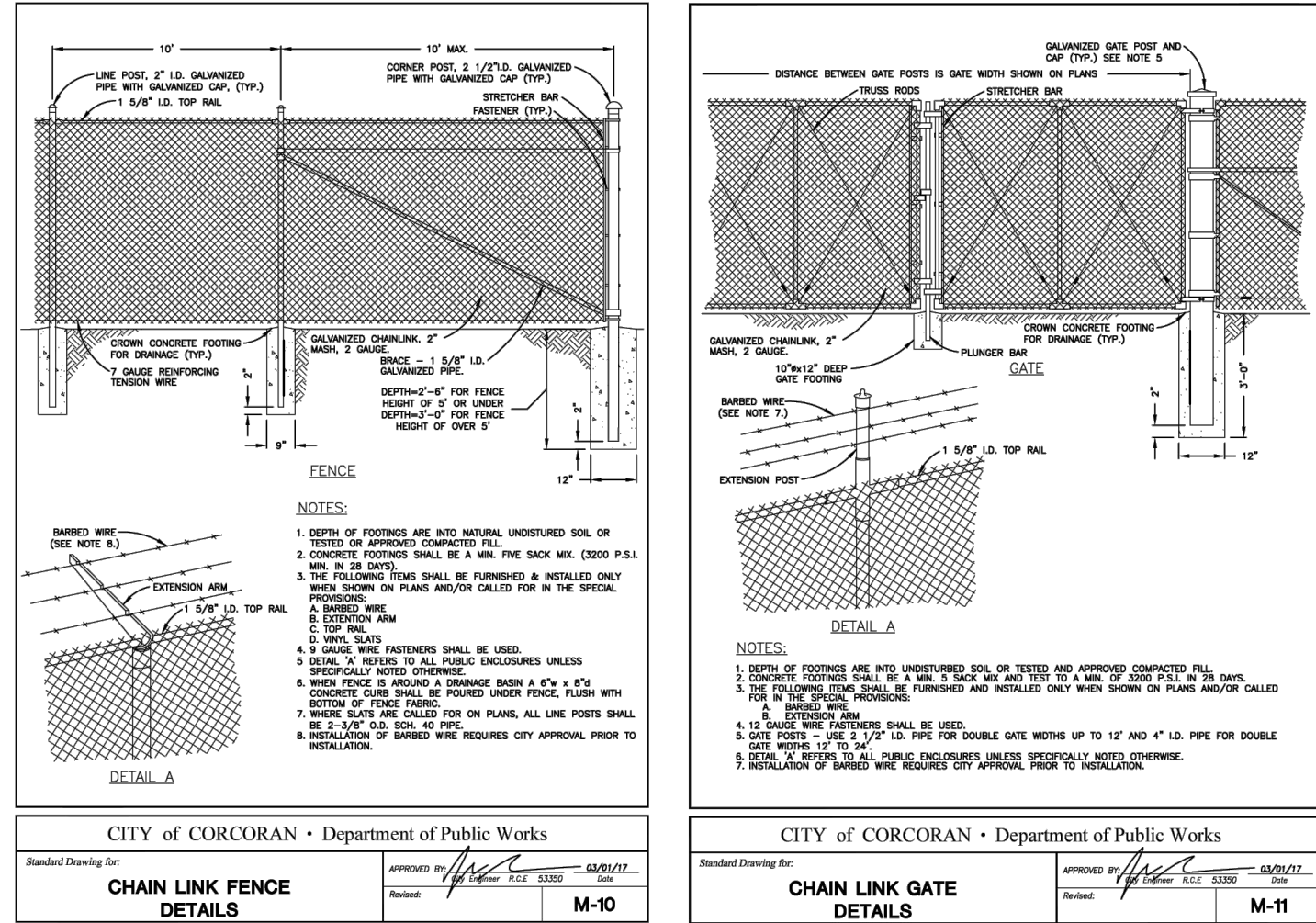

1 (BARBED WIRE) CHAIN LINK FENCE DETAILS

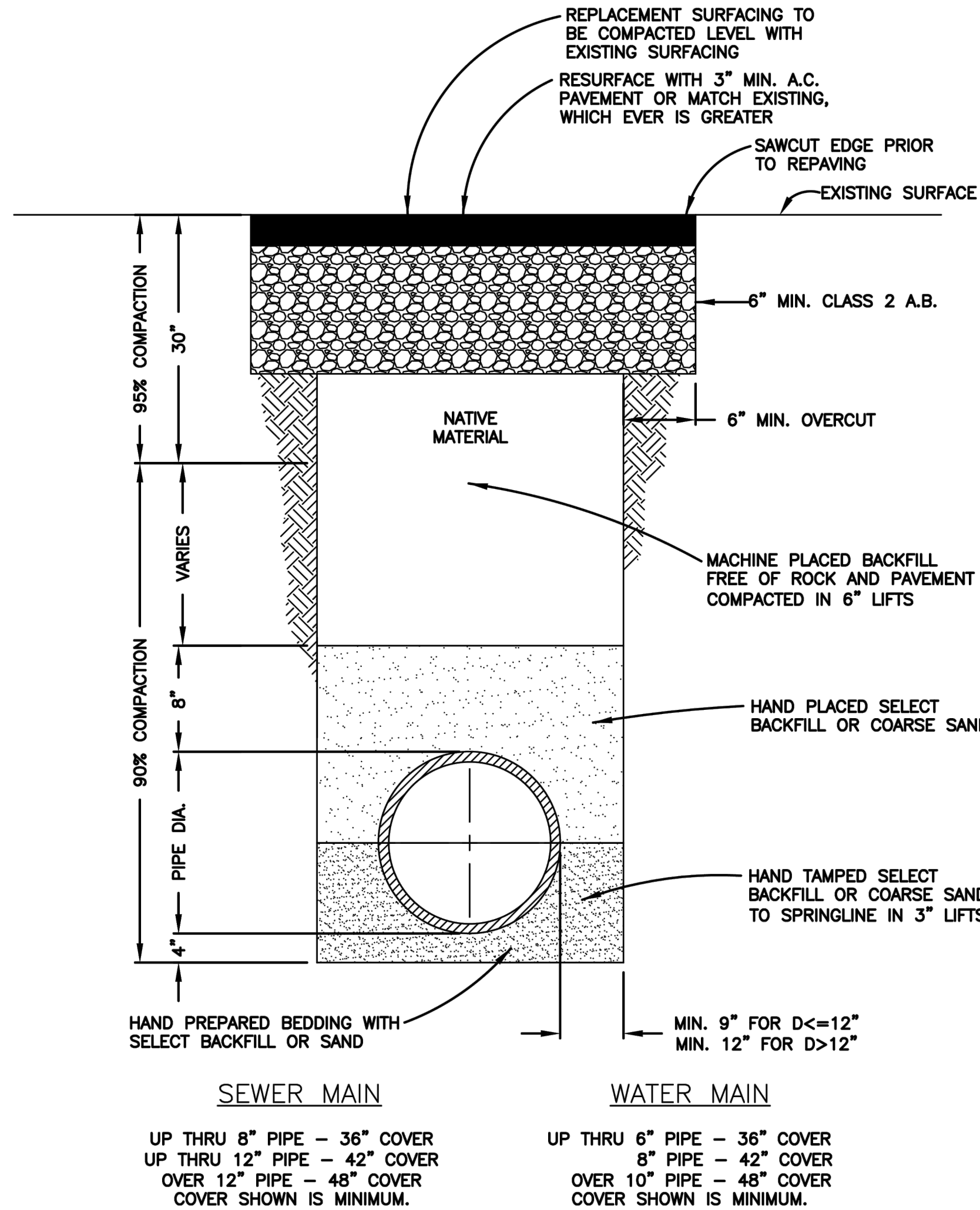

3 TRENCH IN SURFACED & UN-SURFACED AREA DETAIL

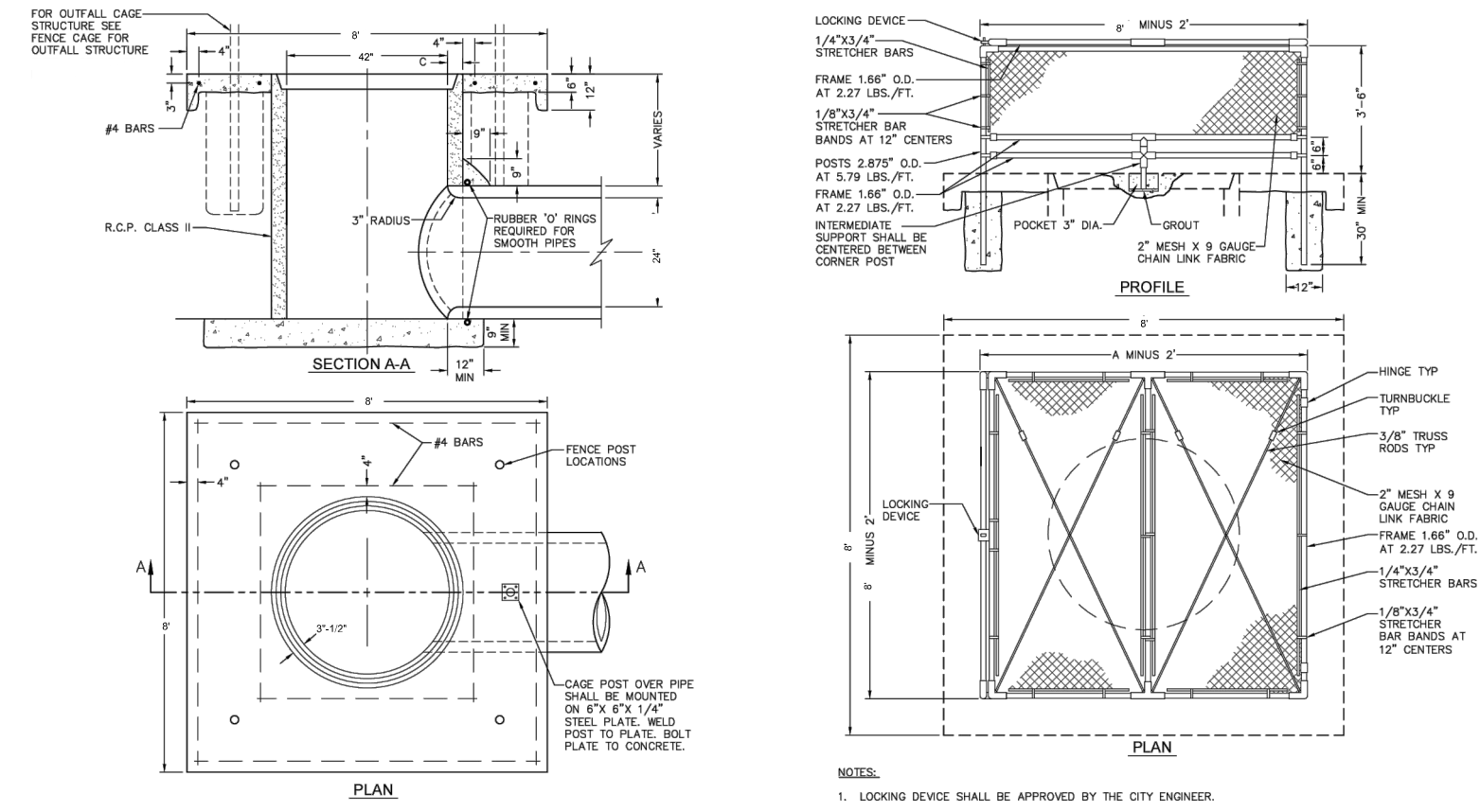

2 STORM WATER OUTFALL STRUCTURE DETAILS

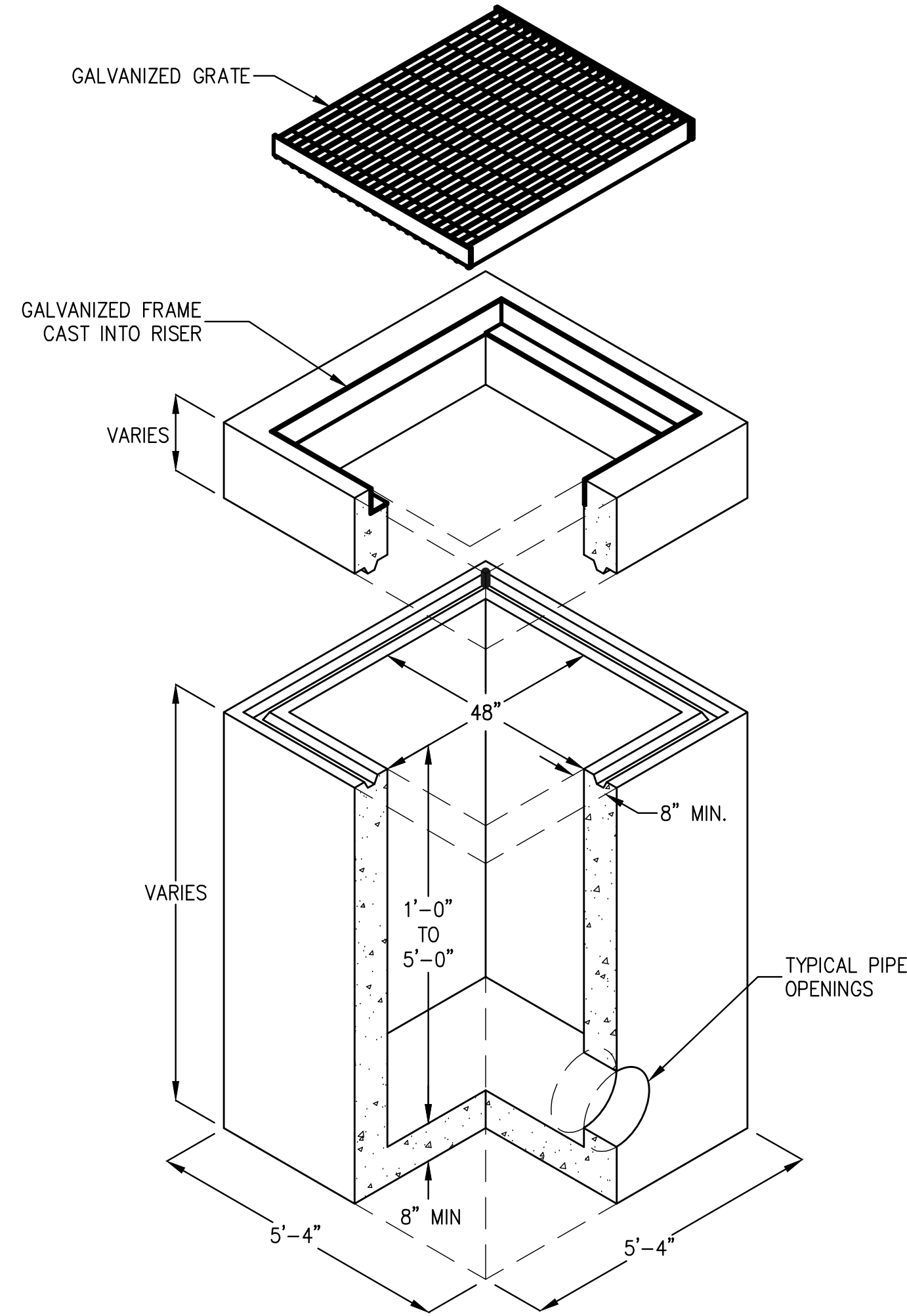

4 TYPICAL PRECAST DROP INLET DETAIL

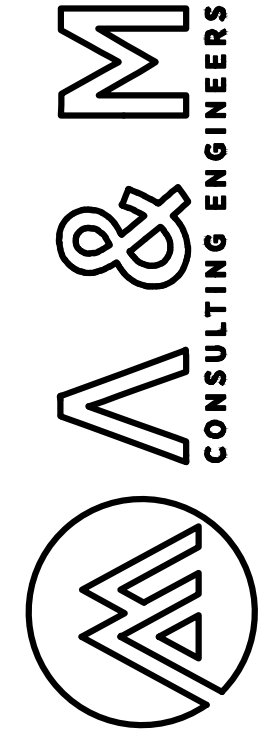
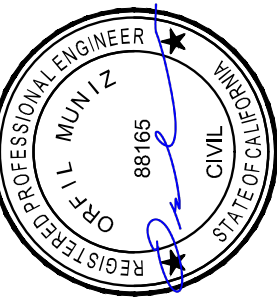

ENGINEERING PLANS FOR:  
WATER TREATMENT PLANT  
STORM WATER BASIN RELOCATION  
SHEET TITLE:  
DETAIL SHEET

REVISIONS

NO.

SCALE: AS SHOWN  
JOB NO: 221-048  
QA/QC: JA  
FILE: BASIN\_DETAILS.DWG  
DATE: 2/23/2023



SHEET NO.

DS-1.01