



PUBLIC WORKS DEPARTMENT

PRESS RELEASE

FOR IMMEDIATE RELEASE ON MARCH 15, 2021

STREET CLOSURES

KEITH LANE FROM POWERS PATH TO CRESTWAY DRIVE
POWERS PATH FROM KEITH LANE TO MCMINN AVE

ATHENS, TENNESSEE – March 15, 2021 – The City of Athens Public Works Department announces the following street closures:

KEITH LANE from POWERS PATH to CRESTWAY DRIVE will be closed from Monday, March 15, 2021 at 7:00 a.m. until no later than Saturday, March 20, 2021 at 5:00 p.m.

After Keith Lane is reopened, POWERS PATH will be closed from KEITH LANE to MCMINN AVE. This closure will be in effect until no later than Saturday, March 20, 2021 at 5:00p.m.

Motorists are advised to use extreme caution, watch for detour and traffic control signage, pedestrians, and work crews. Motorists should allocate additional time for traffic delays when traveling in this area.

The purpose for these closures is utility crossings and utility taps.



The City of Athens is a full-service municipality nestled in the foothills of the Great Smoky Mountains and has garnered a reputation as the “Friendly City.”

For more information, please contact the Office of the Public Works Department at 423-744-2745.

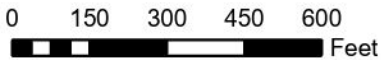
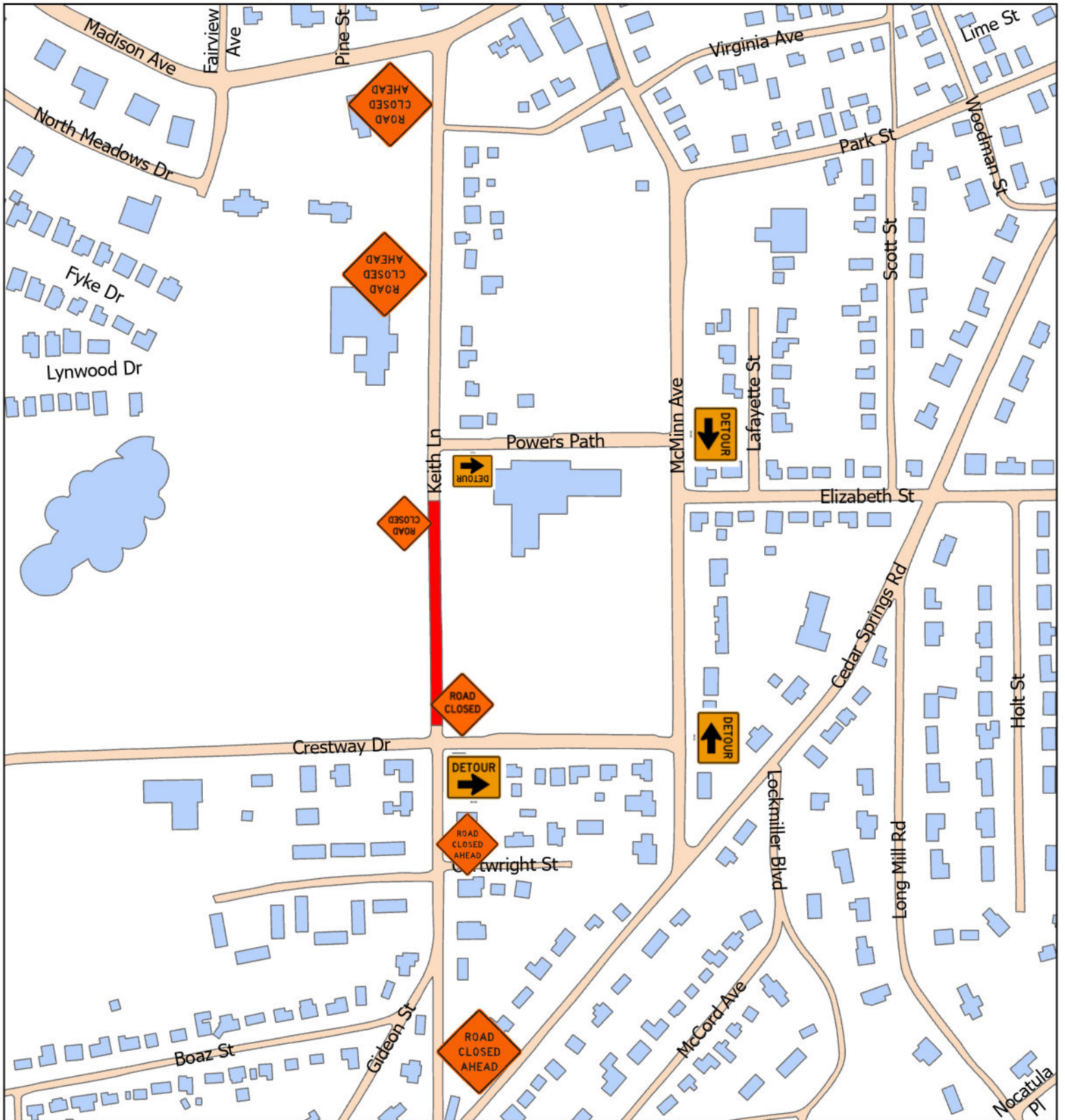
Keith Lane Closure

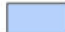

Closure Type

-  street
-  Edge of Pavement
-  Buildings